

Unimate Range - SLA/BLA

From Weidmueller only: the unique connector face with the secure protection against incorrect insertion.

The pin headers and socket blocks of the SLA/BLA product family will only mate as a pair, i.e. only pin headers and socket blocks of the same number of poles will connect together.

This is not the only unique feature of this Weidmueller classic: We make this 5.08 mm pitch product family from glass-fibre-reinforced PBT. The outstanding material properties are the reason why the pin headers and socket blocks are able to withstand a continuous operating temperature of 120 degrees celsius and an increased ambient temperature.

There are three different connection techniques available: clamping yoke connection, TOP, and crimp connection. All the pin headers and socket blocks of the the Unimate Range can be combined as required. For example for the free connection of initiators and actuators, at interface elements and power supply units, and for motor control applications.

Product features overview:

- double protection against incorrect insertion (can only be inserted as a pair and only in one orientation)
- protection against wiring errors
- suitable for continuously high operation temperature
- voltages up to 250 V, currents up to 14 A, conductor cross-sections up to 2.5 mm²
- glass fibre-reinforced thermoplastic polyester (PBT) is used as insulation material: flame-resistant according to UL 94 V-0
- large selection of accessories

Unimate Range - SLA/BLA



Pin headers SLA 90

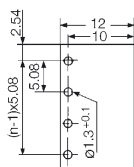
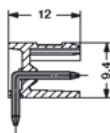
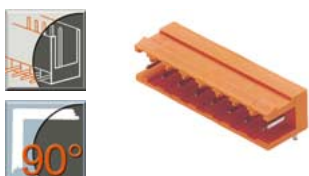

Technical Data		VDE	UL	CSA
Rated voltage	V	250*	300	300
Rated current	A	10	10	10

*Overvoltage category III / Pollution severity 3
Additional technical data see page 227

Pin headers SLA 90B

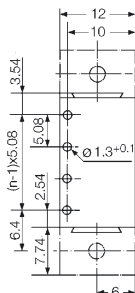
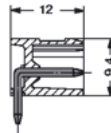
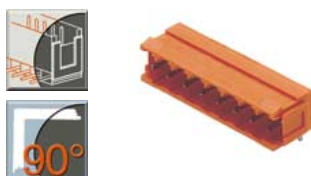

Technical Data		VDE	UL	CSA
Rated voltage	V	250*	300	300
Rated current	A	10	10	10

*Overvoltage category III / Pollution severity 3
Additional technical data see page 227

Pin headers SLA 180

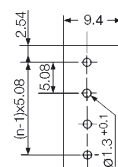
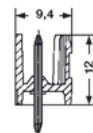

Technical Data		VDE	UL	CSA
Rated voltage	V	250*	300	300
Rated current	A	10	10	10

*Overvoltage category III / Pollution severity 3
Additional technical data see page 227

Solder pin length 3.2 mm 4.5 mm

Colour

Poles	Type	Cat. No.	Cat. No.	Qty.
2	SLA 2/90	1238060000	1346810000	100
3	SLA 3/90	1238160000	1346910000	100
4	SLA 4/90	1238260000	1347010000	100
5	SLA 5/90	1238360000	1347110000	50
6	SLA 6/90	1238460000	1347210000	50
7	SLA 7/90	1238560000	1347310000	50
8	SLA 8/90	1238660000	1347410000	50
9	SLA 9/90	1238760000	1347510000	50
10	SLA 10/90	1238860000	1347610000	50
11	SLA 11/90	1238960000	1347710000	50
12	SLA 12/90	1239060000	1347810000	50
13	SLA 13/90	1239160000	1347910000	50
14	SLA 14/90	1239260000	1348010000	50
15	SLA 15/90	1239360000	1348110000	50
16	SLA 16/90	1239460000	1348210000	50
17	SLA 17/90	1271760000	1348310000	20
18	SLA 18/90	1271860000	1348410000	20
19	SLA 19/90	1271960000	1348510000	20
20	SLA 20/90	1272060000	1348610000	20
21	SLA 21/90	1272160000	1348710000	20
22	SLA 22/90	1315960000	1348810000	20
23	SLA 23/90	1316060000	1348910000	20
24	SLA 24/90	1316160000	1349010000	20

Solder pin length 3.2 mm 4.5 mm

Colour

Poles	Type	Cat. No.	Cat. No.	Qty.
2	SLA 2/90B	1241060000	1351410000	100
3	SLA 3/90B	1241160000	1351510000	100
4	SLA 4/90B	1241260000	1351610000	100
5	SLA 5/90B	1241360000	1351710000	50
6	SLA 6/90B	1241460000	1351810000	50
7	SLA 7/90B	1241560000	1351910000	50
8	SLA 8/90B	1241660000	1352010000	50
9	SLA 9/90B	1241760000	1352110000	50
10	SLA 10/90B	1241860000	1352210000	50
11	SLA 11/90B	1241960000	1352310000	50
12	SLA 12/90B	1242060000	1352410000	50
13	SLA 13/90B	1242160000	1352510000	50
14	SLA 14/90B	1242260000	1352610000	50
15	SLA 15/90B	1242360000	1352710000	50
16	SLA 16/90B	1242460000	1352810000	50
17	SLA 17/90B	1270260000	1352910000	20
18	SLA 18/90B	1270360000	1353010000	20
19	SLA 19/90B	1270460000	1353110000	20
20	SLA 20/90B	1270560000	1353210000	20
21	SLA 21/90B	1270660000	1353310000	20
22	SLA 22/90B	1315660000	1353410000	20
23	SLA 23/90B	1315760000	1353510000	20
24	SLA 24/90B	1315860000	1353610000	20

Solder pin length 3.2 mm 4.5 mm

Colour

Poles	Type	Cat. No.	Cat. No.	Qty.
2	SLA 2/180	1239560000	1349110000	100
3	SLA 3/180	1239660000	1349210000	100
4	SLA 4/180	1239760000	1349310000	100
5	SLA 5/180	1239860000	1349410000	50
6	SLA 6/180	1239960000	1349510000	50
7	SLA 7/180	1240060000	1349610000	50
8	SLA 8/180	1240160000	1349710000	50
9	SLA 9/180	1240260000	1349810000	50
10	SLA 10/180	1240360000	1349910000	50
11	SLA 11/180	1240460000	1350010000	50
12	SLA 12/180	1240560000	1350110000	50
13	SLA 13/180	1240660000	1350210000	50
14	SLA 14/180	1240760000	1350310000	50
15	SLA 15/180	1240860000	1350410000	50
16	SLA 16/180	1240960000	1350510000	50
17	SLA 17/180	1271260000	1350610000	20
18	SLA 18/180	1271360000	1350710000	20
19	SLA 19/180	1271460000	1350810000	20
20	SLA 20/180	1271560000	1350910000	20
21	SLA 21/180	1271660000	1351010000	20
22	SLA 22/180	1315060000	1351110000	20
23	SLA 23/180	1315160000	1351210000	20
24	SLA 24/180	1315260000	1351310000	20

Accessories	Page
Fixing	-
Marking	196
Coding	199
Miscellaneous	205

Accessories	Page
Fixing	193
Marking	196
Coding	199
Miscellaneous	205

Accessories	Page
Fixing	-
Marking	196
Coding	199
Miscellaneous	-



Pin headers SLA 180B

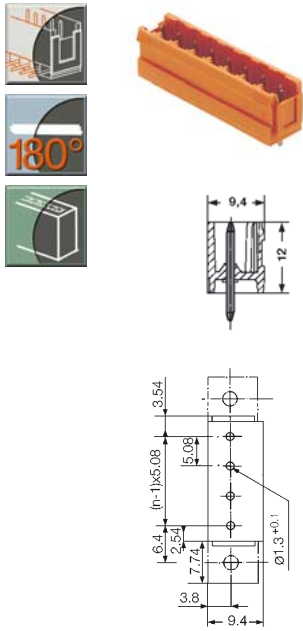

Technical Data		VDE	UL	CSA
Rated voltage	V	250*	300	300
Rated current	A	10	10	10

*Overvoltage category III / Pollution severity 3
Additional technical data see page 227

Solder pin length **3.2 mm** **4.5 mm**

Colour				
Poles	Type	Cat. No.	Cat. No.	Qty.
2	SLA 2/180B	1242560000	1353710000	100
3	SLA 3/180B	1242660000	1353810000	100
4	SLA 4/180B	1242760000	1353910000	100
5	SLA 5/180B	1242860000	1354010000	50
6	SLA 6/180B	1242960000	1354110000	50
7	SLA 7/180B	1243060000	1354210000	50
8	SLA 8/180B	1243160000	1354310000	50
9	SLA 9/180B	1243260000	1354410000	50
10	SLA 10/180B	1243360000	1354510000	50
11	SLA 11/180B	1243460000	1354610000	50
12	SLA 12/180B	1243560000	1354710000	50
13	SLA 13/180B	1243660000	1354810000	50
14	SLA 14/180B	1243760000	1354910000	50
15	SLA 15/180B	1243860000	1355010000	50
16	SLA 16/180B	1243960000	1355110000	50
17	SLA 17/180B	1270760000	1355210000	20
18	SLA 18/180B	1270860000	1355310000	20
19	SLA 19/180B	1270960000	1355410000	20
20	SLA 20/180B	1271060000	1355510000	20
21	SLA 21/180B	1271160000	1355610000	20
22	SLA 22/180B	1315360000	1355710000	20
23	SLA 23/180B	1315460000	1355810000	20
24	SLA 24/180B	1315560000	1355910000	20

Accessories	Page
Fixing	193
Marking	196
Coding	199
Miscellaneous	-

Pin headers SLAKU

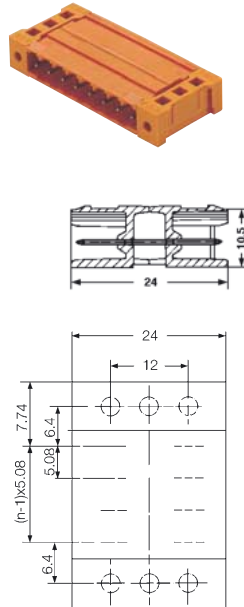

Technical Data		VDE	UL	CSA
Rated voltage	V	250*	300	300
Rated current	A	10	10	10

*Overvoltage category III / Pollution severity 3

Colour			
Poles	Type	Cat. No.	Qty.
2	SLAKU 2	1359660000	50
3	SLAKU 3	1359760000	50
4	SLAKU 4	1342760000	50
5	SLAKU 5	1359860000	25
6	SLAKU 6	1359960000	25
7	SLAKU 7	1360060000	20
8	SLAKU 8	1342860000	20
9	SLAKU 9	1360160000	20
10	SLAKU 10	1360260000	20
11	SLAKU 11	1360360000	10
12	SLAKU 12	1360460000	10

Accessories	Page
Fixing	-
Marking	-
Coding	-
Miscellaneous	-

Pin headers SLAD 90

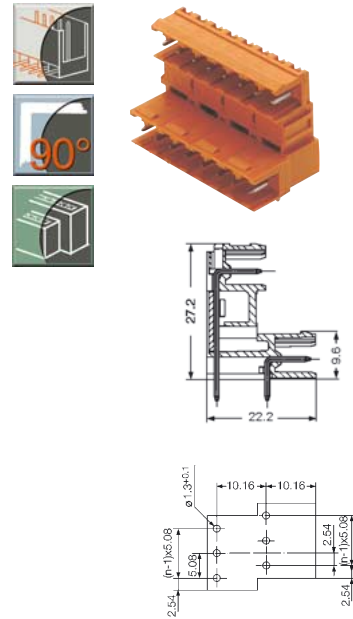

Technical Data		VDE	UL	CSA
Rated voltage	V	250*	300	300
Rated current	A	8	10	7

*Overvoltage category III / Pollution severity 3
Additional technical data see page 227

Solder pin length **3.2 mm** **4.5 mm**

Colour				
Poles	Type	Cat. No.	Cat. No.	Qty.
4	SLAD 4/90	1320060000	1321610000	50
6	SLAD 6/90	1320160000	1321710000	50
8	SLAD 8/90	1372460000	1385510000	50
10	SLAD 10/90	1372560000	1385610000	50
12	SLAD 12/90	1372660000	1385710000	50
14	SLAD 14/90	1372760000	1385810000	50
16	SLAD 16/90	1372860000	1385910000	20
18	SLAD 18/90	1372960000	1386010000	20
20	SLAD 20/90	1373060000	1386110000	20
22	SLAD 22/90	1373160000	1386210000	10
24	SLAD 24/90	1373260000	1386310000	10
26	SLAD 26/90	1373360000	1386410000	10
28	SLAD 28/90	1373460000	1386510000	10
30	SLAD 30/90	1373560000	1386610000	10
32	SLAD 32/90	1373660000	1386710000	10
34	SLAD 34/90	1373760000	1386810000	10
36	SLAD 36/90	1373860000	1386910000	10
38	SLAD 38/90	1373960000	1387010000	10
40	SLAD 40/90	1374060000	1387110000	10
42	SLAD 42/90	1374160000	1387210000	10
44	SLAD 44/90	1374260000	1387310000	10
46	SLAD 46/90	1374360000	1387410000	10
48	SLAD 48/90	1374460000	1387510000	10

Accessories	Page
Fixing	194
Marking	196
Coding	198, 199
Miscellaneous	-

Unimate Range - SLA/BLA



Pin headers SLAD 90B

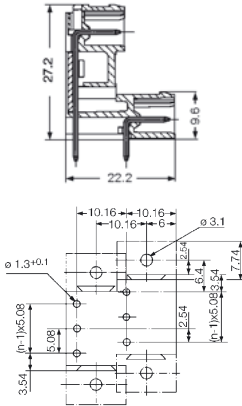
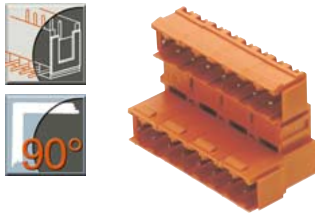

Technical Data		VDE	UL	CSA
Rated voltage	V	250*	300	300
Rated current	A	8	10	7

*Overvoltage category III / Pollution severity 3
Additional technical data see page 227

Solder pin length 3.2 mm 4.5 mm

Colour				Qty.
Poles	Type	Cat. No.	Cat. No.	Qty.
4	SLAD 4/90B	1320660000	1322210000	50
6	SLAD 6/90B	1320760000	1322310000	50
8	SLAD 8/90B	1388560000	1387610000	50
10	SLAD 10/90B	1388660000	1387710000	50
12	SLAD 12/90B	1388760000	1387810000	50
14	SLAD 14/90B	1388860000	1387910000	50
16	SLAD 16/90B	1388960000	1388010000	20
18	SLAD 18/90B	1389060000	1388110000	20
20	SLAD 20/90B	1389160000	1388210000	20
22	SLAD 22/90B	1389260000	1388310000	10
24	SLAD 24/90B	1389360000	1388410000	10
26	SLAD 26/90B	1390660000	1389410000	10
28	SLAD 28/90B	1390760000	1389510000	10
30	SLAD 30/90B	1390860000	1389610000	10
32	SLAD 32/90B	1390960000	1389710000	10
34	SLAD 34/90B	1391060000	1389810000	10
36	SLAD 36/90B	1391160000	1389910000	10
38	SLAD 38/90B	1391260000	1390010000	10
40	SLAD 40/90B	1391360000	1390110000	10
42	SLAD 42/90B	1391460000	1390210000	10
44	SLAD 44/90B	1391560000	1390310000	10
46	SLAD 46/90B	1391660000	1390410000	10
48	SLAD 48/90B	1391760000	1390510000	10

Accessories	Page
Fixing	193
Marking	196
Coding	198, 199
Miscellaneous	-

Pin headers SLAD 180

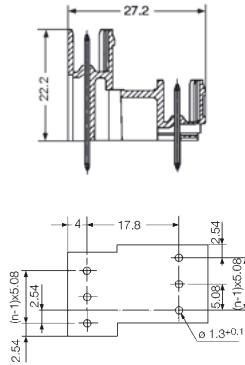
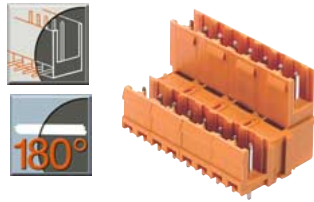

Technical Data		VDE	UL	CSA
Rated voltage	V	250*	300	300
Rated current	A	8	10	7

*Overvoltage category III / Pollution severity 3
Additional technical data see page 227

Solder pin length 3.2 mm 4.5 mm

Colour				Qty.
Poles	Type	Cat. No.	Cat. No.	Qty.
4	SLAD 4/180	1320860000	1322410000	50
6	SLAD 6/180	1320960000	1322510000	50
8	SLAD 8/180	1374560000	1383410000	50
10	SLAD 10/180	1374660000	1383510000	50
12	SLAD 12/180	1374760000	1383610000	50
14	SLAD 14/180	1374860000	1383710000	50
16	SLAD 16/180	1374960000	1383810000	20
18	SLAD 18/180	1375060000	1383910000	20
20	SLAD 20/180	1375160000	1384010000	20
22	SLAD 22/180	1375260000	1384110000	10
24	SLAD 24/180	1375360000	1384210000	10
26	SLAD 26/180	1375460000	1384310000	10
28	SLAD 28/180	1375560000	1384410000	10
30	SLAD 30/180	1375660000	1384510000	10
32	SLAD 32/180	1375760000	1384610000	10
34	SLAD 34/180	1375860000	1384710000	10
36	SLAD 36/180	1375960000	1384810000	10
38	SLAD 38/180	1376060000	1384910000	10
40	SLAD 40/180	1376160000	1385010000	10
42	SLAD 42/180	1376260000	1385110000	10
44	SLAD 44/180	1376360000	1385210000	10
46	SLAD 46/180	1376460000	1385310000	10
48	SLAD 48/180	1376560000	1385410000	10

Accessories	Page
Fixing	193
Marking	196
Coding	198, 199
Miscellaneous	-

Pin headers SLAD 180B

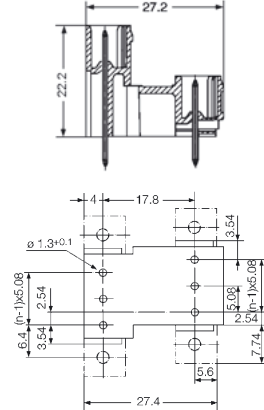
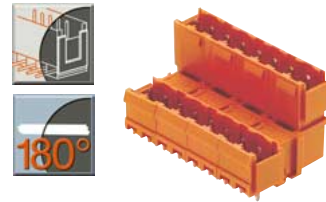

Technical Data		VDE	UL	CSA
Rated voltage	V	250*	300	300
Rated current	A	8	10	7

*Overvoltage category III / Pollution severity 3
Additional technical data see page 227

Solder pin length 3.2 mm 4.5 mm

Colour				Qty.
Poles	Type	Cat. No.	Cat. No.	Qty.
4	SLAD 4/180B	1321460000	1323010000	50
6	SLAD 6/180B	1321560000	1323110000	50
8	SLAD 8/180B	1392760000	1391810000	50
10	SLAD 10/180B	1392860000	1391910000	50
12	SLAD 12/180B	1392960000	1392010000	50
14	SLAD 14/180B	1393060000	1392110000	50
16	SLAD 16/180B	1393160000	1392210000	20
18	SLAD 18/180B	1393260000	1392310000	20
20	SLAD 20/180B	1393360000	1392410000	20
22	SLAD 22/180B	1393460000	1392510000	10
24	SLAD 24/180B	1393560000	1392610000	10
26	SLAD 26/180B	1394860000	1393610000	10
28	SLAD 28/180B	1394960000	1393710000	10
30	SLAD 30/180B	1395060000	1393810000	10
32	SLAD 32/180B	1395160000	1393910000	10
34	SLAD 34/180B	1395260000	1394010000	10
36	SLAD 36/180B	1395360000	1394110000	10
38	SLAD 38/180B	1395460000	1394210000	10
40	SLAD 40/180B	1395560000	1394310000	10
42	SLAD 42/180B	1395660000	1394410000	10
44	SLAD 44/180B	1395760000	1394510000	10
46	SLAD 46/180B	1395860000	1394610000	10
48	SLAD 48/180B	1395960000	1394710000	10

Accessories	Page
Fixing	193
Marking	196
Coding	198, 199
Miscellaneous	-



Socket blocks BLA

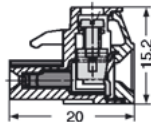
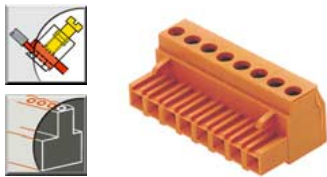

Socket blocks BLA B

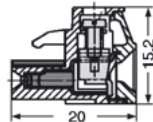
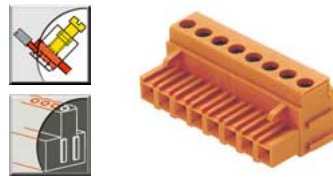

Socket blocks BLAT

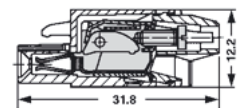
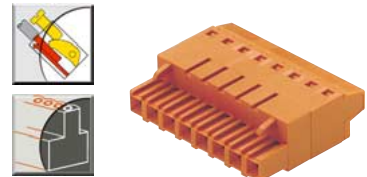

Technical Data		VDE	UL	CSA
Rated voltage	V	250*	300	300
Rated current	A	10	10	10
Clamping range max.	mm ² /AWG	2.5	12	12



*Overvoltage category III / Pollution severity 3
Additional technical data see page 228



Technical Data		VDE	UL	CSA
Rated voltage	V	250*	300	300
Rated current	A	10	10	10
Clamping range max.	mm ² /AWG	2.5	12	12



*Overvoltage category III / Pollution severity 3
Additional technical data see page 228

Technical Data		VDE	UL	CSA
Rated voltage	V	250*	300	300
Rated current	A	10	10	10
Clamping range max.	mm ² /AWG	1.5	12	12

*Overvoltage category III / Pollution severity 3
Additional technical data see page 229

Colour				Qty.
Poles	Type	Cat. No.	Cat. No.	Qty.
2	BLA 2	1281760000	1281710000	100
3	BLA 3	1281860000	1281810000	100
4	BLA 4	1281960000	1281910000	100
5	BLA 5	1282060000	1282010000	50
6	BLA 6	1282160000	1282110000	50
7	BLA 7	1282260000	1282210000	50
8	BLA 8	1282360000	1282310000	50
9	BLA 9	1282460000	1282410000	50
10	BLA 10	1282560000	1282510000	50
11	BLA 11	1282660000	1282610000	50
12	BLA 12	1282760000	1282710000	50
13	BLA 13	1282860000	1282810000	50
14	BLA 14	1282960000	1282910000	50
15	BLA 15	1283060000	1283010000	50
16	BLA 16	1283160000	1283110000	50
17	BLA 17	1283260000	1283210000	20
18	BLA 18	1283360000	1283310000	20
19	BLA 19	1283460000	1283410000	20
20	BLA 20	1283560000	1283510000	20
21	BLA 21	1283660000	1283610000	20
22	BLA 22	1314260000	1314210000	20
23	BLA 23	1314360000	1314310000	20
24	BLA 24	1314460000	1314410000	20

Colour				Qty.
Poles	Type	Cat. No.	Cat. No.	Qty.
2	BLA 2B	1356060000	1356010000	100
3	BLA 3B	1356160000	1356110000	100
4	BLA 4B	1356260000	1356210000	100
5	BLA 5B	1356360000	1356310000	50
6	BLA 6B	1356460000	1356410000	50
7	BLA 7B	1356560000	1356510000	50
8	BLA 8B	1356660000	1356610000	50
9	BLA 9B	1356760000	1356710000	50
10	BLA 10B	1356860000	1356810000	50
11	BLA 11B	1356960000	1356910000	50
12	BLA 12B	1357060000	1357010000	50
13	BLA 13B	1357160000	1357110000	50
14	BLA 14B	1357260000	1357210000	50
15	BLA 15B	1357360000	1357310000	50
16	BLA 16B	1357460000	1357410000	50
17	BLA 17B	1357560000	1357510000	20
18	BLA 18B	1357660000	1357610000	20
19	BLA 19B	1357760000	1357710000	20
20	BLA 20B	1357860000	1357810000	20
21	BLA 21B	1357960000	1357910000	20
22	BLA 22B	1358060000	1358010000	20
23	BLA 23B	1358160000	1358110000	20
24	BLA 24B	1358260000	1358210000	20

Colour				Qty.
Poles	Type	Cat. No.	Cat. No.	Qty.
2	BLAT 2	1484260000	1484210000	100
3	BLAT 3	1484360000	1484310000	100
4	BLAT 4	1484460000	1484410000	100
5	BLAT 5	1484560000	1484510000	50
6	BLAT 6	1484660000	1484610000	50
7	BLAT 7	1484760000	1484710000	50
8	BLAT 8	1484860000	1484810000	50
9	BLAT 9	1484960000	1484910000	50
10	BLAT 10	1485060000	1485010000	50
11	BLAT 11	1485160000	1485110000	50
12	BLAT 12	1485260000	1485210000	50
13	BLAT 13	1485360000	1485310000	50
14	BLAT 14	1485460000	1485410000	50
15	BLAT 15	1485560000	1485510000	50
16	BLAT 16	1485660000	1485610000	50
17	BLAT 17	1485760000	1485710000	20
18	BLAT 18	1485860000	1485810000	20
19	BLAT 19	1485960000	1485910000	20
20	BLAT 20	1486060000	1486010000	20
21	BLAT 21	1486160000	1486110000	20
22	BLAT 22	1486260000	1486210000	20
23	BLAT 23	1486360000	1486310000	20
24	BLAT 24	1486460000	1486410000	20

Accessories	Page
Fixing	-
Marking	196
Coding	199
Miscellaneous	202-207

Accessories	Page
Fixing	193
Marking	196
Coding	199
Miscellaneous	202-207

Accessories	Page
Fixing	-
Marking	196
Coding	199
Miscellaneous	202-207

Unimate Range - SLA/BLA



Socket blocks BLAT B

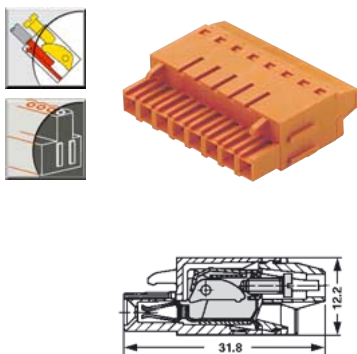

Socket blocks BLAC

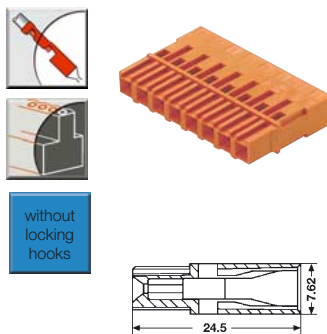

Socket blocks BLAC B

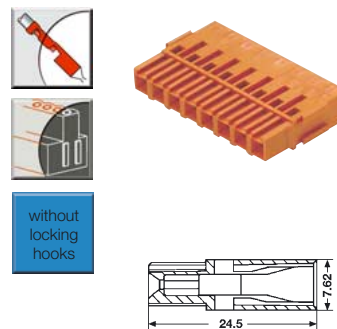

Technical Data		VDE	UL	CSA
Rated voltage	V	250*	300	300
Rated current	A	10	10	10
Clamping range max.	mm ² /AWG	1.5	12	12

*Overvoltage category III / Pollution severity 3

Additional technical data see page 229

Technical Data		VDE	UL	CSA
Rated voltage	V	250*	300	300
Rated current	A	14	10	10
Clamping range max.	mm ² /AWG	2.5	14	14

*Overvoltage category III / Pollution severity 3

Additional technical data see page 228

Technical Data		VDE	UL	CSA
Rated voltage	V	250*	300	300
Rated current	A	14	10	10
Clamping range max.	mm ² /AWG	2.5	14	14

*Overvoltage category III / Pollution severity 3

Additional technical data see page 228

Colour

Poles	Type	Cat. No.	Cat. No.	Qty.
2	BLAT 2B	1486560000	1486510000	100
3	BLAT 3B	1486660000	1486610000	100
4	BLAT 4B	1486760000	1486710000	100
5	BLAT 5B	1486860000	1486810000	50
6	BLAT 6B	1486960000	1486910000	50
7	BLAT 7B	1487060000	1487010000	50
8	BLAT 8B	1487160000	1487110000	50
9	BLAT 9B	1487260000	1487210000	50
10	BLAT 10B	1487360000	1487310000	50
11	BLAT 11B	1487460000	1487410000	50
12	BLAT 12B	1487560000	1487510000	50
13	BLAT 13B	1487660000	1487610000	50
14	BLAT 14B	1487760000	1487710000	50
15	BLAT 15B	1487860000	1487810000	50
16	BLAT 16B	1487960000	1487910000	50
17	BLAT 17B	1488060000	1488010000	20
18	BLAT 18B	1488160000	1488110000	20
19	BLAT 19B	1488260000	1488210000	20
20	BLAT 20B	1488360000	1488310000	20
21	BLAT 21B	1488460000	1488410000	20
22	BLAT 22B	1488560000	1488510000	20
23	BLAT 23B	1488660000	1488610000	20
24	BLAT 24B	1488760000	1488710000	20

Colour

Poles	Type	Cat. No.	Qty.
2	BLAC 2	1578200000	100
3	BLAC 3	1476160000	100
4	BLAC 4	1476260000	100
5	BLAC 5	1577520000	50
6	BLAC 6	1476360000	50
7	BLAC 7	1577530000	50
8	BLAC 8	1476460000	50
9	BLAC 9	1577540000	50
10	BLAC 10	1476560000	50
11	BLAC 11	1577550000	50
12	BLAC 12	1476660000	50
13	BLAC 13	1601040000	50
14	BLAC 14	1594140000	50
15	BLAC 15	1601050000	50
16	BLAC 16	1476760000	50
17	BLAC 17	1601060000	20
18	BLAC 18	1601070000	20
19	BLAC 19	1601080000	20
20	BLAC 20	1476860000	20
21	BLAC 21	1601090000	20
22	BLAC 22	1601100000	20
23	BLAC 23	1601110000	20
24	BLAC 24	1476960000	20

Colour

Poles	Type	Cat. No.	Qty.
2	BLAC 2B	1578210000	100
3	BLAC 3B	1477060000	100
4	BLAC 4B	1477160000	100
5	BLAC 5B	1577440000	50
6	BLAC 6B	1477260000	50
7	BLAC 7B	1577450000	50
8	BLAC 8B	1477360000	50
9	BLAC 9B	1577460000	50
10	BLAC 10B	1477460000	50
11	BLAC 11B	1577470000	50
12	BLAC 12B	1477560000	50
13	BLAC 13B	1601200000	50
14	BLAC 14B	1594150000	50
15	BLAC 15B	1601210000	50
16	BLAC 16B	1477660000	50
17	BLAC 17B	1601220000	20
18	BLAC 18B	1601230000	20
19	BLAC 19B	1601240000	20
20	BLAC 20B	1477760000	20
21	BLAC 21B	1601250000	20
22	BLAC 22B	1601260000	20
23	BLAC 23B	1601270000	20
24	BLAC 24B	1477860000	20

Accessories	Page
Fixing	193
Marking	196
Coding	199
Miscellaneous	202-207

Accessories	Page
Fixing	-
Marking	196
Coding	199
Miscellaneous	202-207

Accessories	Page
Fixing	193
Marking	196
Coding	199
Miscellaneous	202-207



Socket blocks BLAC R

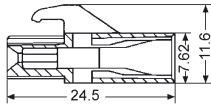
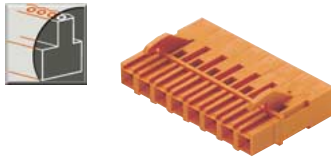

Socket blocks BLAC BR

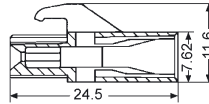
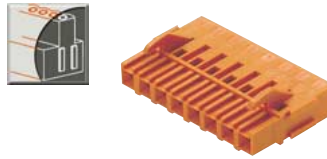

Crimp contacts for BLAC 5.08



A variety of crimp contacts are available for the use with the socket block BLAC 5.08 to match the specific application.

Technical Data		VDE	UL	CSA
Rated voltage	V	250*	300	300
Rated current	A	14	10	10
Clamping range max.	mm ² /AWG	2.5	14	14

*Overvoltage category III / Pollution severity 3

Additional technical data see page 228

Technical Data		VDE	UL	CSA
Rated voltage	V	250*	300	300
Rated current	A	14	10	10
Clamping range max.	mm ² /AWG	2.5	14	14

*Overvoltage category III / Pollution severity 3

Additional technical data see page 228

Colour

Poles	Type	Cat. No.	Qty.
2	BLAC 2R	1578220000	100
3	BLAC 3R	1477960000	100
4	BLAC 4R	1478060000	100
5	BLAC 5R	1577480000	50
6	BLAC 6R	1478160000	50
7	BLAC 7R	1577490000	50
8	BLAC 8R	1478260000	50
9	BLAC 9R	1577500000	50
10	BLAC 10R	1478360000	50
11	BLAC 11R	1577510000	50
12	BLAC 12R	1478460000	50
13	BLAC 13R	1601120000	50
14	BLAC 14R	1594160000	50
15	BLAC 15R	1601130000	50
16	BLAC 16R	1478560000	50
17	BLAC 17R	1601140000	20
18	BLAC 18R	1601150000	20
19	BLAC 19R	1601160000	20
20	BLAC 20R	1478660000	20
21	BLAC 21R	1601170000	20
22	BLAC 22R	1601180000	20
23	BLAC 23R	1601190000	20
24	BLAC 24R	1478760000	20

Colour

Poles	Type	Cat. No.	Qty.
2	BLAC 2BR	1578230000	100
3	BLAC 3BR	1478860000	100
4	BLAC 4BR	1478960000	100
5	BLAC 5BR	1444160000	50
6	BLAC 6BR	1479060000	50
7	BLAC 7BR	1577430000	50
8	BLAC 8BR	1479160000	50
9	BLAC 9BR	1577420000	50
10	BLAC 10BR	1479260000	50
11	BLAC 11BR	1577410000	50
12	BLAC 12BR	1479360000	50
13	BLAC 13BR	1601280000	50
14	BLAC 14BR	1594170000	50
15	BLAC 15BR	1601290000	50
16	BLAC 16BR	1479460000	50
17	BLAC 17BR	1601300000	20
18	BLAC 18BR	1601310000	20
19	BLAC 19BR	1601320000	20
20	BLAC 20BR	1479560000	20
21	BLAC 21BR	1601330000	20
22	BLAC 22BR	1601340000	20
23	BLAC 23BR	1601350000	20
24	BLAC 24BR	1479660000	20

Single contacts, tin-plated	for conductor	Cat. No.	Qty.
DFFC 0.22-0.35 SN E	0.22-0.35 mm ²	1604250000	250
DFFC 0.5-1.0 SN E	0.5-1.0 mm ²	1567060000	250
DFFC 1.5-2.5 SN E	1.5-2.5 mm ²	1567070000	250

Bandolier, tin-plated	for conductor	Cat. No.	Qty.
DFFC 0.22-0.35 SN R	0.22-0.35 mm ²	1604230000	3000
DFFC 0.5-1.0 SN R	0.5-1.0 mm ²	1480000000	3000
DFFC 1.5-2.5 SN R	1.5-2.5 mm ²	1480100000	2500

Accessories	Page
Fixing	-
Marking	196
Coding	199
Miscellaneous	202-207

Accessories	Page
Fixing	193
Marking	196
Coding	199
Miscellaneous	202-207

