



## LEVER-NUTS™

- 222 Series Compact Lever-Operated Connectors with CAGE CLAMP®, for Solid and Stranded Wire

# 222 Series

## 2, 3 or 5 Conductor Compact Connector

Cross section:	28 – 12 AWG (stranded and solid)
Electrical specs:	600 V (1000 V signs and fixtures) 20 A maximum
Strip length: 	9 - 10 mm / 0.37 in
Maximum operating temperature:	105° C



For all connections requiring...

- Stranded / solid wires
- Wide range of wire sizes
- Combination of different wire sizes and types in one connector
- Small space consumption
- Built-in test point
- Protection against electrical shock, touch safe
- Low installed cost and safe operation
- Maintenance-free connection
- A reusable connector



Item No.	Pack.-unit pcs	Item No.	Pack.-unit pcs	Item No.	Pack.-unit pcs
<b>222-412</b>		<b>222-413</b>		<b>222-415</b>	
<b>222-412/K194-4045</b>	100 pc box (1=100)	<b>222-413/K194-4045</b>	50 pc box (1=50)	<b>222-415/K194-4045</b>	40 pc box (1=40)
<b>222-412/PW05-0005</b>	5 pc blister pack	<b>222-413/PW05-0005</b>	5 pc blister pack	<b>222-415/PW05-0005</b>	5 pc blister pack
		<b>222-413/VE00-2500</b>	2,500 pc bulk bag		

### Technical Data

Approvals			
Number of connection points per connector	2	3	5
Potentials per connector	1	1	1
Connection type	CAGE CLAMP® Spring pressure connection technology	CAGE CLAMP® Spring pressure connection technology	CAGE CLAMP® Spring pressure connection technology
Height	14.5 mm/0.571 in	14.5 mm/0.571 in	14.5 mm/0.571 in
Width	12.4 mm/0.488 in	17 mm/0.669 in	26.6 mm/1.047 in
Depth	20.5 mm/0.807 in	20.5 mm/0.807 in	20.5 mm/0.807 in
Color	Gray (w/ orange levers)	Gray (w/ orange levers)	Gray (w/ orange levers)

### Accessories

Item No.	Pack.-unit pcs
<b>206-130</b>	1
<b>210-101</b>	1



Operating Tool

### Easy as 1, 2, 3...

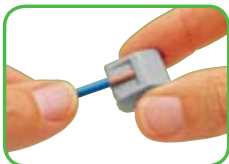

1) Strip wire

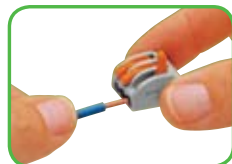

2) Push up lever

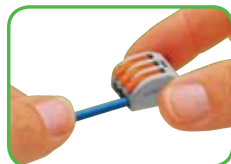

3) Insert conductor and push down lever

# 222 Series Mounting Carrier

<p>Mounting carrier for 222 Series compact connectors</p> <p>Accommodates:</p> <p>2 x 222-415      1 x 222-415 + 1 x 222-413</p> <p>3 x 222-413      1 x 222-415 + 2 x 222-412</p> <p>4 x 222-412      3 x 222-412 + 1 x 222-413</p>	<p>Strain relief plate for 222-500 mounting carrier</p>	<p>Universal right angled adapter for 222-500 mounting carrier</p> <p>773-332 mounting carrier</p> <p>273-150 mounting carrier</p>
--	---	--



Item No.	Pack.-unit pcs	Item No.	Pack.-unit pcs	Item No.	Pack.-unit pcs
<b>Mounting carrier</b> , orange, for 2-, 3- or 5-pole compact connectors		<b>Strain relief plate</b> , orange, for snap-on fixing to 222-500 mounting carrier		<b>Universal right angled adapter</b> , gray, in combination with mounting carriers for DIN 35 rail mounting	
<b>222-500</b>	50 (5x10)	<b>222-505</b>	50 (5x10)	<b>222-510</b>	50 (5x10)
Self-adhesive marker strips, plain	<b>210-334</b>				
	1 card				

## Assembly



Snapping of lateral connector safety lock.

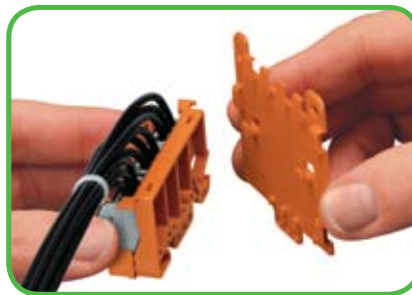

Mounting of strain relief plate to the mounting carrier.

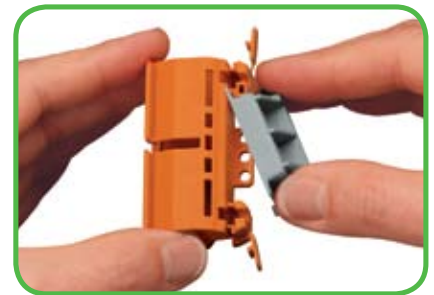

Snapping the universal right angled carrier on the mounting carrier.

## Mounting

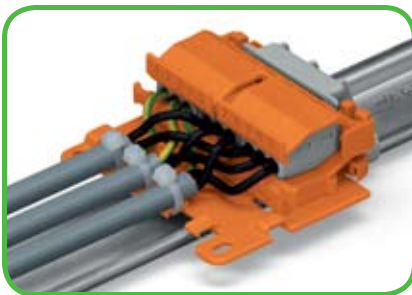

Horizontal mounting with strain relief plate on DIN 35 rail using universal right angled adapter.



Strain relief by cable tie on the carrier, transverse to the connectors wiring direction. Molded marking of clamping units.



Horizontal mounting with strain relief plate on level surfaces. Testing connectors via test slots in the carrier.

## WAGO Service Worldwide

### Germany

WAGO Kontakttechnik  
Minden  
Tel. ++0571/887-443  
Fax ++0571/887-541

### Austria

WAGO Kontakttechnik  
GmbH Vienna  
Tel. ++43/1/615 07 80  
Fax ++43/1/615 07 75

### Belgium

WAGO Kontakttechnik  
Zaventem  
Tel. ++32/2/7 17 90 90  
Fax ++32/2/7 17 90 99

### China

WAGO ELECTRONIC Co. Ltd.  
Tianjin  
Tel.  
++86/22/82125854/64/74  
Fax ++86/22/82125984

### England

WAGO, Ltd.  
Rugby  
Tel. ++44/1788/568008  
Fax ++44/1788/568050

### France

WAGO CONTACT SA.  
Paris  
Tel. ++33/148172590  
Fax ++33/148632520

### Italy

WAGO ELETTRONICA SRL  
San Lazzaro di Savena (BO)  
Tel. ++39/051/625-91-25  
Fax ++39/051/625-91-27

### Japan

WAGO Co. of JAPAN Ltd.  
Tokyo  
Tel. ++81/3/3254/8881  
Fax ++81/3/3254/8885

### Poland

WAGO ELWAG sp. z o. o.  
Wroclaw  
Tel. ++48/71/33-66-626  
Fax ++48/71/33-60-952

### Singapore

WAGO Electronic Pte. Ltd.  
Singapur  
Tel. ++65/2866776  
Fax ++65/2842425

### Switzerland

WAGO CONTACT SA  
Domdidier  
Tel. ++65/2866776  
Fax ++65/2842425

### Mexico

WAGO Corporation  
Tel. 001-800-309-5975  
+ 52-(55)-26-44-69-16  
Fax + 52-(55)-26-44-69-15

### Canada

WAGO Corporation  
Tel. 800 / DIN Rail (346-7245)  
Fax 262 / 255-3232

WAGO Corporation  
N120 W19129 Freistadt Road  
Germantown, Wisconsin 53022  
Telephone: 800 / DIN Rail (346-7245)  
Fax: 262 / 255-3232  
info.us@wago.com  
www.wago.us

