

Blackburn®

Cross Tap Clamps

MECHANICAL CONNECTORS

Type XT— Clamp for Tee Tap, Cross, Parallel and End-to-End Connectors

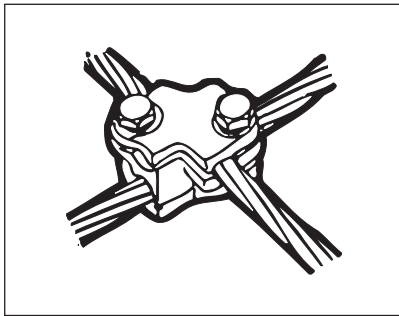

- A multi-purpose connector; castings of copper alloy; bolts of silicon bronze
- Design allows for free wrench rotation which speeds installation
- For tin-plated style add suffix P to Cat. Number—e.g. XT12P

Cat. No.	Conductor Range (AWG or KCMIL)				Conductor Diameter				Dim. (in.)			Bolt Size
	Main		Tap		A		B		L	H	W	
	max.	min.	max.	min.	max.	min.	max.	min.				
XT12	4/0 str.	1 str.	2 str.	6 sol.	.528	.328	.292	.162	1½	1⅞	1½	⅝
XT13	4/0 str.	1 str.	4/0 str.	1 str.	.528	.328	.528	.328	1⅞	2	1⅞	⅝
XT21	500 KCMIL	250 KCMIL	2 str.	6 sol.	.813	.574	.292	.162	2⅞	2⅞	1⅞	⅝
XT22	500 KCMIL	250 KCMIL	4/0 str.	1 str.	.813	.574	.528	.328	2⅞	2⅞	2⅞	⅝
XT23*	500 KCMIL	250 KCMIL	500 KCMIL	250 KCMIL	.813	.574	.813	.574	2⅞	2⅞	2⅞	⅝
XT33*	1000 KCMIL	500 KCMIL	500 KCMIL	250 KCMIL	1.152	.811	.813	.574	2¼	3	2⅞	⅝
XT34*	1000 KCMIL	500 KCMIL	1000 KCMIL	500 KCMIL	1.152	.811	1.152	.811	2⅞	3⅞	2⅞	⅞

* 4 bolt clamps

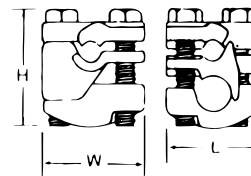

Blackburn®

Dead-End Clamps

Type DLC—Single U Bolt Aluminum Fittings

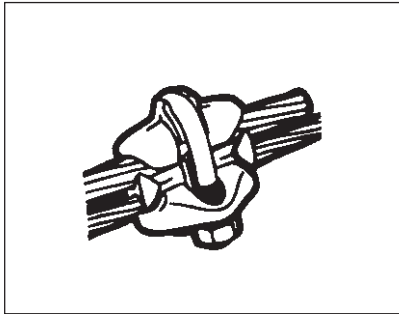

- Top and bottom pressure pads cast of high strength, heat treated, aluminum silicon alloy
- Extra long separating spacer of highly conductive aluminum; spacer interlocks with U bolt—will not drop out
- Spring action counteracts cold flow
- No special tools required for installation
- Suitable for deadend loop connections
- Hardware of high-strength galvanized steel
- For use on copper, aluminum and ACSR conductors
- Order pre-filled with oxide inhibitor (suffix 9) for use on aluminum to copper

Cat. No.	Conductor Range				Conductor Diameter				Dimensions (in.)				
	ACSR		AWG or KCMIL		A		B		W	L	H	F	E
	Main	Tap	Main	Tap	max.	min.	max.	min.					
DLC2106 [†]	2/0—6	2/0—6	2/0 str.—6 sol.	2/0 str.—6 sol.	.447	.162	.447	.162	1 ¹ / ₈	1 ¹ / ₂	3 ³ / ₄	⁹ / ₁₆	³ / ₈
DLC23 [†]	4/0—1 2—6 AR	4/0—1/0	266.8—1/0 str.	266.8—1/0 str.	.563	.368	.609	.368	2 ³ / ₈	2 ³ / ₈	4	¹ / ₄	¹ / ₂
DLC25	336.4—1/0 1/0—6 AR	336.4—1/0 1/0—6 AR	397.5—1/0 str.	397.5—1/0 str.	.684	.368	.743	.368	2 ³ / ₈	3 ³ / ₁₆	4	¹ / ₄	¹ / ₂

[†] RUS listed

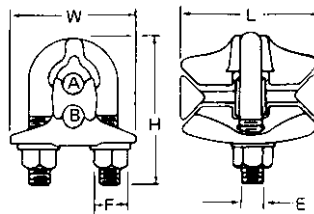

Blackburn® Hot Line Clamps



MECHANICAL CONNECTORS

Type HLC—Hot Line Clamps (Protected Thread)

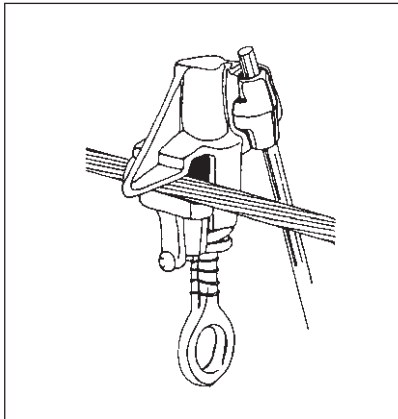

- Eye-bolt coated with high temperature grease, assuring easy turning in all weather conditions
- Available prefilled with oxide-inhibiting Contax and individually packaged; add suffix 9 to Cat. Number
- HLC2108 Series is for 2/0—8 main line conductor
- HLC3974 Series is for 397.5 KCMIL—6 main line conductor

Cat. No.	For Wire Combination	Conductor Range			
		Main		Tap	
		ACSR	AWG or KCMIL	ACSR	AWG
Bronze Body HLC2108*	Copper to Copper	—	2/0—8	—	2/0
Plated Bronze Body HLC2108P	General Purpose	2/0—6	2/0—8	2/0—6	2/0—8
Plated Aluminum Body HLC2108AP9	General Purpose	2/0—6	2/0—8	2/0—6	2/0—8
Bronze Body HLC3974	Copper to Copper	—	400—6 sol.	—	4/0—6 sol.
Plated Bronze Body HLC3974P	General Purpose	—	400—6 sol.	3/0—6	4/0—6 sol.
Plated Aluminum Body HLC3974AP	General Purpose	397.5—6	400—6 sol.	3/0—6	4/0—6 sol.

* RUS Listed.

Blackburn®

Hot Line Clamps

Type PGH—Center Bolt Parallel Groove Hot Tap Clamps

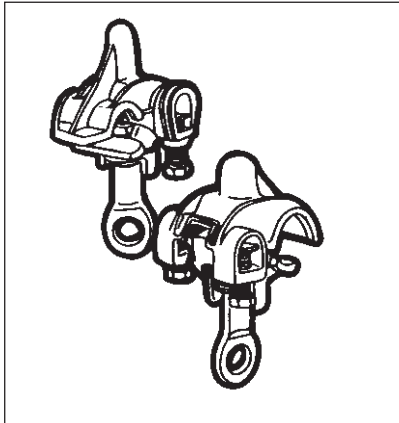

- Incorporates the superior design features of parallel groove clamps, time-proven for their reliable performance
- Protected threads; wide temperature range lubricant prevents seizing
- Tap wire positively secured to clamp during installation and removal by hex head bolt and pressure pad; main and tap clamped securely as clamp is tightened
- Available prefilled with Contax, add suffix 9
- Copper clamps are for use on copper conductors only

Cat. No.	Std.	Pre-filled	Conductor Range				Conductor Diameter				Center Bolts No. Dia.	Fig.	Dimensions (in.)			
			Main		Tap		Main		Tap				W	H	L	
			ACSR	AWG	ACSR	AWG	max.	min.	max.	min.						
Aluminum Clamps																
PGH29			2/0—8	2/0 str.—8 sol.	1/0—8	1/0 str.—8 sol.	.447	.128	.398	.128	1	½	1	2⅝	5¼	2¾
PGH4	PGH49		397.5—6 2/0—6 AR	450—4 sol.	3/0—6	4/0 str.—6 sol.	.781	.198	.528	.162	1	½	1	3⅝	6⅞	2⅞
	PGH69		874—4/0 397.5⅞—2 AR	1000—4/0 str.	266—6	300—6 sol.	1.152	.522	.657	.162	2	½	2	4	6¾	4¼
	PGH6129*		874—4/0 397.5⅞—2 AR	1000—4/0 str.	266—6	300—6 sol.	1.152	.522	.657	.162	1	½	3	3⅝	6¾	3⅞
Copper Clamps																
PGH3	PGH39		—	2/0 str.—8 sol.	—	2/0 str.—8 sol.	.419	.419	.128	.128	1	⅞	1	2⅝	5¼	1¼

* PGH6129 has two hex head bolt and pressure pad tap conductor retainers.
AR—with Armor Rod.

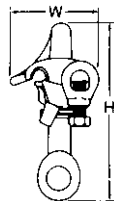

Fig. 1

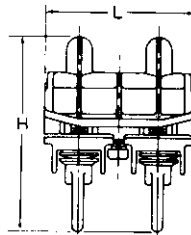

Fig. 2

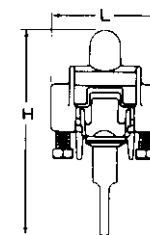
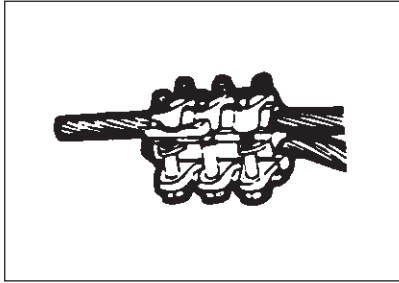

Fig. 3

Blackburn® Multi-Bolt Connectors

MECHANICAL CONNECTORS

Types 4B, 6B—One Piece Multi-Bolt Connectors



- Cap and pressure plate of cast aluminum alloy; spacer of high conductivity aluminum
- High strength aluminum alloy bolts and lock washers prevent seizing
- One piece construction eliminates loose parts during installation

- For use on copper, aluminum and ACSR conductors
- Factory filled with Contax oxide inhibitor

Cat. No.	Conductor Range				Conductor Diameter				Dimensions (in.)						No. of Bolts
	ACSR		AWG or KCMIL		A		B		W	F	H	T	L	E	
	Main	Tap	Main	Tap	max.	min.	max.	min.							
4B29	4/0—4	4/0—4	250—2 str.	250—2 sol.	.575	.250	.575	.250	2 ⁵ / ₁₆	5/8	3 ³ / ₁₆	1 ¹ / ₃₂	3 ³ / ₄	7/16	4
4B49	397.5—1/0	397.5—1/0	477—1/0 str.	477—1/0 str.	.795	.368	.795	.368	2 ³ / ₄	3/4	4 ³ / ₁₆	1 ⁹ / ₃₂	4 ³ / ₄	1/2	4
6B89	795—300	795—300	800—350	800—336.4	1.108	.679	1.108	.679	3 ¹ / ₂	1 ⁵ / ₁₆	5 ⁵ / ₆₄	7/16	6 ³ / ₄	5/8	6

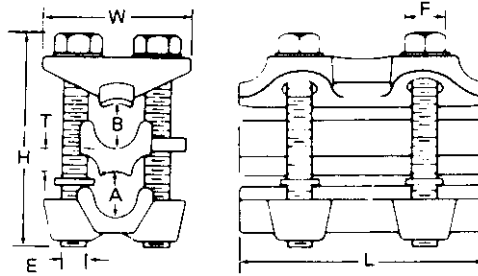

Blackburn®

AMT Connectors



AMT Connectors



The high quality and built-in flexibility of the new Blackburn® AMT Connectors reduce the cost of field installations on splices, taps, and terminations. They're easy and quick to install, and provide superior insulation that lasts the life of the connection.

Features and Benefits:

- PVC insulation eliminates insulation failures and reduces outage costs
- UV resistant material
- Compact design provides space efficiencies
- UL Listed.



Cat. No.	Description	Fig.	UPC	Std. Ctn.
AMTD50066	Insulated Six Hole Both Sides For 500-#6 AWG	5	783786-25947	10
AMTD50065	Insulated Five Hole Both Sides For 500-#6 AWG	5	783786-25946	10
AMTD50064	Insulated Four Hole Both Sides For 500-#6 AWG	5	783786-25945	10
AMTD50063	Insulated Three Hole Both Sides For 500-#6 AWG	5	783786-25944	10
AMT500	Insulated Two Hole Same Side For 500-#6 AWG	2	783786-25925	25
AMTD350106	Insulated Six Hole Both Sides For 350-#10 AWG	5	783786-25943	10
AMTD350105	Insulated Five Hole Both Sides For 350-#10 AWG	5	783786-25942	10
AMTD350104	Insulated Four Hole Both Sides For 350-#10 AWG	5	783786-25941	25
AMTD350103	Insulated Three Hole Both Sides For 350-#10 AWG	5	783786-25940	25
AMTS350106	Insulated Six Hole Same Side For 350-#10 AWG	4	783786-25937	10
AMTS350105	Insulated Five Hole Same Side For 350-#10 AWG	4	783786-25936	10
AMTS350104	Insulated Four Hole Same Side For 350-#10 AWG	4	783786-25935	25
AMTS350103	Insulated Three Hole Same Side For 350-#10 AWG	4	783786-25934	25
AMT350	Insulated Two Hole Same Side For 350-#10 AWG	2	783786-25924	25
AMTS250108	Insulated Eight Hole Same Side For 250-#10 AWG	4	783786-25933	10
AMTD250106	Insulated Six Hole Both Sides For 250-#10 AWG	5	783786-25939	10
AMTD250105	Insulated Five Hole Both Sides For 250-#10 AWG	5	783786-25938	10
AMTD250104	Insulated Four Hole Both Sides For 250-#10 AWG	5	783786-25927	25
AMTD250103	Insulated Three Hole Both Sides For 250-#10 AWG	5	783786-25926	25
AMTT250	Insulated Two Hole Opposite Sides for 250-#10 AWG	3	783786-25923	25
AMT250	Insulated Two Hole Same Side for 250-#10 AWG	2	783786-25922	25
AMTS414	Insulated Four Hole Same Side for #4-#14 AWG	4	783786-25932	25
AMTTC4	Insulated Two Hole Opposite Sides for #4-#14 AWG	3	783786-25919	25
AMTC4	Insulated Two Hole Same Side for #4-#14 AWG	2	783786-25917	25
AMTT20	Insulated Two Hole Opposite Sides for 2/0-#14 AWG	3	783786-25921	25
AMT20	Insulated Two Hole Same Side for 2/0-#14 AWG	2	783786-25920	25
AMTSR500	Insulated Aluminum Splice 500-#10 AWG	1	783786-25931	25
AMTSR350	Insulated Aluminum Splice 350-#6 AWG	1	783786-25930	25
AMTSR250	Insulated Aluminum Splice 250-#6 AWG	1	783786-25929	25
AMTSR10	Insulated Aluminum Splice 1/0-#14 AWG	1	783786-25928	25

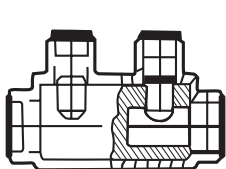

Fig. 1

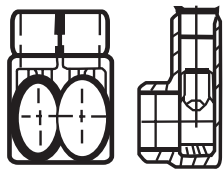

Fig. 2

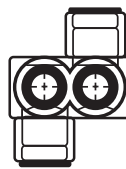

Fig. 3

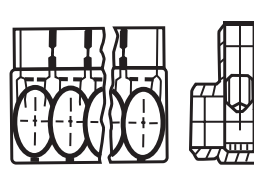

Fig. 4

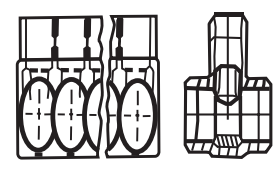
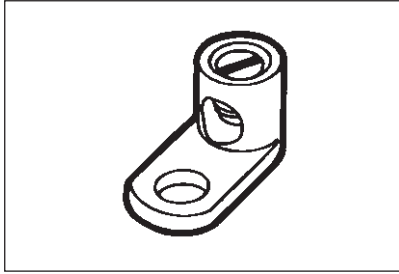

Fig. 5

Blackburn® Copper Mechanical Connectors

MECHANICAL CONNECTORS



Copper Mechanical Connectors

- For copper conductors
- Screws are plated steel
- Compact design
- Add suffix P to cat. number for tin plating
- One-piece construction for strength and durability
- Excellent for confined quarters
- Cat. Nos. L400 and L650 are cast from high strength bronze alloy
- Cat. Nos. L35, L70, L125 and L250 are cold forged from pure electrolytic copper with 99% conductivity

Type L—Single Conductor, One Hole Mount



Cat. No.		Conductor Range		Dimensions (in.)							
Socket	Hex	max.	min.	L	W	H	F	D	J	E	G
L35*	—	8 str.	14 sol.	1 ³ / ₁₆	3 ⁷ / ₈	3 ⁷ / ₈	3 ³ / ₃₂	1 ³ / ₆₄	1 ¹ / ₆₄	1 ³ / ₆₄	1 ¹ / ₂
L70*	—	4 str.	14 sol.	1 ¹ / ₈	1 ⁷ / ₃₂	3 ⁵ / ₆₄	3 ³ / ₃₂	9 ³ / ₃₂	9 ³ / ₃₂	9 ³ / ₃₂	2 ¹ / ₃₂
L125	L125H	1/0 str.	8 sol.	1 ¹ / ₂	4 ⁷ / ₆₄	3 ³ / ₄	3 ³ / ₃₂	3 ³ / ₈	2 ⁷ / ₆₄	2 ¹ / ₆₄	2 ⁷ / ₃₂
L250	L250H	250 KCMIL	6 str.	1 ⁶ / ₆₄	1 ⁵ / ₁₆	1 ¹ / ₁₆	1 ¹ / ₈	2 ⁹ / ₆₄	5 ⁵ / ₈	1 ³ / ₃₂	1 ³ / ₃₂
L400BB	L400H	500 KCMIL	4/0 str.	3	1 ¹³ / ₃₂	1 ¹⁵ / ₃₂	9 ³ / ₃₂	5 ⁵ / ₈	7 ⁷ / ₈	9 ¹ / ₁₆	1 ⁵ / ₈
L650	L650H	1000 KCMIL	500 KCMIL	4	2	2 ³ / ₁₆	1 ⁷ / ₃₂	3 ³ / ₄	1 ¹ / ₄	9 ¹ / ₁₆	2

* Sizes L35 and L70 have screwdriver slot head screws only.
U.L. 486A

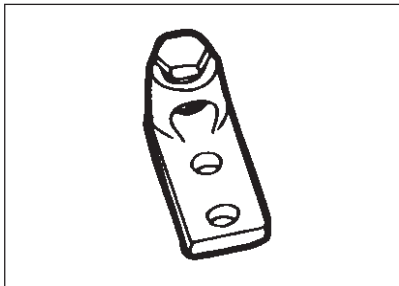
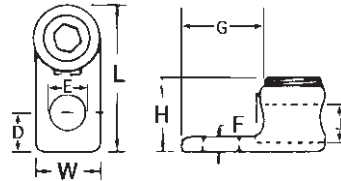

- Cast from high strength bronze alloy
- For use where large contact area is required to provide a more secure mounting

Type L—Single Conductor, Two Hole Mount



Cat. No.		Conductor Range		Dimensions (in.)								
Socket	Hex	max.	min.	L	W	H	F	D	K	E	G	J
L1252	L1252H	1/0 str.	4 str.	2 ¹⁹ / ₁₆	2 ⁵ / ₃₂	1 ³ / ₁₆	3 ¹ / ₁₆	7 ¹ / ₁₆	1	1 ¹ / ₃₂	2	2 ⁷ / ₆₄
L2502	L2502H	250 KCMIL	1/0 str.	3	1 ¹ / ₁₆	1 ¹ / ₃₂	1 ⁵ / ₆₄	7 ¹ / ₁₆	1	1 ¹³ / ₃₂	1 ⁷ / ₈	5 ⁵ / ₈
L4002	L4002H	500 KCMIL	4/0 str.	3 ³ / ₈	1 ¹³ / ₃₂	1 ¹⁵ / ₃₂	5 ¹ / ₁₆	7 ¹ / ₁₆	1	1 ¹³ / ₃₂	1 ¹⁵ / ₁₆	5 ⁷ / ₆₄
L6502	L6502H	1000 KCMIL	500 KCMIL	4 ¹ / ₁₆	2	2	3 ³ / ₈	9 ¹ / ₁₆	1 ¹ / ₂	9 ¹ / ₁₆	2 ³ / ₄	1 ¹ / ₄

U.L. 486A

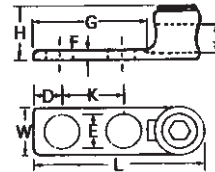

Blackburn®

Copper Mechanical Connectors



Type TL—Two Conductor, Two Hole Mount

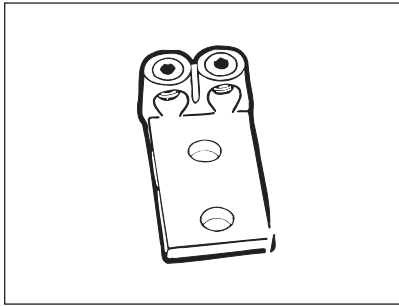

• Conveniently terminates parallel conductors

Cat. No.		Conductor Range		Dimensions (in.)								
Socket	Hex	max.	min.	L	W	H	F	D	K	E	G	J
TL250	TL250H	250 KCMIL	1/0 str.	4 ⁵ / ₁₆	1 ⁷ / ₈	³ / ₃₂	⁵ / ₈	1 ³ / ₄	⁹ / ₁₆	1 ¹ / ₁₆	3 ³ / ₁₆	⁵ / ₈
TL400	TL400H	500 KCMIL	4/0 str.	4 ³ / ₄	2 ³ / ₁₆	¹ / ₃₂	1 ¹ / ₁₆	1 ³ / ₄	⁹ / ₁₆	1 ⁹ / ₁₆	3	⁷ / ₈
TL650	TL650H	1000 KCMIL	500 KCMIL	5 ⁵ / ₁₆	3 ³ / ₄	⁹ / ₁₆	⁵ / ₈	1 ³ / ₄	⁹ / ₁₆	2 ² / ₁₆	3 ³ / ₈	1 ¹ / ₄

Four hole NEMA tang on TL650.
U.L. 486A

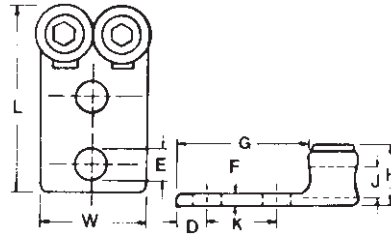

Type S—Copper End-to-End Splice Connector

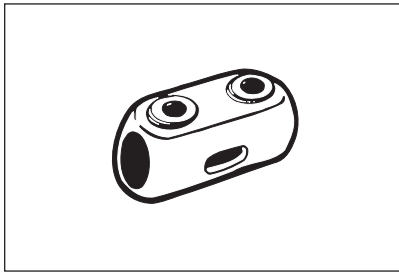

• Cast of high strength copper alloy
• Plated steel socket head set screws

Cat. No.	Conductor Range		Dimensions (in.)				
	max.	min.	L	W	H	J	I
S100BB	1 str.	4 sol.	1 ¹¹ / ₁₆	⁵ / ₈	1 ¹¹ / ₁₆	³ / ₈	¹⁵ / ₁₆
S225BB*	4/0 str.	1 str.	2 ³ / ₁₆	² / ₃₂	³ / ₃₂	⁹ / ₁₆	1 ³ / ₁₆
S400BB	500 KCMIL	4/0 str.	2 ⁷ / ₈	1 ¹ / ₁₆	1 ¹ / ₁₆	⁷ / ₈	1 ⁵ / ₈

* Not U.L. Listed.

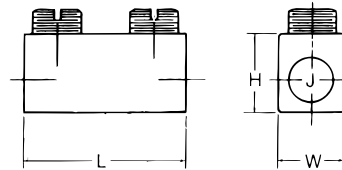

Blackburn® Copper Mechanical Connectors

MECHANICAL CONNECTORS

Type STC—Copper Single Conductor, One Hole Mount (Straight Tang)

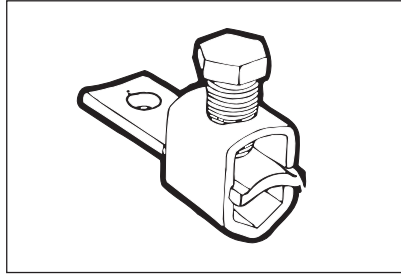

- Uniquely designed pressure bar and notched v-bottom collar provide a vise-like grip between conductor and terminal
- U.L. 486A tested for copper conductor
- Made of electrolytic seamless copper
- Screws are zinc plated steel

Cat. No.	Fig. No.	Conductor Range		Dimensions (in.)						
		max.	min.	L	W	H	F	E	D	
STC1014*	1	10 AWG	14 AWG	1	5/16	1/2	5/64	5/32	3/16	
STC0614	2	6 str.	14 AWG	1 3/64	3/8	1 1/16	5/64	13/64	7/32	
STC0414	2	4 str.	14 AWG	1 1/4	1/2	2 1/32	3/32	17/64	1/4	
STC0208	3	2 str.	8 str.	1 15/32	1/2	3 1/32	3/32	17/64	1/4	
STC1102	3	1/0 str.	2 str.	1 15/16	5/8	1 1/4	1/8	17/64	7/16	
STC3104	3	3/0 str.	4 str.	2 1/4	3/4	1 9/16	1/8	13/32	7/16	
STC4102	3	4/0 str.	2 str.	2 3/8	1	1 21/32	1/8	11/32	1/2	
STC3511	3	350 KCMIL	1/0 str.	3 1/4	1	1 7/8	3/16	13/32	5/8	
STC5011	3	500 KCMIL	1/0 str.	3 3/8	1 1/2	1 13/16	3/16	13/32	15/16	
STC9960	3	1000 KCMIL	600 KCMIL	5	2	2 5/8	1/4	17/32	1 1/8	

* Not CSA Listed.

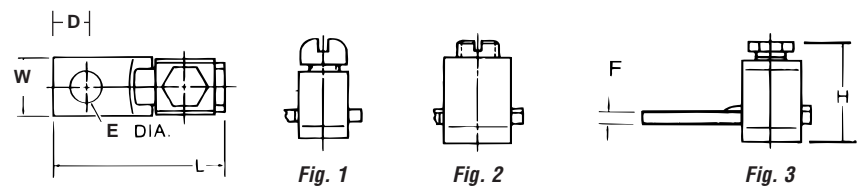

Type BTC—Copper Single Conductor, One Hole Mount (Offset Tang)

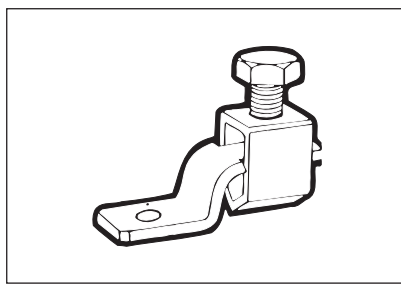

Cat. No.	Fig. No.	Conductor Range		Dimensions (in.)						
		max.	min.	L	W	H	F	E	D	
BTC1014*	1	10 AWG	14 AWG	1	5/16	43/64	5/64	5/32	3/16	
BTC0614	2	6 str.	14 AWG	1 3/32	3/8	23/32	5/64	13/64	7/32	
BTC0208	2	2 str.	8 str.	1 15/32	1/2	2 1/32	3/32	17/64	1/4	
BTC1102	3	1/0 str.	2 str.	1 25/32	5/8	1 13/32	1/8	17/64	7/16	
BTC3104	3	3/0 str.	4 str.	2 3/64	3/4	1 9/16	1/8	13/32	7/16	
BTC4102	3	4/0 str.	2 str.	2 9/16	1	1 61/64	1/8	11/32	1/2	
BTC3511	3	350 KCMIL	1/0 str.	3 1/4	1	2 1/2	3/16	13/32	5/8	
BTC5011	3	500 KCMIL	1/0 str.	4 1/4	1 1/2	2 21/32	3/16	13/32	15/16	
BTC9960	3	1000 KCMIL	600 KCMIL	4 3/4	2	3 1/16	1/4	17/32	1 1/8	

*Not CSA Listed.

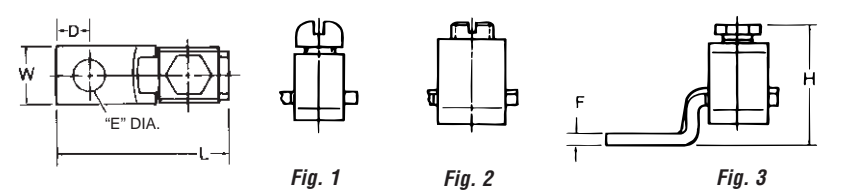

Blackburn® Anti-Rotational Connector



Anti-Rotational Connector

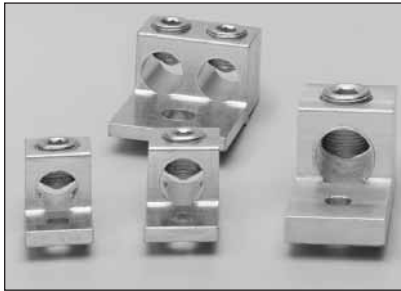

Thomas & Betts' new Anti-Rotational Connectors are designed with a rib on the bottom that keeps the connectors from turning, so there's no need to apply excessive torque and there's no danger of loosening connectors. The unique "no turn" rib provides a secure connection that eliminates conductor pinching that results from connector movement.

The new "no turn" design feature solves a unique problem for electricians and installers. Larger conductors tend to get damaged in overtorque conditions,

and connectors are prone to loosen in applications where there is vibration such as motor loads. Inspectors and local standards boards are requiring electricians and installers to make provisions to eliminate these conditions, and Blackburn® Anti-Rotational Connectors are the solution.

Cat. No.	Description	Std./Outer		UPC	Fig.
		Net Each	Wt./100		
ADR21-AR	2/0-14AWG, ¼ Bolt Hole	25/250	3.48	78378661008	Fig.1
ADR30-AR	300MCM-6AWG, ⅞ Bolt Hole	25/250	10	78378661016	Fig.1
ADR35-AR	350MCM-6AWG, ⅞ Bolt Hole	12/120	15	78378661019	Fig.1
ADR60-AR	600MCM-2AWG, ½ Bolt Hole	6/60	37.5	78378661031	Fig.1
ADR35-21-AR	350MCM-6AWG, ⅞ Bolt Hole	6/60	29.7	78378614979	Fig.2
ADR60-21-AR	600MCM-2AWG, ½ Bolt Hole	4/40	75.1	78378614978	Fig.2



Fig. 1

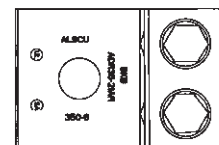

Fig. 2