

4

3

2

1

PART NUMBERS				CABLE RANGE inches (mm)	THREAD TYPE AND SIZE For thread specs see page 29	DIMENSIONS INCHES (MM)					
Dome Elbow Fittings		Flex Elbow Fittings				A Clearance Hole $+0.010^{+0.25mm}$ 0	B Body Length Dome	C Body Length Flex	D Height	E Thread Length	F Wrenching Flats
Black	Gray	Black	Gray								
ED09AA-BK ED09AR-BK	ED09AA-GY ED09AR-GY	EF09AA-BK EF09AR-BK	EF09AA-GY EF09AR-GY	.16 - .31 (4 - 8) .08 - .24 (2 - 6)	PG 9	.60 (15.2)	1.77 (45)	3.35 (85)	.91 (23)	.31 (8)	.75 (19)
ED09NA-BK ED09NR-BK	ED09NA-GY ED09NR-GY	EF09NA-BK EF09NR-BK	EF09NA-GY EF09NR-GY	.16 - .31 (4 - 8) .08 - .24 (2 - 6)	3/8" NPT	.68 (17.2)	1.77 (45)	3.35 (85)	.91 (23)	.59 (15)	.75 (19)
ED11AA-BK ED11AR-BK	ED11AA-GY ED11AR-GY	EF11AA-BK EF11AR-BK	EF11AA-GY EF11AR-GY	.20 - .39 (5 - 10) .11 - .27 (3 - 7)	PG 11	.73 (18.5)	1.97 (50)	4.05 (103)	1.06 (27)	.31 (8)	.87 (22)
ED13AA-BK ED13AR-BK	ED13AA-GY ED13AR-GY	EF13AA-BK EF13AR-BK	EF13AA-GY EF13AR-GY	.24 - .47 (6 - 12) .20 - .35 (5 - 9)	PG 13.5	.80 (20.3)	2.24 (57)	4.05 (103)	1.20 (30.5)	.35 (9)	.94 (24)
ED13NA-BK ED13NR-BK	ED13NA-GY ED13NR-GY	EF13NA-BK EF13NR-BK	EF13NA-GY EF13NR-GY	.24 - .47 (6 - 12) .20 - .35 (5 - 9)	1/2" NPT	.83 (21.1)	2.24 (57)	4.69 (119)	1.20 (30.5)	.51 (13)	.94 (24)
ED16NA-BK ED16NR-BK	ED16NA-GY ED16NR-GY	EF16NA-BK EF16NR-BK	EF16NA-GY EF16NR-GY	.39 - .55 (10 - 14) .27 - .47 (7 - 12)	1/2" NPT	.83 (21.1)	2.32 (59)	5.12 (130)	1.24 (31)	.51 (13)	1.06 (27)
ED16AA-BK ED16AR-BK	ED16AA-GY ED16AR-GY	EF16AA-BK EF16AR-BK	EF16AA-GY EF16AR-GY	.39 - .55 (10 - 14) .27 - .47 (7 - 12)	PG 16	.88 (22.3)	2.32 (59)	5.12 (130)	1.28 (32)	.39 (10)	1.06 (27)
ED21AA-BK ED21AR-BK	ED21AA-GY ED21AR-GY	EF21AA-BK EF21AR-BK	EF21AA-GY EF21AR-GY	.51 - .71 (13 - 18) .35 - .63 (9 - 16)	PG 21	1.12 (28.4)	2.87 (73)	6.14 (156)	1.57 (40)	.43 (11)	1.30 (33)
ED21NA-BK ED21NR-BK	ED21NA-GY ED21NR-GY	EF21NA-BK EF21NR-BK	EF21NA-GY EF21NR-GY	.51 - .71 (13 - 18) .35 - .63 (9 - 16)	3/4" NPT	1.05 (26.7)	2.87 (73)	6.14 (156)	1.57 (40)	.51 (13)	1.30 (33)
ED29AA-BK ED29AR-BK	ED29AA-GY ED29AR-GY			.71 - .98 (18 - 25) .51 - .79 (13 - 20)	PG 29	1.47 (37.3)	3.58 (91)	--	2.03 (51.5)	.43 (11)	1.65 (42)
ED29NA-BK ED29NR-BK	ED29NA-GY ED29NR-GY			.71 - .98 (18 - 25) .51 - .79 (13 - 20)	1" NPT	1.47 (37.3)	3.58 (91)	--	1.97 (50)	.75 (19)	1.65 (42)

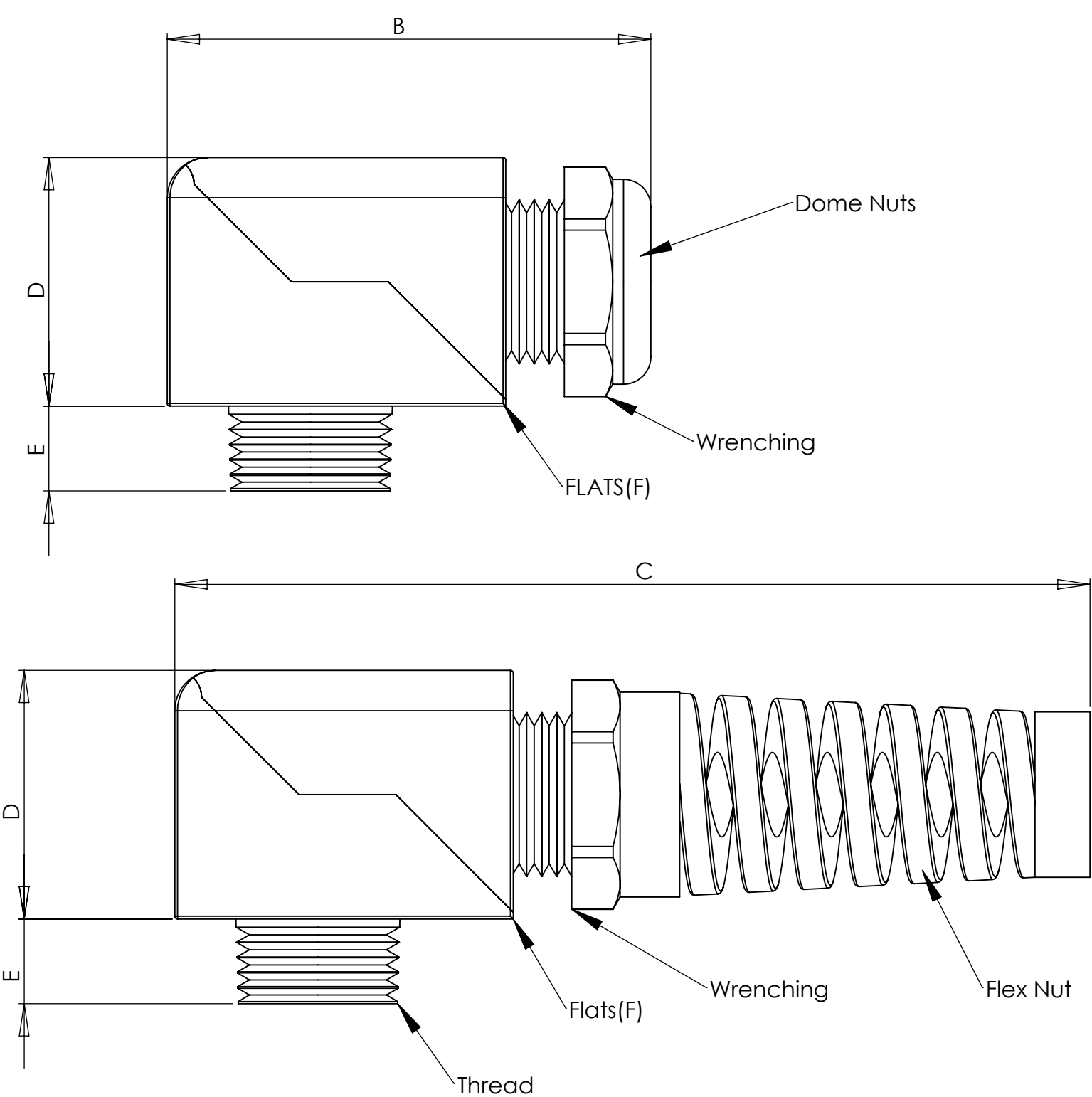
**SPECIFICATIONS:****Pressure rating:**

150 PSIG (10 BAR) NEMA 4x and 6
(Submersible) IP 68

Materials:

Body & Dome Nut: Nylon 6/6
Form Seal: Buna-N
Optional O-Ring: Buna-N

Operating Temperature:

-40°F to 212°F (-40°C to 100°C)
Short Term: 248°F (120°C)

NOTES:

- 1) GENERAL DIMENSIONS DRAWINGS.
- 2) DIMENSIONS [] ARE IN INCHES.
- 3) DIMENSIONS NOTED ARE FOR REFERENCE ONLY.

Third angle projection

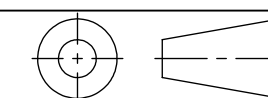

14853 HINDSDALE AVE, SUITE D
CENTENNIAL, CO 80112-4240, USA
TEL: +1-303-699-1135
TOLL FREE: +1-800-456-9012
E MAIL: info@sealconusa.com,
WEBSITE: www.sealconusa.com

4

3

2