



**SCHROFF**

Project - 0 item(s)

**MY PROJECT LIST**

- PRODUCTS
- APPLICATIONS
- INDUSTRIES
- NEW PRODUCTS
- CONFIGURATORS
- Products ▾
- Search
- 

Home > Front Panel, anodized, unshielded, screw assembly



# Front Panel, anodized, unshielded, screw assembly

**SCHROFF**



**Catalog Number: 30807-481**

[Back To Product](#)

- Al, anodized
- Partial width front panel, Al, 2.5 mm

**Note:**

Please order fixing material (sleeves, collar screws) separately, see Downloads-Mounting Hardware

**Specification:**

- IEC 60297-3-101
- IEEE 1101.1/10

**Material and Surface Finish:**

Al, Anodized

**Assembly:**

Screw on - Front Side

**EMC Shielding:**

Unshielded

**Type:**

Individual Components

**Individual Component Type:**

Front Panels

**Standard pack quantity (SPQ):**

Please take into consideration that deliveries may be carried out in the stated SPQs (SPQ, e.g. 5 pieces, 10 pieces, 50 pieces, etc.). Differing order quantities (e.g. 2 pieces) may be changed to the next possible delivery quantity = Standard Pack Quantity.



Other Views

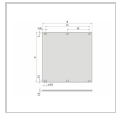

**Select product specifications before modifying or adding to project list or requesting a quote.**

Height-U-defining

Width-HP-defining

[Clear Selection](#)

Quantity

**Modify Product** ▶

**Add Item to Project List** +

**Documents**

Main Catalog - Front panels

**Links**

Mounting Hardware

Native CAD files

## Technical Data

<b>Height mm</b>	128.4
<b>Qty</b>	1 piece (SPQ 5)
<b>Delivery is exclusively made in Standard Pack Quantity (SPQ)</b>	5
<b>B mm</b>	20.0
<b>For case height [U]</b>	128.4
<b>Thickness mm</b>	2.5
<b>Height U</b>	3
<b>Width HP</b>	4

## Delivery Comprises:

Item	Quantity	Description
1	1	Front panel, Al, 2.5 mm, anodised

## Accessories

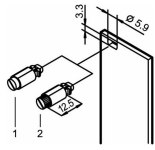

Quarter-turn fastener with knurled and slotted head, grey, PU 100 pcs

21101-849

[Add Item to Project List +](#)

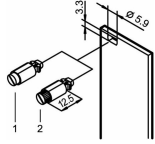

Quarter-turn fastener with knurled and slotted head, black, PU 100 pcs

21101-850

[Add Item to Project List +](#)

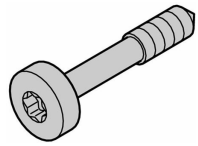

Collar screw, Torx (M2.5x12.3), steel black, PU 100 pcs

21101-783

[Add Item to Project List +](#)



Sleeve, brass, black, PU 100 pcs

21100-886

[Add Item to Project List +](#)

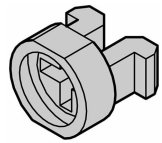

Sleeve, plastic, black, PU 100 pcs

21100-591

[Add Item to Project List +](#)

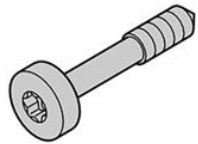

Collar screw, Torx (M2.5x12.3), steel nickel plated, PU 100 pcs

21101-782

[Add Item to Project List +](#)

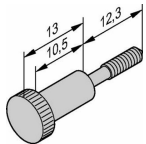

Collar screw, knurled head long for LD (M2.5x12.3), brass nickel plated, PU 100 pcs

21101-909

[Add Item to Project List +](#)



Sleeve, brass nickel-plated, PU 100 pcs

21100-660

[Add Item to Project List +](#)

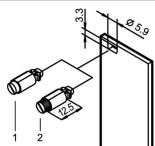

Quarter-turn fastener with slotted head, grey, PU 100 pcs

21101-847

[Add Item to Project List +](#)



Collar screw, cross recess/slotted (M2.5x12.3), steel black, PU 100 pcs

21101-102

[Add Item to Project List +](#)

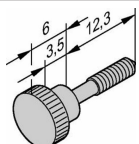

Collar screw, knurled head short (M2.5x12.3), brass nickel plated, PU 100 pcs

21101-749

[Add Item to Project List +](#)



Sleeve, stainless steel, PU 100 pcs

21100-662

[Add Item to Project List +](#)

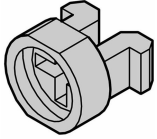

Sleeve, plastic, grey, PU 100 pcs

21100-464

[Add Item to Project List +](#)

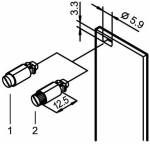

Quarter-turn fastener with slotted head, black, PU 100 pcs

21101-848

[Add Item to Project List +](#)



Collar screw, cross recess/slotted (M2.5x12.3), steel nickel plated, PU 100 pcs

21101-101

[Add Item to Project List +](#)

### EXPLORE

- [About Us](#)
- [Services & Capabilities](#)
- [News & Events](#)
- [Newsletter Subscriptions](#)
- [Strategic Partnerships](#)
- [Investor Relations](#)

### CONTACT

- [Customer Service](#)
- [Find a Sales Office or Distributor](#)
- [Global Locations](#)
- [Product Compliance & Certifications](#)
- [Partner Login](#)

### DOWNLOAD

- [Download Center](#)
- [Reference Projects](#)
- [Videos](#)
- [Product Configurators](#)
- [Warranties and Terms of Sale & Procurement](#)

© 2018 nVent. All rights reserved | [Privacy Policy](#) | [Terms of Use](#) | [Cookie Policy](#) | [Imprint](#) | [Site Map](#)

### Connect With Us

