

Data sheet

OpDAT REGplus 3xSC/ST-D MM (ceramic), 1xM20, with shrink splice holder

Page 1/5

P/N
150240C30310S
EAN 4250184152569

2018-03-01

Illustrations



Dimensional drawing

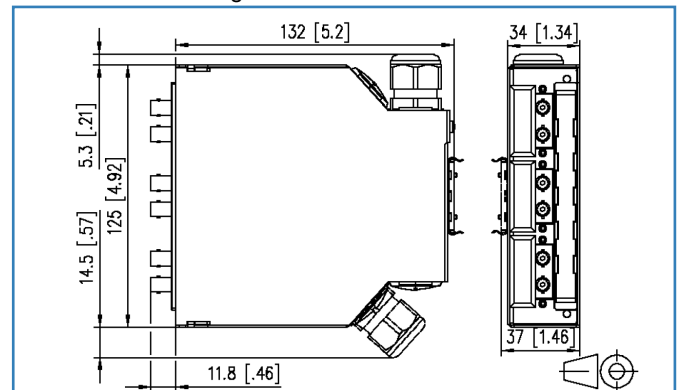

See enlarged drawings at the end of document

Product specification

- splice distributor for TH35 rail
- equipped with SC-D/ST-D (MM) adapters made of zinc die-casting
- slotted ceramic sleeve for multi mode applications
- with fiber reservoir
- custom-labeled identification strips
- various mounting versions on rail
- splice tray with shrink splice holder
- front plate can be completely removed
- cable feed from top or bottom, straight or inclined, with M20 cable gland (up to 2 possible)
- feed of preassembled cables is possible
- one cable gland M20 with strain relief included in the delivery
- housing cover fastening by means of just one captive screw
- unoccupied adapter recesses are closed with special blind plugs
- variants: equipped with 2, 3, 4 or 6 SC-D/ST-D adapters (SC-D interior, ST-D exterior)
- please note: if you use preassembled cables with ST plugs, use the unequipped version of the OpDAT REG plus. The ST-D adapters required in this case are available as accessory. Before mounting the adapters in the housing, plug the preassembled ST plugs in the adapters for reasons of space.



OpDAT REGplus 3xSC/ST-D MM (ceramic), 1xM20, with shrink splice holder

P/N
150240C30310S
EAN 4250184152569

2018-03-01

Technical Data

General Data

Fields of application	Structured building cabling
Design	Splice distributor
Mounting style	Standard rail TH35
Color	metallike
Dimensions	
Dimension (L x W x H)	144.80 x 143.80 x 37.00 mm
Dimension (L x W x H)	5.701 x 5.661 x 1.457 in.
Mode type of the fiber	Multimode
Labeling option	identification label

Connections/interfaces

Connector technology interface 1	SC-D/ST-D Couplers
Connector technology interface 2	SC-D/ST-D Couplers
Number of ports interface 1	6
Number of ports interface 2	6
Number of equipped ports interface 1	3
Number of ports interface 2 equipped	3
Number of ports with dust protection interface 1	3
Number of ports with dust protection interface 2	3
Number of blind covers interface 2	3
Cable access/outlet	from top or bottom, straight or inclined

Mechanical characteristics

Cut-out	SC-D, LC-Q, ST-D
Connector type	Duplex
Life - Number of mating cycles	min. 500
strain relief	M gland

Materials and material properties

Material - Front cover	Frianyl
Material - Sleeve	ceramic, slotted
Material - Coupler housing	GD-Zn (zinc die-cast)



Data sheet

Page 3/5

OpDAT REGplus 3xSC/ST-D MM (ceramic), 1xM20, with shrink splice holder

P/N

150240C30310S

EAN 4250184152569

2018-03-01

Technical Data

Approvals

RoHS	compliant
------	-----------

Classifications

ETIM 5.0	EC001130
----------	----------

ETIM 6.0	EC001130
----------	----------

Packing details

Type of packaging	1 pc(s) / box
-------------------	---------------

Packaging unit - Weight (gram)	656.00 g
--------------------------------	----------

Packaging unit - Weight (pound)	1.45 lb
---------------------------------	---------

Packaging dimension (W x H x D)	145.00 x 182.00 x 40.00 mm
---------------------------------	----------------------------

Packaging dimension (W x H x D)	5.709 x 7.165 x 1.575 in.
---------------------------------	---------------------------



Data sheet

Page 4/5

OpDAT REGplus 3xSC/ST-D MM (ceramic), 1xM20, with shrink splice holder

P/N

150240C30310S

EAN 4250184152569

2018-03-01

Accessories

P/N	Designation
899789-01	Label sheet for E-DAT C6 and E-DAT design patch panels



Data sheet

OpDAT REGplus 3xSC/ST-D MM (ceramic), 1xM20, with shrink splice holder

Page 5/5

P/N
150240C30310S
EAN 4250184152569

2018-03-01

Illustrations

Dimensional drawing

