

LUMOTAST 75 IP40, signal lamps, round collar, protruding bezel



fields of application

- > Measurement-control-regulation
- > Mechanical and system engineering
- > Signalling systems



description

technical data

> general

illuminated	Yes
Collar color	black
Collar shape	round
Operating temperature, min.	-25 °C
Operating temperature, max.	55 °C
Storage temperature, min.	-40 °C
Storage temperature, max.	80 °C
Lamp socket	T4.5
Packaging	Box
Packaging unit	10 pcs.
Degree of protection, front side, according to DIN EN 60529	IP40
RoHS compliant	Yes
REACH compliant	Yes

> mounting diameters

Mounting hole	16.2 mm
Mounting depth	33.5 mm
Installation height	7.5 mm
Outside dimension, width	18 mm

> mechanical data

Fixing	Threaded ring
Terminal on the rear	Solder terminal

direct links

- > [RAFI eCatalog](#)

Lötbarkeit

Yes

drawings

Dimensioned drawing

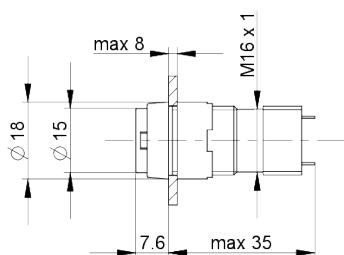

System drawing

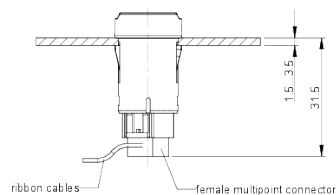

System drawing

Installation drawing with plug-in socket

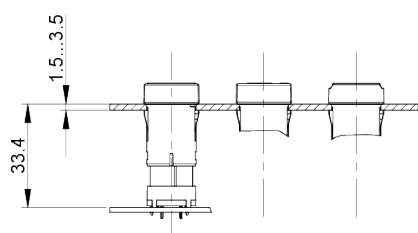

Mounting hole drawing

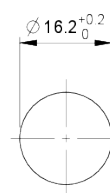

Connection drawing

Wiring diagram (view of component bottom)

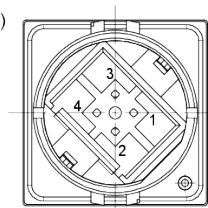

1 + 4 = Push-button connection, 2 + 3 = Light connection when used LED: Connection 3 = Cathode