



MW Industries, Inc.

Home

Products

Online Catalog

Request Quote

Order Online

Check Stock

Request Print Catalog

Request Samples

Engineering Data

Distributors

Capabilities Brochure

CALL NOW:  
203 888-2133



Home > 4.5mm Hex Male-Female Standoffs

### 4.5MM HEX MALE-FEMALE STANDOFFS

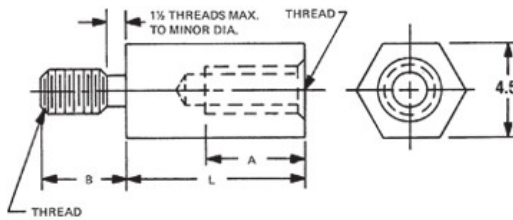

MINIMUM THREAD DEPTH "A"					
Thread	Body Length "L"				
	5	6	7	8	9
M2.5x0.45	1.9	2.9	3.9		
M3x0.5	1.8	2.8	3.8	4.8	5.8

In short lengths, "A" will be tapped to maximum depth.  
For non-standard parts, [contact us](#).

Qty1 \*

Qty2

Qty3

- M2107 12
- M2108 13
- M2109 14
- M2110 15
- M2111 16
- M2112 17
- M2113** 18
- M2114 19
- M2115 20
- M2116 21
- M2117 22
- M2118 23
- M2119 24

Select	Code	Thread	A	B
<input checked="" type="radio"/>	2545	M2.5x0.45	4.8	3.97
<input type="radio"/>	3005	M3x0.5	6.4	4.76

Select	Code	Material	RoHS
<input type="radio"/>	AL	Aluminum	YES
<input type="radio"/>	B	Brass	YES
<input checked="" type="radio"/>	SS	Stainless Steel	YES
<input type="radio"/>	S	Steel	YES
<input type="radio"/>	N	Nylon	YES

[Home](#) [Previous](#) [Next](#)

Related ASE

Ordering Code			
xxxxx	xxxx	xx	x
Length	Thread	Material	Finish

**PART: M2113 2545 SS**

Red ?'s show missing selections. [Help](#)

[Material Specifications](#)  
[Ordering non-standard items](#)  
[Download a Drawing](#)

**Add to Cart**

### 4.5mm Hex Male-Female Standoffs

Finish \*

<input checked="" type="radio"/>	Plain Finish
<input type="radio"/>	1-Cad clear chromate/commercial*
<input type="radio"/>	2-Cad clear chromate*
<input type="radio"/>	3-Cad yellow chromate*
<input type="radio"/>	4-Chrome over nickel
<input type="radio"/>	5-Nickel
<input type="radio"/>	6-Gold iridite
<input type="radio"/>	7-Clear iridite
<input type="radio"/>	9-Alodine 1200*
<input type="radio"/>	10-Bright chrome
<input type="radio"/>	11-Satin chrome
<input type="radio"/>	12-Zinc

