



MW Industries, Inc.

- Home

- Products

- Online Catalog

- Request Quote

- Order Online

- Check Stock

- Request Print Catalog

- Request Samples

- Engineering Data

- Distributors

- Capabilities Brochure

Home > 5/16 Hex Male-Female Standoffs

5/16 HEX MALE-FEMALE STANDOFFS

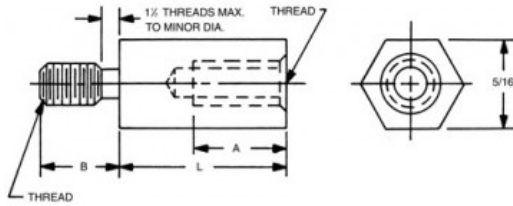

[Home](#) [Previous](#) [Next](#)
[Related Metric](#)

| | | | |
|---------------|--------|----------|--------|
| Ordering Code | | | |
| xxxxx | xxx | xx | x |
| | | | |
| Length | Thread | Material | Finish |

PART: 4591-1032-SS

Red ?'s show missing selections. [Help](#)

- [Material Specifications](#)
- [Ordering non-standard items](#)
- [Download a Drawing](#)

Add to Cart

| Thread Length Code | | |
|--------------------|------|------|
| Thread | A | B |
| 4-40 | 1/4 | 3/16 |
| 6-32 | 3/8 | 1/4 |
| 8-32 | 7/16 | 3/8 |
| 10-32 | 1/2 | 3/8 |

Qty1 *

Qty2

Qty3

- 4585 1-1/8
- 4586 1-3/16
- 4587 1-1/4
- 4588 1-5/16
- 4589 1-3/8
- 4590 1-7/16
- 4591 1-1/2
- 4592 1-9/16
- 4593 1-5/8
- 4594 1-11/16
- 4595 1-3/4
- 4596 1-13/16

Thread *

| Select | Code | Thread |
|----------------------------------|------|--------|
| <input type="radio"/> | 440 | 4-40 |
| <input type="radio"/> | 632 | 6-32 |
| <input type="radio"/> | 832 | 8-32 |
| <input checked="" type="radio"/> | 1032 | 10-32 |

Material *

| Select | Code | Material | RoHS |
|----------------------------------|------|-----------------|------|
| <input type="radio"/> | AL | Aluminum | YES |
| <input type="radio"/> | B | Brass | YES |
| <input checked="" type="radio"/> | SS | Stainless Steel | YES |
| <input type="radio"/> | S | Steel | YES |
| <input type="radio"/> | N | Nylon | YES |



Finish *

| | |
|----------------------------------|----------------------------------|
| <input checked="" type="radio"/> | Plain Finish |
| <input type="radio"/> | 1-Cad clear chromate/commercial* |
| <input type="radio"/> | 2-Cad clear chromate* |
| <input type="radio"/> | 3-Cad yellow chromate* |
| <input type="radio"/> | 4-Chrome over nickel |
| <input type="radio"/> | 5-Nickel |
| <input type="radio"/> | 6-Gold iridite |
| <input type="radio"/> | 7-Clear iridite |
| <input type="radio"/> | 9-Alodine 1200* |
| <input type="radio"/> | 10-Bright chrome |
| <input type="radio"/> | 11-Satin chrome |
| <input type="radio"/> | 12-Zinc |