

Cable duct - CD 30X60 WH - 3240621

Please be informed that the data shown in this PDF Document is generated from our Online Catalog. Please find the complete data in the user's documentation. Our General Terms of Use for Downloads are valid (<http://phoenixcontact.com/download>)



Cable duct, white, comprising upper part and mounting base, width: 30 mm, height: 60 mm, length: 2000 mm

The figure shows the CD 80x80 WH version

Product Features

- Easy, burr-free cutting with minimum effort using the CUTFOX-CD cable duct cutter
- Thanks to its leverage and special cutting geometry, the PPS CD cable duct cutter enables easy, burr-free cutting with minimum effort
- Predetermined breaking point enables tool-free, burr-free removal of bars
- The wide, diagonal heads of the cable duct bars make it easy to fit the cover and hold it securely in place
- Installed conductors are securely held in place by means of wire retaining clips that can be snapped onto bars on the side
- Plastic body-bound rivets enable easy fixing of cable ducts using the rivet setting tool



Key Commercial Data

Packing unit	1 pc
Minimum order quantity	24 pc
Weight per Piece (excluding packing)	1.0 g
Custom tariff number	39259020
Country of origin	Germany

Technical data

Dimensions

Length (b)	2000 mm
Width (a)	30 mm
Height	60 mm

Ambient conditions

Ambient temperature (operation)	-5 °C ... 60 °C
---------------------------------	-----------------

Cable duct - CD 30X60 WH - 3240621

Technical data

General

Color	white
Components	Lead-free
Flammability rating according to UL 94	V0
Material	PVC

Standards and Regulations

Halogen-free	no
Connection in acc. with standard	CSA
Flammability rating according to UL 94	V0

Classifications

eCl@ss

eCl@ss 4.0	27140602
eCl@ss 4.1	27140602
eCl@ss 5.0	27140602
eCl@ss 5.1	27140602
eCl@ss 6.0	27400703
eCl@ss 7.0	27400703
eCl@ss 8.0	27400703

ETIM

ETIM 4.0	EC000012
ETIM 5.0	EC000012

UNSPSC

UNSPSC 6.01	30101815
UNSPSC 7.0901	30101815
UNSPSC 11	30101815
UNSPSC 12.01	30101815
UNSPSC 13.2	30101815

Approvals

Approvals

Approvals

CSA / UL Recognized / VDE Zeichengenehmigung

Cable duct - CD 30X60 WH - 3240621

Approvals

Ex Approvals

Approvals submitted

Approval details



Drawings

Dimensional drawing

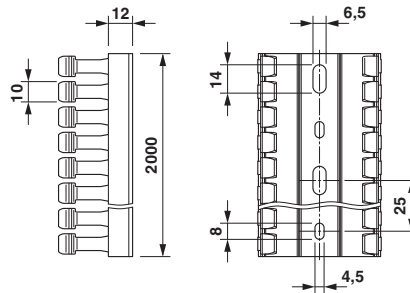

Base perforation according to DIN EN 50085