

Valve connectors - SACC-V-3CON-PG9/B-1L-S - 1671153

Please be informed that the data shown in this PDF Document is generated from our Online Catalog. Please find the complete data in the user's documentation. Our General Terms of Use for Downloads are valid (<http://phoenixcontact.com/download>)



Valve connector, 3-pos., type B, 1 LED, with protective circuit, screw connection, cable screw connection Pg9



Key commercial data

Packing unit	1 pc
Weight per Piece (excluding packing)	37.7 GRM
Custom tariff number	85366990
Country of origin	Czech Republic

Technical data

Dimensions

External diameter	6 mm ... 8 mm
-------------------	---------------

Ambient conditions

Ambient temperature (operation)	-25 °C ... 60 °C (valve plug)
Degree of protection	IP65

General

Rated current at 40°C	4 A
Rated voltage	24 V
Number of positions	3
Contact resistance	≤ 4 mΩ
Insulation resistance	> 2 GΩ
Standards/regulations	Valve connector EN 175301-803
Status display	Yellow LED
Protective circuit/component	Z diode
Surge voltage category	II
Pollution degree	3

Valve connectors - SACC-V-3CON-PG9/B-1L-S - 1671153

Technical data

General

Connection method	Screw connection
Conductor cross section	0.34 mm ² ... 2.5 mm ²
AWG conductor cross section	22 ... 13

Material

Inflammability class according to UL 94	HB
Valve plug contact material	CuSn
Valve plug contact surface material	Ag
Valve plug contact insert material	PBT
Material housing valve plug	PA

Classifications

eCl@ss

eCl@ss 4.0	27140815
eCl@ss 4.1	27140815
eCl@ss 5.0	27143423
eCl@ss 5.1	27143423
eCl@ss 6.0	27143423
eCl@ss 7.0	27449001
eCl@ss 8.0	27440104

ETIM

ETIM 2.0	EC001121
ETIM 3.0	EC002062
ETIM 4.0	EC002062
ETIM 5.0	EC002062

UNSPSC

UNSPSC 6.01	31251501
UNSPSC 7.0901	31251501
UNSPSC 11	31251501
UNSPSC 12.01	31251501
UNSPSC 13.2	31251501

Approvals

Approvals

Valve connectors - SACC-V-3CON-PG9/B-1L-S - 1671153

Approvals

Approvals

GOST / GOST

Ex Approvals

Approvals submitted

Approval details

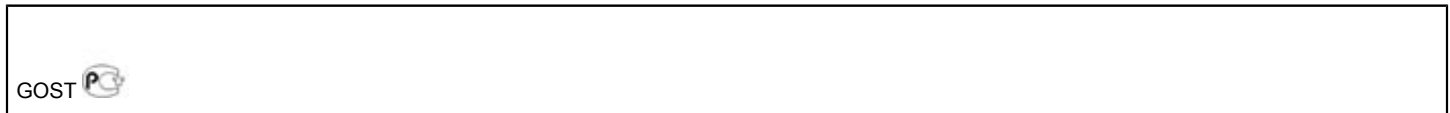

Drawings

Dimensioned drawing

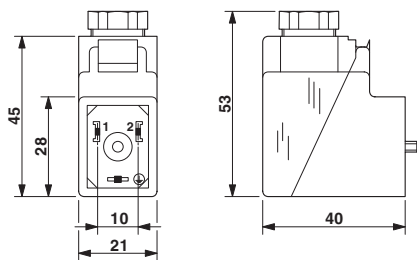

Circuit diagram

