

## Flush-type connector - SACC-DSI-M12MSS-4CON-M16/0,5PE - 1424132

Please be informed that the data shown in this PDF Document is generated from our Online Catalog. Please find the complete data in the user's documentation. Our General Terms of Use for Downloads are valid (<http://phoenixcontact.com/download>)



Flush-type connector, Power, 4-position, Plug, M12, S power, Rear mounting, M16 x 1.5, Individual wires, cable length: 0.5 m

### Why buy this product

- ✓ For compact devices: transmit high power in a confined space
- ✓ Protection against mismatching thanks to S-coding
- ✓ Pre-assembled with litz wires for immediate use
- ✓ Customer-specific assemblies and litz wire lengths available
- ✓ Sealed on the litz wire side for optimum leak-tightness
- ✓ For high transmission safety: shield connection to the housing with optional EMC nut

RoHS

### Key Commercial Data

|                                      |                                                                                                         |
|--------------------------------------|---------------------------------------------------------------------------------------------------------|
| Packing unit                         | 1 STK                                                                                                   |
| GTIN                                 | <br>4 046356 693370 |
| GTIN                                 | 4046356693370                                                                                           |
| Weight per Piece (excluding packing) | 60.000 g                                                                                                |
| Custom tariff number                 | 85366990                                                                                                |
| Country of origin                    | Germany                                                                                                 |

### Technical data

#### Dimensions

|                 |       |
|-----------------|-------|
| Length of cable | 0.5 m |
|-----------------|-------|

#### Ambient conditions

|                                 |                                  |
|---------------------------------|----------------------------------|
| Ambient temperature (operation) | -25 °C ... 85 °C (Plug / socket) |
| Degree of protection            | IP67                             |

# Flush-type connector - SACC-DSI-M12MSS-4CON-M16/0,5PE - 1424132

## Technical data

### General

|                             |                                                                                                                                                                                                                                                                                                                                                    |
|-----------------------------|----------------------------------------------------------------------------------------------------------------------------------------------------------------------------------------------------------------------------------------------------------------------------------------------------------------------------------------------------|
| Note                        | The electrical and mechanical data specified assume that the connector pair is correctly locked and mounted. If the connector is unlocked and if there is a danger of contamination, the connector must be sealed using a protective cap > IP54. Influences arising from litz wires, cables or PCB assembly must also be taken into consideration. |
| Rated current at 40°C       | 12 A                                                                                                                                                                                                                                                                                                                                               |
| Rated voltage               | 630 V                                                                                                                                                                                                                                                                                                                                              |
| Rated surge voltage         | 6 kV                                                                                                                                                                                                                                                                                                                                               |
| Number of positions         | 4                                                                                                                                                                                                                                                                                                                                                  |
| Insulation resistance       | ≥ 100 MΩ                                                                                                                                                                                                                                                                                                                                           |
| Coding                      | S power                                                                                                                                                                                                                                                                                                                                            |
| Standards/regulations       | M12 connector IEC 61076-2-111 In line with                                                                                                                                                                                                                                                                                                         |
| Signal type/category        | Power                                                                                                                                                                                                                                                                                                                                              |
| Status display              | No                                                                                                                                                                                                                                                                                                                                                 |
| Overvoltage category        | III                                                                                                                                                                                                                                                                                                                                                |
| Degree of pollution         | 3                                                                                                                                                                                                                                                                                                                                                  |
| Connection method           | Individual wires                                                                                                                                                                                                                                                                                                                                   |
| Insertion/withdrawal cycles | > 100                                                                                                                                                                                                                                                                                                                                              |
| Mounting type               | Rear mounting M16 x 1.5 With flat nut                                                                                                                                                                                                                                                                                                              |

### Material

|                                        |                           |
|----------------------------------------|---------------------------|
| Flammability rating according to UL 94 | V0                        |
| Contact material                       | CuZn                      |
| Contact surface material               | Au                        |
| Contact carrier material               | PA                        |
| Material, knurls                       | CuZn alloy, nickel-plated |
| Sealing material                       | FKM                       |

### Cable

|                                 |                                                 |
|---------------------------------|-------------------------------------------------|
| Cable type                      | PP litz wire                                    |
| Conductor cross section         | 1.5 mm <sup>2</sup>                             |
| AWG signal line                 | 16                                              |
| Wire colors                     | Black 1, black 2, black 3, green/yellow         |
| Conductor material              | Bare Cu litz wires                              |
| Standards/specifications        | M12 connector IEC 61076-2-111 In line with      |
| Flame resistance                | in acc. with UL FT-2                            |
| Halogen-free                    | According to VDE 0282-13 Appendix C             |
| Ambient temperature (operation) | -40 °C ... 85 °C (without mechanical actuation) |
|                                 | -40 °C ... 90 °C (cable, fixed installation)    |
|                                 | -30 °C ... 90 °C (cable, flexible installation) |

# Flush-type connector - SACC-DSI-M12MSS-4CON-M16/0,5PE - 1424132

## Technical data

### Standards and Regulations

|                                        |                                     |
|----------------------------------------|-------------------------------------|
| Standard designation                   | M12 connector                       |
| Standards/regulations                  | IEC 61076-2-111                     |
| Halogen-free                           | According to VDE 0282-13 Appendix C |
| Flame resistance                       | in acc. with UL FT-2                |
| Flammability rating according to UL 94 | V0                                  |

### Environmental Product Compliance

|            |                                                                                                     |
|------------|-----------------------------------------------------------------------------------------------------|
| China RoHS | Environmentally Friendly Use Period = 50                                                            |
|            | For details about hazardous substances go to tab "Downloads", Category "Manufacturer's declaration" |

## Drawings

Schematic diagram



Connector pin assignment of M12 plug, 4-pos., S-coded, view of pin side

Dimensional drawing

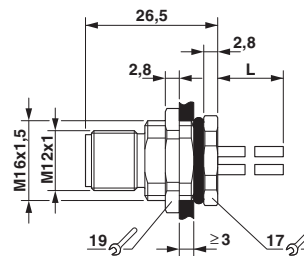

M12 flush-type plug

Circuit diagram

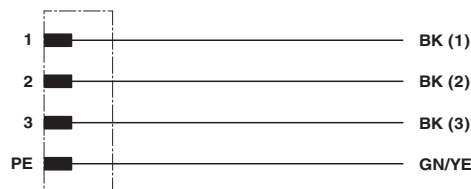

Contact assignment

## Classifications

eCl@ss

|            |          |
|------------|----------|
| eCl@ss 4.0 | 27140815 |
| eCl@ss 4.1 | 27140815 |

# Flush-type connector - SACC-DSI-M12MSS-4CON-M16/0,5PE - 1424132

## Classifications

### eCl@ss

|            |          |
|------------|----------|
| eCl@ss 5.0 | 27143423 |
| eCl@ss 5.1 | 27143423 |
| eCl@ss 6.0 | 27143423 |
| eCl@ss 7.0 | 27449001 |
| eCl@ss 8.0 | 27440103 |
| eCl@ss 9.0 | 27440102 |

### ETIM

|          |          |
|----------|----------|
| ETIM 3.0 | EC002061 |
| ETIM 4.0 | EC002062 |
| ETIM 5.0 | EC002061 |
| ETIM 6.0 | EC002061 |

### UNSPSC

|               |          |
|---------------|----------|
| UNSPSC 6.01   | 31251501 |
| UNSPSC 7.0901 | 31251501 |
| UNSPSC 11     | 31251501 |
| UNSPSC 12.01  | 31251501 |
| UNSPSC 13.2   | 39121413 |

## Approvals

### Approvals

#### Approvals

UL Listed / cUL Listed / EAC / cULus Listed

#### Ex Approvals

### Approval details

|                            |                                                                                     |                                                                                                                                                       |               |
|----------------------------|-------------------------------------------------------------------------------------|-------------------------------------------------------------------------------------------------------------------------------------------------------|---------------|
| UL Listed                  |  | <a href="http://database.ul.com/cgi-bin/XYV/template/LISEXT/1FRAME/index.htm">http://database.ul.com/cgi-bin/XYV/template/LISEXT/1FRAME/index.htm</a> | FILE E 468743 |
| mm <sup>2</sup> /AWG/kcmil | 16                                                                                  |                                                                                                                                                       |               |
| Nominal current IN         | 12 A                                                                                |                                                                                                                                                       |               |

# Flush-type connector - SACC-DSI-M12MSS-4CON-M16/0,5PE - 1424132

## Approvals

|                    |       |
|--------------------|-------|
| Nominal voltage UN | 600 V |
|--------------------|-------|

|                            |                                                                                   |                                                                                                                                                       |               |
|----------------------------|-----------------------------------------------------------------------------------|-------------------------------------------------------------------------------------------------------------------------------------------------------|---------------|
| cUL Listed                 |  | <a href="http://database.ul.com/cgi-bin/XYV/template/LISEXT/1FRAME/index.htm">http://database.ul.com/cgi-bin/XYV/template/LISEXT/1FRAME/index.htm</a> | FILE E 468743 |
| mm <sup>2</sup> /AWG/kcmil | 16                                                                                |                                                                                                                                                       |               |
| Nominal current IN         | 12 A                                                                              |                                                                                                                                                       |               |
| Nominal voltage UN         | 600 V                                                                             |                                                                                                                                                       |               |

|     |                                                                                   |         |
|-----|-----------------------------------------------------------------------------------|---------|
| EAC |  | B.01742 |
|-----|-----------------------------------------------------------------------------------|---------|

|              |                                                                                    |
|--------------|------------------------------------------------------------------------------------|
| cULus Listed |  |
|--------------|------------------------------------------------------------------------------------|