

## Cable gland - G-INS-M20-S68N-PNES-BK - 1411133

Please be informed that the data shown in this PDF Document is generated from our Online Catalog. Please find the complete data in the user's documentation. Our General Terms of Use for Downloads are valid (<http://phoenixcontact.com/download>)



Cable gland, Cable gland material: Polyamide 6, External cable diameter 6 mm ... 12 mm, Shielding: No, Connecting thread: M20, Color: jet black RAL 9005

### Why buy this product

- Plastic material conforms to UL 746C f1

### Key Commercial Data

Packing unit	1 STK
Minimum order quantity	5 STK
GTIN	 4 046356 922661
GTIN	4046356922661
Weight per Piece (excluding packing)	12.000 g
Custom tariff number	39269097
Country of origin	Turkey

### Technical data

#### Dimensions

Length	42 mm
Wrench size, union nut	24 mm
Wrench size, support	24 mm
Hexagon angular dimension	27.8 mm
Length of the connecting thread	10 mm
Feed-through hole diameter	20.1 mm ... 20.2 mm
External cable diameter	6 mm ... 12 mm
	9 mm ... 12 mm (for UL 514 B)

## Cable gland - G-INS-M20-S68N-PNES-BK - 1411133

### Technical data

#### Ambient conditions

Degree of protection	IP68 (5 bar / 0.5 h)
	IP66
Ambient temperature (operation)	-20 °C ... 100 °C (static)

#### General

No. of conductors	1
Cable gland material	Polyamide 6
Cable seal material	Neoprene
Shielded	No
Thread type on connection side	M20
Thread pitch	1.5 mm
Torque	3.5 Nm (Union nut)
	3.5 Nm (Support)
	6 Nm (for UL514 B: union nut / support)
Flammability rating according to UL 94	V2
	V2 (Housing)
Color	jet black RAL 9005
Impact category	2
Execution of the strain relief	A
Assembly instructions	1) Mount screw connection support in the housing using the correct torque 2) Insert cable 3) Tighten union nut using the correct torque

#### Standards and Regulations

Connection in acc. with standard	CSA
Flammability rating according to UL 94	V2

#### Environmental Product Compliance

China RoHS	Environmentally friendly use period: unlimited = EFUP-e
	No hazardous substances above threshold values

### Drawings

# Cable gland - G-INS-M20-S68N-PNES-BK - 1411133

Dimensional drawing

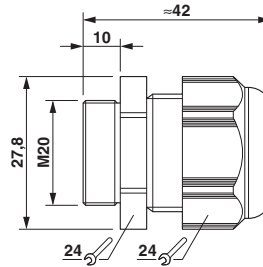

Dimensional drawing

## Approvals

Approvals

---

Approvals

CSA / UL Listed / VDE Zeichengenehmigung

---

Ex Approvals

---

## Approval details

CSA  <http://www.csagroup.org/services/testing-and-certification/certified-product-listing/243143>

UL Listed  <http://database.ul.com/cgi-bin/XYV/template/LISEXT/1FRAME/index.htm> E199260

VDE Zeichengenehmigung  <http://www.vde.com/en/Institute/OnlineService/VDE-approved-products/Pages/Online-Search.aspx> 40024418

---