



600W Modified Sine Wave DC-AC Power Inverter **A-301/302-600** series



■ Features :

- 12V or 24V DC input
- Power ON-OFF switch
- Input voltage range: -15% ~ +25%
- Output voltage regulation: ±10%
- Protections: Bat. Low alarm/Bat. Low shutdown/Over voltage/Over temp./Output short/Input polarity reverse/Over load.
- Output waveform: Modified sine wave
- Cooling fan ON-OFF control

| | | | | | |
|---------------|--|---|-------------|------------------------|-------------|
| OUTPUT | SAFETY MODEL NO. | | | | |
| | AC VOLTAGE | 110V | | | |
| | RATED POWER | 600W | | | |
| | SURGE POWER | 1200W | | | |
| | WAVEFORM | Modified Sine Wave | | | |
| | FREQUENCY | 60Hz±1% | 50Hz±1% | 60Hz±1% | 50Hz±1% |
| | AC REGULATION | ±10% | | ±10% | |
| | STANDARD RECEPTACLES | TYPE-2* 2ea | TYPE-3* 1ea | TYPE-2* 2ea | TYPE-3* 1ea |
| LED INDICATOR | Green LED for power on; Red LED for power failure status | | | | |
| INPUT | DC CURRENT | 60A | | 30A | |
| | NO LOAD CURRENT DRAW | 0.5A | 0.6A | 0.35A | 0.38A |
| | DC VOLTAGE | 12V | | 24V | |
| | VOLTAGE RANGE | 10 ~ 15VDC | | 21 ~ 30VDC | |
| | EFFICIENCY (Typ.) | 82% | | 85% | |
| | DC CONNECTOR | 900mm Battery clip*1ea | | 900mm Battery clip*1ea | |
| | FUSE | 25 A * 3ea | | 20 A * 3ea | |
| PROTECTION | BAT. LOW ALARM | 10±0.5V | | 19±0.8V | 21±1V |
| | BAT. LOW SHUTDOWN | 9.5±0.5V | | 18±0.8V | 20±1V |
| | OVER LOAD | >750W shut down o/p voltage, re-power on to recover | | | |
| | OVER VOLTAGE | 15 ~ 17V | | 30 ~ 32V | |
| | OVER TEMPERATURE | 60±5°C / 140±9°F | | | |
| | OUTPUT SHORT | Shut-off | | | |
| | BAT. POLARITY | By fuse open | | | |
| ENVIRONMENT | WORKING TEMP. | 0 ~ +30°C @100% load, 40°C @ 50% load | | | |
| | WORKING HUMIDITY | 20% ~ 90% RH non-condensing | | | |
| | STORAGE TEMP., HUMIDITY | -30 ~ +70°C / -22 ~ +158°F, 10 ~ 95% RH | | | |
| | TEMP. COEFFICIENT | ±0.05% / °C (0 ~ 50°C) | | | |
| SAFETY & EMC | ISOLATION RESISTANCE | I/P-O/P:100M Ohms min./ 500VDC / 25°C / 70% RH | | | |
| | EMI CONDUCTION & RADIATION | Compliance to EN55022 class B, 72/ 245/ CEE, 95/ 54/ CE | | | |
| | EMS IMMUNITY | Compliance to EN61000-4-2,3 | | | |
| | LVD | Compliance to EN60950 | | | |
| OTHERS | MTBF | 100Khrs min. MIL-HDBK-217F(25°C) | | | |
| | DIMENSION | 210*173*65mm (L*W*H) | | | |
| | PACKING | 2.1kg ; 8pcs / 20kg / CARTON | | | |
| | COOLING | by fan, >50% load fan on | | | |
| APPLICATIONS | Home appliance, Power tools, Office and Portable equipment and Vehicle ...etc. | | | | |

AC Output Receptacles (optional)

| | | | | | |
|--------|--------|--------|-----------|-----------|--------|
| | | | | | |
| TYPE-1 | TYPE-2 | TYPE-3 | TYPE-4 | TYPE-5 | TYPE-6 |
| JAPAN | USA | EUROPE | UNIVERSAL | AUSTRALIA | U.K |

■ Mechanical Specification

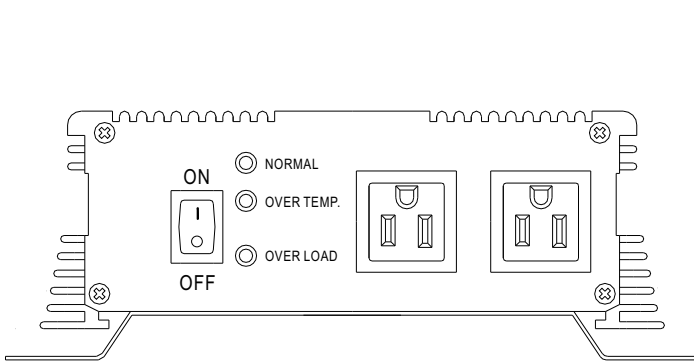
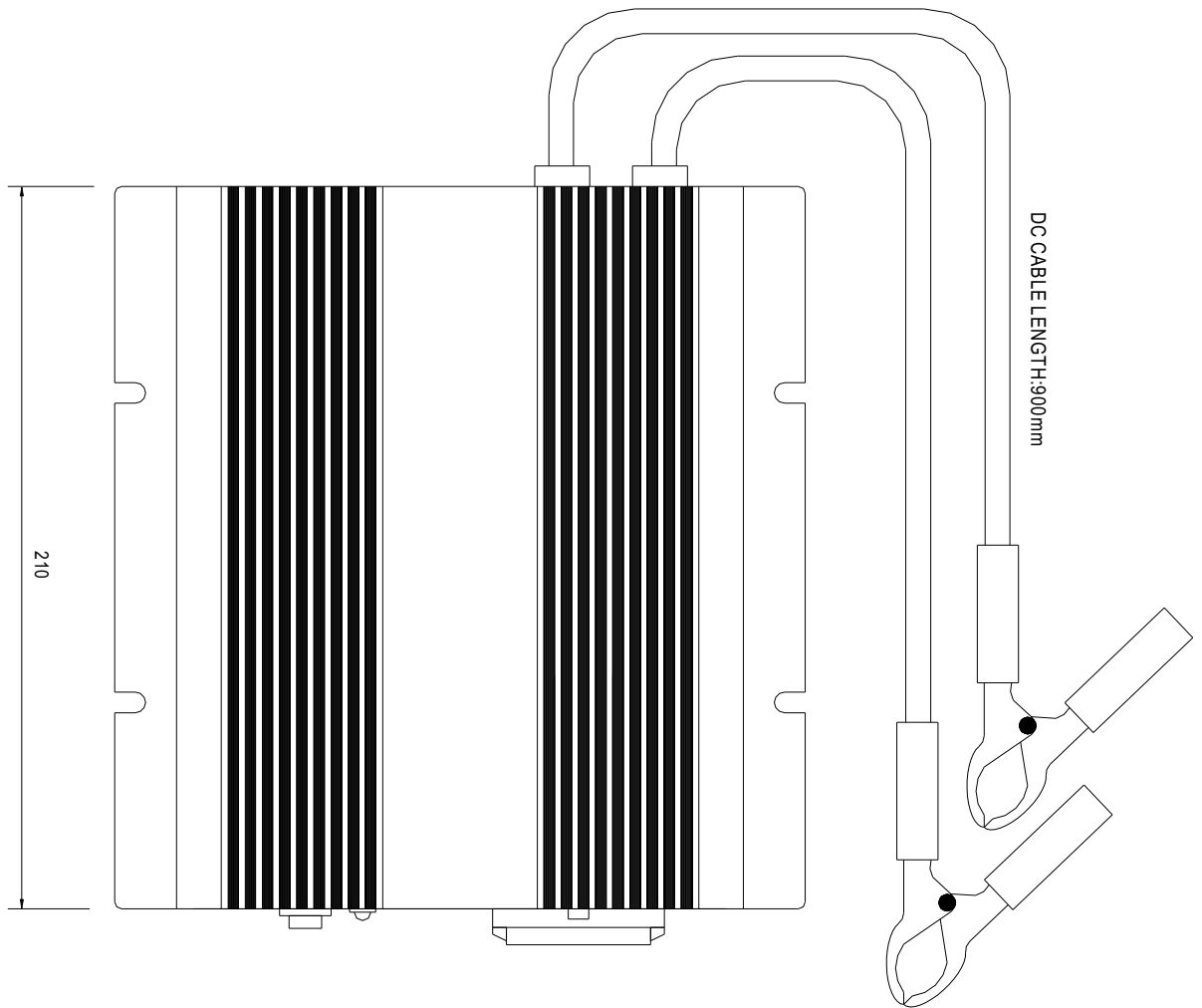
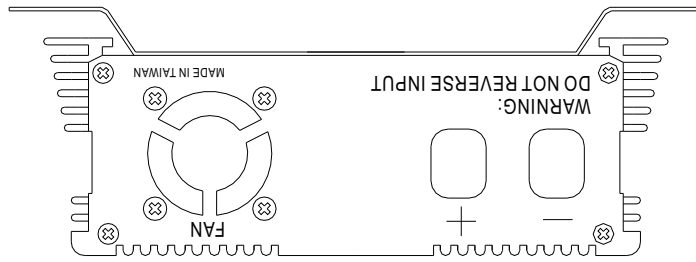

USA

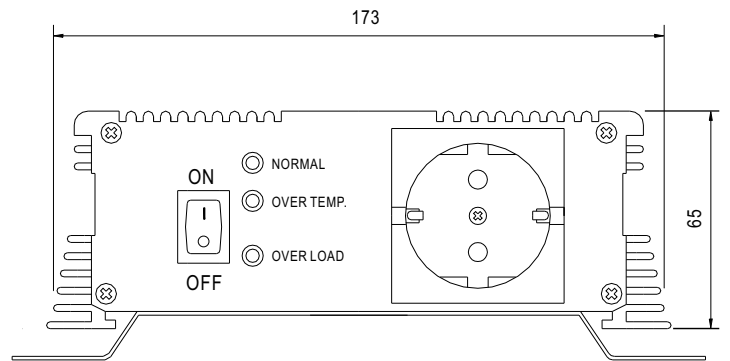

EUROPE