

CWC6395
 SUPERSEDES: **X116113-V7**

REV	DOCUMENT	CHANGED BY	CHECK
A	0013729	NM 10JUN05	AK

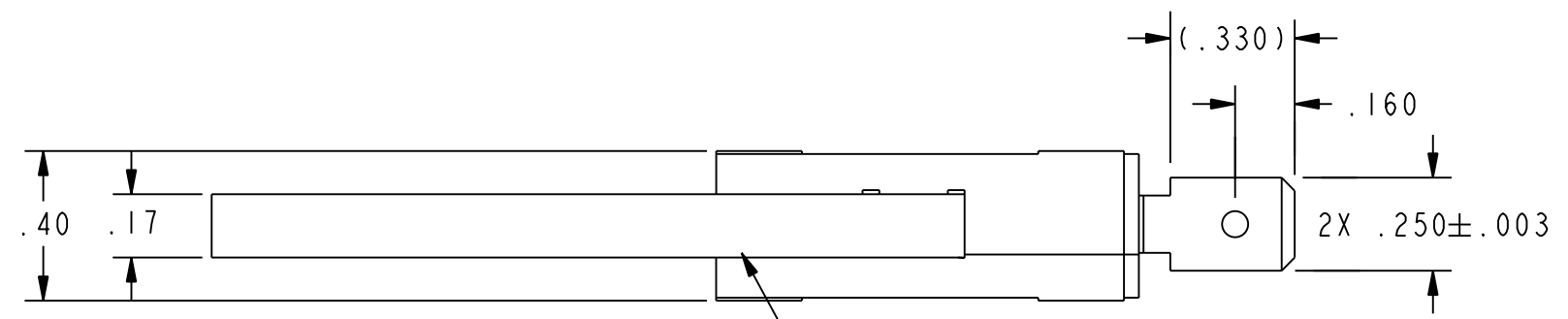

CORROSION RESISTANT
 STEEL ACTUATOR

NOTES

- 1 - MAXIMUM MECHANICAL DEAD BREAK OF .0135 CAN BE EXPECTED WITH THIS SWITCH CONSTRUCTION.
- 2 - SILVER PLATED TERMINALS.
- 3 - SWITCH WILL FUNCTION A MINIMUM OF 1000 ACTUATIONS AT RATED LOAD WHILE EXPOSED TO A 350° F ENVIRONMENT FOR 600 HOURS.

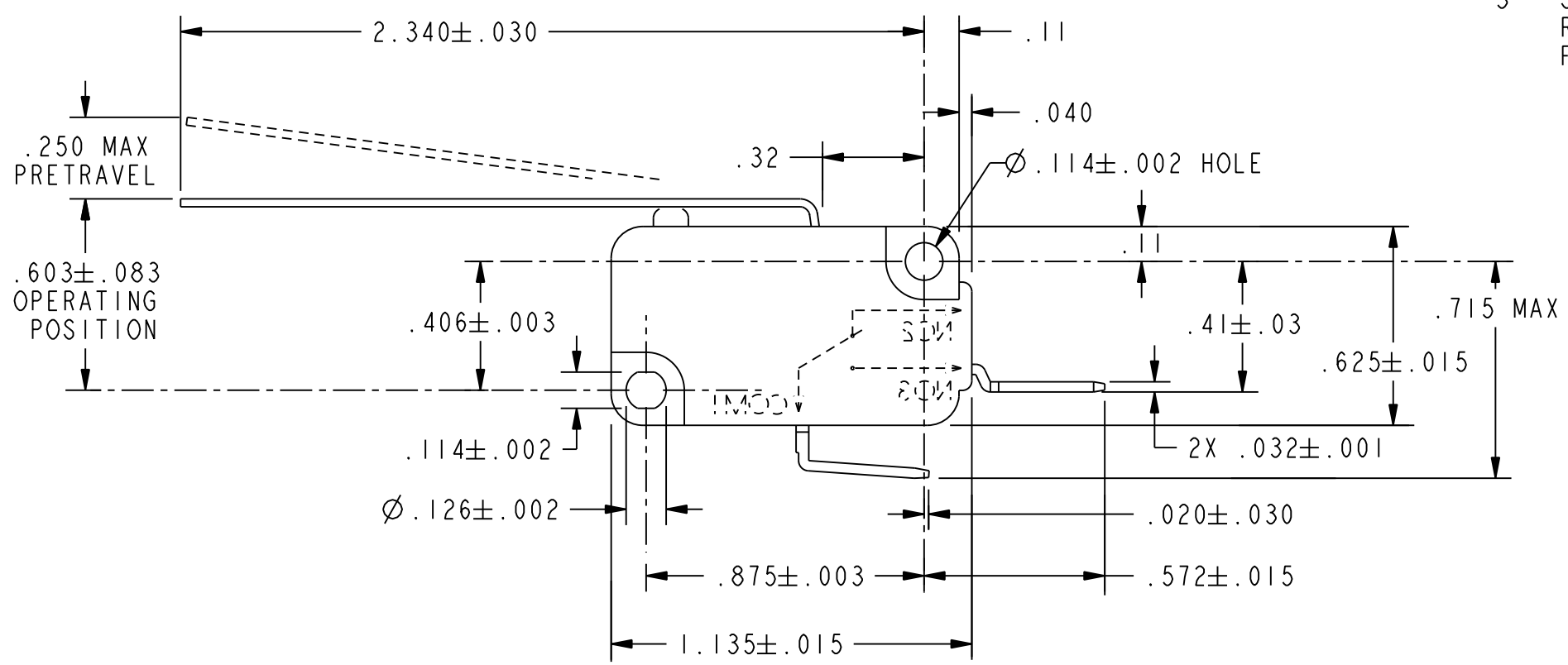

CHARACTERISTICS	
OPERATING FORCE-----	90 GRAMS MAX
RELEASE FORCE -----	4 GRAM MIN
DIFFERENTIAL TRAVEL -----	.054 MAX
OVERTRAVEL -----	.124 MIN
RELEASE TRAVEL -----	.030 MIN

ELECTRICAL DATA	
CONTACT ARRANGEMENT S P N O	
L264 15.1A 125, 250, 277 VAC	

UNLESS OTHERWISE SPECIFIED TOLERANCES ARE:			
	<input checked="" type="checkbox"/> US (inch) CUSTOMARY	<input type="checkbox"/> SI (mm) METRIC	
NO PLACE	X	±.040	±1
ONE PLACE	.X	±.030	±0,4
TWO PLACE	.XX	±.015	±0,15
THREE PLACE	.XXX	±.005	±
ANGLES		±	±
RAW MATERIAL-COMMERCIAL STANDARD			
THIRD ANGLE PROJECTION			

DRAWN	NM	10JUN05
CHECK	AK	10JUN05
THIS DRAWING COVERS A PROPRIETARY ITEM AND IS THE PROPERTY OF HONEYWELL. THIS DRAWING IS NOT TO BE COPIED OR USED WITHOUT THE PERMISSION OF HONEYWELL.		
DIMENSIONS ARE TO BE MET BEFORE PROTECTIVE COATINGS ARE APPLIED		
PTC 2D	ASME Y14.5M-1994	

Honeywell			
TITLE SWITCH, BASIC			
SIZE	DWG TYPE	DRAWING NAME	REV
B	I	V7-9W2AE9-048	A
SCALE 2 : 1		WEIGHT	SHEET 1 OF 1