

MICRO SWITCH
a Honeywell Division

FED. MFG. CODE 91 929

SWITCH - BASIC

CATALOG LISTING

V7-6A28D8C1-1

CW-C6006

CATALOG LISTING

V7-6A28D8C1-1

PAGE 1 OF 1

REPLACES

RELEASE NO. PR-19944

ISSUE

5

CHECK

REVISIONS

A	CO-74876	K D R	09 SEP 93
B	CO-76502	DCS	20 JAN 94
C	CO-77197	DCS	10 MAY 94
D	CO-79631	DCS	30 JAN 95

CHECK

30 APR 92

DAW

30 APR 92

CHECK

28 APR 92

JAK

DRAWN

DDM/CAD

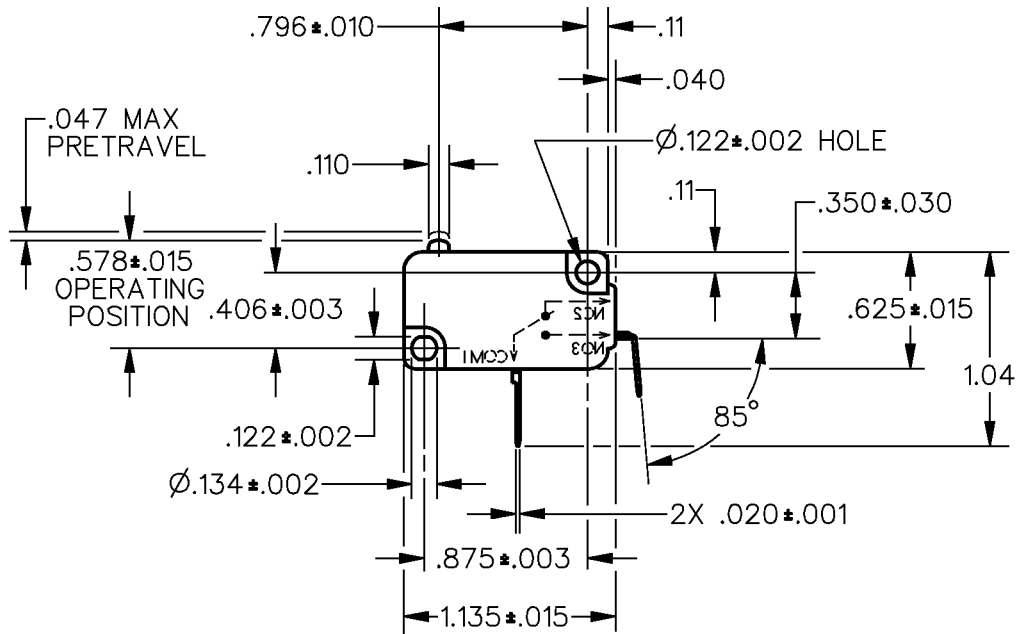
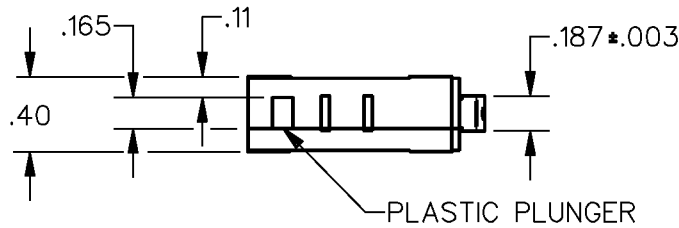

NOTE
1 - METRIC MOUNTING HOLES

ANSI Y14.5M-1982 APPLIES

THIS DRAWING COVERS A PROPRIETARY ITEM AND IS THE PROPERTY OF MICRO SWITCH, A DIVISION OF HONEYWELL. THIS DRAWING IS NOT TO BE COPIED OR USED WITHOUT THE APPROVAL OF MICRO SWITCH.

THIRD ANGLE PROJECTION

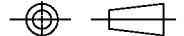

CHARACTERISTICS	ELECTRICAL DATA	SCALE FULL	DO NOT SCALE PRINT
OPERATING FORCE — — — — 6-14 OZ	CONTACT ARRANGEMENT S P N O	UNLESS OTHERWISE SPECIFIED TOLERANCES ARE	
RELEASE FORCE — — — — 4 OZ MIN	L162 5A 125, 250, 277 VAC 1/10HP 250 VAC	ONE PLACE (.0) ± .030	
DIFFERENTIAL TRAVEL — — .002-.010		TWO PLACE (.00) ± .015	
OVERTRAVEL — — — — .050 MIN		THREE PLACE (.000) ± .005	
RELEASE TRAVEL — — — .007 MIN		ANGLES ± 5°	
		WEIGHT	