

REV	DOCUMENT	CHANGED BY	CHECK
C	0018268	TSG 06JAN06	RJ

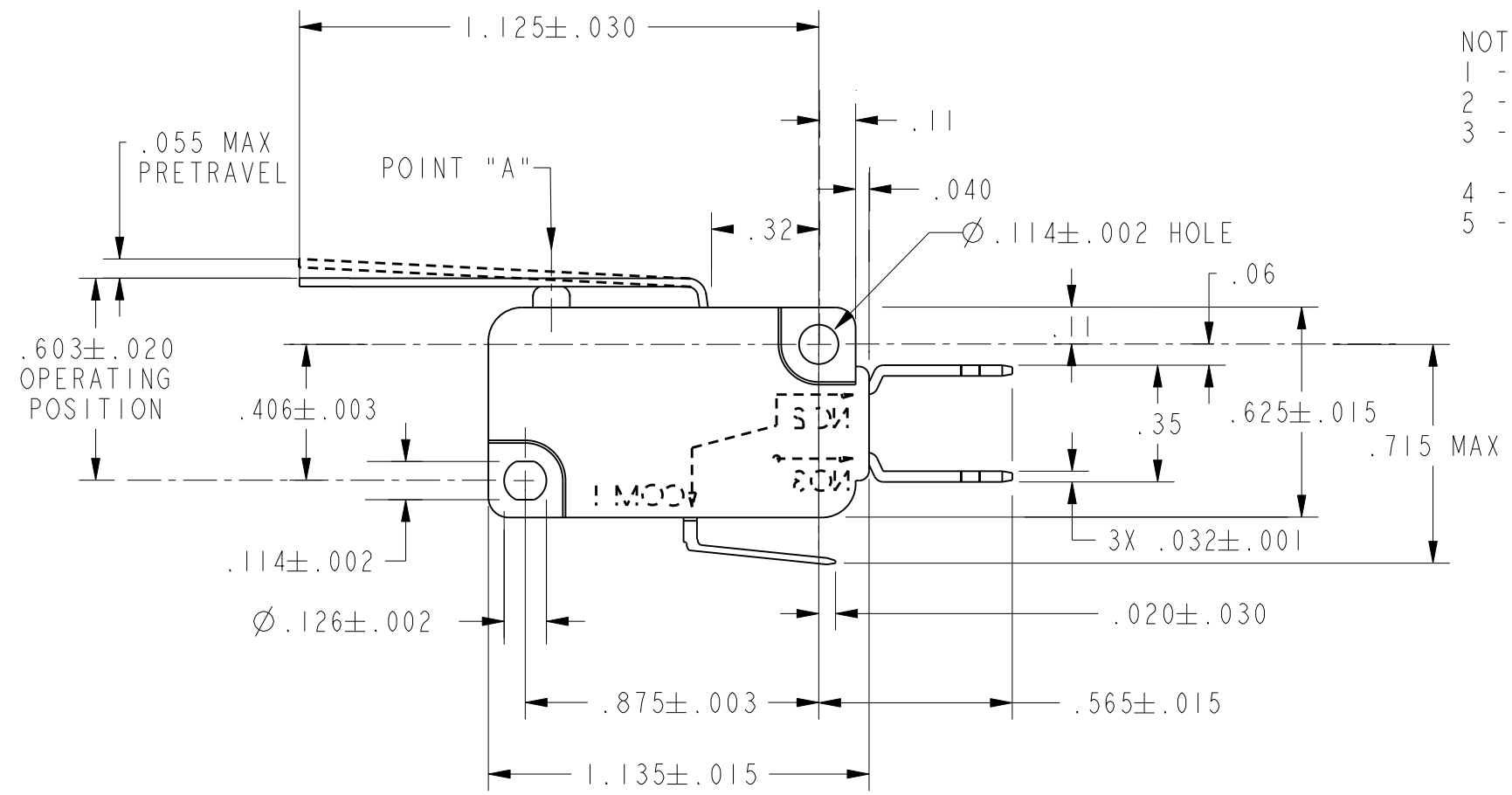
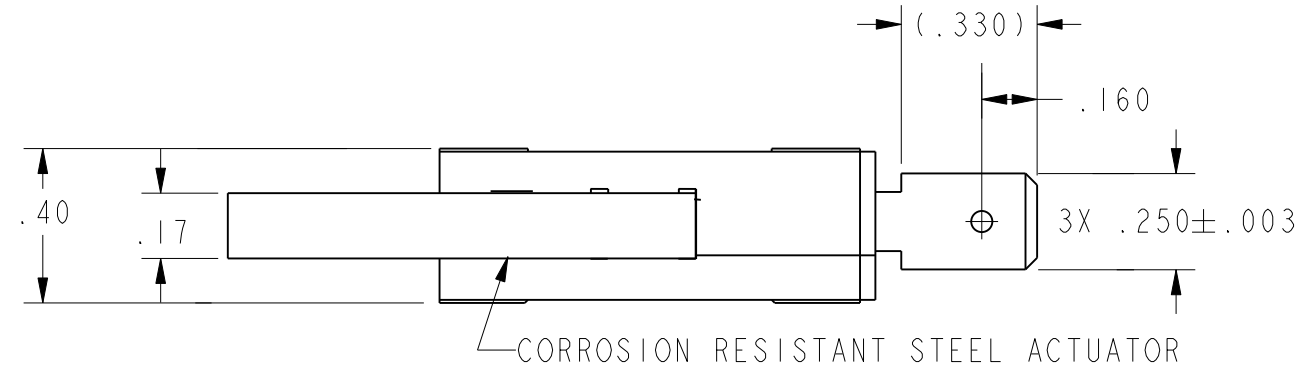

NOTES

- 1 - MARK CUSTOMER PART NUMBER "AIMO-1E77-179" ON SWITCH
- 2 - ALL CHARACTERISTICS MEASURED AT POINT "A"
- 3 - MAXIMUM MECHANICAL DEAD BREAK OF .0031 MAY BE EXPECTED WITH THIS SWITCH CONSTRUCTION
- 4 - SWITCH MATERIALS WILL WITHSTAND 150°C
- 5 - RESTRICTED LISTING

CHARACTERISTICS OPERATING FORCE ----- 271 GRAMS MAX RELEASE FORCE ----- 16 GRAMS MIN DIFFERENTIAL TRAVEL ----- .012 MAX OVERTRAVEL ----- .032 MIN RELEASE TRAVEL ----- .007 MIN		ELECTRICAL DATA CONTACT ARRANGEMENT S P D T 25A, 277 VAC 1HP, 125 VAC 2HP, 250 VAC 		UNLESS OTHERWISE SPECIFIED TOLERANCES ARE: NO PLACE X ±.040 ±1 ONE PLACE .X ±.030 ±0,4 TWO PLACE .XX ±.015 ±0,15 THREE PLACE .XXX ±.005 ± ANGLES ± ± RAW MATERIAL-COMMERCIAL STANDARD THIRD ANGLE PROJECTION 		DRAWN KSR 05MAY04 CHECK AK 05MAY04 THIS DRAWING COVERS A PROPRIETARY ITEM AND IS THE PROPERTY OF HONEYWELL. THIS DRAWING IS NOT TO BE COPIED OR USED WITHOUT THE PERMISSION OF HONEYWELL. DIMENSIONS ARE TO BE MET BEFORE PROTECTIVE COATINGS ARE APPLIED PTC ASME Y14.5M-1994					TITLE SWITCH, BASIC		SIZE DWG TYPE DRAWING NAME REV B I V7-1Z13E9-015-1 C	
						SCALE 2:1 WEIGHT SHEET 1 OF 1								