

HONEYWELL  
PART NUMBER

-

| REV | DOCUMENT | CHANGED BY | CHECK |
|-----|----------|------------|-------|
| 3   | 0041144  | SS 26JUN08 | BLR   |

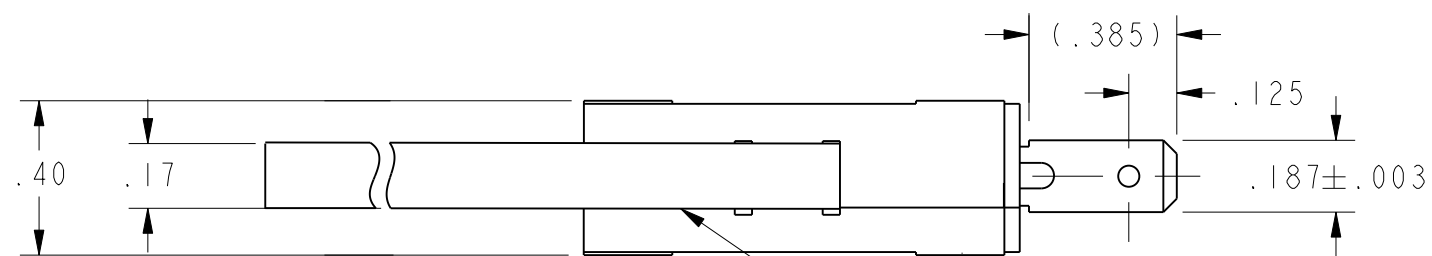

CORROSION RESISTANT  
STEEL ACTUATOR

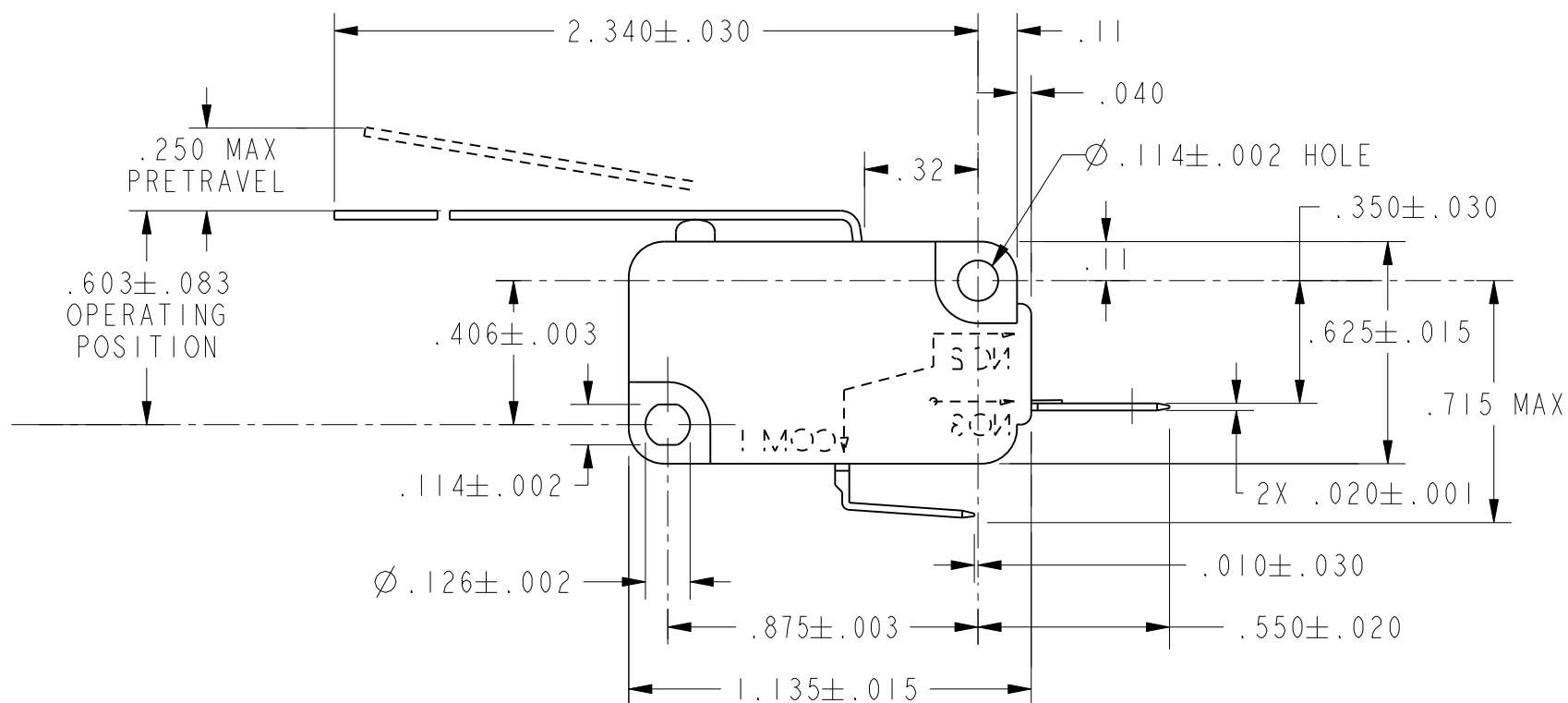

|                        |                             |
|------------------------|-----------------------------|
| RELEASE NO.<br>PR21569 | CATALOG LISTING<br>CW-B1734 |
| REPLACES<br>-          |                             |

| CHARACTERISTICS                    |
|------------------------------------|
| OPERATING FORCE ---- 46 GRAMS MAX  |
| RELEASE FORCE ----- 4 GRAMS MIN    |
| DIFFERENTIAL TRAVEL ----- .054 MAX |
| OVERTRAVEL ----- .124 MIN          |
| RELEASE TRAVEL ----- .030 MIN      |

| ELECTRICAL DATA                 |
|---------------------------------|
| CONTACT ARRANGEMENT<br>S P N O  |
| L215                            |
| 15.1A 1/2HP 125, 250 OR 277 VAC |
| 1/2A 125 VDC                    |
| 1/4A 250 VDC; 5A 125 VAC "L"    |

| DESIGN UNITS: INCH                    |
|---------------------------------------|
| TOLERANCES UNLESS NOTED:              |
| NO PLACES      x      ±      -        |
| ONE PLACE      .x      ±      0.030   |
| TWO PLACE      .xx      ±      0.015  |
| THREE PLACE    .xxx      ±      0.005 |
| ANGLES          x      ±      -       |
| THIRD ANGLE PROJECTION                |

|  |     |         |
|--|-----|---------|
| DRAWN  | DCS | 16FEB95 |
| CHECK  | -   | -       |
| THIS DRAWING COVERS A PROPRIETARY ITEM AND IS THE PROPERTY OF HONEYWELL. THIS DRAWING IS NOT TO BE COPIED OR USED WITHOUT THE PERMISSION OF HONEYWELL. |     |         |
| INTERPRET PER ANSI Y14.5M-1982 OTHER HONEYWELL ENGINEERING STANDARDS MAY APPLY   |     |         |
| Pro/ENGINEER   | 2D  |         |

|                               |          |           |                        |          |
|-------------------------------|----------|-----------|------------------------|----------|
| <b>Honeywell</b>              |          |           |                        |          |
| TITLE<br><b>SWITCH, BASIC</b> |          |           |                        |          |
| SIZE                          | TYPE     | CAGE CODE | DRAWING NAME           | REV      |
| <b>B</b>                      | <b>I</b> | -         | <b>V7-1C27D8-048-1</b> | <b>3</b> |
| SCALE                         | -        |           | SHEET                  | 1 OF 1   |