

HONEYWELL
PART NUMBER
V7-6C17D8-000-2

REV	DOCUMENT	CHANGED BY	CHECK
C	0086919	VKR 28FEB12	CMH

CWC6026

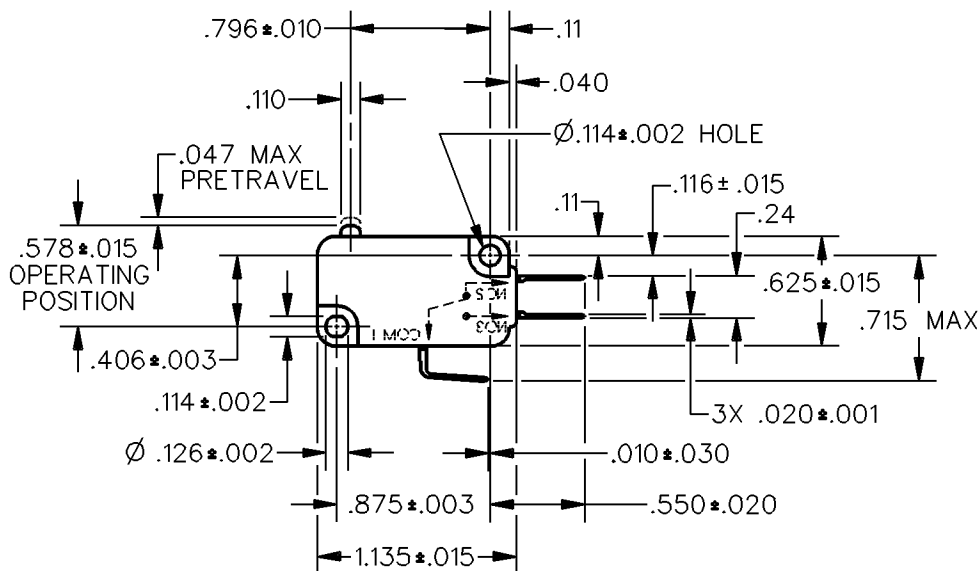
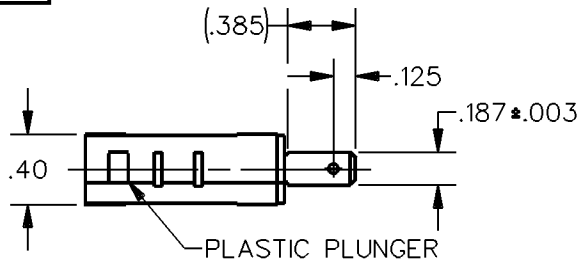

CHARACTERISTICS	ELECTRICAL DATA
OPERATING FORCE — — — — 6-14 OZ MAX	CONTACT ARRANGEMENT S P D T
RELEASE FORCE — — — — 4 OZ MIN	15.1A 1/2HP 125, 250, 277 VAC 1/2A 125 VDC; 1/4A 250 VDC 5A 125 VAC "L"
DIFFERENTIAL TRAVEL — — — .006-.016	
OVERTRAVEL — — — — .040 MIN	
FREE POSITION — — — — .625 MAX	
RELEASE TRAVEL — — — — .007 MIN	
	L215

REPLACES X115255-V7

DESIGN UNITS: INCH

TOLERANCES UNLESS NOTED:

NO PLACE	X	±	
ONE PLACE	.X	±	.030
TWO PLACE	.XX	±	.015
THREE PLACE	.XXX	±	.005
FOUR PLACE	.XXXX	±	
ANGLES		±	

THIRD ANGLE PROJECTION

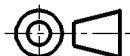

DRAWN	RS	18MAY05
CHECK	AK	18MAY05

THIS DRAWING COVERS A PROPRIETARY ITEM AND IS THE PROPERTY OF HONEYWELL. THIS DRAWING IS NOT TO BE COPIED OR USED WITHOUT THE PERMISSION OF HONEYWELL.

INTERPRET PER ASME Y14.5M-1994
OTHER HONEYWELL ENGINEERING
STANDARDS MAY APPLY

RASTER

Honeywell

TITLE
SWITCH - BASIC

SIZE	TYPE	DRAWING NAME	REV
A	I	V7-6C17D8-000-2	C
SCALE	---	SHEET	1 OF 1