

MICRO SWITCH

FREERPORT ILLINOIS, U.S.A
A DIVISION OF HONEYWELL

FED. MFG. CODE 9 1929

SWITCH - BASIC

12 HM19-5

12HM19-5

PAGE 1 OF 1

M

DRAWING NUMBER

ISSUE

7

REPLACES

RELEASE NO. PR-5805

CHECK

CHECK

CHECK

CHECK

CHECK

CHECK

REVISIONS

A	PR-5805
	RE R
	28 APR 76
B	CO
	5 10 22
	D J S
	25 MAR 82
C	CO 52357
	R J H
	18 NOV 82
D	CO 52357-2
	K A G
	30 DEC 82
E	CO 71228
	D A W
	29 OCT 91
F	CO 94220
	D L T
	24 MAR 99

FORMTEK
FO-52848-A
DRAWN

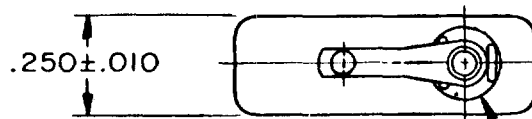

WOBBLEFRAM ACTUATOR SEAL

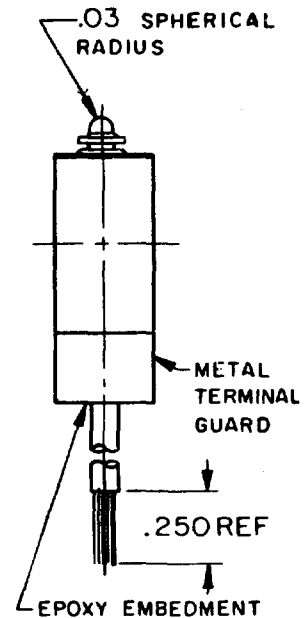
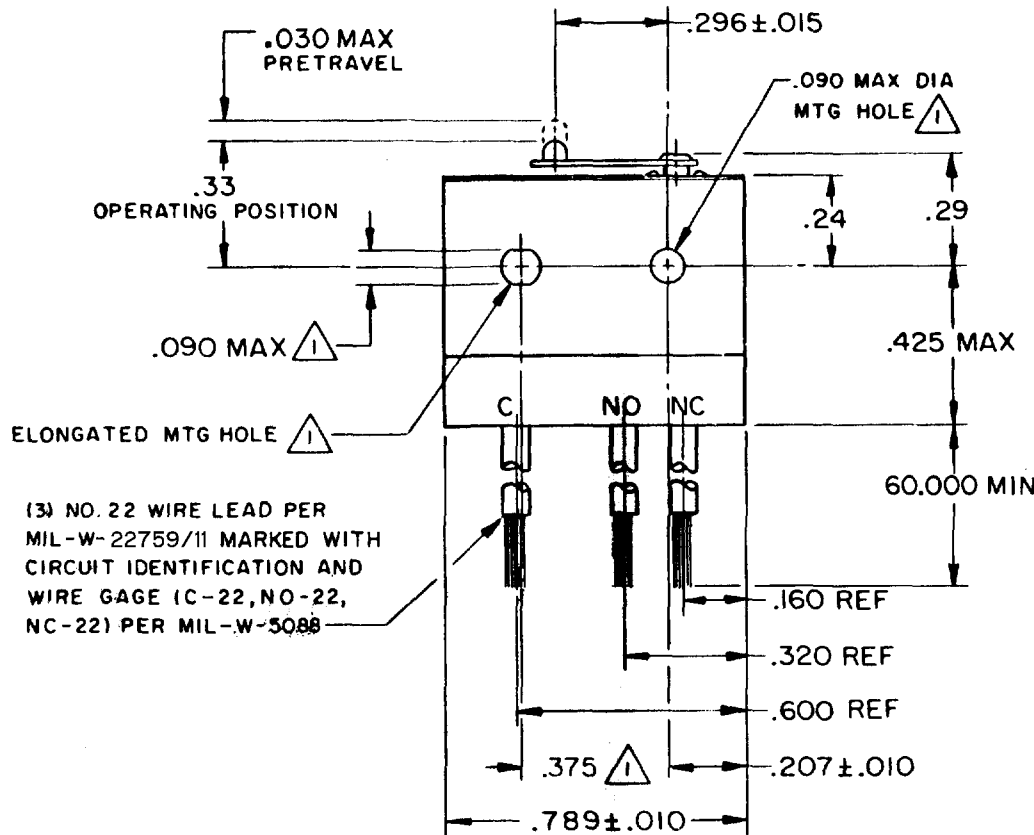

(3) NO. 22 WIRE LEAD PER MIL-W-22759/11 MARKED WITH CIRCUIT IDENTIFICATION AND WIRE GAGE (C-22, NO-22, NC-22) PER MIL-W-5088

NOTES

- 1 MOUNTING HOLES WILL ACCEPT PINS OR SCREWS OF .087 MAX DIA ON .375 ± .002 CENTERS
- 2 - FOR USE IN TEMPERATURE RANGE -85° F TO + 257° F
- 3 - HERMETICALLY SEALED (METAL-TO-METAL, GLASS-TO-METAL)
- 4 ALL EXPOSED PARTS ARE OF CORROSION RESISTANT MATERIALS
- 5 WEIGHT OF SWITCH ONLY IS 0.22 OZ MAX. WEIGHT OF CONDUCTOR GROUP ONLY IS 1.0 OZ MAX PER FOOT
- 6 - DO NOT APPLY MORE THAN 1 1/2 INCH-POUNDS OF TORQUE WHEN TIGHTENING MOUNTING SCREWS
- 7 - SWITCH WILL REMAIN FUNCTIONAL AFTER BEING SUBJECTED TO THE SHOCK OF MIL-S-901 GRADE A, SUBASSEMBLY, CLASS I, LIGHTWEIGHT TYPE C.

THIS DRAWING COVERS A PROPRIETARY ITEM AND IS THE PROPERTY OF MICRO SWITCH, A DIVISION OF HONEYWELL. THIS DRAWING IS NOT TO BE COPIED OR USED WITHOUT THE APPROVAL OF MICRO SWITCH.

THIRD ANGLE PROJECTION

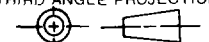

CHARACTERISTICS	
OPERATING FORCE	7 OZ MAX
RELEASE FORCE	1 OZ MIN
DIFFERENTIAL TRAVEL	.006 MAX
OVERTRAVEL	.003 MIN

ELECTRICAL DATA		
CONTACT ARRANGEMENT S P D T		
LINE VOLTAGE	INDUCTIVE LOAD	RESISTIVE LOAD
SEA LEVEL 70,000 FT 28 VDC	1 AMP	3 AMP
SEA LEVEL 115 VAC (400 CYCLE)	1 AMP	1 AMP

SCALE	2 TO 1		
DO NOT SCALE PRINT			
TOLERANCES			
APPLY TO DESIGN UNITS. CONVERSIONS ARE ONLY FOR REFERENCE. UNLESS NOTED, TOLERANCES ARE ±			
DIM. mm	TOL. mm/in	DIM. in	TOL. in
NO PLACES	X	1/04	
ONE PLACE	X,X	0.4/.016	X,X 0.8/.03
TWO PLACES	X,XX	0.15/.006	X,XX 0.38/.015
THREE PLACES	X,XXX		X,XXX 0.13/.005
ANGLES			
DESIGN UNITS	SI METRIC <input type="checkbox"/>	US CUSTOMARY <input checked="" type="checkbox"/>	
WEIGHT	5		