

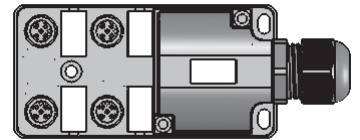

JDC Junction Blocks Micro-DC Series

4 Port2-13



6 Port14-25

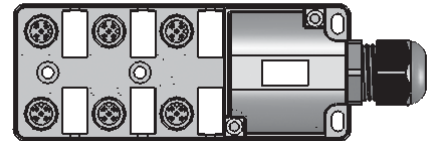

8 Port26-35

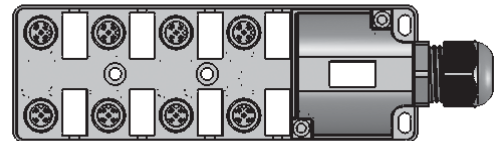

10 Port36-43

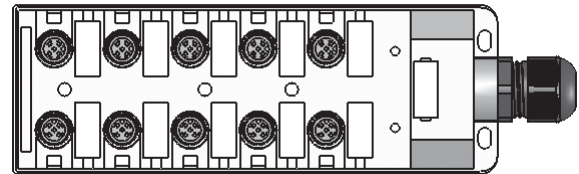

12 Port44-52

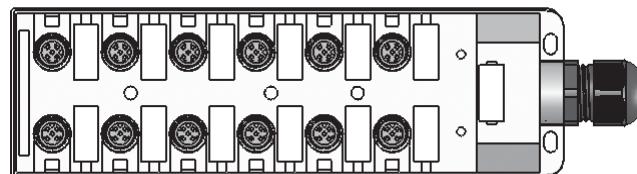

Specifications53

JDC Junction Blocks

JDC Junction Blocks 4 Port ❖ 3 Pin

MIN Receptacle ❖ MIN Plug

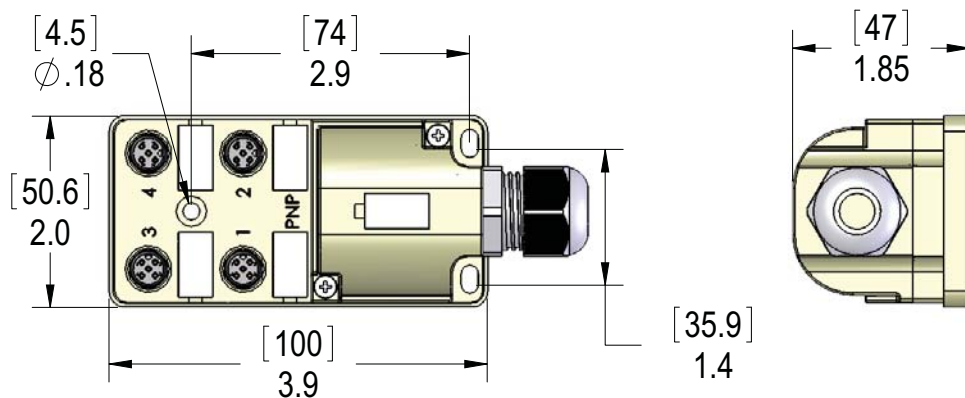

MIN Receptacle

MIN Plug

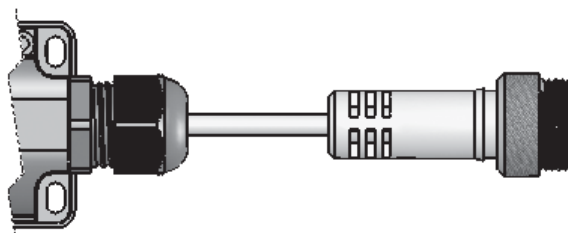
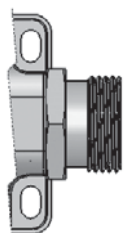

Trunk Connection	Length	Part Number		
		No LED	PNP	NPN
MIN Receptacle	N/A	JDC-430-006-M000	JDC-43P-206-M000	JDC-43N-206-M000
MIN Plug	0.3 M	JDC-430-006-M003	JDC-43P-206-M003	JDC-43N-206-M003

JDC Junction Blocks 4 Port ❖ 3 Pin

MIN Receptacle ❖ MIN Plug

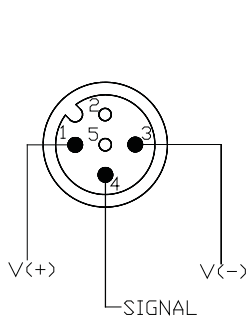

No LED Version

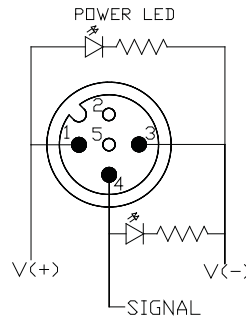

PNP Version

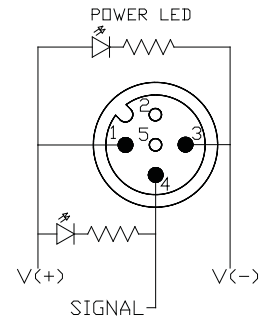

NPN Version

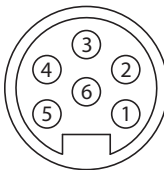
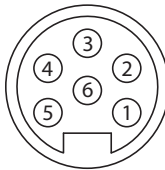
Function	MIN-6MR Receptacle Version	MIN-6MP Plug Version
		
+ V	PIN #6	PIN #6
- V	PIN #3	PIN #3
PORT 1 PIN 4	PIN #2	PIN #2
PORT 2 PIN 4	PIN #1	PIN #1
PORT 3 PIN 4	PIN #5	PIN #5
PORT 4 PIN 4	PIN #4	PIN #4
Mating Plug for Receptacle or Plug	MIN-6FP...	MIN-6FP...

JDC Junction Blocks 4 Port ❖ 4 Pin

Field Wireable ❖ Cable ❖ D-Sub

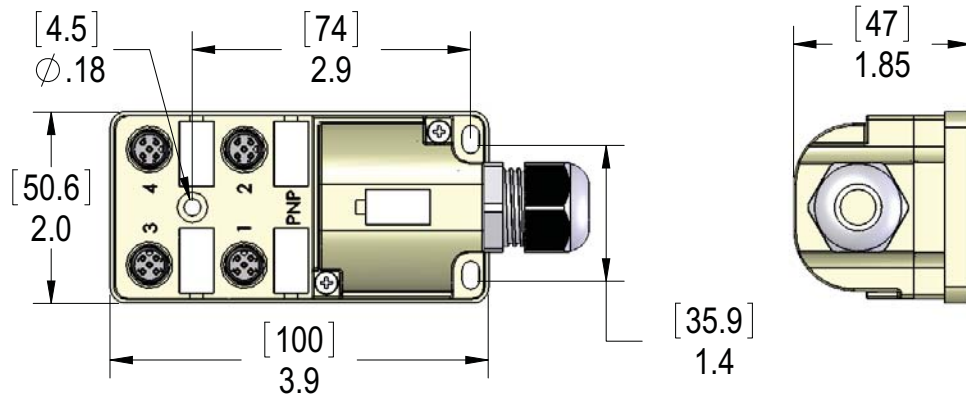

Field Wireable

Cable

D-Sub

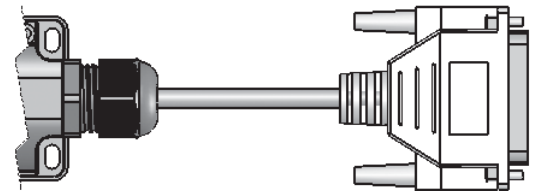
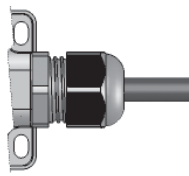
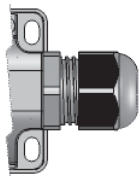

Trunk Connection	Length	Part Number		
		No LED	PNP	NPN
Field Wireable	N/A	JDC-440-007-F000	JDC-44P-207-F000	JDC-44N-207-F000
Cable	5 M	JDC-440-007-C050	JDC-44P-207-C050	JDC-44N-207-C050
	10 M	JDC-440-007-C100	JDC-44P-207-C100	JDC-44N-207-C100
9 PIN D-SUB	0.3 M	JDC-440-009-D003	JDC-44P-209-D003	JDC-44N-209-D003
	6 M	JDC-440-009-D060	JDC-44P-209-D060	JDC-44N-209-D060

Other cable lengths are available, please consult the factory.

JDC Junction Blocks 4 Port ❖ 4 Pin

Field Wireable ❖ Cable ❖ D-Sub

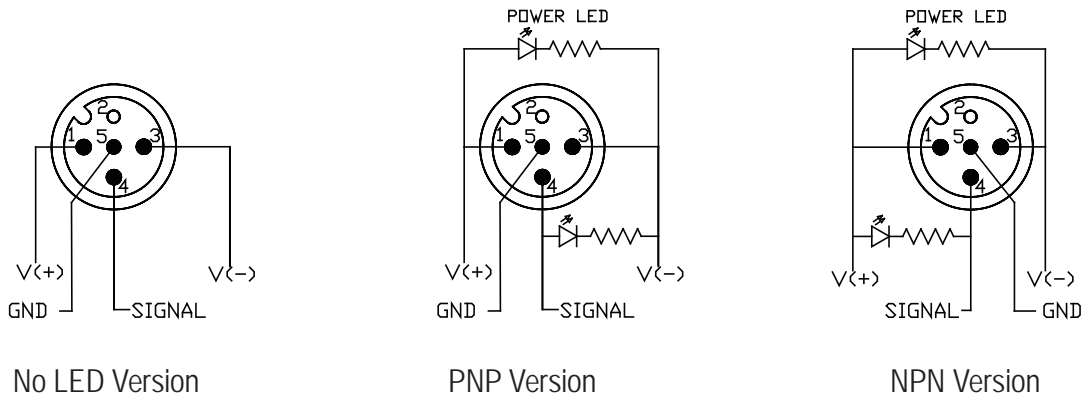

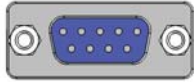
Function	Cable Version	9 PIN Male D-SUB
	Cable O.D. 0.34"	
+ V	Brown	PIN #6 & #7
- V	Blue	PIN #8 & #9
Ground	Green/Yellow	Shield
PORT 1 PIN 4	White	PIN #1
PORT 2 PIN 4	Green	PIN #2
PORT 3 PIN 4	Yellow	PIN #3
PORT 4 PIN 4	Gray	PIN #4

JDC Junction Blocks

JDC Junction Blocks 4 Port ❖ 4 Pin

MIN Receptacle ❖ MIN Plug ❖ M23 Receptacle

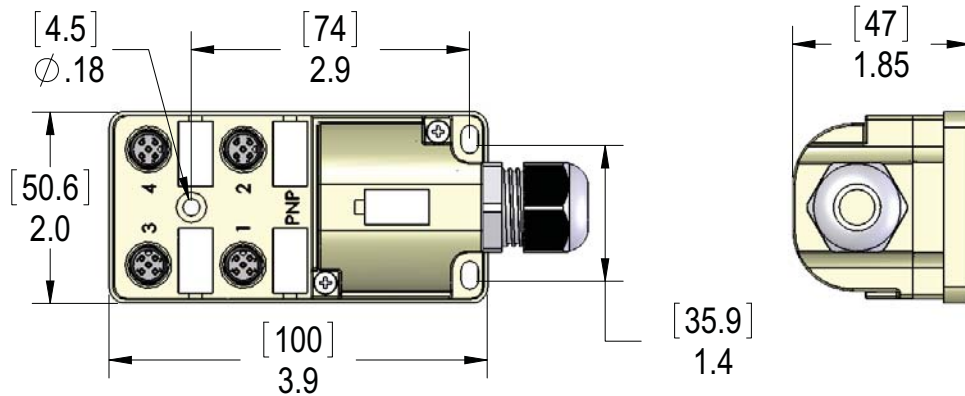

MIN Receptacle

MIN Plug

M23 Receptacle

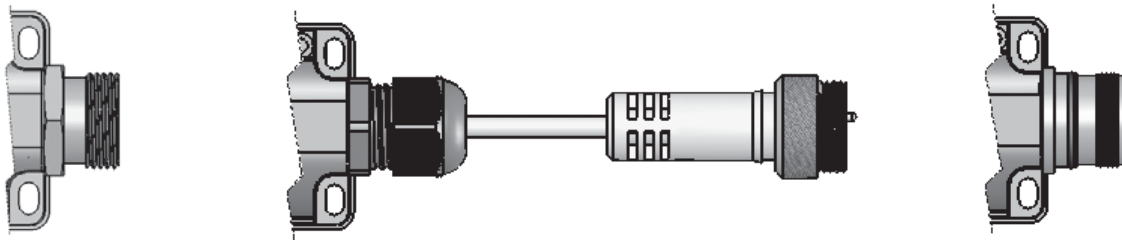

Trunk Connection	Length	Part Number		
		No LED	PNP	NPN
MIN 7 Receptacle	N/A	JDC-440-007-M000	JDC-44P-207-M000	JDC-44N-207-M000
MIN 7 Plug	0.3 M	JDC-440-007-M003	JDC-44P-207-M003	JDC-44N-207-M003
MIN 12 Receptacle	N/A	JDC-440-012-M000	JDC-44P-212-M000	JDC-44N-212-M000
MIN 12 Plug	0.3 M	JDC-440-012-M003	JDC-44P-212-M003	JDC-44N-212-M003
M23 Receptacle	N/A	JDC-440-012-V000	JDC-44P-212-V000	JDC-44N-212-V000

JDC Junction Blocks 4 Port ❖ 4 Pin

MIN Receptacle ❖ MIN Plug ❖ M23 Receptacle

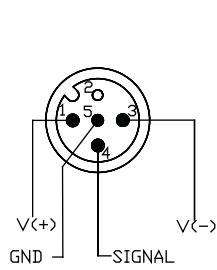

No LED Version

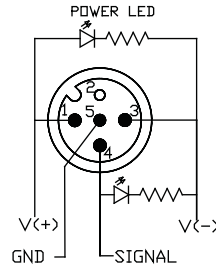

PNP Version

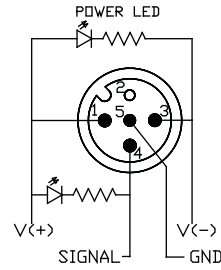

NPN Version

Function	MIN-7 Receptacle & Plug Version	MIN-12 Receptacle & Plug Version	12 PIN M23 Receptacle Version
+ V	PIN #6	PIN #10	PIN #11
- V	PIN #3	PIN #11	PIN #10 & #9
Ground	PIN #7	PIN #9	PIN #12
PORT 1 PIN 4	PIN #2	PIN #1	PIN #1
PORT 2 PIN4	PIN #1	PIN #2	PIN #2
PORT 3 PIN 4	PIN #5	PIN #3	PIN #3
PORT 4 PIN 4	PIN #4	PIN #4	PIN #4
Mating Plug for Receptacle or Plug	MIN-7FPX-xx	MIN-12FP-xx	MCV-12FP-xx

JDC Junction Blocks 4 Port ❖ 5 Pin

Field Wireable ❖ Cable ❖ D-Sub

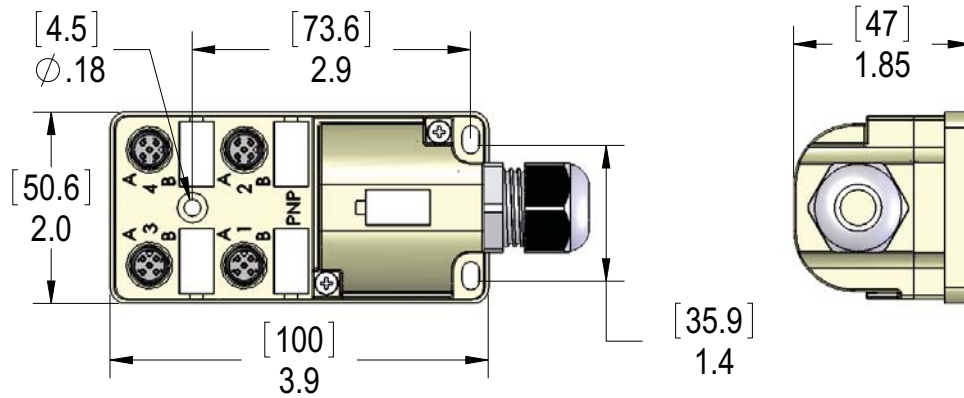

Field Wireable

Cable

D-Sub

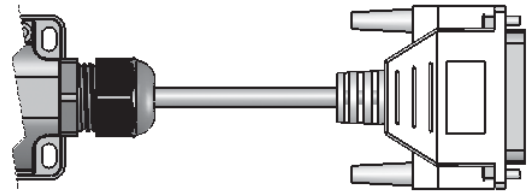
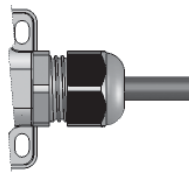
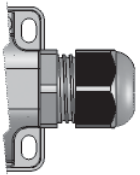

Trunk Connection	Length	Part Number		
		No LED	PNP	NPN
Field Wireable	N/A	JDC-450-011-F000	JDC-45P-211-F000	JDC-45N-211-F000
Cable	5 M	JDC-450-011-C050	JDC-45P-211-C050	JDC-45N-211-C050
	10 M	JDC-450-011-C100	JDC-45P-211-C100	JDC-45N-211-C100
25 PIN D-SUB	0.3 M	JDC-450-025-D003	JDC-45P-225-D003	JDC-45N-225-D003
	6 M	JDC-450-025-D060	JDC-45P-225-D060	JDC-45N-225-D060

Other cable lengths are available, please consult the factory.

JDC Junction Blocks 4 Port ❖ 5 Pin

Field Wireable ❖ Cable ❖ D-Sub

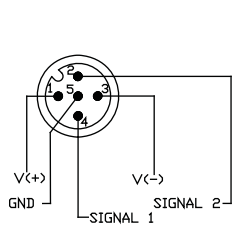

No LED Version

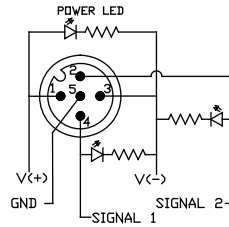

PNP Version

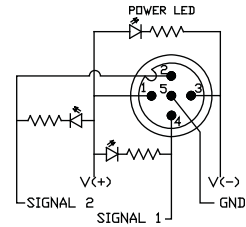

NPN Version

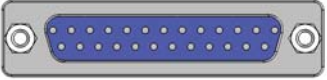
Function	Cable Version	25 PIN Male D-SUB
	Cable O.D. 0.38"	
+ V	Brown	PIN #22 & #23
- V	Blue	PIN #24 & #25
Ground	Green/Yellow	Shield
PORT 1 PIN 2	Pink	PIN #1
PORT 1 PIN 4	White	PIN #2
PORT 2 PIN 2	Red	PIN #3
PORT 2 PIN 4	Green	PIN #4
PORT 3 PIN 2	Black	PIN #5
PORT 3 PIN 4	Yellow	PIN #6
PORT 4 PIN 2	Violet	PIN #7
PORT 4 PIN 4	Gray	PIN #8

JDC Junction Blocks 4 Port ❖ 5 Pin

MIN Receptacle ❖ MIN Plug ❖ M23 Receptacle

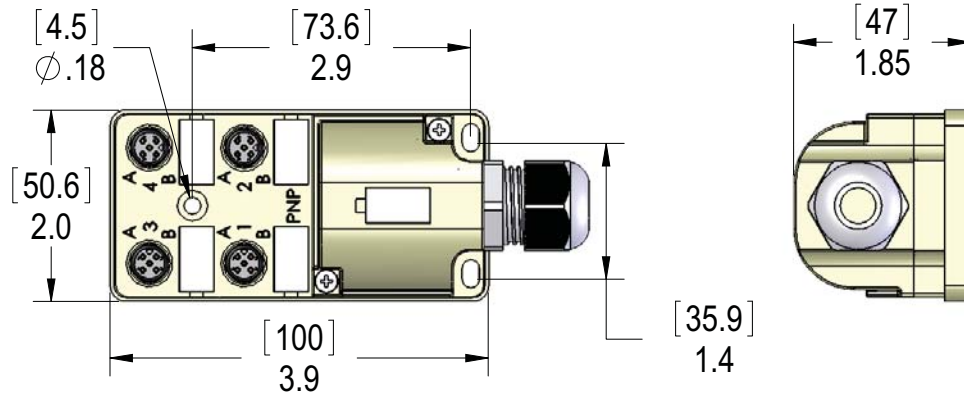

MIN Receptacle

MIN Plug

M23 Receptacle

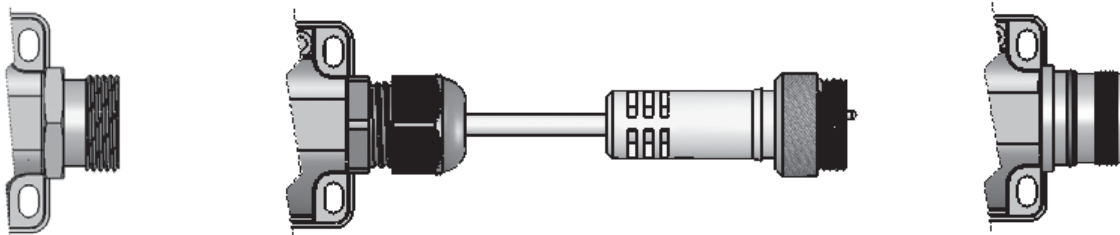

Trunk Connection	Length	Part Number		
		No LED	PNP	NPN
MIN 12 Receptacle	N/A	JDC-450-012-M000	JDC-45P-212-M000	JDC-45N-212-M000
MIN 12 Plug	0.3 M	JDC-450-012-M003	JDC-45P-212-M003	JDC-45N-212-M003
MIN 19 Receptacle	N/A	JDC-450-019-M000	JDC-45P-219-M000	JDC-45N-219-M000
MIN 19 Plug	0.3 M	JDC-450-019-M003	JDC-45P-219-M003	JDC-45N-219-M003
M23 Receptacle	N/A	JDC-450-019-V000	JDC-45P-219-V000	JDC-45N-219-V000

JDC Junction Blocks 4 Port ❖ 5 Pin

MIN Receptacle ❖ MIN Plug ❖ M23 Receptacle

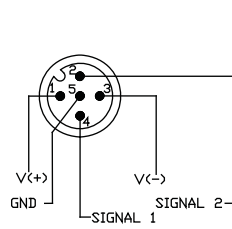

No LED Version

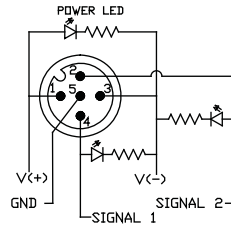

PNP Version

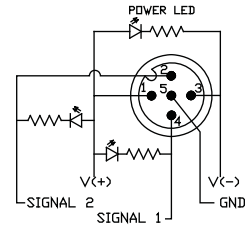

NPN Version

Function	MIN-12 Receptacle & Plug Version	MIN-19 Receptacle & Plug Version	19 PIN M23 Receptacle Version
+ V	PIN #10	PIN #7	PIN #19
- V	PIN #11	PIN #5	PIN #6
Ground	PIN #9	PIN #12	PIN #12
PORT 1 PIN 2	PIN #5	PIN #19	PIN #7
PORT 1 PIN 4	PIN #1	PIN #15	PIN #15
PORT 2 PIN 4	PIN #6	PIN #4	PIN #4
PORT 2 PIN 4	PIN #2	PIN #6	PIN #5
PORT 3 PIN 2	PIN #7	PIN #8	PIN #8
PORT 3 PIN 4	PIN #3	PIN #16	PIN #16
PORT 4 PIN 2	PIN #8	PIN #14	PIN #14
PORT 4 PIN 4	PIN #4	PIN #3	PIN #3

JDC Junction Blocks 4 Port ❖ 5 Pin

Straight Wired

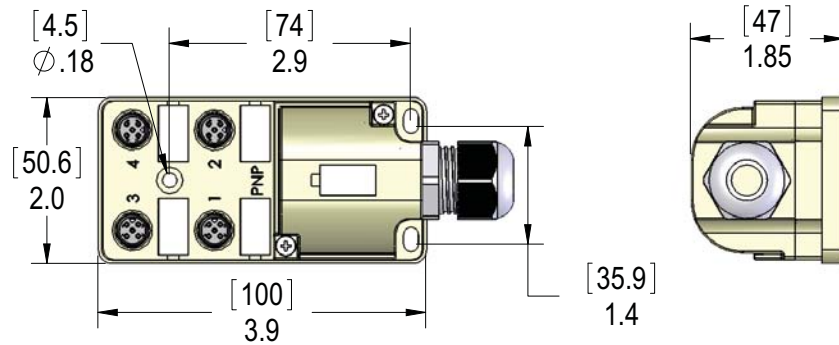

Field Wireable

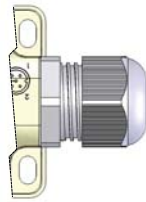

Cable

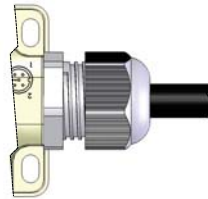

Trunk Connection	Length	Part Number
Field Wireable	N/A	JDC-4A0-017-F000
Cable	5 M	JDC-4A0-017-C050
	10 M	JDC-4A0-017-C100

Other cable lengths are available, please consult the factory.

JDC Junction Blocks 4 Port ❖ 5 Pin

Straight Wired

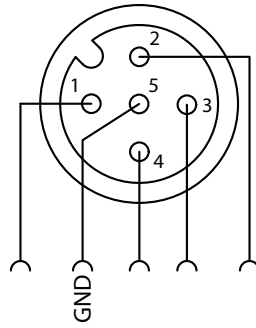

Function	Cable Version
	Cable O.D. 0.43"
ALL PORTS PIN 5	Green/Yellow
PORT 1 PIN 1	Gray/Pink
PORT 1 PIN 2	Pink
PORT 1 PIN 3	Red/Blue
PORT 1 PIN 4	White
PORT 2 PIN 1	Brown/Green
PORT 2 PIN 2	Red
PORT 2 PIN 3	White/Green
PORT 2 PIN 4	Green
PORT 3 PIN 1	Yellow/Brown
PORT 3 PIN 2	Black
PORT 3 PIN 3	White/Yellow
PORT 3 PIN 4	Yellow
PORT 4 PIN 1	Gray/Brown
PORT 4 PIN 2	Violet
PORT 4 PIN 3	White/Gray
PORT 4 PIN 4	Gray

JDC Junction Blocks 6 Port ❖ 3 Pin

MIN Receptacle ❖ MIN Plug

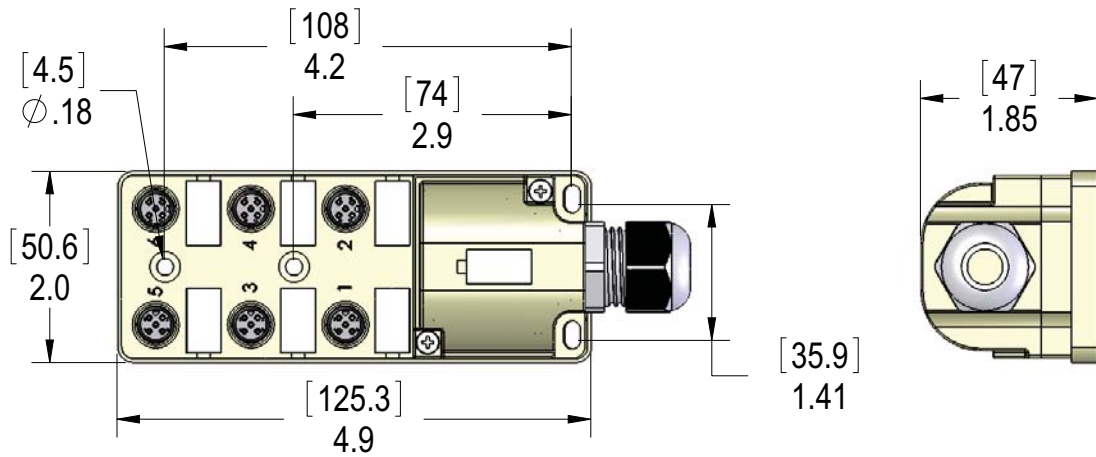

MIN Receptacle

MIN Plug

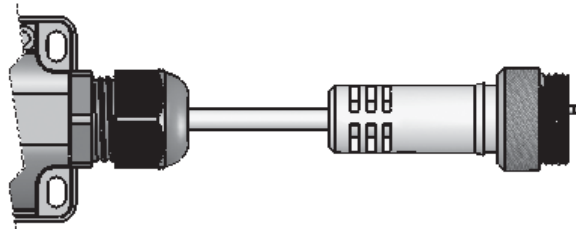
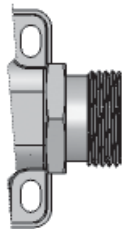

Trunk Connection	Length	Part Number		
		No LED	PNP	NPN
MIN 8 Receptacle	N/A	JDC-630-008-M000	JDC-63P-208-M000	JDC-63N-208-M000
MIN 8 Plug	0.3 M	JDC-630-008-M003	JDC-63P-208-M003	JDC-63N-208-M003

JDC Junction Blocks

JDC Junction Blocks 6 Port ❖ 3 Pin

MIN Receptacle ❖ MIN Plug

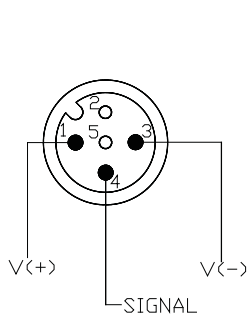

No LED Version

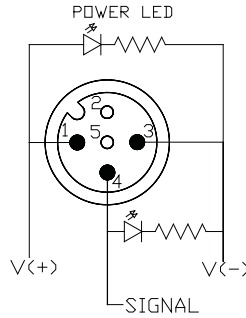

PNP Version

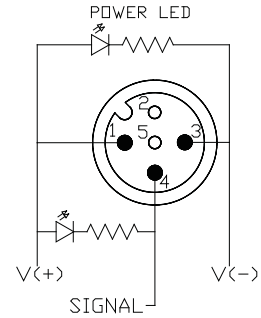

NPN Version

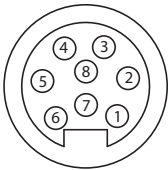
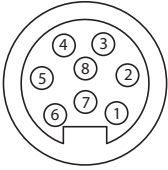
Function	MIN-8MR Receptacle Version	MIN-8MP Plug Version
		
+ V	PIN #8	PIN #8
- V	PIN #7	PIN #7
PORT 1 PIN 4	PIN #6	PIN #6
PORT 2 PIN 4	PIN #5	PIN #5
PORT 3 PIN 4	PIN #4	PIN #4
PORT 4 PIN 4	PIN #3	PIN #3
PORT 5 PIN 4	PIN #2	PIN #2
PORT 6 PIN 4	PIN #1	PIN #1
Mating Plug for Receptacle or Plug	MIN-8FPX...	MIN-8FP...

JDC Junction Blocks 6 Port ❖ 4 Pin

Field Wireable ❖ Cable ❖ D-Sub

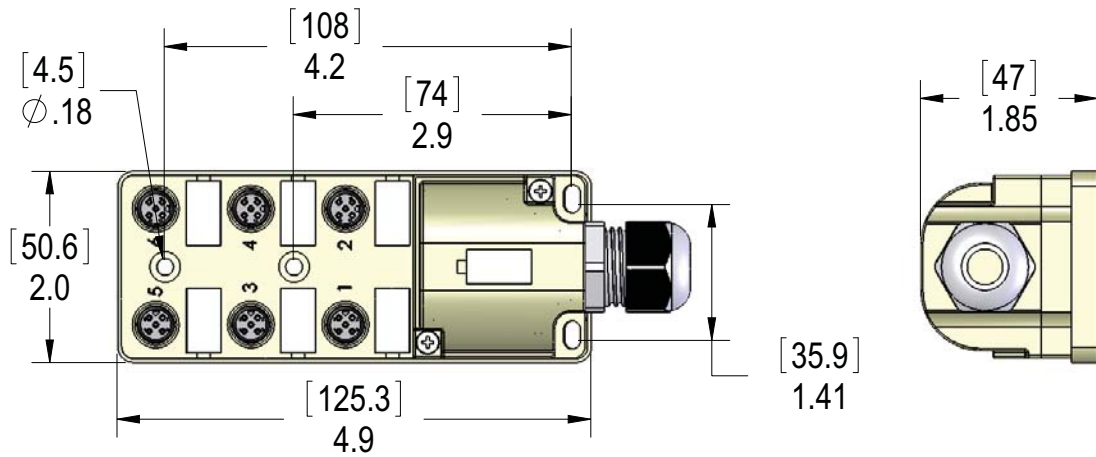

Field Wireable

Cable

D-Sub

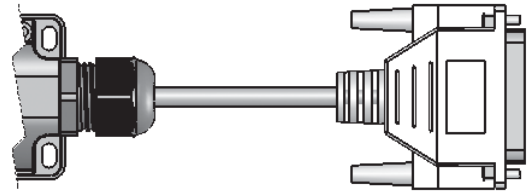
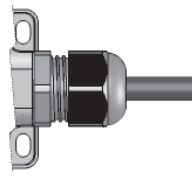
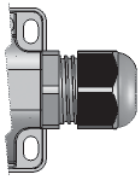

Trunk Connection	Length	Part Number		
		No LED	PNP	NPN
Field Wireable	N/A	JDC-640-009-F000	JDC-64P-209-F000	JDC-64N-209-F000
Cable	5 M	JDC-640-009-C050	JDC-64P-209-C050	JDC-64N-209-C050
	10 M	JDC-640-009-C100	JDC-64P-209-C100	JDC-64N-209-C100
9 PIN D-SUB	0.3 M	JDC-640-009-D003	JDC-64P-209-D003	JDC-64N-209-D003
	6 M	JDC-640-009-D060	JDC-64P-209-D060	JDC-64N-209-D060

Other cable lengths are available, please consult the factory.

JDC Junction Blocks 6 Port ❖ 4 Pin

Field Wireable ❖ Cable ❖ D-Sub

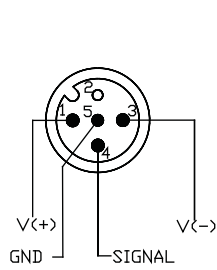

No LED Version

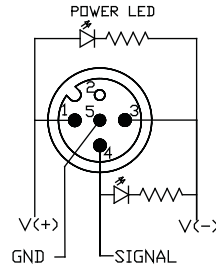

PNP Version

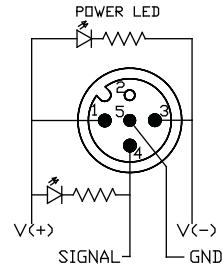

NPN Version

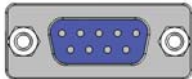
Function	Cable Version	9 PIN Male D-SUB
	Cable O.D. 0.35"	
+ V	Brown	PIN #7 & #8
- V	Blue	PIN #9
Ground	Green/Yellow	Shield
PORT 1 PIN 4	White	PIN #1
PORT 2 PIN 4	Green	PIN #2
PORT 3 PIN 4	Yellow	PIN #3
PORT 4 PIN 4	Gray	PIN #4
PORT 5 PIN 4	Pink	PIN #5
PORT 6 PIN 4	Red	PIN #6

JDC Junction Blocks 6 Port ❖ 4 Pin

MIN Receptacle ❖ MIN Plug ❖ M23 Receptacle

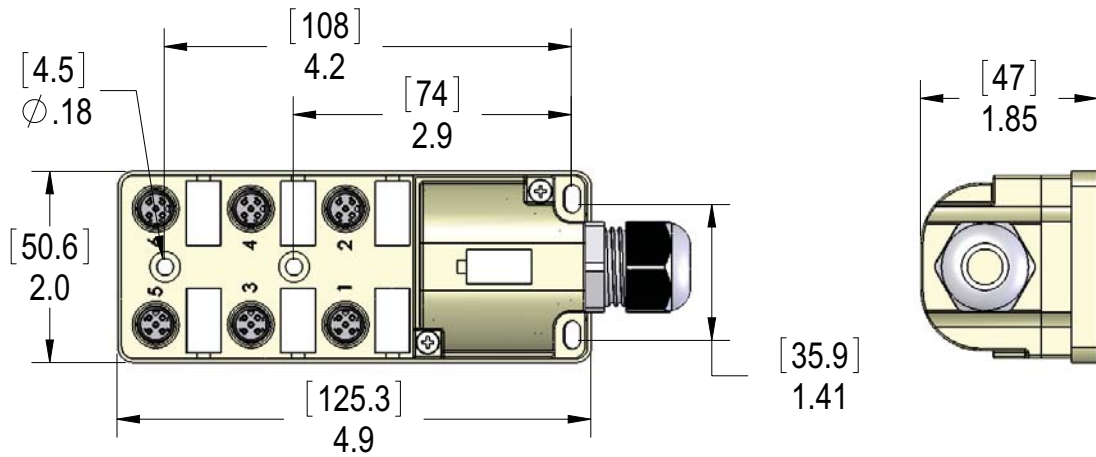

MIN Receptacle

MIN Plug

M23 Receptacle

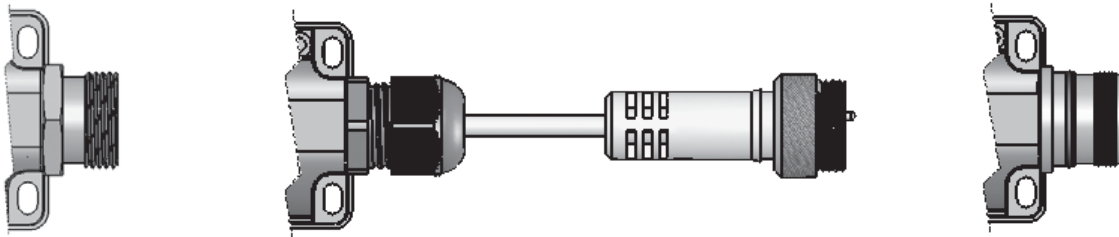

Trunk Connection	Length	Part Number		
		No LED	PNP	NPN
MIN 9 Receptacle	N/A	JDC-640-009-M000	JDC-64P-209-M000	JDC-64N-209-M000
MIN 9 Plug	0.3 M	JDC-640-009-M003	JDC-64P-209-M003	JDC-64N-209-M003
M23 Receptacle	N/A	JDC-640-012-V000	JDC-64P-212-V000	JDC-64N-212-V000

JDC Junction Blocks

JDC Junction Blocks 6 Port ❖ 4 Pin

MIN Receptacle ❖ MIN Plug ❖ M23 Receptacle

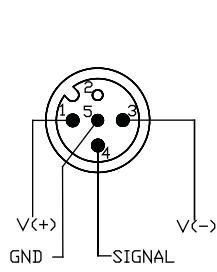

No LED Version

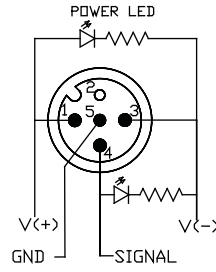

PNP Version

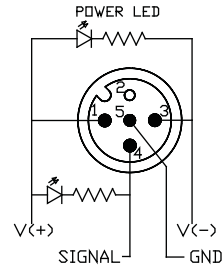

NPN Version

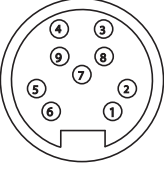
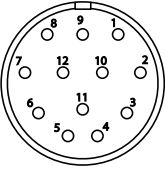
Function	MIN-9 Receptacle & Plug Version	12 PIN M23 Receptacle Version
		
+ V	PIN #8	PIN #11
- V	PIN #9	PIN #9 & #10
Ground	PIN #7	PIN #12
PORT 1 PIN 4	PIN #1	PIN #1
PORT 2 PIN4	PIN #2	PIN #2
PORT 3 PIN 4	PIN #3	PIN #3
PORT 4 PIN 4	PIN #4	PIN #4
PORT 5 PIN 4	PIN #5	PIN #5
PORT 6 PIN 4	PIN #6	PIN #6
Mating Plug for Receptacle or Plug	MIN-9FPX-xx	MCV-12FP-xx

JDC Junction Blocks 6 Port ❖ 5 Pin

Field Wireable ❖ Cable ❖ D-Sub

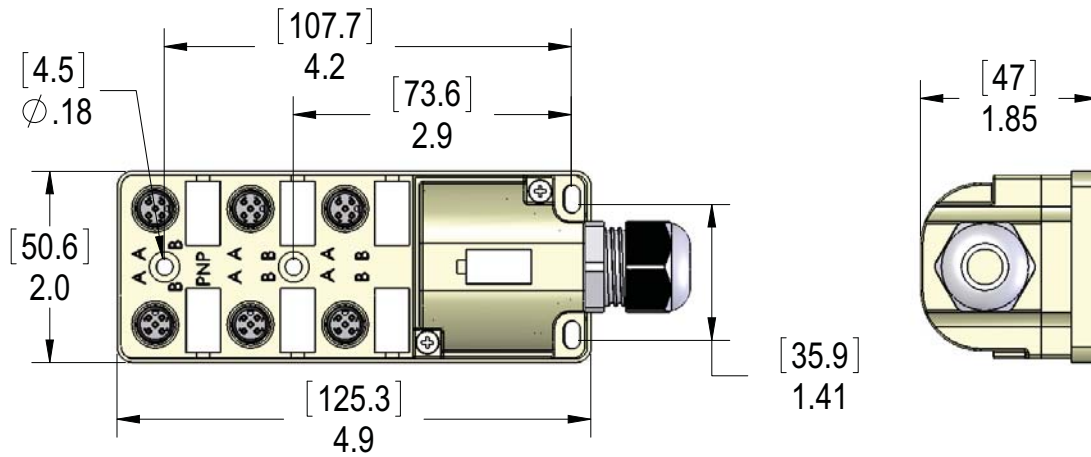

Field Wireable

Cable

D-Sub

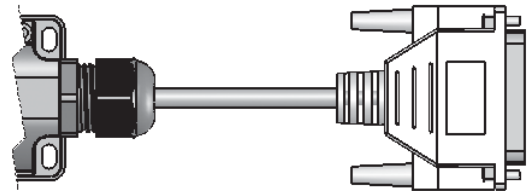
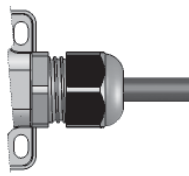
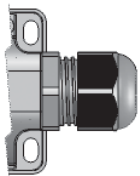

Trunk Connection	Length	Part Number		
		No LED	PNP	NPN
Field Wireable	N/A	JDC-650-015-F000	JDC-65P-215-F000	JDC-65N-215-F000
Cable	5 M	JDC-650-015-C050	JDC-65P-215-C050	JDC-65N-215-C050
	10 M	JDC-650-015-C100	JDC-65P-215-C100	JDC-65N-215-C100
25 PIN D-SUB	0.3 M	JDC-650-025-D003	JDC-65P-225-D003	JDC-65N-225-D003
	6 M	JDC-650-025-D060	JDC-65P-225-D060	JDC-65N-225-D060

Other cable lengths are available, please consult the factory.

JDC Junction Blocks 6 Port ❖ 5 Pin

Field Wireable ❖ Cable ❖ D-Sub

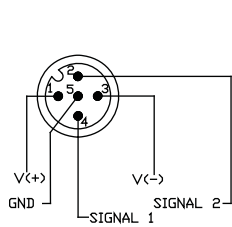

No LED Version

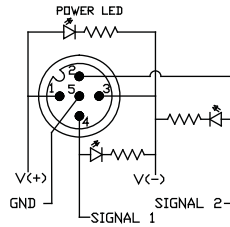

PNP Version

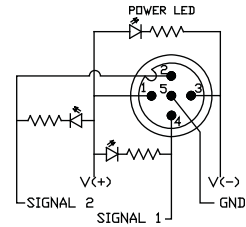

NPN Version

Function	Cable Version	25 PIN Male D-SUB
	Cable O.D. 0.40"	
+ V	Brown	PIN #22 & #23
- V	Blue	PIN #24 & #25
Ground	Green/Yellow	Shield
PORT 1 PIN 2	Gray/Pink	PIN #2
PORT 1 PIN 4	White	PIN #1
PORT 2 PIN 2	Red/Blue	PIN #4
PORT 2 PIN 4	Green	PIN #3
PORT 3 PIN 2	White/Green	PIN #6
PORT 3 PIN 4	Yellow	PIN #5
PORT 4 PIN 2	Brown/Green	PIN #8
PORT 4 PIN 4	Gray	PIN #7
PORT 5 PIN 2	White/Yellow	PIN #10
PORT 5 PIN 4	Pink	PIN #9
PORT 6 PIN 2	Yellow/Brown	PIN #12
PORT 6 PIN 4	Red	PIN #11

JDC Junction Blocks 6 Port ❖ 5 Pin

MIN Receptacle ❖ MIN Plug ❖ M23 Receptacle

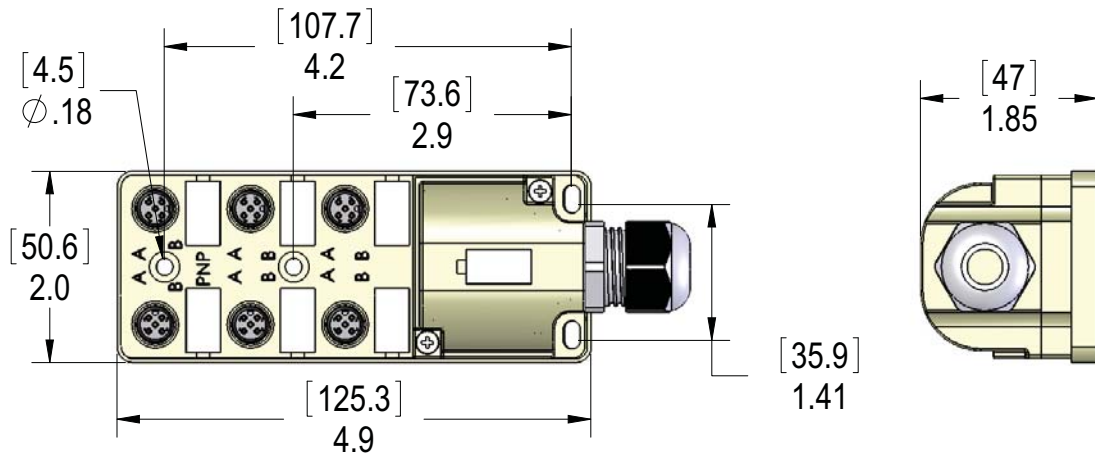

MIN Receptacle

MIN Plug

M23 Receptacle

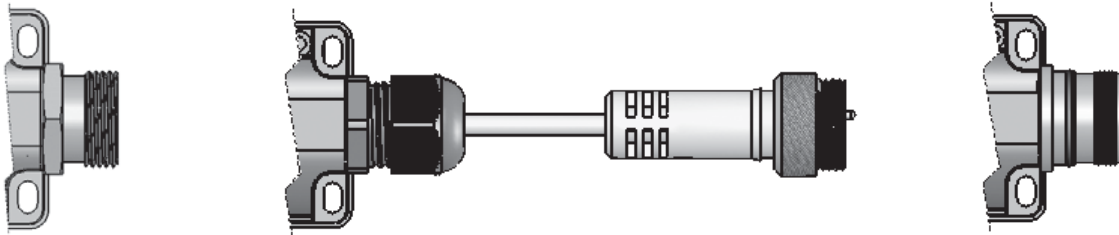

Trunk Connection	Length	Part Number		
		No LED	PNP	NPN
MIN 19 Receptacle	N/A	JDC-650-019-M000	JDC-65P-219-M000	JDC-65N-219-M000
MIN 19 Plug	0.3 M	JDC-650-019-M003	JDC-65P-219-M003	JDC-65N-219-M003
M23 Receptacle	N/A	JDC-650-019-V000	JDC-65P-219-V000	JDC-65N-219-V000

JDC Junction Blocks 6 Port ❖ 5 Pin

MIN Receptacle ❖ MIN Plug ❖ M23 Receptacle

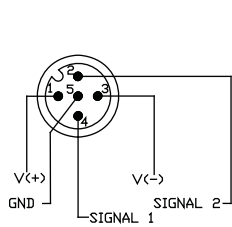

No LED Version

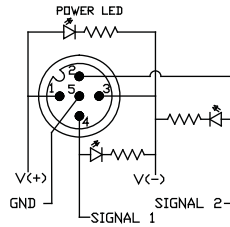

PNP Version

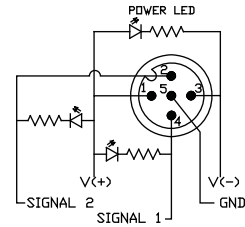

NPN Version

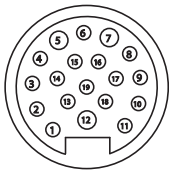
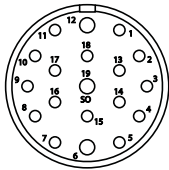
Function	MIN-19 Receptacle & Plug Version	19 PIN M23 Receptacle Version
		
+ V	PIN #7	PIN #19
- V	PIN #5	PIN #6
Ground	PIN #12	PIN #12
PORT 1 PIN 2	PIN #19	PIN #7
PORT 1 PIN 4	PIN #15	PIN #15
PORT 2 PIN 4	PIN #4	PIN #4
PORT 2 PIN 4	PIN #6	PIN #5
PORT 3 PIN 2	PIN #8	PIN #8
PORT 3 PIN 4	PIN #16	PIN #16
PORT 4 PIN 2	PIN #14	PIN #14
PORT 4 PIN 4	PIN #3	PIN #3
PORT 5 PIN 2	PIN #9	PIN #9
PORT 5 PIN 4	PIN #17	PIN #17
PORT 6 PIN 2	PIN #13	PIN #13
PORT 6 PIN 4	PIN #2	PIN #2
Mating Plug for Receptacle or Plug	MINP-19FP-xx	MCV-19FP-xx

JDC Junction Blocks 6 Port ❖ 5 Pin

Straight Wired

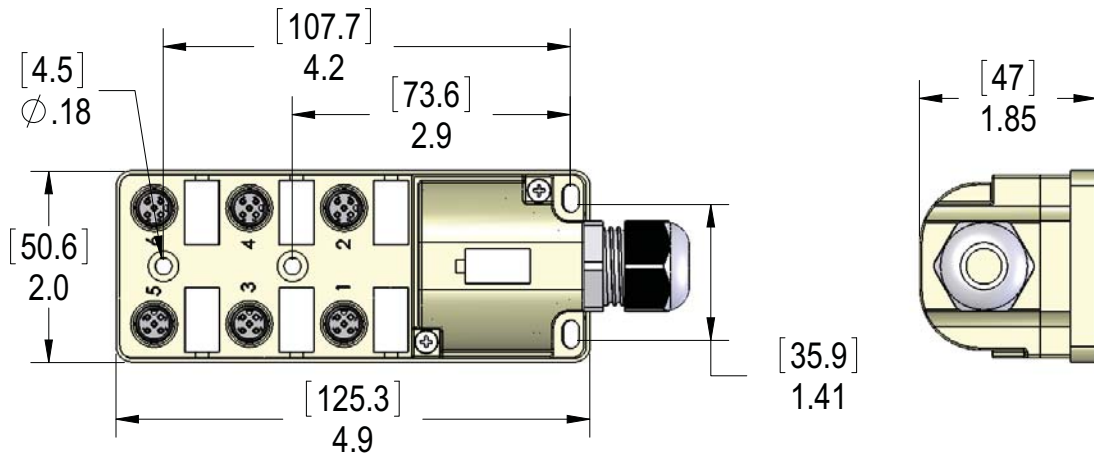

Field Wireable

Cable

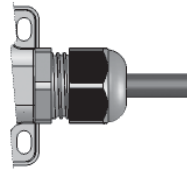
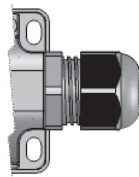

Trunk Connection	Length	Part Number
Field Wireable	N/A	JDC-6A0-025-F000
Cable	5 M	JDC-6A0-025-C050
	10 M	JDC-6A0-025-C100

Other cable lengths are available, please consult the factory.

JDC Junction Blocks 6 Port ❖ 5 Pin

Straight Wired

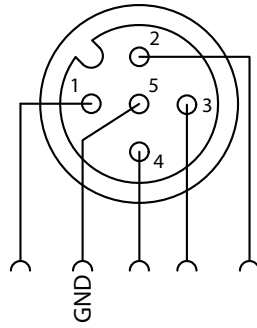

Function	Cable Version
	Cable O.D. 0.50"
ALL PORTS PIN 5	Green/Yellow
PORT 1 PIN 1	Brown/Black
PORT 1 PIN 2	White/Blue
PORT 1 PIN 3	White/Black
PORT 1 PIN 4	White
PORT 2 PIN 1	Brown/Green
PORT 2 PIN 2	White/Green
PORT 2 PIN 3	Brown/Blue
PORT 2 PIN 4	Green
PORT 3 PIN 1	Yellow/Brown
PORT 3 PIN 2	White/Yellow
PORT 3 PIN 3	Black
PORT 3 PIN 4	Yellow
PORT 4 PIN 1	Gray/Brown
PORT 4 PIN 2	White/Gray
PORT 4 PIN 3	Gray/Pink
PORT 4 PIN 4	Gray
PORT 5 PIN 1	Pink/Brown
PORT 5 PIN 2	White/Pink
PORT 5 PIN 3	Violet
PORT 5 PIN 4	Pink
PORT 6 PIN 1	Brown/Red
PORT 6 PIN 2	White/Red
PORT 6 PIN 3	Red/Blue
PORT 6 PIN 4	Red

JDC Junction Blocks 8 Port ❖ 3 Pin

MIN Receptacle ❖ MIN Plug

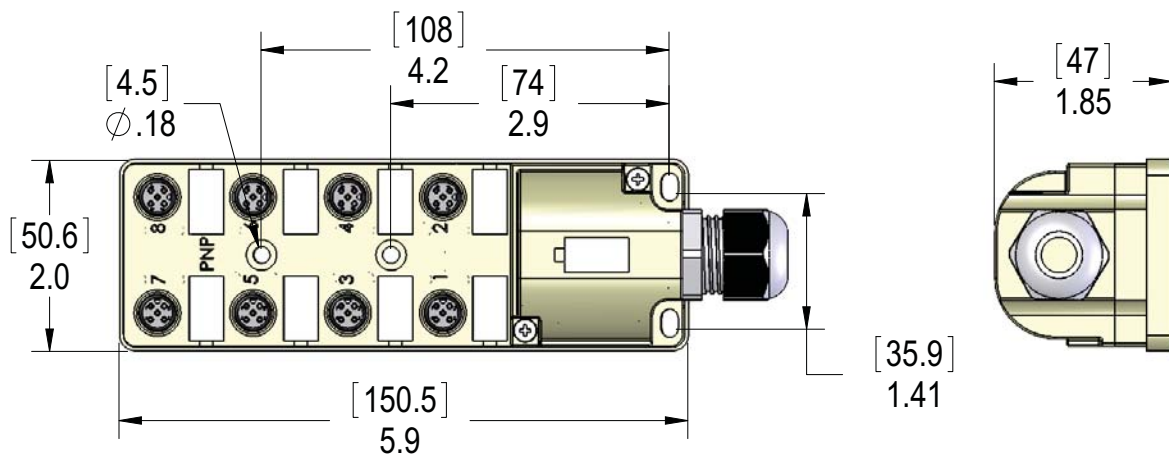

MIN Receptacle

MIN Plug

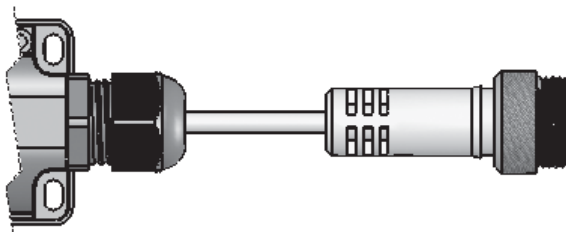
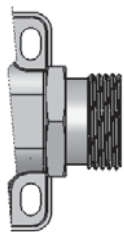

Trunk Connection	Length	Part Number		
		No LED	PNP	NPN
MIN 10 Receptacle	N/A	JDC-830-010-M000	JDC-83P-210-M000	JDC-83N-210-M000
MIN 10 Plug	0.3 M	JDC-830-010-M003	JDC-83P-210-M003	JDC-83N-210-M003

JDC Junction Blocks 8 Port ❖ 3 Pin

MIN Receptacle ❖ MIN Plug

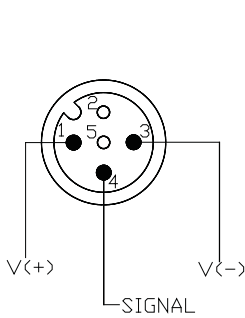

No LED Version

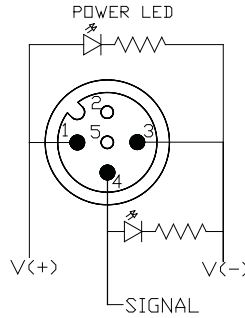

PNP Version

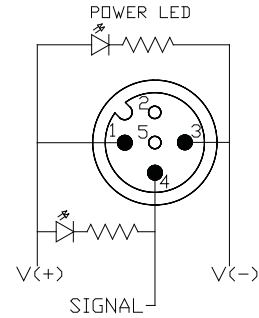

NPN Version

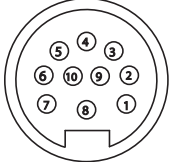
Function	MIN-10 Receptacle & Plug Version
	
+ V	PIN #10
- V	PIN #8
PORT 1 PIN 4	PIN #7
PORT 2 PIN 4	PIN #6
PORT 3 PIN 4	PIN #5
PORT 4 PIN 4	PIN #4
PORT 5 PIN 4	PIN #3
PORT 6 PIN 4	PIN #2
PORT 7 PIN 4	PIN #1
PORT 8 PIN 4	PIN #9
Mating Plug for Receptacle or Plug	MIN-10FPX-xx

JDC Junction Blocks 8 Port ❖ 4 Pin

Field Wireable ❖ Cable ❖ D-Sub

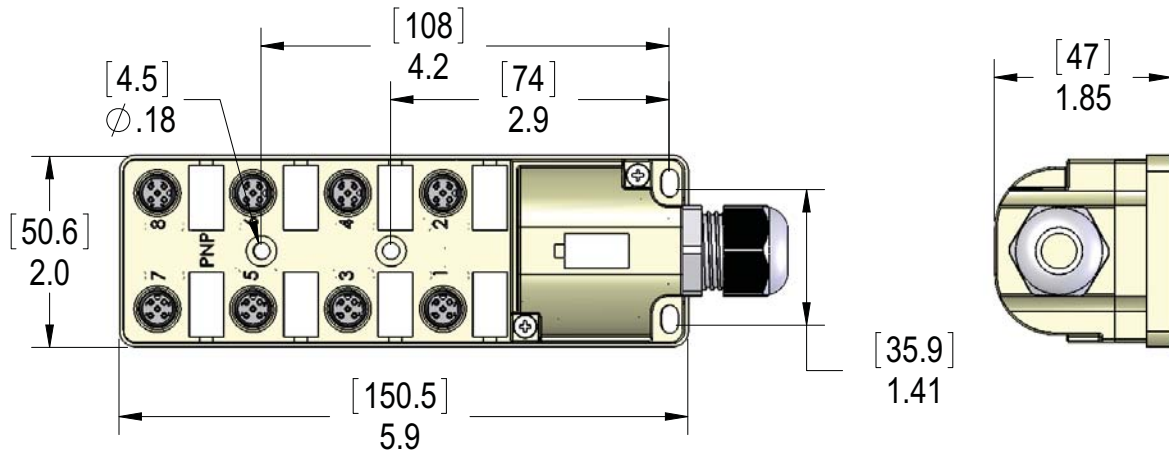

Field Wireable

Cable

D-Sub

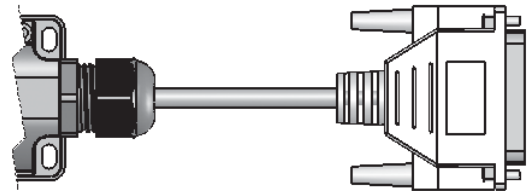
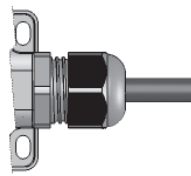
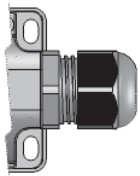

Trunk Connection	Length	Part Number		
		No LED	PNP	NPN
Field Wireable	N/A	JDC-840-011-F000	JDC-84P-211-F000	JDC-84N-211-F000
Cable	5 M	JDC-840-011-C050	JDC-84P-211-C050	JDC-84N-211-C050
	10 M	JDC-840-011-C100	JDC-84P-211-C100	JDC-84N-211-C100
25 PIN D-SUB	0.3 M	JDC-840-025-D003	JDC-84P-225-D003	JDC-84N-225-D003
	6 M	JDC-840-025-D060	JDC-84P-225-D060	JDC-84N-225-D060

Other cable lengths are available, please consult the factory.

JDC Junction Blocks 8 Port ❖ 4 Pin

Field Wireable ❖ Cable ❖ D-Sub

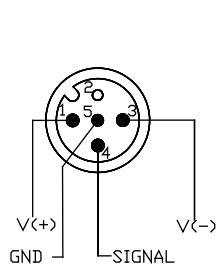

No LED Version

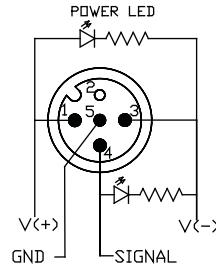

PNP Version

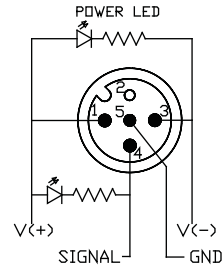

NPN Version

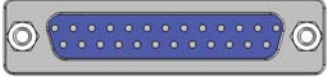
Function	Cable Version	25 PIN Male D-SUB
	Cable O.D. 0.35"	
+ V	Brown	PIN #22 & #23
- V	Blue	PIN #24 & #25
Ground	Green/Yellow	Shield
PORT 1 PIN 4	White	PIN #1
PORT 2 PIN 4	Green	PIN #2
PORT 3 PIN 4	Yellow	PIN #3
PORT 4 PIN 4	Gray	PIN #4
PORT 5 PIN 4	Pink	PIN #5
PORT 6 PIN 4	Red	PIN #6
PORT 7 PIN 4	Black	PIN #7
PORT 8 PIN 4	Violet	PIN #8

JDC Junction Blocks 8 Port ❖ 4 Pin

MIN Receptacle ❖ MIN Plug ❖ M23 Receptacle

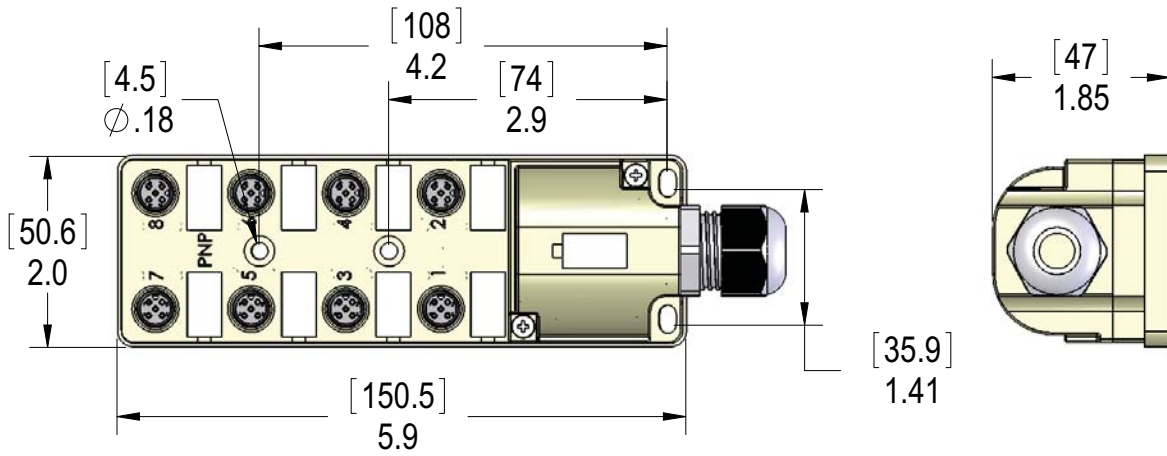

MIN Receptacle

MIN Plug

M23 Receptacle

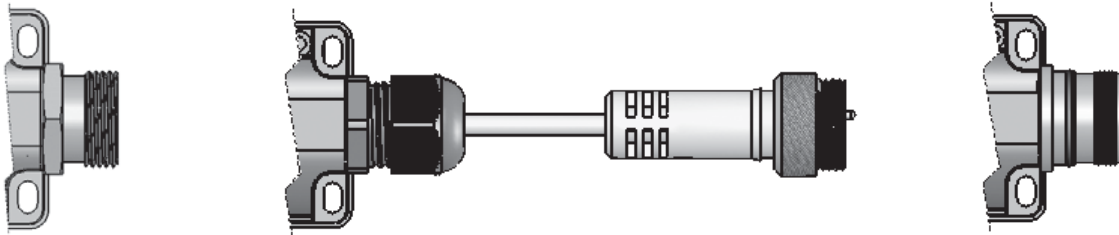

Trunk Connection	Length	Part Number		
		No LED	PNP	NPN
MIN 12 Receptacle	N/A	JDC-840-012-M000	JDC-84P-212-M000	JDC-84N-212-M000
MIN 12 Plug	0.3 M	JDC-840-012-M003	JDC-84P-212-M003	JDC-84N-212-M003
M23 Receptacle	N/A	JDC-840-012-V000	JDC-84P-212-V000	JDC-84N-212-V000

JDC Junction Blocks 8 Port ❖ 4 Pin

MIN Receptacle ❖ MIN Plug ❖ M23 Receptacle

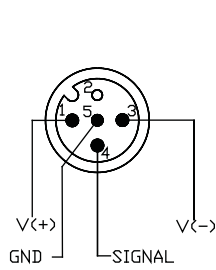

No LED Version

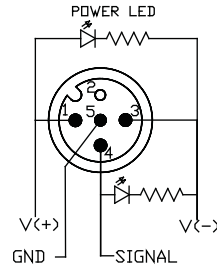

PNP Version

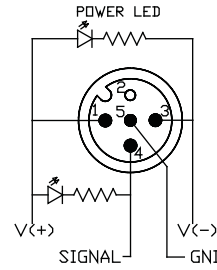

NPN Version

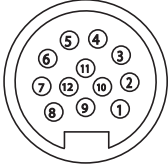
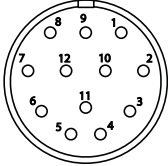
Function	MIN-12 Receptacle & Plug Version	12 PIN M23 Receptacle Version
		
+ V	PIN #10	PIN #11
- V	PIN #11	PIN #9 & #10
Ground	PIN #9	PIN #12
PORT 1 PIN 4	PIN #1	PIN #1
PORT 2 PIN 4	PIN #2	PIN #2
PORT 3 PIN 4	PIN #3	PIN #3
PORT 4 PIN 4	PIN #4	PIN #4
PORT 5 PIN 4	PIN #5	PIN #5
PORT 6 PIN 4	PIN #6	PIN #6
PORT 7 PIN 4	PIN #7	PIN #7
PORT 8 PIN 4	PIN #8	PIN #8
Mating Plug for Receptacle or Plug	MIN-12FPX-xx	MCV-12FP-xx

JDC Junction Blocks 8 Port ❖ 5 Pin

Field Wireable ❖ Cable ❖ D-Sub

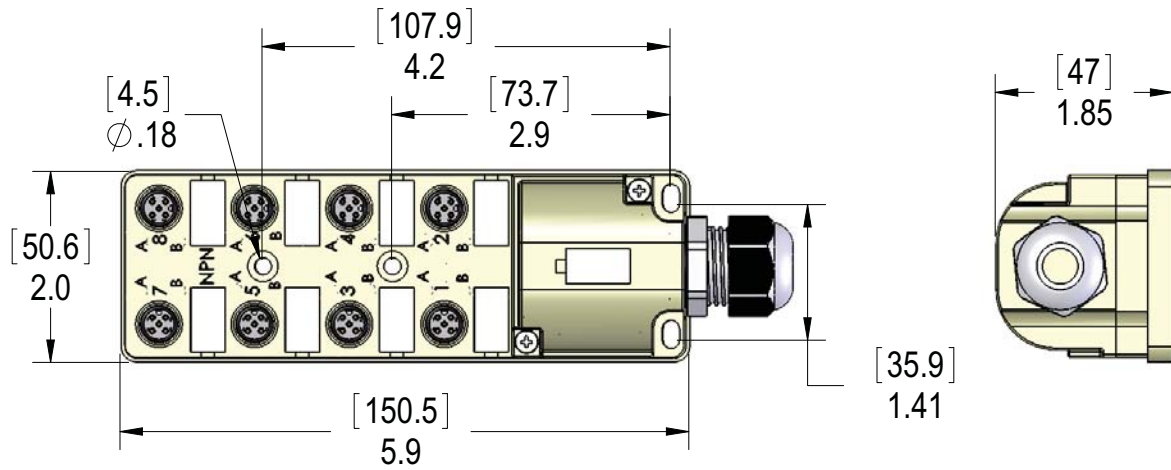

Field Wireable

Cable

D-Sub

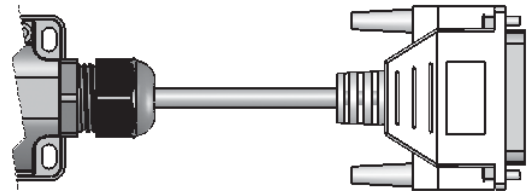
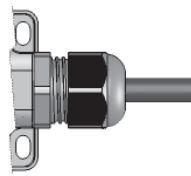
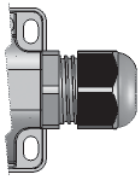

Trunk Connection	Length	Part Number		
		No LED	PNP	NPN
Field Wireable	N/A	JDC-850-019-F000	JDC-85P-219-F000	JDC-85N-219-F000
Cable	5 M	JDC-850-019-C050	JDC-85P-219-C050	JDC-85N-219-C050
	10 M	JDC-850-019-C100	JDC-85P-219-C100	JDC-85N-219-C100
25 PIN D-SUB	0.3 M	JDC-850-025-D003	JDC-85P-225-D003	JDC-85N-225-D003
	6 M	JDC-850-025-D060	JDC-85P-225-D060	JDC-85N-225-D060

Other cable lengths are available, please consult the factory.

JDC Junction Blocks 8 Port ❖ 5 Pin

Field Wireable ❖ Cable ❖ D-Sub

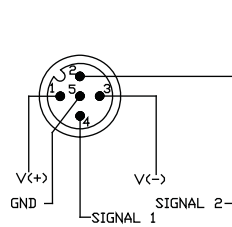

No LED Version

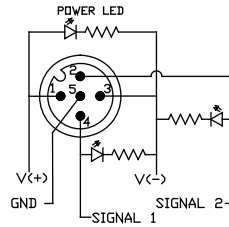

PNP Version

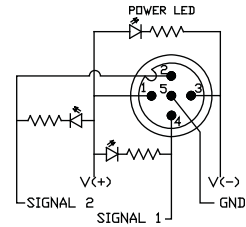

NPN Version

Function	Cable Version	25 PIN Male D-SUB
	Cable O.D. 0.43"	
+ V	Brown	PIN #22 & #23
- V	Blue	PIN #24 & #25
Ground	Green/Yellow	Shield
PORT 1 PIN 2	Gray/Pink	PIN #2
PORT 1 PIN 4	White	PIN #1
PORT 2 PIN 2	Red/Blue	PIN #4
PORT 2 PIN 4	Green	PIN #3
PORT 3 PIN 2	White/Green	PIN #6
PORT 3 PIN 4	Yellow	PIN #5
PORT 4 PIN 2	Brown/Green	PIN #8
PORT 4 PIN 4	Gray	PIN #7
PORT 5 PIN 2	White/Yellow	PIN #10
PORT 5 PIN 4	Pink	PIN #9
PORT 6 PIN 2	Yellow/Brown	PIN #12
PORT 6 PIN 4	Red	PIN #11
PORT 7 PIN 2	White/Gray	PIN #14
PORT 7 PIN 4	Black	PIN #13
PORT 8 PIN 2	Gray/Brown	PIN #16
PORT 8 PIN 4	Violet	PIN #15

JDC Junction Blocks

JDC Junction Blocks 8 Port ❖ 5 Pin

MIN Receptacle ❖ MIN Plug ❖ M23 Receptacle

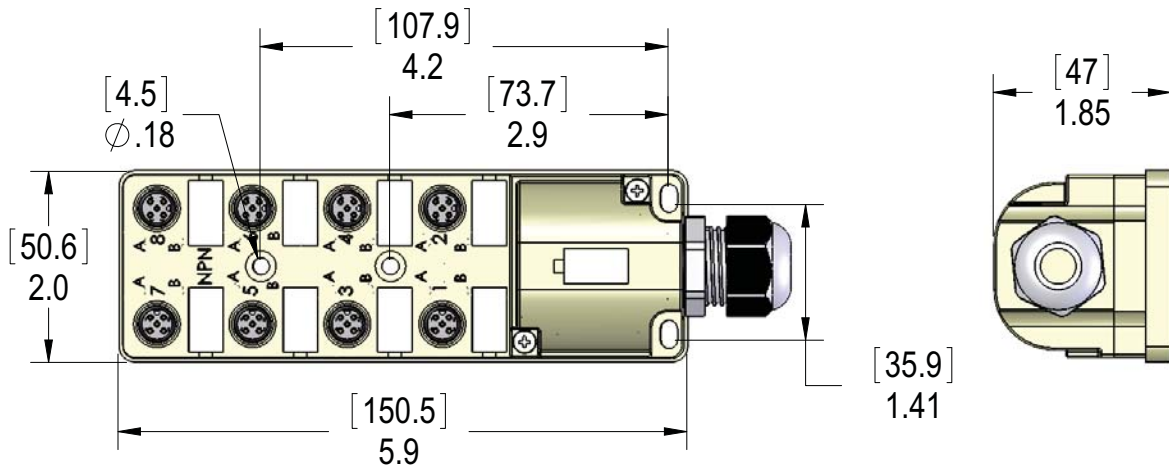

MIN Receptacle

MIN Plug

M23 Receptacle

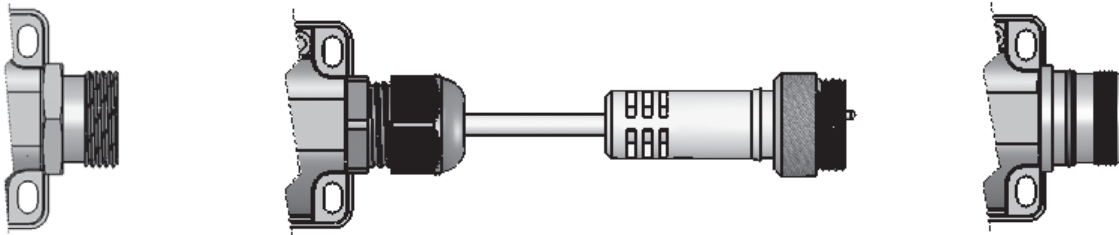

Trunk Connection	Length	Part Number		
		No LED	PNP	NPN
MIN 19 Receptacle	N/A	JDC-850-019-M000	JDC-85P-219-M000	JDC-85N-219-M000
MIN 19 Plug	0.3 M	JDC-850-019-M003	JDC-85P-219-M003	JDC-85N-219-M003
M23 Receptacle	N/A	JDC-850-019-V000	JDC-85P-219-V000	JDC-85N-219-V000

JDC Junction Blocks 8 Port ❖ 5 Pin

MIN Receptacle ❖ MIN Plug ❖ M23 Receptacle

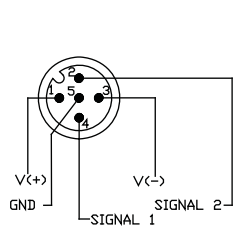

No LED Version

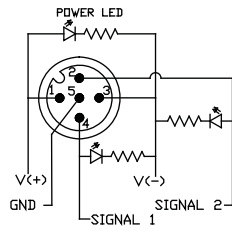

PNP Version

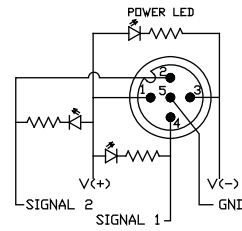

NPN Version

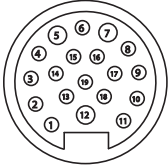
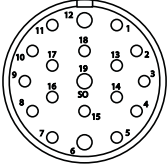
Function	MIN-19 Receptacle & Plug Version	19 PIN M23 Receptacle Version
		
+ V	PIN #7	PIN #19
- V	PIN #5	PIN #6
Ground	PIN #12	PIN #12
PORT 1 PIN 2	PIN #19	PIN #7
PORT 1 PIN 4	PIN #15	PIN #15
PORT 2 PIN 2	PIN #4	PIN #4
PORT 2 PIN 4	PIN #6	PIN #5
PORT 3 PIN 2	PIN #8	PIN #8
PORT 3 PIN 4	PIN #16	PIN #16
PORT 4 PIN 2	PIN #14	PIN #14
PORT 4 PIN 4	PIN #3	PIN #3
PORT 5 PIN 2	PIN #9	PIN #9
PORT 5 PIN 4	PIN #17	PIN #17
PORT 6 PIN 2	PIN #13	PIN #13
PORT 6 PIN 4	PIN #2	PIN #2
PORT 7 PIN 2	PIN #10	PIN #10
PORT 7 PIN 4	PIN #11	PIN #11
PORT 8 PIN 2	PIN #18	PIN #18
PORT 8 PIN 4	PIN #1	PIN #1
Mating Plug for Receptacle or Plug	MINP-19FP-xx	MCV-19FP-xx

JDC Junction Blocks 10 Port ❖ 3 Pin

MIN Receptacle ❖ MIN Plug

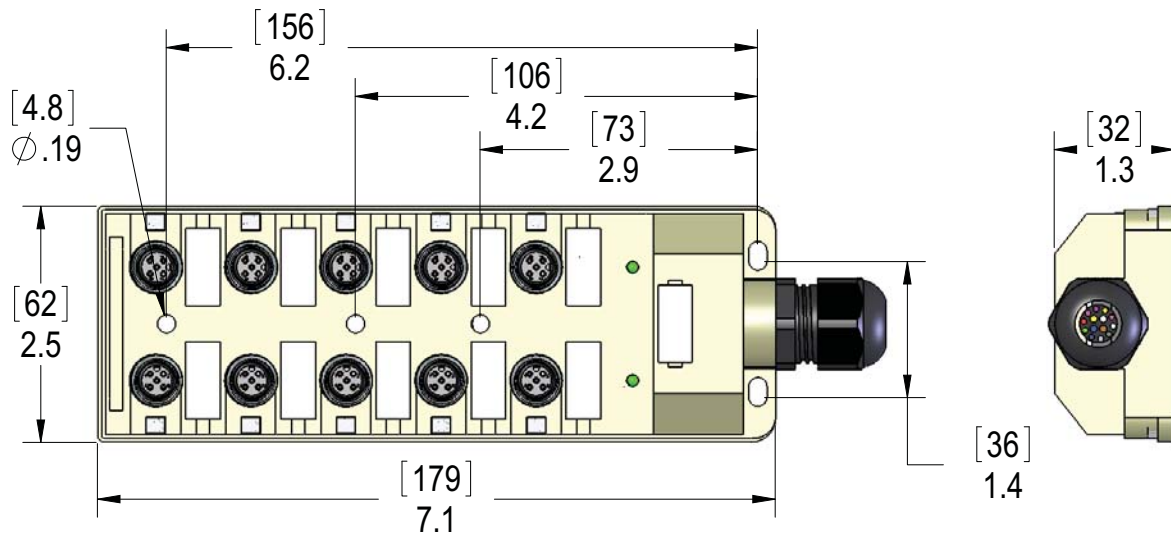

MIN Receptacle

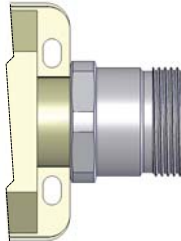

MIN Plug

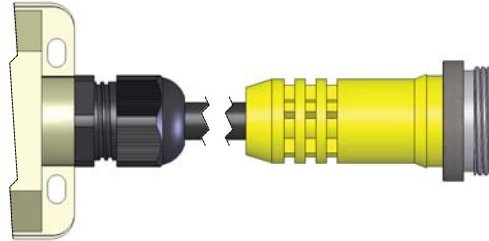

Trunk Connection	Length	Part Number		
		No LED	PNP	NPN
MIN 12 Receptacle	N/A	JDC-030-012-M000	JDC-03P-212-M000	JDC-03N-212-M000
MIN 12 Plug	0.3 M	JDC-030-012-M003	JDC-03P-212-M003	JDC-03N-212-M003

JDC Junction Blocks

JDC Junction Blocks 10 Port ❖ 3 Pin

MIN Receptacle ❖ MIN Plug

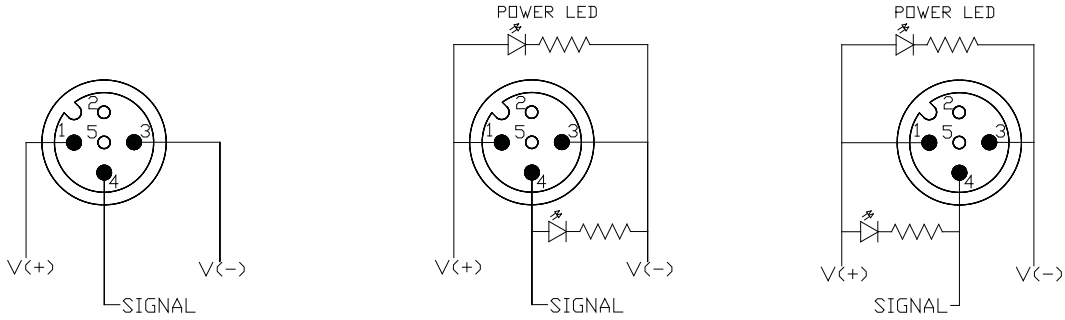

No LED Version

PNP Version

NPN Version

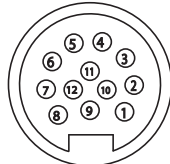
Function	MIN-12 Receptacle & Plug Version
	
+ V	PIN #10
- V	PIN #9
PORT 1 PIN 4	PIN #1
PORT 2 PIN 4	PIN #2
PORT 3 PIN 4	PIN #3
PORT 4 PIN 4	PIN #4
PORT 5 PIN 4	PIN #5
PORT 6 PIN 4	PIN #6
PORT 7 PIN 4	PIN #7
PORT 8 PIN 4	PIN #8
PORT 9 PIN 4	PIN #11
PORT 10 PIN 4	PIN #12
Mating Plug for Receptacle or Plug	MIN-12FP-xx

JDC Junction Blocks 10 Port ❖ 4 Pin

Cable ❖ D-Sub

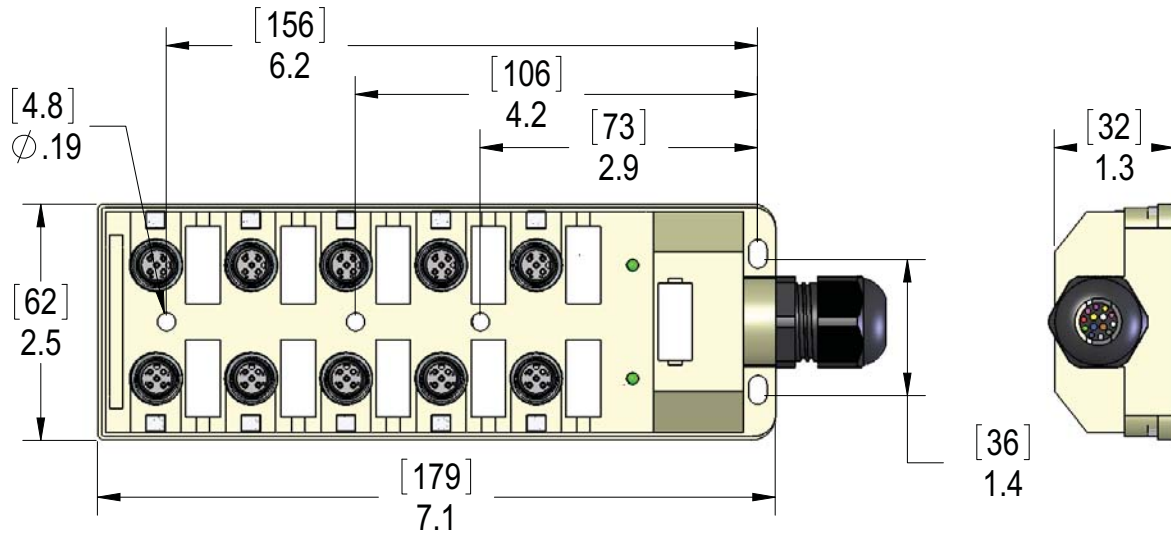

Cable

D-Sub

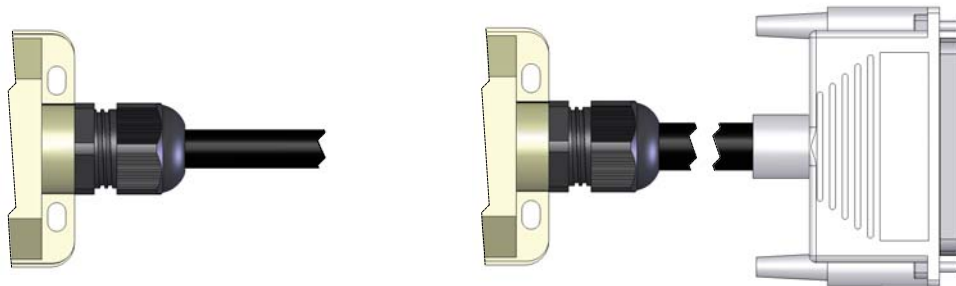

Trunk Connection	Length	Part Number		
		No LED	PNP	NPN
Cable	5 M	JDC-040-013-C050	JDC-04P-213-C050	JDC-04N-213-C050
	10 M	JDC-040-013-C100	JDC-04P-213-C100	JDC-04N-213-C100
25 PIN D-SUB	0.3 M	JDC-040-025-D003	JDC-04P-225-D003	JDC-04N-225-D003
	6 M	JDC-040-025-D060	JDC-04P-225-D060	JDC-04N-225-D060

Other cable lengths are available, please consult the factory.

JDC Junction Blocks 10 Port ❖ 4 Pin

Cable ❖ D-Sub

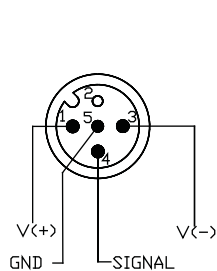

No LED Version

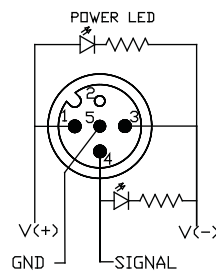

PNP Version

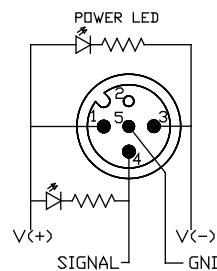

NPN Version

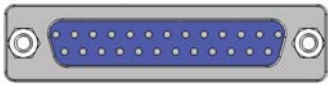
Function	Cable Version	25 PIN Male D-SUB
	Cable O.D. 0.39"	
+ V	Brown	PIN #22 & #23
- V	Blue	PIN #24 & #25
Ground	Green/Yellow	Shield
PORT 1 PIN 4	White	PIN #1
PORT 2 PIN 4	Green	PIN #2
PORT 3 PIN 4	Yellow	PIN #3
PORT 4 PIN 4	Gray	PIN #4
PORT 5 PIN 4	Pink	PIN #5
PORT 6 PIN 4	Red	PIN #6
PORT 7 PIN 4	Black	PIN #7
PORT 8 PIN 4	Violet	PIN #8
PORT 9 PIN 4	Gray/Pink	PIN #9
PORT 10 PIN 4	Red/Blue	PIN #10

JDC Junction Blocks

JDC Junction Blocks 10 Port ❖ 4 Pin

MIN Receptacle ❖ MIN Plug ❖ M23 Receptacle

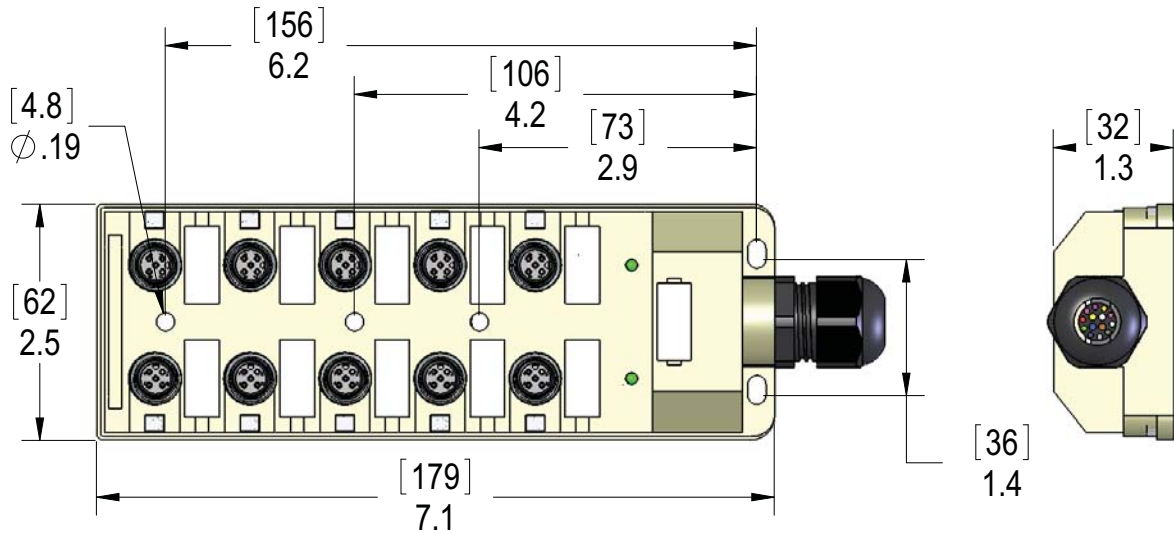

MIN Receptacle

MIN Plug

M23 Receptacle

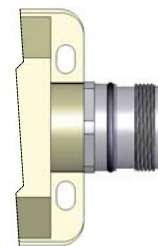
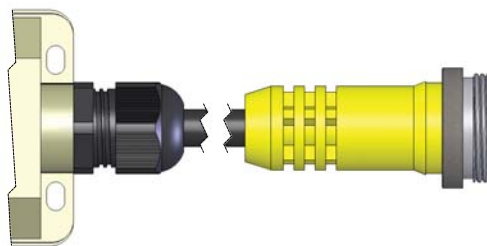
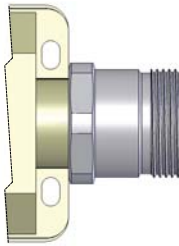

Trunk Connection	Length	Part Number		
		No LED	PNP	NPN
MIN 19 Receptacle	N/A	JDC-040-019-M000	JDC-04P-219-M000	JDC-04N-219-M000
MIN 19 Plug	0.3 M	JDC-040-019-M003	JDC-04P-219-M003	JDC-04N-219-M003
M23 Receptacle	N/A	JDC-040-019-V000	JDC-04P-219-V000	JDC-04N-219-V000

JDC Junction Blocks 10 Port ❖ 4 Pin

MIN Receptacle ❖ MIN Plug ❖ M23 Receptacle

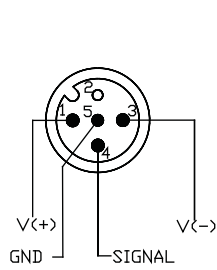

No LED Version

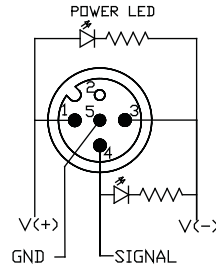

PNP Version

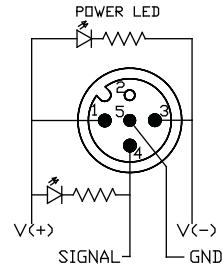

NPN Version

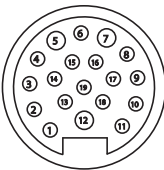
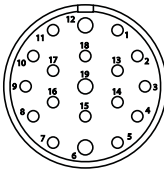
Function	MIN-19 Receptacle & Plug Version	19 PIN M23 Receptacle Version
		
+ V	PIN #7	PIN #19
- V	PIN #5	PIN #6
Ground	PIN #12	PIN #12
PORT 1 PIN 4	PIN #15	PIN #15
PORT 2 PIN 4	PIN #6	PIN #5
PORT 3 PIN 4	PIN #16	PIN #16
PORT 4 PIN 4	PIN #3	PIN #3
PORT 5 PIN 4	PIN #17	PIN #17
PORT 6 PIN 4	PIN #2	PIN #2
PORT 7 PIN 4	PIN #11	PIN #11
PORT 8 PIN 4	PIN #1	PIN #1
PORT 9 PIN 4	PIN #10	PIN #7
PORT 10 PIN 4	PIN #18	PIN #4
Mating Plug for Receptacle or Plug	MIN-19FP-xx	MCV-19FP-xx

JDC Junction Blocks 10 Port ❖ 5 Pin

Cable ❖ D-Sub

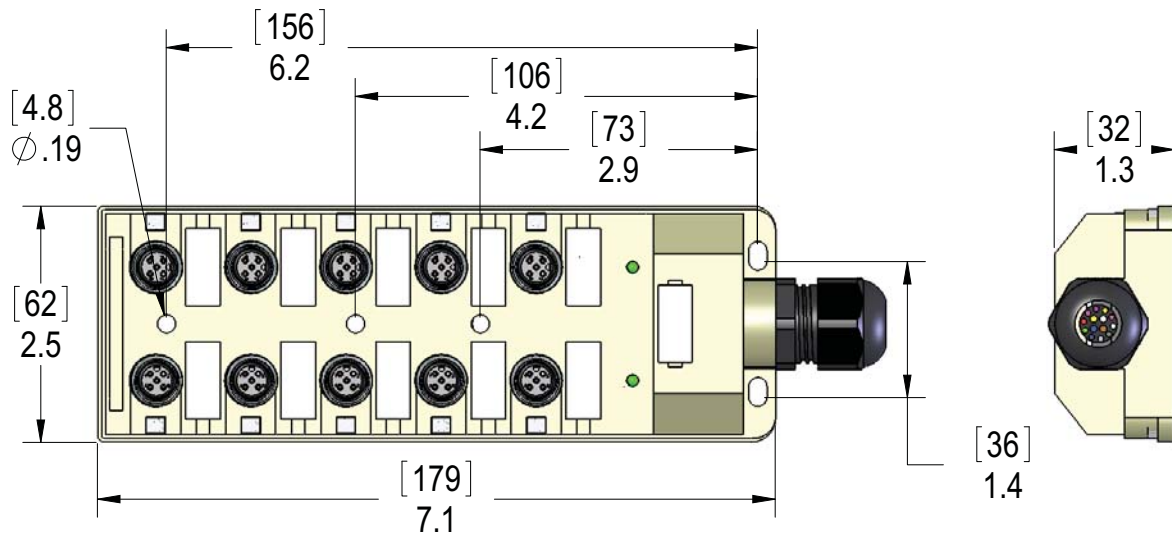

Cable

D-Sub

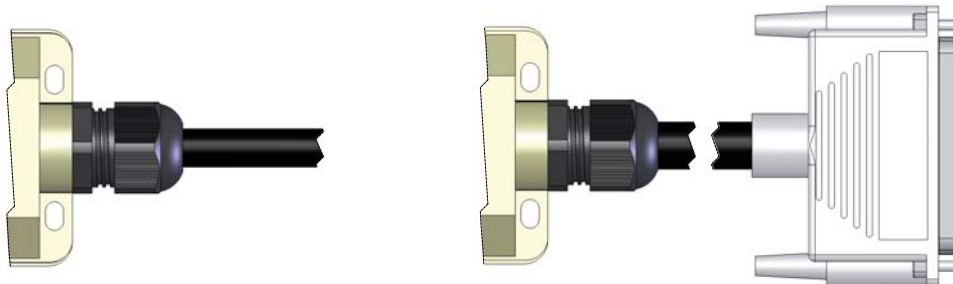

Trunk Connection	Length	Part Number		
		No LED	PNP	NPN
Cable	5 M	JDC-050-024-C050	JDC-05P-224-C050	JDC-05N-224-C050
	10 M	JDC-050-024-C100	JDC-05P-224-C100	JDC-05N-224-C100
25 PIN D-SUB	0.3 M	JDC-050-025-D003	JDC-05P-225-D003	JDC-05N-225-D003
	6 M	JDC-050-025-D060	JDC-05P-225-D060	JDC-05N-225-D060

Other cable lengths are available, please consult the factory.

JDC Junction Blocks 10 Port ❖ 5 Pin

Cable ❖ D-Sub

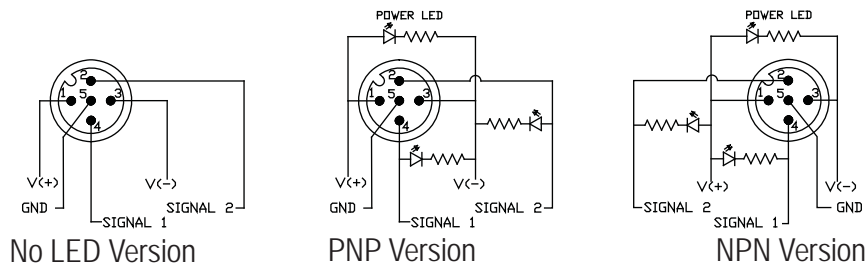

Function	Cable Version	25 PIN Male D-SUB
	Cable O.D. 0.47"	
+ V	Brown & Brown/White	PIN #22 & #23
- V	Blue	PIN #24 & #25
Ground	Green/Yellow	Shield
PORT 1 PIN 2	Gray/Pink	PIN #2
PORT 1 PIN 4	White	PIN #1
PORT 2 PIN 2	Red/Blue	PIN #4
PORT 2 PIN 4	Green	PIN #3
PORT 3 PIN 2	White/Green	PIN #6
PORT 3 PIN 4	Yellow	PIN #5
PORT 4 PIN 2	Brown/Green	PIN #8
PORT 4 PIN 4	Gray	PIN #7
PORT 5 PIN 2	White/Yellow	PIN #10
PORT 5 PIN 4	Pink	PIN #9
PORT 6 PIN 2	Yellow/Brown	PIN #12
PORT 6 PIN 4	Red	PIN #11
PORT 7 PIN 2	White/Gray	PIN #14
PORT 7 PIN 4	Black	PIN #13
PORT 8 PIN 2	Gray/Brown	PIN #16
PORT 8 PIN 4	Violet	PIN #15
PORT 9 PIN 2	White/Red	PIN #18
PORT 9 PIN 4	White/Pink	PIN #17
PORT10 PIN 2	Brown/Red	PIN #20
PORT 10 PIN 4	Pink/Brown	PIN #19

JDC Junction Blocks 12 Port ❖ 4 Pin

Cable ❖ D-Sub

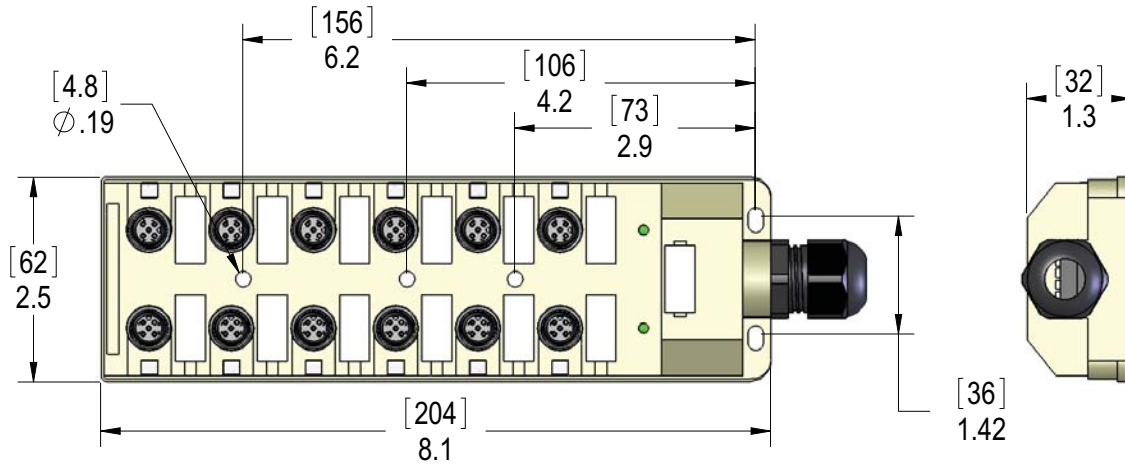

Cable

D-Sub

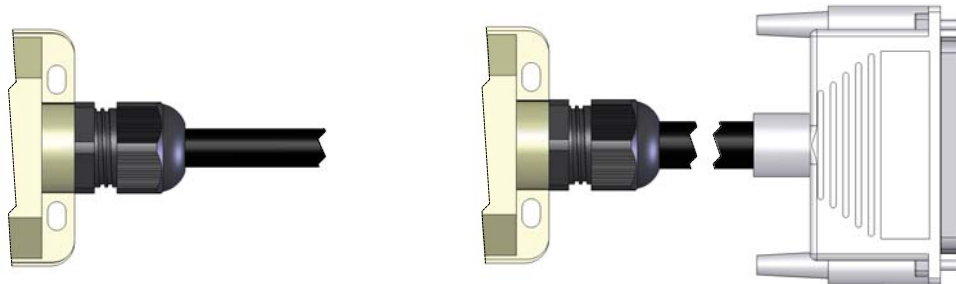

Trunk Connection	Length	Part Number		
		No LED	PNP	NPN
Cable	5 M	JDC-240-016-C050	JDC-24P-216-C050	JDC-24N-216-C050
	10 M	JDC-240-016-C100	JDC-24P-216-C100	JDC-24N-216-C100
25 PIN D-SUB	0.3 M	JDC-240-025-D003	JDC-24P-225-D003	JDC-24N-225-D003
	6 M	JDC-240-025-D060	JDC-24P-225-D060	JDC-24N-225-D060

Other cable lengths are available, please consult the factory.

JDC Junction Blocks 12 Port ❖ 4 Pin

Cable ❖ D-Sub

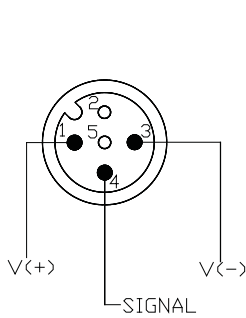

No LED Version

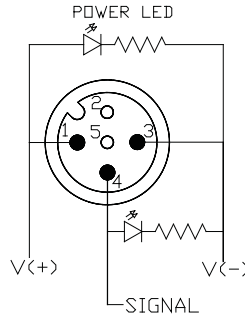

PNP Version

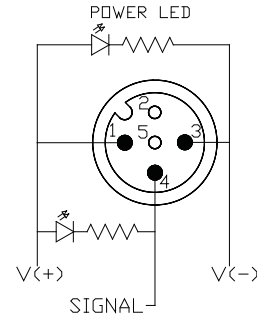

NPN Version

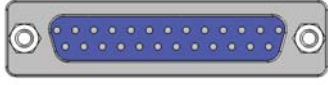
Function	Cable Version	25 PIN Male D-SUB
	Cable O.D. 0.40"	
+ V	Brown	PIN #22 & #23
- V	Blue	PIN #24 & #25
Ground	Green/Yellow	Shield
PORT 1 PIN 4	White	PIN #1
PORT 2 PIN 4	Green	PIN #2
PORT 3 PIN 4	Yellow	PIN #3
PORT 4 PIN 4	Gray	PIN #4
PORT 5 PIN 4	Pink	PIN #5
PORT 6 PIN 4	Red	PIN #6
PORT 7 PIN 4	Black	PIN #7
PORT 8 PIN 4	Violet	PIN #8
PORT 9 PIN 4	Gray/Pink	PIN #9
PORT 10 PIN 4	Red/Blue	PIN #10
PORT 11 PIN 4	White/Green	PIN #11
PORT 12 PIN 4	Brown/Green	PIN #12

JDC Junction Blocks

JDC Junction Blocks 12 Port ❖ 4 Pin

MIN Receptacle ❖ MIN Plug ❖ M23 Receptacle

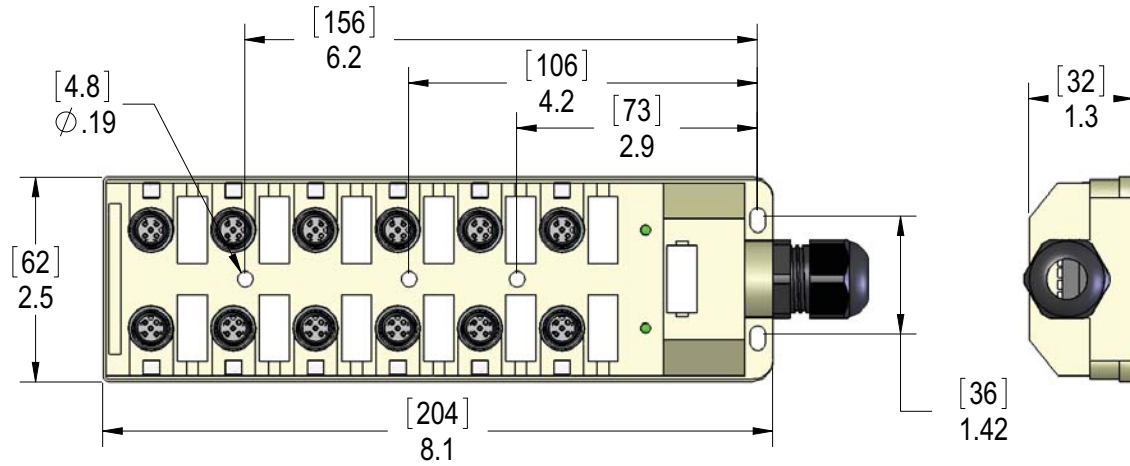

MIN Receptacle

MIN Plug

M23 Receptacle

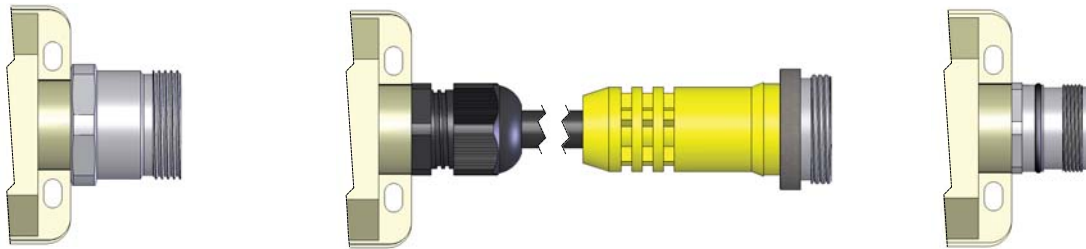

Trunk Connection	Length	Part Number		
		No LED	PNP	NPN
MIN 19 Receptacle	N/A	JDC-240-019-M000	JDC-24P-219-M000	JDC-24N-219-M000
MIN 19 Plug	0.3 M	JDC-240-019-M003	JDC-24P-219-M003	JDC-24N-219-M003
M23 Receptacle	N/A	JDC-240-019-V000	JDC-24P-219-V000	JDC-24N-219-V000

JDC Junction Blocks

JDC Junction Blocks 12 Port ❖ 4 Pin

MIN Receptacle ❖ MIN Plug ❖ M23 Receptacle

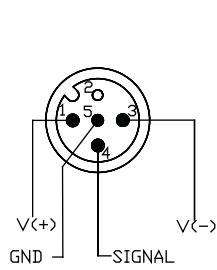

No LED Version

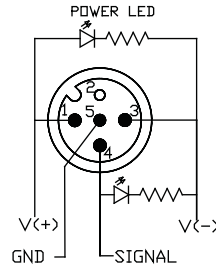

PNP Version

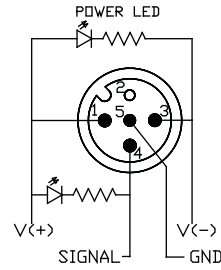

NPN Version

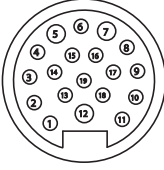
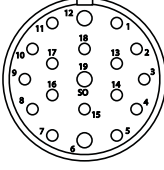
Function	MIN-19 Receptacle & Plug Version	19 PIN M23 Receptacle Version
		
+ V	PIN #7	PIN #19
- V	PIN #5	PIN #6
Ground	PIN #12	PIN #12
PORT 1 PIN 4	PIN #15	PIN #15
PORT 2 PIN 4	PIN #6	PIN #5
PORT 3 PIN 4	PIN #16	PIN #16
PORT 4 PIN 4	PIN #3	PIN #3
PORT 5 PIN 4	PIN #17	PIN #17
PORT 6 PIN 4	PIN #2	PIN #2
PORT 7 PIN 4	PIN #11	PIN #11
PORT 8 PIN 4	PIN #1	PIN #1
PORT 9 PIN 4	PIN #10	PIN #7
PORT 10 PIN 4	PIN #18	PIN #4
PORT 11 PIN 2	PIN #9	PIN #8
PORT 12 PIN 4	PIN #13	PIN #14
Mating Plug for Receptacle or Plug	MINP-19FP-xx	MCV-19FP-xx

JDC Junction Blocks 12 Port ❖ 5 Pin

Cable ❖ D-Sub

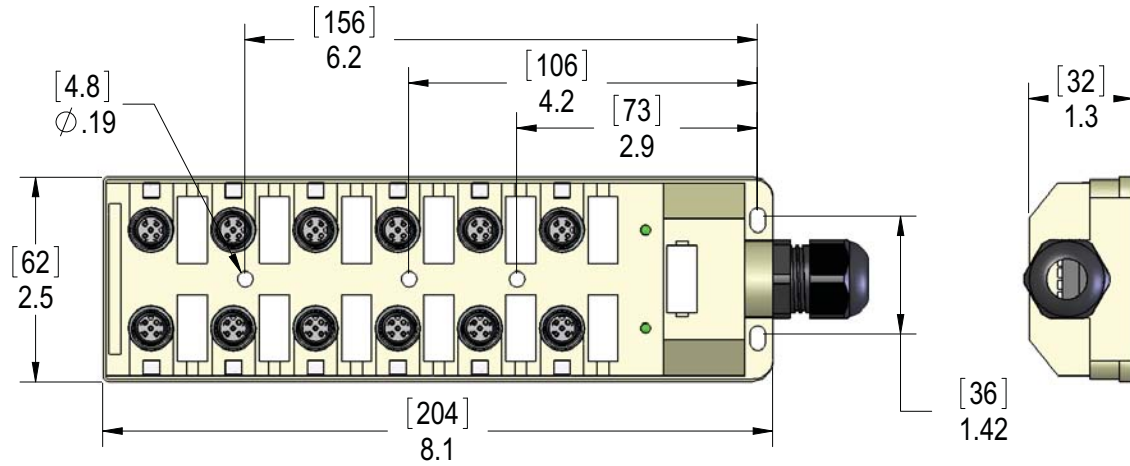

Cable

D-Sub

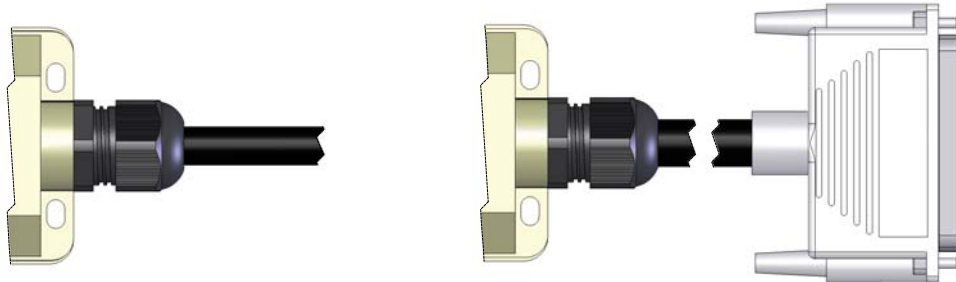

Trunk Connection	Length	Part Number		
		No LED	PNP	NPN
Cable	5 M	JDC-250-028-C050	JDC-25P-228-C050	JDC-25N-228-C050
	10 M	JDC-250-028-C100	JDC-25P-228-C100	JDC-25N-228-C100
37 PIN D-SUB	0.3 M	JDC-250-037-D003	JDC-25P-237-D003	JDC-25N-237-D003
	6 M	JDC-250-037-D060	JDC-25P-237-D060	JDC-25N-237-D060

JDC Junction Blocks

JDC Junction Blocks 12 Port ❖ 5 Pin

Cable ❖ D-Sub

Function	Cable Version	37 PIN Male D-SUB
	Cable O.D. 0.47"	
+ V	Brown & Brown/White	PIN #34 & #35
- V	Blue	PIN #36 & #37
Ground	Green/Yellow	Shield
PORT 1 PIN 2	Gray/Pink	PIN #2
PORT 1 PIN 4	White	PIN #1
PORT 2 PIN 2	Red/Blue	PIN #4
PORT 2 PIN 4	Green	PIN #3
PORT 3 PIN 2	White/Green	PIN #6
PORT 3 PIN 4	Yellow	PIN #5
PORT 4 PIN 2	Brown/Green	PIN #8
PORT 4 PIN 4	Gray	PIN #7
PORT 5 PIN 2	White/Yellow	PIN #10
PORT 5 PIN 4	Pink	PIN #9
PORT 6 PIN 2	Yellow/Brown	PIN #12
PORT 6 PIN 4	Red	PIN #11
PORT 7 PIN 2	White/Gray	PIN #14
PORT 7 PIN 4	Black	PIN #13
PORT 8 PIN 2	Gray/Brown	PIN #16
PORT 8 PIN 4	Violet	PIN #15
PORT 9 PIN 2	White/Red	PIN #18
PORT 9 PIN 4	White/Pink	PIN #17
PORT10 PIN 2	Brown/Red	PIN #20
PORT 10 PIN 4	Pink/Brown	PIN #19
PORT 11 PIN 2	White/Black	PIN #22
PORT 11 PIN 4	White/Blue	PIN #21
PORT 12 PIN 2	Brown/Black	PIN #24
PORT 12 PIN 4	Brown/Blue	PIN #23

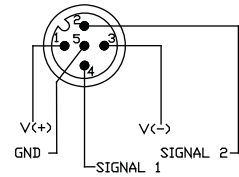

No LED Version

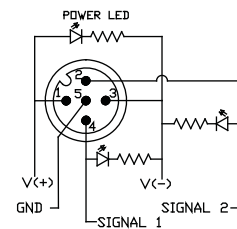

PNP Version

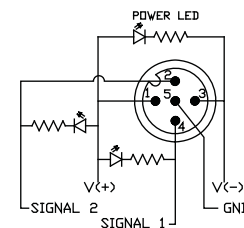

NPN Version

JDC Panel Mount Junction Blocks

10 - 5 Pole MDC ❖ 3 Pin Pluggable Power Connector ❖ 25 Pin D-Sub

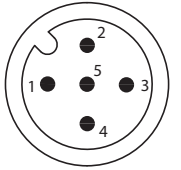
Face View of Female MDC	# of Poles	Rating	Part Number
	5	300V 3A	D32-10MDC-DB25

Materials:

Plate: Stainless Steel

Gasket: NBR

10 - 5 Pin Female MDC Receptacles

3 Pin pluggable power connector
(for alternative to DB25 pins 21 - 25)

25 Pin D-Sub male connector

Wiring			
PORT #	PIN #	DB25 PIN #	3 PIN Pluggable PIN #
ALL PORTS	1	23 & 24	V+
ALL PORTS	3	21 & 22	V-
ALL PORTS	5	25	Ground
J1	4	1	
J1	2	2	
J2	4	3	
J2	2	4	
J3	4	5	
J3	2	6	
J4	4	7	
J4	2	8	
J5	4	9	
J5	2	10	
J6	4	11	
J6	2	12	
J7	4	13	
J7	2	14	
J8	4	15	
J8	2	16	
J9	4	17	
J9	2	18	
J10	4	19	
J10	2	20	

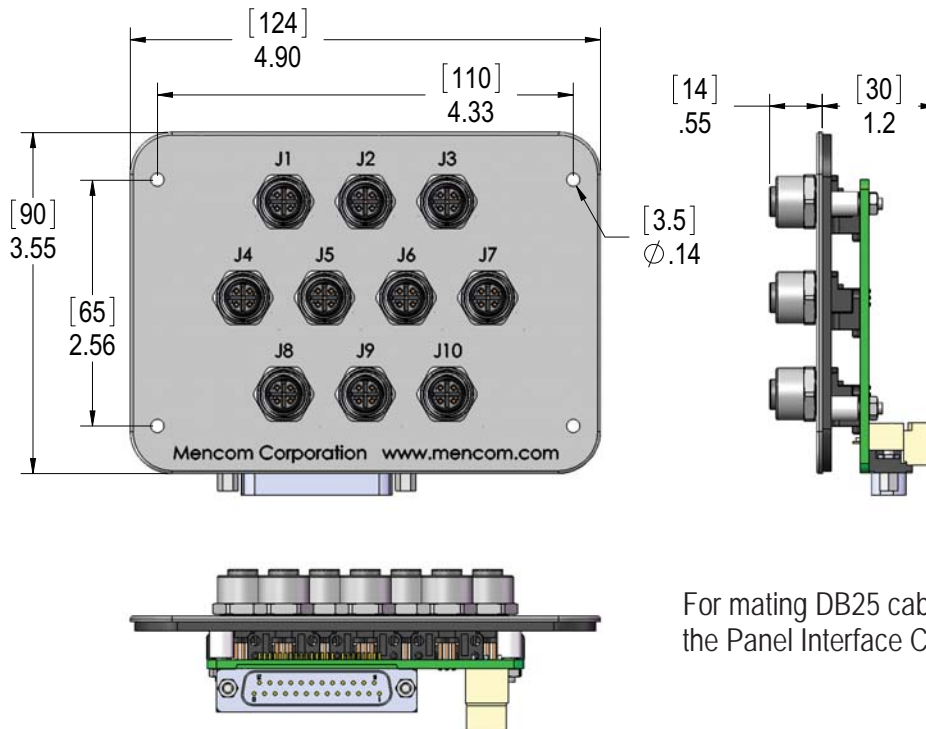

For mating DB25 cable, see page W-17 in the Panel Interface Connector Section.

JDC Panel Mount Junction Blocks

10 - 5 Pole MDC ❖ 3 Pin Pluggable Power Connector ❖ 20 Pin Ribbon Cable

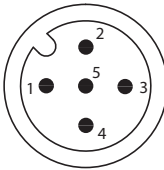
Face View of Female MDC	# of Poles	Rating	Part Number
	5	300V 3A	D32-10MDC-RC20

Materials:

Plate: Stainless Steel
Gasket: NBR

10 - 5 Pin Female MDC Receptacles

3 Pin pluggable power connector

20 Pin Ribbon Cable

Wiring			
PORT #	PIN #	20 PIN Ribbon Cable	3 PIN Pluggable PIN #
ALL PORTS	1		V+
ALL PORTS	3		V-
ALL PORTS	5		Ground
J1	4	1	
J1	2	2	
J2	4	3	
J2	2	4	
J3	4	5	
J3	2	6	
J4	4	7	
J4	2	8	
J5	4	9	
J5	2	10	
J6	4	11	
J6	2	12	
J7	4	13	
J7	2	14	
J8	4	15	
J8	2	16	
J9	4	17	
J9	2	18	
J10	4	19	
J10	2	20	

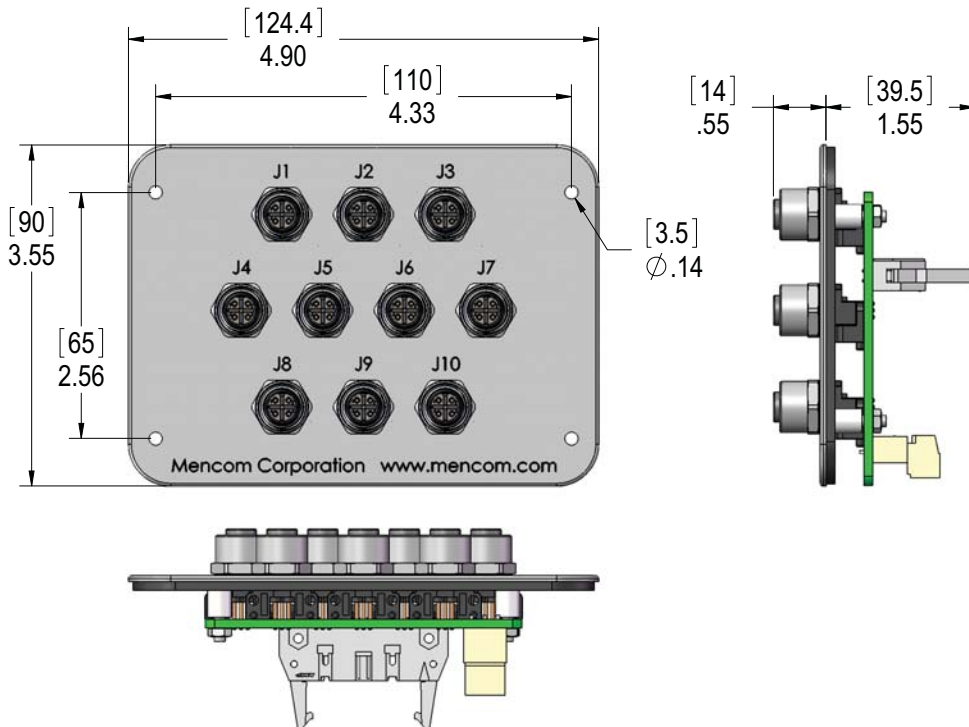

JDC Junction Blocks

JDC Panel Mount Junction Block

10 - 5 Pole MDC ❖ 3 Pin Pluggable Power Connector ❖ Terminal Block

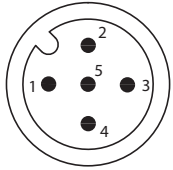
Face View of Female MDC	# of Poles	Rating	Part Number
	5	300V 3A	D32-10MDC-TB23

Materials:

Plate: Stainless Steel
Gasket: NBR

10 - 5 Pin Female MDC Receptacles

23 Pin Push Button Spring-Clamp Terminal Blocks

Wiring		
PORT #	PIN #	Terminal Block # and PIN #
ALL PORTS	1	V+
ALL PORTS	3	V-
ALL PORTS	5	Ground
J1	4	2 - J1
J1	2	3 - J1
J2	4	2 - J2
J2	2	3 - J2
J3	4	2 - J3
J3	2	3 - J3
J4	4	2 - J4
J4	2	3 - J4
J5	4	2 - J5
J5	2	3 - J5
J6	4	2 - J6
J6	2	3 - J6
J7	4	2 - J7
J7	2	3 - J7
J8	4	2 - J8
J8	2	3 - J8
J9	4	2 - J9
J9	2	3 - J9
J10	4	2 - J10
J10	2	3 - J10

JDC Junction Blocks

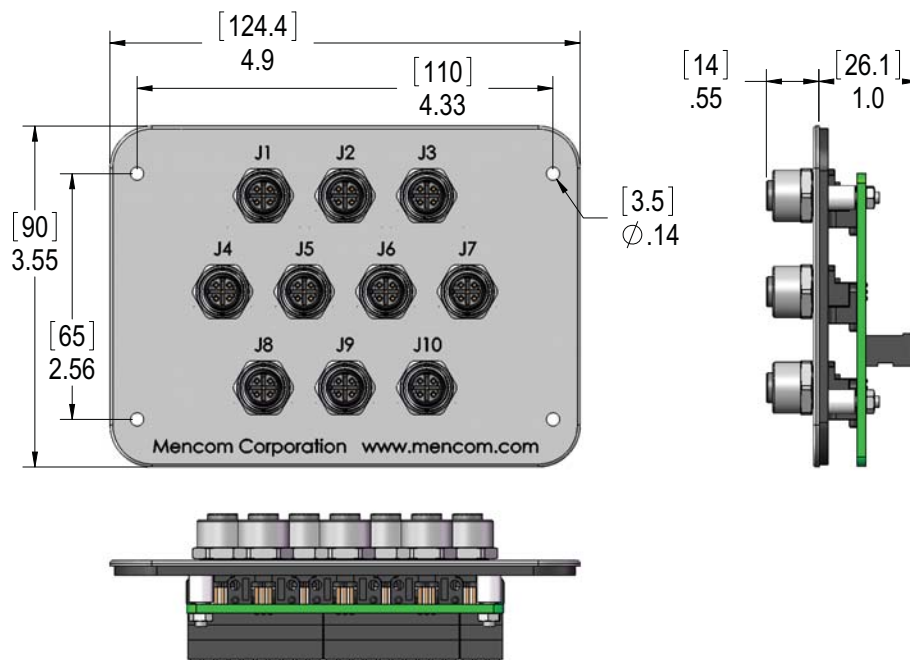

JDC Specifications

JDC Junction Block Specifications:

Ratings:	3 A per Connector 8 A per Block
Voltage:	Without LEDs: 0-150 Volt Max With LEDs: 48 VDC Max in accordance with LED Configuration
Body:	Polypropylene
Inserts:	Polyamide
Coupling Nuts:	4, 6, & 8 Port: PBT 10 & 12 Port: Nickel Plated Brass
O-Ring:	BUNA-N
LED Lens:	Polycarbonate
Contacts:	Copper Alloy with Gold Plating
Marker Tags:	Polyamide (supplied on all units)

JDC Panel Mounted Junction Block Specifications:

Ratings:	3 A per Connector 8 A per Block
Body:	Stainless Steel
Inserts:	Polyamide
Coupling Nuts:	Nickel Plated Brass
O-Ring:	BUNA-N
Contacts:	Copper Alloy with Gold Plating
Gasket:	Closed Cell PVC/NBR

