

Part Number	Size (Male)	A	B	C	D
30-210-0	9-pin	16.92	25.00	30.80	19.2
30-211-0	15-pin	25.25	33.30	39.20	27.7
30-212-0	25-pin	38.96	47.10	53.10	41.1
30-213-0	37-pin	55.42	63.50	69.40	57.3

Part Number	Size (Female)	A	B	C	D
30-220-0	9-pin	16.30	25.00	30.80	19.2
30-221-0	15-pin	24.60	33.30	39.20	27.7
30-222-0	25-pin	38.30	47.10	53.10	41.1
30-223-0	37-pin	54.80	63.50	69.40	57.3

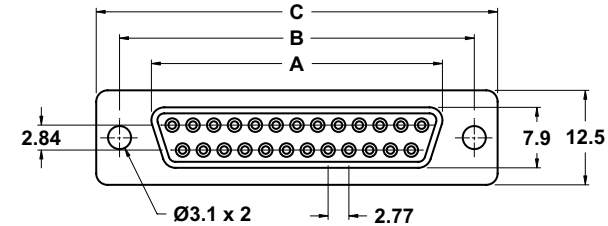
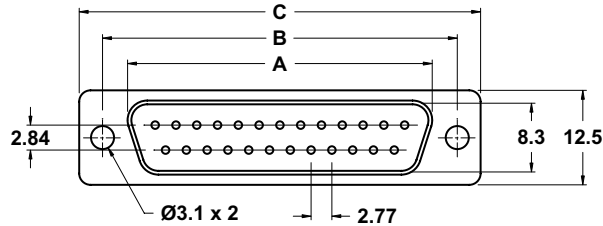

MALE

FEMALE

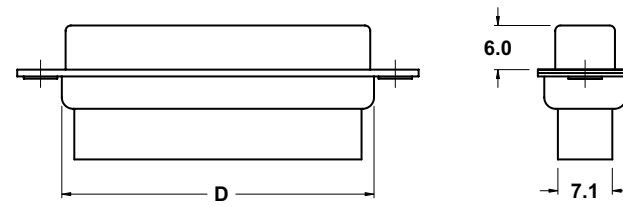
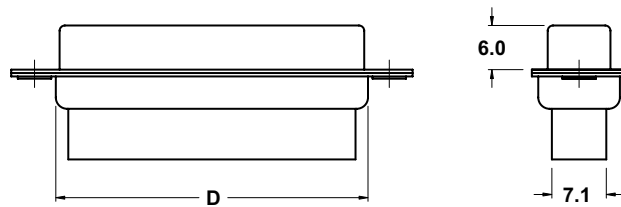

NOTE:

Electrical

Operation Voltage: 250VAC Max.
 Current Rating: 3 Amps Max.
 Contact Resistance: 15 Miliohms Max.
 Insulation Resistance: 3000 Megaohms Min. @ 500VDC
 Dielectric Withstanding Voltage: 1000VAC / Minute
 Operating Temp.: -55°C to 105°C

Materials

Insulator: Thermal Plastic UL94V-0
 Contacts: Copper Alloy
 Shell: Steel
 Rivet, Boardlock: Copper Alloy

Contact Plating

Underplated: 50µ" ~ 100µ" Nickel
 Contact Area: 1µ" ~ 50µ" Selective Gold
 Solder Toils Area: 100µ" ~ 200µ" Tin/Lead(Brighten Tin) or
 100µ" ~ 200µ" Tin/Lead Free(Brighten Tin/Motte Tin)

TITLE		SCALE
CRIMP D-SUB HOUSING		1 : 1
DRAWING NO.	30-21X & 30-22X	
	UNITS	mm
FILE NAME	30-21X & 30-22X.pdf	
	SHEET	1/1



Mode Electronics Part Number 'multi-parts'