

| PANEL THICK | W |
|-------------|------|
| 0.75-1.25 | 19.2 |
| 1.25-2.0 | 19.4 |
| 2.0-3.0 | 19.8 |

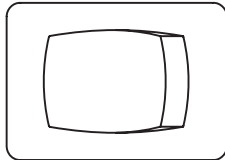

Specifications:

Rating: 10A @125VAC / 6A @ 250 VAC
 Contact Resistance: 30m Ω Max.
 Insulation Resistance: 500VDC 100M Ω Min.
 Withstand Voltage: 1000VAC 1 Minute
 Operation Force: 800 \pm 300g
 Electrical Life: 10000 Cycles at Full Load
 Operating Temperature Range: -25 $^{\circ}$ C ~ 85 $^{\circ}$ C
 Soldering: 280 $^{\circ}$ C for 3 Sec.

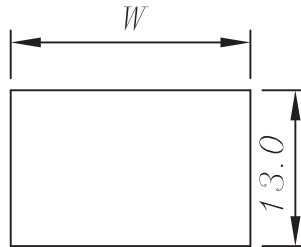
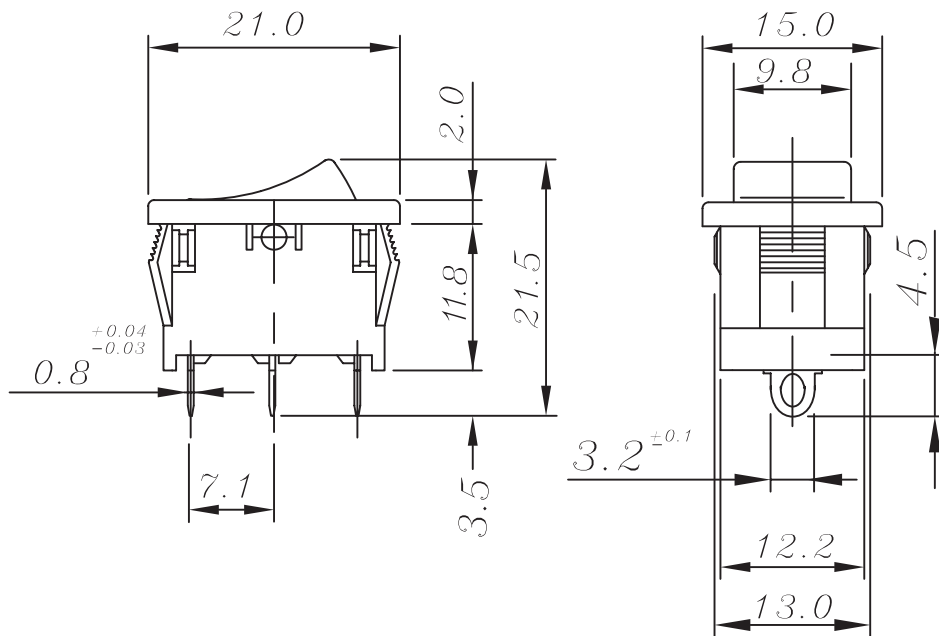

| TITLE | | SCALE |
|----------------------|----------------|------------|
| ROCKER SWITCH | | NTS |
| DRAWING NO. | 46-145J | |
| | | UNITS mm |
| FILE NAME | 46-145J.pdf | SHEET 1/1 |



Mode Electronics Part Number 46-145J-0