

DATE	REVISIONS	REV
10-2-93	CHG'D LEAD LENGTH./	A
7-28-95	UPDATED SPECS./	B
1-30-97	E.C.N. #10301./	C

DRAWING NUMBER  
SSF-LXH100YD(-01) REV C

REPLACES LUMEX P/N SSF-LXH100YD (-1)

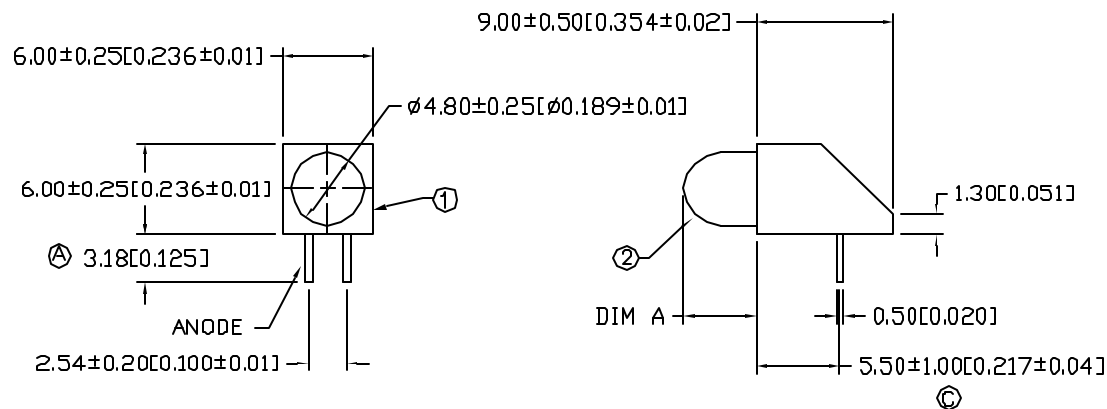

DIM. A

NO P/N SUFFIX: 3.2 ±0.5 (.126 ±.02)  
WITH -1 SUFFIX: 4.7 ±0.5 (.187 ±.02)

NOTES:

- SSH-LXH100 HOLDER, BLACK.
- NO P/N SUFFIX, SSL-LX507F3YD  
WITH -01 SUFFIX, SSL-LX509F3YD

ELECTRO-OPTICAL CHARACTERISTICS  $T_A=25^\circ\text{C}$   $I_f=20\text{mA}$

PARAMETER	MIN	TYP	MAX	UNITS	TEST COND
PEAK WAVELENGTH		585 (YELLOW)		nm	
FORWARD VOLTAGE		2.1	2.5	$V_f$	
REVERSE VOLTAGE	5.0			$V_r$	$I_r=100\mu\text{A}$
AXIAL INTENSITY		30		mcad	$I_f=20\text{mA}$
VIEWING ANGLE		60		2x theta	
EMITTED COLOR		YELLOW			
EPOXY LENS FINISH		YELLOW DIFFUSED			

Ⓐ LIMITS OF SAFE OPERATION AT 25°C

PARAMETER	MAX	UNITS
PEAK FORWARD CURRENT*	150	mA
STEADY CURRENT	30	mA
POWER DISSIPATION	105	mW
DERATE FROM 25°C	-1.2	mW/°C
OPERATING, STORAGE TEMP	-40 TO +85	°C
LEAD SOLDERING TEMP	+260	°C
2.0mm FROM BODY		3 SEC. MAX

\*  $t < 10\mu\text{s}$

RELIABILITY NOTE

OUR MANY YEARS OF EXPERIENCE DATA ACCUMULATION INDICATE THAT SOLDER HEAT IS A MAJOR CAUSE OF EARLY AND FUTURE FAILURE. PLEASE PAY ATTENTION TO YOUR SOLDERING PROCESS.

**LUMEX**  
OPTO COMPONENTS INC.

290 E. HELLEN ROAD  
PALATINE, ILLINOIS 60067  
(847) 359-2790

CONFIDENTIAL INFORMATION  
THE INFORMATION CONTAINED IN THIS DOCUMENT IS THE PROPERTY OF LUMEX OPTO/COMPONENTS, INC. EXCEPT AS SPECIFICALLY AUTHORIZED IN WRITING BY LUMEX OPTO/COMPONENTS, INC., THE HOLDER OF THIS DOCUMENT SHALL KEEP ALL INFORMATION CONTAINED HEREIN CONFIDENTIAL AND SHALL PROTECT SAME IN WHOLE OR IN PART FROM DISCLOSURE AND DISSEMINATION TO ALL THIRD PARTIES.

DATE: 7-15-93	DWN:	CHK'D:	APPD:
SCALE: N/A			

T-5 (T-1 3/4) LED, RIGHT ANGLE FAULT INDICATOR,  
YELLOW DIFFUSED

UNLESS OTHERWISE SPECIFIED TOLERANCE IS  $\pm 0.25\text{mm}$  ( $\pm 0.010''$ )

MB/40

PAGE 1 OF 1

DRAWING NUMBER  
SSF-LXH100YD(-01)

REV  
C