

Terminal Block Accessories

Kliptite (Quick Connect) - Single Row

Specifications:

Kliptite (Quick Connect) accept standard female wire terminals. These Kliptites are ideal for applications that require a positive, yet quick disconnect termination. Kliptites are assembled to the block with screws or, in some applications, riveted to the block.

Kliptites are available in 0°, 45° or 90° bends; one side or two side. Material: Brass; Finish: Tin

Screw Construction	Rivet Construction	Tab Width	Tab Thickness	(2) 0° tabs	(2) 45° tabs	(2) 90° tabs	(1) 0° tab	(1) 45° tab	(1) 90° tab
411 Series		0.110	0.020	KT10	KT11	KT12	KT16	KT17	KT18
599 Series	799 Series	0.187	0.020	KT28	KT29	KT30	KT34	KT35	KT36
699 Series	899 Series	0.250	0.032	KT46	KT47	KT48	KT52	KT53	KT54
812 Series	912 Series	0.250	0.032	KT73	KT74	KT75	KT79	KT80	KT81
1690 Series ¹		0.250	0.032	KT46	KT47	KT48	KT52	KT53	KT54
2590 Series ²		0.187	0.020	KT28	KT29	KT30	KT34	KT35	KT36
2690 Series ³		0.250	0.032	KT46	KT47	KT48	KT52	KT53	KT54

- 1) 1690 Series insulated feed-thru blocks use the 699 Series Kliptites
- 2) 2590 Series use the 599 Series Kliptites
- 3) 2690 Series PC block use the 699 Kliptites

TWO SIDE TABS

ONE SIDE TABS

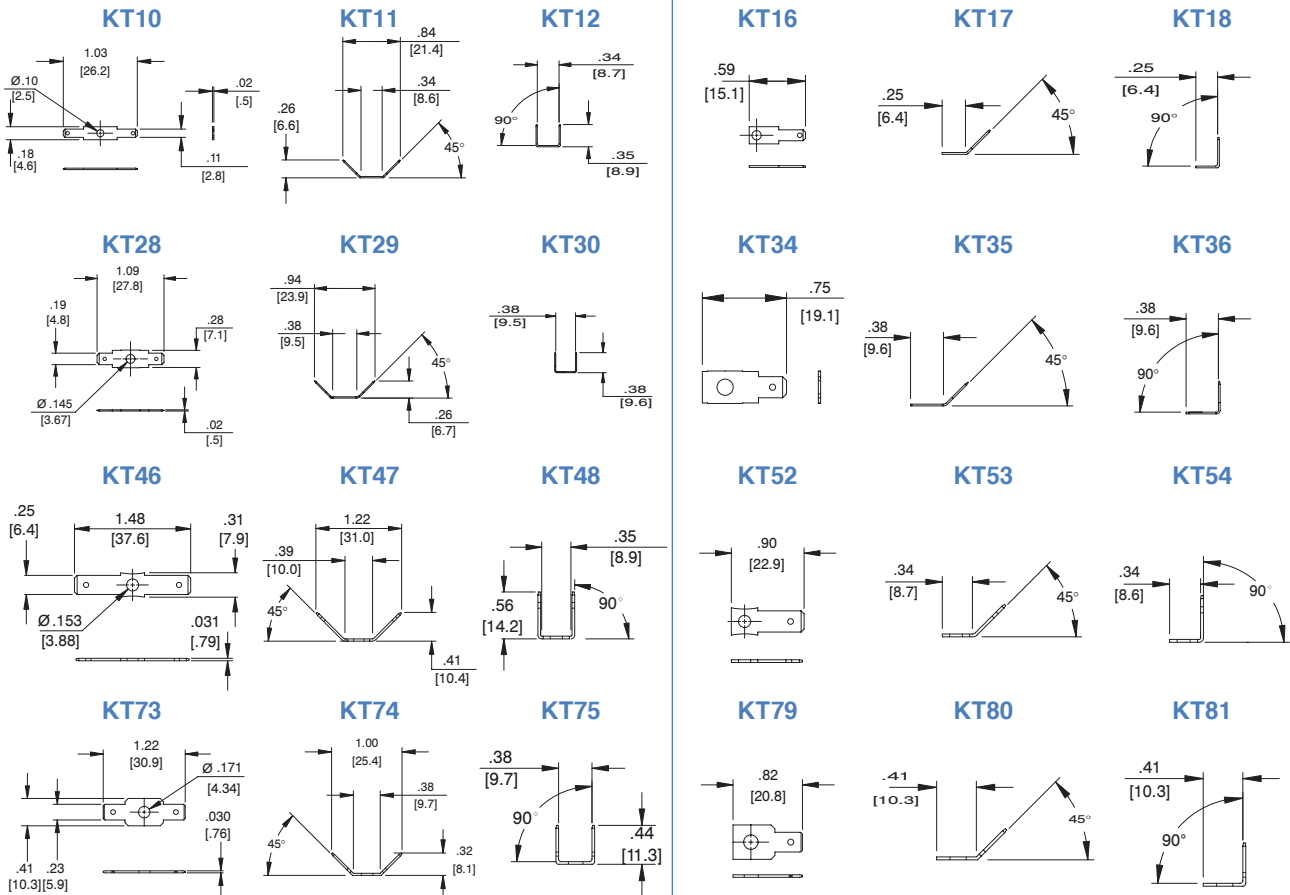

Terminal Block Accessories

Kliptite (Quick Connect) - Double Row

Screw Construction	Rivet Construction	Tab Width	Tab Thickness	(2) 0° tabs	(2) 45° tabs	(2) 90° tabs	(1) 0° tab	(1) 45° tab	(1) 90° tab
100 Series ⁴		0.187	0.020	KT19	KT20	KT21	KT25	KT26	KT27
200 Series ⁵		0.250	0.032	KT37	KT38	KT39	KT43	KT44	KT45
300 Series ⁶		0.250	0.032	KT55	KT56	KT57	KT61	KT62	KT63
400 Series		0.250	0.032	KT67	KT68	KT69	KT64	KT65	KT66
600 Series		0.187	0.020	KT19	KT20	KT21	KT25	KT26	KT27
600A Series		0.187	0.020	KT19	KT20	KT21	KT25	KT26	KT27
601 Series	800A Series	0.250	0.032	KT37	KT38	KT39	KT43	KT44	KT45
602 Series	801 Series	0.250	0.032	KT55	KT56	KT57	KT61	KT62	KT63
603 Series	802 Series	0.250	0.032	KT67	KT68	KT69	KT64	KT65	KT66
621 RZ Series ⁵		0.250	0.032	KT37	KT38	KT39	KT43	KT44	KT45
670A GP Series ⁴		0.187	0.020	KT19	KT20	KT21	KT25	KT26	KT27
670A RZ Series ⁴		0.187	0.020	KT19	KT20	KT21	KT25	KT26	KT27
671 GP Series ⁵		0.250	0.032	KT37	KT38	KT39	KT43	KT44	KT45
671 RZ Series ⁵		0.250	0.032	KT37	KT38	KT39	KT43	KT44	KT45
672 GP Series ⁶		0.250	0.032	KT55	KT56	KT57	KT61	KT62	KT63
672 RZ Series ⁶		0.250	0.032	KT55	KT56	KT57	KT61	KT62	KT63

- 4) 100, 670A GP, 670A RZ Series use the 600, 600A Series Kliptites
 5) 200, 671 GP, 671 RZ, 621 RZ Series use the 601 Series Kliptites
 6) 300, 672 GP, 672 RZ Series use the 602 Series Kliptites

MSP Catalog Designations:
 2-SIDE TABS: F1 (0°), F2 (45°), F3 (90°)
 1-SIDE TABS: HF1 (0°), HF2 (45°), HF3 (90°)

TWO SIDE TABS

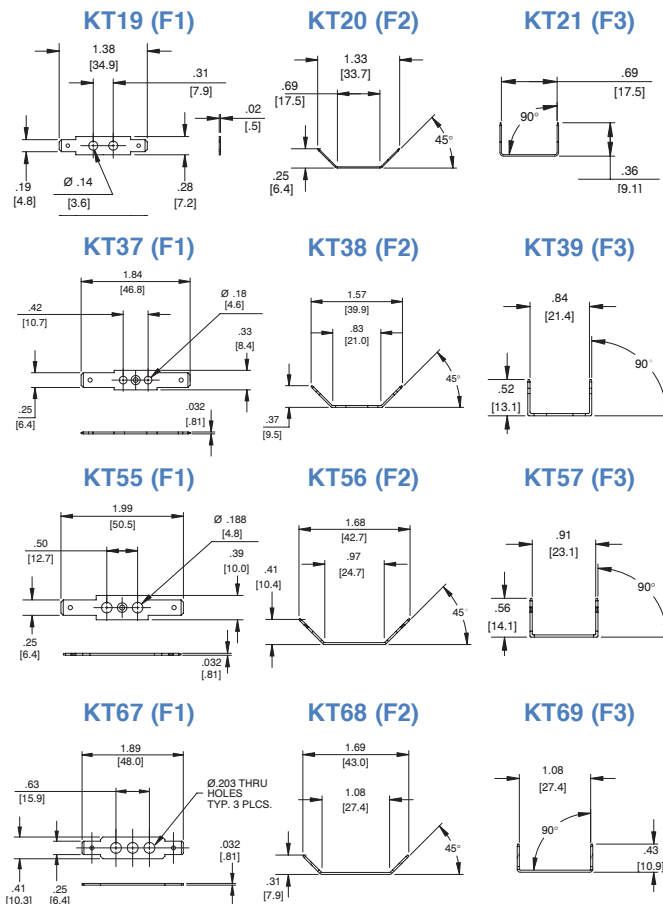

ONE SIDE TABS

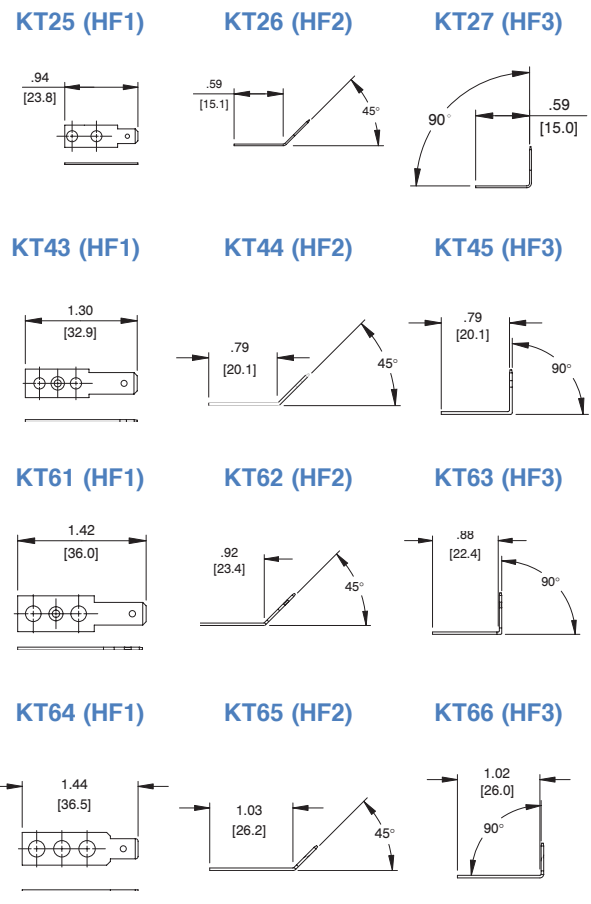

Terminal Block Accessories

Solder Terminal Lugs

ST and 3/4 ST Types

	FIGURE	A	B	C	D	E	F	G	H	J	M	N	R	T	ALSO USED ON
411 ST	SEE FIGURE #1														
411 3/4ST	SEE FIGURE #1A														
599 3/4ST	FIG 2	0.56	--	--	--	0.28	0.16	0.06	0.16	0.032	0.144	0.093	0.11	--	2590, 2590A
600 ST	FIG 3	1.22	0.75	0.69	0.31	0.28	0.16	0.06	0.16	0.032	0.144	0.093	--	--	600A, 670A GP
600 3/4ST	FIG 3A	0.92	--	--	0.31	0.28	0.16	0.06	0.16	0.032	0.144	0.093	0.15	--	
601 ST	FIG 3	1.58	0.94	0.84	0.42	0.31	0.21	0.06	0.21	0.036	0.148	0.125	--	--	621 RZ
601 3/4ST	FIG 3A	1.17	--	--	0.42	0.31	0.21	0.06	0.21	0.036	0.148	0.125	0.17	--	
602 ST	FIG 3	1.85	1.06	0.94	0.50	0.41	0.28	0.09	0.28	0.036	0.177	0.125	--	--	672 GP
602 3/4ST	FIG 3A	1.37	--	--	0.50	0.41	0.28	0.09	0.28	0.036	0.177	0.125	0.20	--	
699 3/4ST	FIG 2	0.70	--	--	--	0.31	0.21	0.06	0.21	0.032	0.146	0.125	0.13	--	1690, 2690
812 3/4ST	FIG 2	0.88	--	--	--	0.41	0.28	0.09	0.28	0.037	0.177	0.125	0.19	--	

mm = dim x 25.4

MSP Catalog Designations: ST = S 3/4ST = HS

To ensure solderability, use within six (6) months.

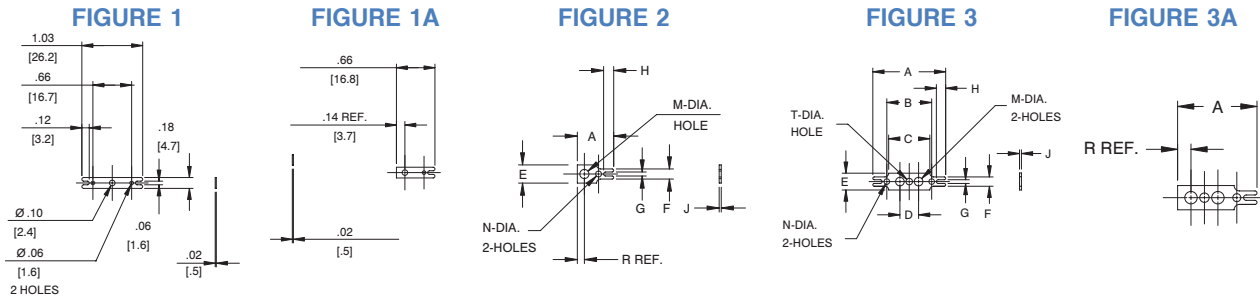

Y, YSY and Z Types (Material: Brass Finish Electro-Tin Plated)

	FIGURE	A	B	C	D	E	F	H	J	M	L (see detail R)	ALSO USED ON	
599Z, 600Y	FIG 6	0.28	0.48	0.33	0.085	0.63	0.036	NA	0.144	NA	599Z=0.31, 600Y=0.31	670A RZ	
600YSY	FIG 6	0.28	0.48	0.33	0.085	0.82	0.036	NA	0.144	NA	0.50	670A RZ	
600Z	FIG 7	0.28	0.73	0.25	0.140	0.94	0.036	0.31	0.160	0.143	0.62	670A RZ	
699Z, 601Y	FIG 4	0.31	0.63	0.44	0.099	0.80	0.036	NA	0.148	NA	699Z=0.42, 601Y=0.42		
601YSY	FIG 5	0.31	0.63	0.44	0.099	1.07	0.040	NA	0.148	NA	0.69		
602Y	FIG 4	0.43	0.75	0.52	0.125	0.95	0.040	NA	0.177	NA	0.49		
812Z, 602YSY	FIG 5	0.40	0.70	0.52	0.125	1.13	0.040	NA	0.177	NA	812Z=0.64, 602YSY=0.67		
602Z	FIG 8	0.40	1.09	0.38	0.203	1.06	0.040	0.50	0.177	NA	0.60		
603Y	FIG 9	NOTE: For factory assembly only onto 603 Terminal Boards										0.60	
672 YSY	FIG 7	0.42	0.70	0.27	0.08	1.02	0.040	0.25	NA	0.14	0.56	300 series	

mm = dim x 25.4

MSP Catalog Designations: Y = L YSY = LSL

To ensure solderability, use within six (6) months.

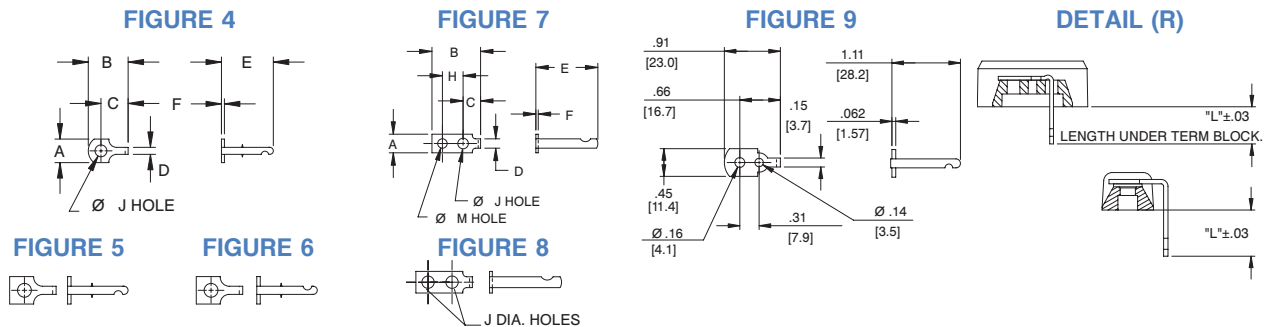

Figures 5 & 6 same as Figure 4 except as shown

Same as Figure 7 except as shown

Terminal Block Accessories

J & JS Jumpers

Catalog #	A	B	C	D	E	F	G	H	J	K
J 410/J 411	0.41	0.25	0.19	0.09	0.10	0.04	0.010	0.094	0.08	NA
J 600	0.62	0.38	0.25	0.12	0.16	0.04	0.015	0.156	0.08	NA
J 601	0.71	0.45	0.31	0.15	0.19	0.06	0.015	0.166	0.11	NA
J 602	0.91	0.56	0.37	0.18	0.27	0.08	0.015	0.190	0.16	NA
J 603	1.13	0.69	0.43	0.21	0.25	0.12	0.031	0.201	0.24	NA
J 604	1.38	0.88	0.50	0.25	0.35	0.15	0.035	0.234	0.32	NA
J 605	1.75	1.13	0.62	0.31	0.39	0.24	0.035	0.266	0.54	NA
J 621	0.69	0.44	0.30	0.17	0.38	0.07	0.015	0.141	0.11	0.14
JS 600	0.62	0.38	0.25	0.12	0.16	0.04	0.015	0.156	0.08	0.16
JS 601	0.71	0.45	0.31	0.15	0.19	0.06	0.015	0.166	0.11	0.17
JS 602	0.91	0.56	0.37	0.18	0.27	0.08	0.015	0.190	0.16	0.14

MSP Catalog Designations:
 J 600 = LL 100
 J 601 = LL 200
 J 602 = LL 300
 J 603 = LL 400

Material: Brass
 Finish: Nickel Plate

mm = dim X 25.4

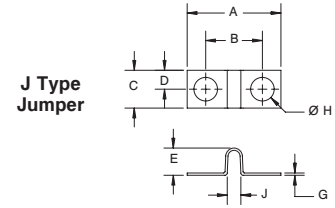

J Type Jumper
 (per 55164/28B)

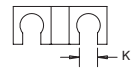

NOTE 1: These parts are not necessarily supplied flat. The functioning of the part, however, will not be interfered.

NOTE 2: All dimensions are applicable after the bus (jumper) is torqued down into the associate terminal board.

RJ Type Jumpers

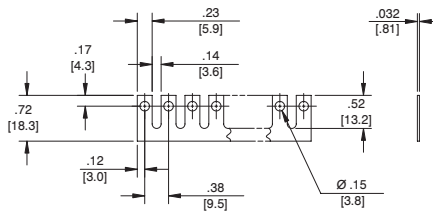

600 RJ

Max # of sections = 24

Note: 670A RZ, 599 Series, use 600 RJ

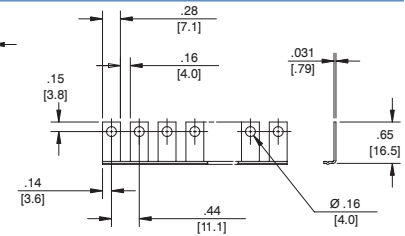

601 RJ

Max # of sections = 24

Material: Brass
 Finish: Nickel Plate

RJS Type Jumpers

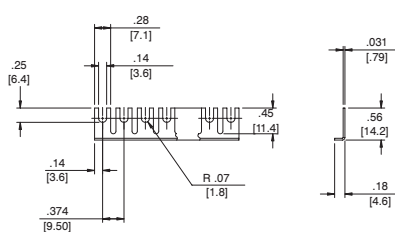

600 RJS

Max # of sections = 24

Note: 670A RZ, 599 Series, use 600 RJ

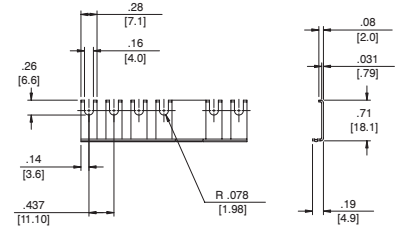

601 RJS

Max # of sections = 24

Material: Brass
 Finish: Nickel Plate

Wire Clamp

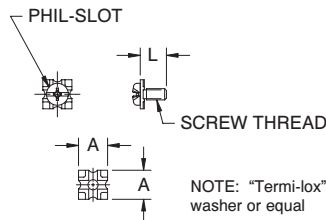

Catalog #	Material	Finish	Screw Thread	L	A
3786	Steel	Nickel	8-32 UNC	0.38	0.41
3765			6-32 UNC	0.31	0.33
3780	Brass	Nickel	8-32 UNC	0.38	0.41
3760			6-32 UNC	0.31	0.33
3860	Brass	Nickel	6-32 UNC	0.30	0.29
3865	Steel	Nickel	6-32 UNC	0.30	0.29

mm = dim X 25.4

Straddle Plate

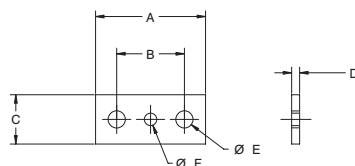

Catalog #	A	B	C	D	E	F	Material	Finish
SPB 600	0.56	0.31	0.30	0.032	0.144	N/A	Brass	Tin
SPB 601	0.71	0.42	0.30	0.031	0.148	N/A	Brass	Nickel
SPB 602	0.87	0.50	0.40	0.032	0.189	N/A	Brass	Nickel
SPB 603	1.03	0.62	0.45	0.063	0.190	0.143	Brass	Tin
SPB 604	1.21	0.75	0.54	0.087	0.187	0.138	Brass	Tin
SPB 605	1.46	0.87	0.63	0.116	0.220	0.138	Brass	Nickel

mm = dim X 25.4

Terminal Block Accessories

Kulka® Fanning Strips

- Terminals, Brass, Tin Plated
- Material: XP = Phenolic, Black
GME = Glass Cloth Melamine
Per MIL-M-14 Light Brown Term

649 Series

- For 410 and 411 Series Terminal Blocks
- Available in XP Phenolic Only

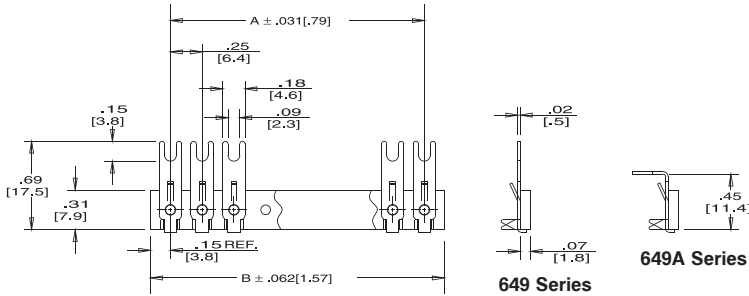

# of Term.	A	B	# of Term.	A	B
2	0.250	0.562	13	3.000	3.312
3	0.500	0.812	14	3.250	3.562
4	0.750	1.062	15	3.500	3.812
5	1.000	1.312	16	3.750	4.062
6	1.250	1.562	17	4.000	4.312
7	1.500	1.812	18	4.250	4.562
8	1.750	2.062	19	4.500	4.812
9	2.000	2.312	20	4.750	5.062
10	2.250	2.562	21	5.000	5.312
11	2.500	2.812	22	5.250	5.562
12	2.750	3.062			

650/651/652 Series

- 650 Series for 599, 600, and 670A RZ Series Terminal Blocks
- 651 Series for 601 and 699 Series Terminal Blocks
- 652 Series for 602 and 812 Series Terminal Blocks

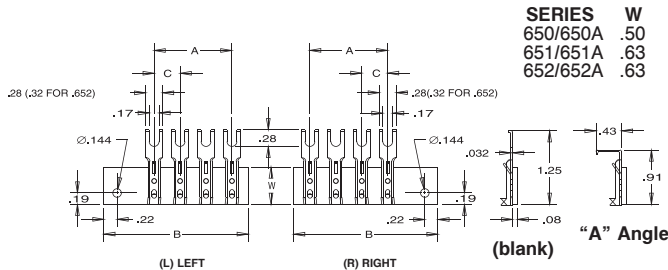

SERIES	650 / 650A		651 / 651A		652 / 652A	
C	3/8 (.375)		7/16 (.4375)		9/16 (.5625)	
# of Term.	A	B	A	B	A	B
2	.375	1.435	.437	1.497	.562	1.622
3	.750	1.810	.875	1.935	1.125	2.185
4	1.125	2.185	1.312	2.372	1.687	2.747
5	1.500	2.560	1.750	2.610	2.250	3.310
6	1.875	2.935	2.187	3.247	2.812	3.872
7	2.250	3.310	2.625	3.685	3.375	4.435
8	2.265	3.685	3.062	4.122	3.937	4.997
9	3.000	4.060	3.500	4.560	4.500	5.560
10	3.375	4.435	3.937	4.997	5.062	6.122
11	3.750	4.810	4.375	5.435	5.625	6.685
12	4.125	5.165	4.812	5.872	6.187	7.247
13	4.500	5.560	5.250	6.310	6.750	7.810
14	4.875	5.935	5.687	6.747	7.312	8.372
15	5.250	6.310	6.125	7.185	7.875	8.935
16	5.625	6.685	6.562	7.622	8.437	9.497
17	6.000	7.060	7.000	8.060	9.000	10.060
18	6.375	7.435	7.437	8.497	9.562	10.622
19	6.750	7.810	7.875	8.935	10.125	11.185
20	7.125	8.186	8.312	9.372	10.687	11.747
21	7.500	8.560	8.750	9.810	11.250	12.310
22	7.875	8.935	9.187	10.247	11.812	12.872
23	--	--	9.625	10.685	12.375	13.435
24	--	--	--	--	12.937	13.997
25	--	--	--	--	13.500	14.560
26	--	--	--	--	14.062	15.122

Ordering Code

For convenience and accuracy in ordering, please specify catalog numbers as shown:

- For Marking Strips, use an "MS" prefix on the series
- For Insulator Strips, use an "IS" prefix on the series

Series	Mat. Code	Angle	Position	# of Terminals
649	XP	A	L	5
650	GME	(or leave blank)	R	
651				
652				

Terminal Block Accessories

Kulka® Stud and Turret Terminal Blocks

Threaded Stud

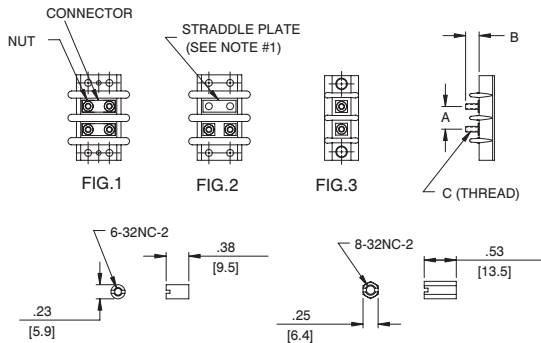

Catalog #	Figure	A	B	C
599 GP 2002 XX	FIG 3	0.38	0.34	6-32 NC
600A GP 2002 XX	FIG 2	0.38	0.38	6-32 NC
601 GP 2102 XX	FIG 2	0.44	0.44	6-32 NC
602 GP 2202 XX	FIG 2	0.56	0.50	8-32 NC
603 GP 2302 XX	FIG 1	0.69	0.50	10-32 NF
604 GP 2402 XX	FIG 1	0.88	0.44	10-32 NF
605 GP 2502 XX	FIG 1	1.13	0.75	1/4-28 NF
699 GP 2102 XX	FIG 3	0.44	0.44	6-32 NC
812 GP 2202 XX	FIG 3	0.56	0.50	8-32 NC

NOTE 1: Standard with block, but packed separately
 NOTE 2: 604 and 605 nuts are part of the assembly.
 Additional nuts (one per stud) are supplied in bulk.

XX = # of terminals

Screw Terminal with Feed-Thru Solder Terminal

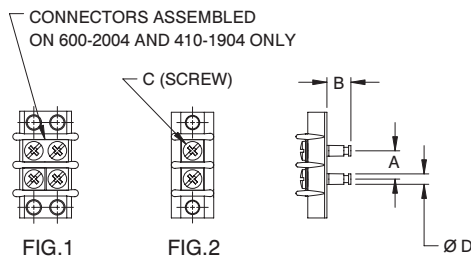

Catalog #	Figure	A	B	C	D
411 GP 1904 XX	FIG 2	0.25	0.28	2-56 NC X .19	0.11
599 GP 2004 XX	FIG 2	0.38	0.31	5-40 NC X .25	0.14
600 GP 2004 XX	FIG 1	0.38	0.31	5-40 NC X .25	0.14
601 GP 2104 XX	FIG 1	0.44	0.38	6-32 NC X .25	0.13
699 GP 2104 XX	FIG 2	0.44	0.38	6-32 NC X .25	0.13
812 GP 2204 XX	FIG 2	0.56	0.44	8-32 NC X .25	0.14

To ensure solderability, use within six (6) months. XX = # of terminals

Screw Terminal with Solder Pin for Printed Circuit Board Connection

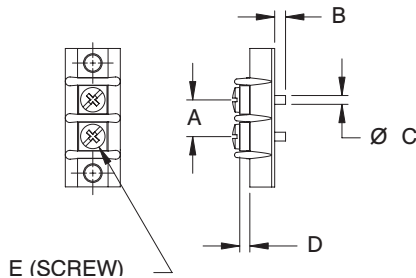

Catalog #	A	B	C	D	E
599 GP 2020 XX	0.38	0.13	0.09	0.09	5-40 NC X .19
599 GP 2021 XX	0.38	0.13	0.09	0.03	5-40 NC X .19
699 GP 2120 XX	0.44	0.19	0.09	0.04	6-32 NC X .25
699 GP 2121 XX	0.44	0.20	0.06	0.04	6-32 NC X .25

To ensure solderability, use within six (6) months. XX = # of terminals

Individual Screw Terminals

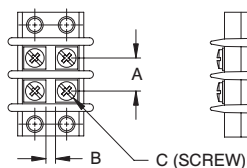

Catalog #	A	B	C
601 GP 2108 XX	0.44	0.09	6-32 NC X .25

XX = # of terminals

Terminal Block Accessories

Double Row - Top Mounted Covers/Marking Strips

Specifications:

- White Vinyl Material, 0.03" thick
- Two Nylon Spring Clips for Mounting Provided
- **Marking Strips:** Printed on Center Line with Letters or Numbers for Circuit Identification
- **Covers:** Printed on Top, Bottom or Center Line with Letters or Numbers for Circuit Identification
- Printing Character Size is 1/8 Inch
- Unless Otherwise Specified, the Marking goes down the Center of the Cover for Print Styles 01A, 01B, 01C, 01D
- Marking goes down the 2 Sides of the Cover for Print Styles 07A, 07B, 07C, 07D

Number of Terminals	Series 1		Series 2		Series 3	
	A	B	A	B	A	B
1	0.91	0.55	1.01	0.65	1.16	0.80
2	1.29	0.93	1.44	1.08	1.73	1.37
3	1.66	1.30	1.88	1.52	2.29	1.93
4	2.04	1.68	2.32	1.96	2.85	2.49
5	2.41	2.05	2.76	2.40	3.42	3.06
6	2.79	2.43	3.19	2.83	3.98	3.62
7	3.16	2.80	3.63	3.27	4.54	4.18
8	3.56	3.20	4.07	3.71	5.10	4.74
9	3.91	3.55	4.50	4.14	5.67	5.31
10	4.29	3.93	4.94	4.58	6.23	5.87
11	4.66	4.30	5.38	5.02	6.79	6.43
12	5.04	4.68	5.81	5.45	7.36	7.00
13	5.41	5.05	6.25	5.89	7.92	7.56
14	5.79	5.43	6.69	6.33	8.48	8.12
15	6.16	5.80	7.13	6.77	9.05	8.69
16	6.54	6.18	7.56	7.20	9.61	9.25
17	6.91	6.55	8.00	7.64	10.17	9.81
18	7.29	6.93	8.44	8.08	10.73	10.37
19	7.66	7.30	8.87	8.51	11.30	10.94
20	8.04	7.68	9.31	8.95	11.86	11.50
21	8.41	8.05	9.75	9.39	12.42	12.06
22	8.79	8.43	10.18	9.82	12.99	12.63
23	9.16	8.80	10.62	10.26	13.55	13.19
24	9.54	9.18	11.06	10.70	14.11	13.75
25	9.91	9.55	11.50	11.14	--	--
26	10.29	9.93	11.93	11.57	--	--
27	10.66	10.30	12.37	12.01	--	--
28	11.04	10.68	12.81	12.45	--	--
29	11.41	11.05	13.24	12.88	--	--
30	11.79	11.43	13.68	13.32	--	--
31	12.16	11.80	--	--	--	--
32	12.54	12.18	--	--	--	--
33	12.91	12.55	--	--	--	--
34	13.29	12.93	--	--	--	--
35	13.66	13.30	--	--	--	--
36	14.04	13.68	--	--	--	--

NYLON SPRING CLIP

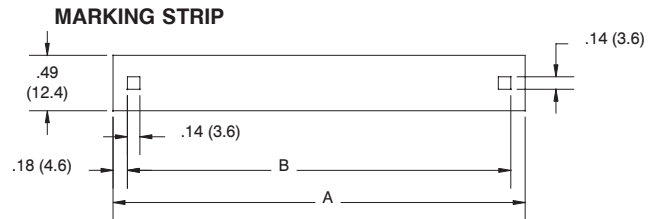
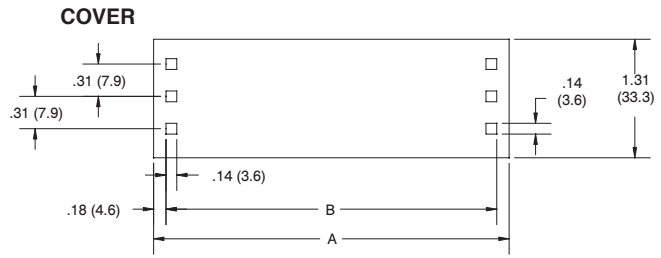
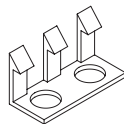

Print Styles

01A	1 2 3 4 5 6 7	01C	1 2 3 4 5 6 7
01B	7 6 5 4 3 2 1	01D	7 6 5 4 3 2 1
07A	7 6 5 4 3 2 1 1 2 3 4 5 6 7	07C	1 2 3 4 5 6 7 1 2 3 4 5 6 7
07B	1 2 3 4 5 6 7 7 6 5 4 3 2 1	07D	7 6 5 4 3 2 1 7 6 5 4 3 2 1

Ordering Codes

COVER	SERIES	NO. OF TERMINALS	PRINT STYLE
CW	2	05*	01A
CB (Black) CW (White) CC (Clear)	1/2/3 or 621		
MARKING STRIP	SERIES	NO. OF TERMINALS	PRINT STYLE
SW	2	05*	01A
SW (White)	1/2/3 or 621		Print styles 07A/B/C/D not available

Terminal Block Accessories

Double Row - Sub Mounted Marking Strips

Specifications:

- Black XP Phenolic Material, 0.03" thick
- Printed on Top or Bottom Position with Letters or Numbers for Circuit Identification
- Printing Character Size is 1/8 Inch

# of Terminals	Series 1 100/670A GP, 600 GP, 600A GP, 670A RZ	Series 2 200/671 GP, 601 GP, 621 RZ, 671 RZ	Series 3 300/672 GP 602 GP, 672 RZ
1	1.031	1.188	1.531
2	1.406	1.625	2.094
3	1.781	2.063	2.656
4	2.156	2.500	3.219
5	2.531	2.938	3.781
6	2.906	3.375	4.344
7	3.281	3.813	4.906
8	3.656	4.250	5.469
9	4.031	4.688	6.031
10	4.406	5.125	6.594
11	4.781	5.563	7.156
12	5.156	6.000	7.719
13	5.531	6.438	8.281
14	5.906	6.875	8.844
15	6.281	7.313	9.406
16	6.656	7.750	9.969
17	7.031	8.188	10.531
18	7.406	8.625	11.094
19	7.781	9.063	11.656
20	8.156	9.500	12.219
21	8.531	9.938	12.781
22	8.906	10.375	13.344
23	9.281	10.813	13.906
24	9.656	11.250	14.469
25	10.031	11.688	--
26	10.406	12.125	--
27	10.781	12.563	--
28	11.156	13.000	--
29	11.531	13.438	--
30	11.906	13.875	--
31	12.281	--	--
32	12.656	--	--
33	13.031	--	--
34	13.406	--	--
35	13.781	--	--
36	14.156	--	--

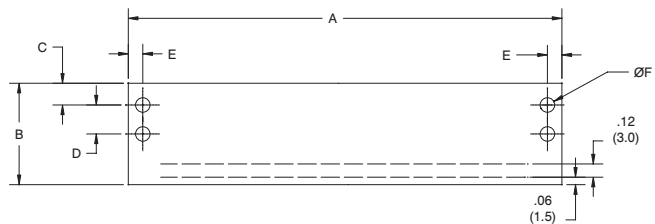

SERIES	B	C	D	E	F
100	1.12	.28	.31	.14	.16
200	1.37	.34	.42	.16	.18
300	1.56	.40	.50	.20	.20
621	1.88	.51	.42	.16	.18

Print Styles

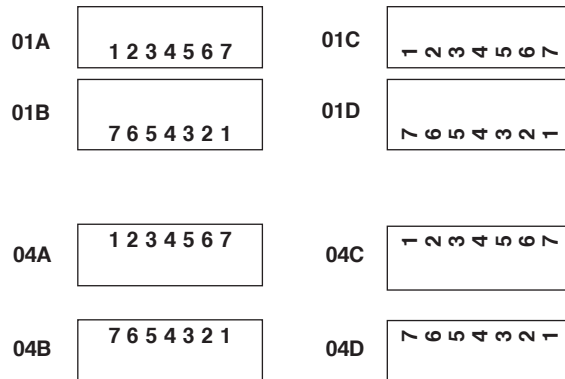

Ordering Code

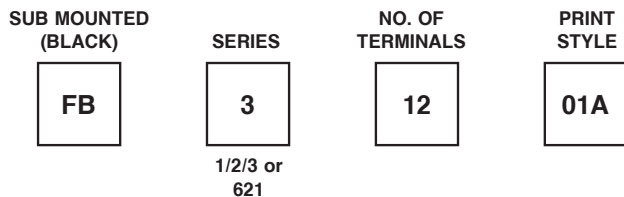

Marking and Insulator Strips

Kulka® marking strips serve as insulation between terminal blocks and chassis, as well as providing a marking surface for terminal identification. When specified, they can be printed to show terminal designations by numbers, letters, symbols or any combination thereof. Insulator strips offer the same properties, but do not provide space for terminal identification. Both marking and insulator strips can be supplied pre-mounted on the back of each block thereby simplifying assembly and inventory control.

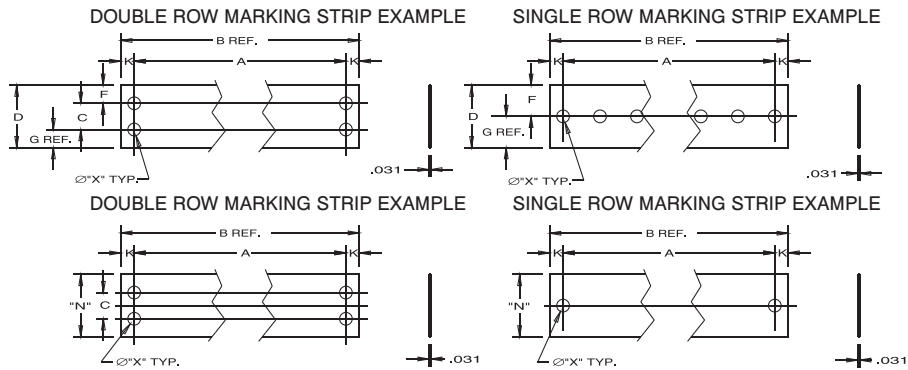

Drawing and Dimensions:

Marking and insulator strips are available for Kulka® Terminal Blocks. These include double and single row/single row insulated turret. Dimensions for insulator strips do not allow a marking surface.

Order Information:

FEED-THRU STYLE: For feed-thru terminal blocks, see styles 2, 3, 5, 6, 8, & 9 on page 114. Insert applicable feed-thru style designation in ordering code, i.e. Y, YSY, XY, 1904, 1921, 2000, 2004, 2020, 2021, 2104, 2120, 3000.

AVAILABILITY: Marking and insulator strips are available to fit most Kulka® Terminal Blocks. See SERIES reference numbers on pages 113-114 for a complete listing. If not listed, consult Customer Service for availability. Designate appropriate prefix (MS for marking strips or IS for insulator strip) in front of the SERIES number when ordering. Available materials: XP (general purpose laminate), XXXPFR (flame retardant), GME (glass cloth melamine), GEE (glass cloth epoxy).

Printing:

- Marking strips are available in many printing styles. The maximum number of characters per station is two (2).
 - Please specify printing style.
 - If unprinted marking strips are desired, insert the letter "X" in the printing style space of the ordering code.
 - Printing is the standard method of marking.
 - Printing color is silver (white) on dark surfaces and black on light surfaces.
- PROTECTIVE COATING:** Marking and insulator strips can be supplied with a fungus proof varnish (MIL-V-173A) cover coating. State on order: "coat after printing with MIL-V-173A varnish."

*See block dimension for overall length and mounting

Ordering Code:

Contact Customer Service for Availability of Materials

MS/IS	SERIES	MAT. CODE	FEED THRU (IF APPLICABLE)	NO. OF TERM	PRINT STYLE
MS	601	XP	Y	16	06A
MS (marking strip)	410, 411, 599 (799),	XP			
IS (insulator strip)	600 (800), 601 (801),	XXXPFR			
	602 (802), 603, 604,	GME			
	605, 621, 670, 671, 672	GEE			

Terminal Block Accessories

Marking Strip Dimensions - Single Row

Series	Style	Dimensions						
		D	F	G	K	W	X	N*
411	1, 2, 4	0.56	0.19	0.37	0.13	0.06	0.13	0.41
	5, 7, 8	0.88	0.44	--				
599 (799)	1, 2, 4	0.81	0.28	0.53	0.14	0.13	0.16	0.56
	5, 7, 8	1.13	0.56	--				
699 (899)	1, 2, 4	0.88	0.34	0.54	0.16	0.13	0.18	0.50
	5, 7, 8	1.13	0.56	--				
812 (912)	1, 2, 4	0.94	0.38	0.56	0.20	0.06	0.21	0.75
	5, 7, 8	1.31	0.66	--		0.13		

*N dimension to replace D dimension for insulator strips

mm = dim X 25.4

**Consult Customer Service on marking strips that are for terminal blocks with Z lugs.

For overall lengths, reference appropriate terminal block series A & B dimensions

STYLES 1 & 2

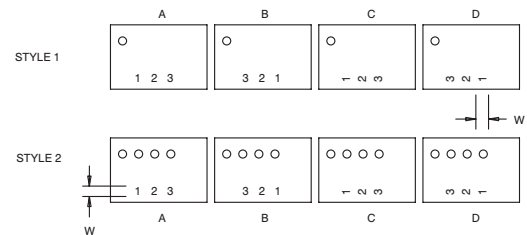
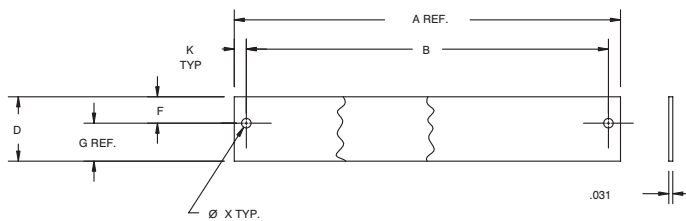

STYLES 4 & 5

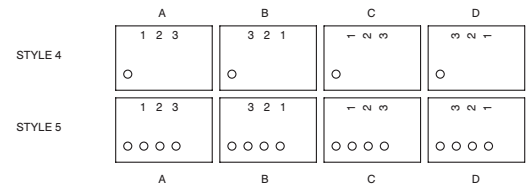
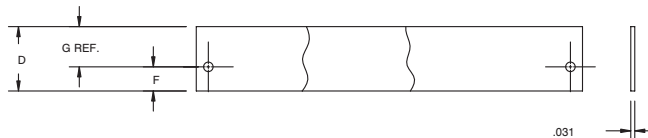

STYLES 7 & 8

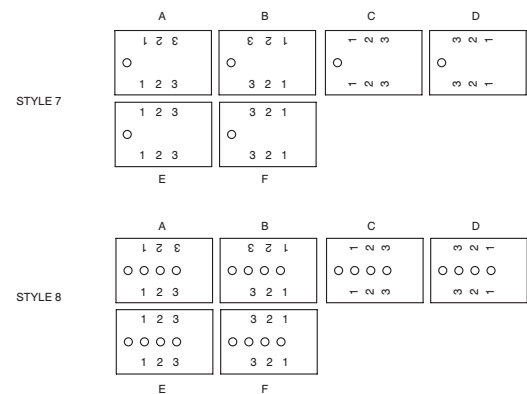
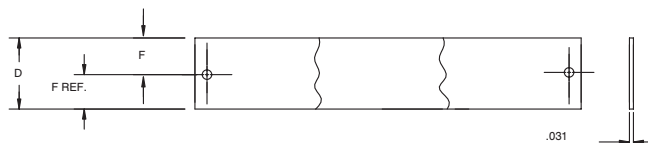

Terminal Block Accessories

Marking Strip Dimensions - Double Row

Series	Style	Dimensions							
		C	D	F	G	K	W	X	N*
410	1-6	0.25	0.75	0.19	0.31	0.12	0.06	0.13	0.41
	7, 8, 9		1.13	0.44	--				
600 (800)	1-6	0.31	1.13	0.28	0.53	0.14	0.13	0.16	0.69
	7, 8, 9		1.38	0.53	--				
601 (801)	1-6	0.42	1.31	0.34	0.55	0.16	0.13	1.75	0.88
	7, 8, 9		1.50	0.55	--				
602 (802)	1-6	0.50	1.50	0.41	0.59	0.20	0.13	0.21	1.06
	7, 8, 9		1.75	0.63	--				
603	1-6	0.63	1.88	0.59	0.66	0.22	0.13	0.23	1.31
	7, 8, 9		2.13	0.75	--				
604	1, 4	0.75	2.13	0.63	0.75	0.27	0.13	0.23	1.50
	7		2.50	0.88	--				
605	1, 4	0.88	2.69	0.81	1.00	0.31	0.13	0.27	1.81
	7		2.81	0.97	--				
670	1-6	0.31	1.19	0.28	0.60	0.14	0.13	0.16	0.88
	7, 8, 9		1.50	0.59	--				
671	1-6	0.42	1.50	0.34	0.73	0.16	0.13	0.18	1.13
	7, 8, 9		1.75	0.67	--				
672	1-6	0.50	1.63	0.41	0.72	0.20	0.13	0.21	1.31
	7, 8, 9		1.94	0.72	--				

*N dimension to replace D dimension for insulator strips
 **Consult Customer Service on marking strips that are for terminal blocks with Z lugs.

For overall lengths, reference appropriate terminal block series A & B dimensions

mm = dim X 25.4

STYLES 1, 2 AND 3

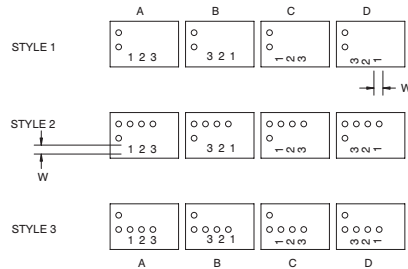
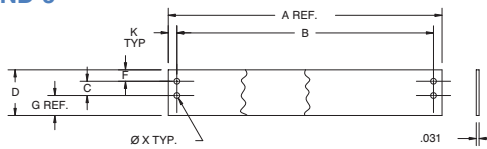

STYLES 4, 5 AND 6

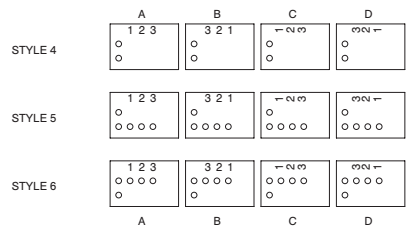
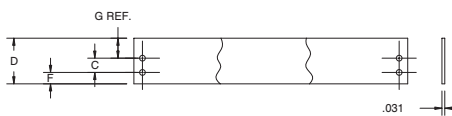

STYLE 7

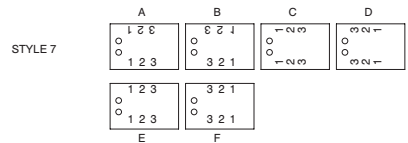
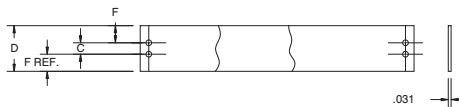

STYLES 8 AND 9

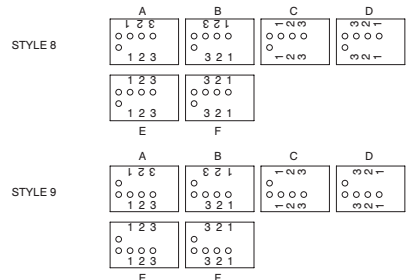
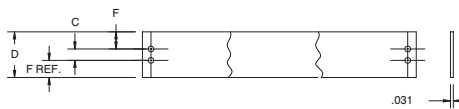

Terminal Block Accessories

Terminal Block Printing

Numeric Print Styles

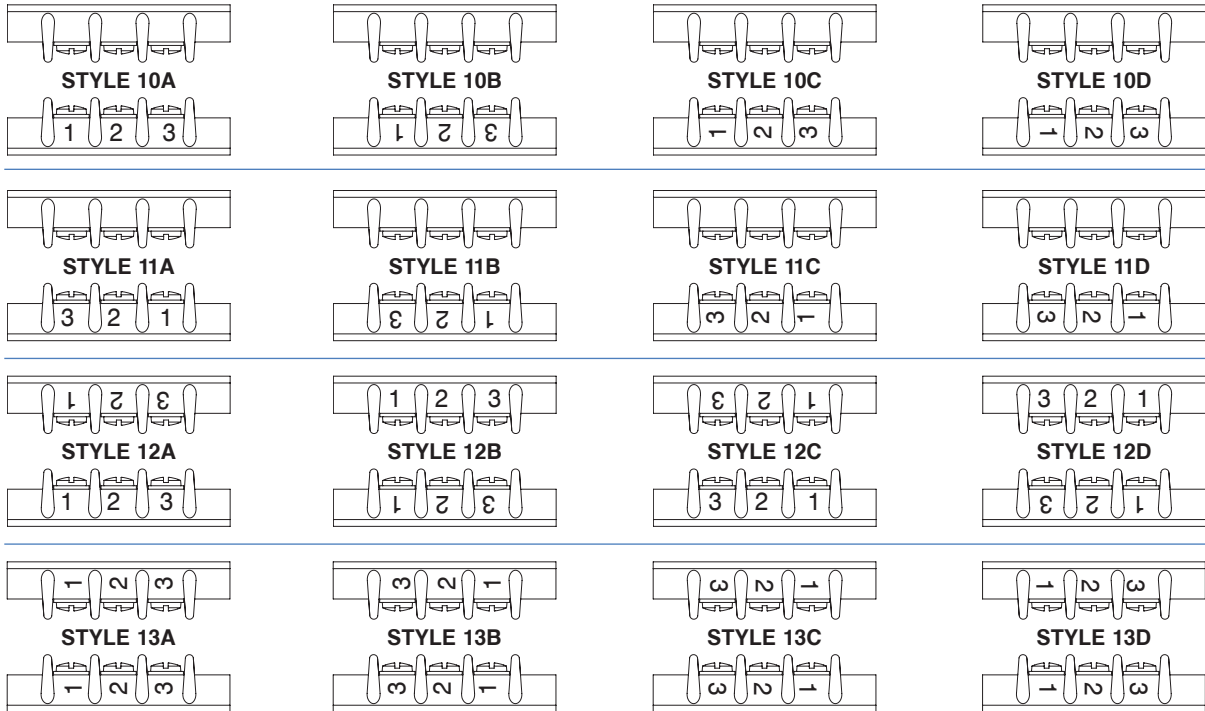

Alpha Print Styles

