

Product Data Sheet



133X596 CH

Replace "X" with 1, 2 or 3 for number of poles

Distribution Power Block
510 Amps, 600 Volts (AC/DC)
1,000V AC/DC CE (IEC 60947-7-1)



Wire Range:

Line side: (2) 250kcmil – 1/0
 Load Side: (12) #4 - #14 AWG

See tables below for SCCR wire ranges, flexible stranded and multiple wire approvals.

Electrical Ratings:

- 510A copper wire, 410A aluminum wire (Based on NEC Table 310-16, 75°C columns)
- CE Rated Voltage (U_i): 1,000 V AC/DC per IEC 60947-7-1
- Material Group: IIIa
- Pollution Degree: 3
- 600 Volts AC/DC (UL 1059 Class C, User Group - General Industrial)
- Factory and Field Wiring

Short Circuit Current Ratings (Copper wire only):

| Wire Class | Suitable Conductors (kcmil/AWG) | | Overcurrent Protection Fuse Required Class/Max Amp Rating | | | | | | SCCR, RMS SYM Amps |
|------------|---------------------------------|--------|---|-----|-----|-----|----|----|--------------------|
| | | | J | T | RK1 | RK5 | G | CC | |
| B,C | 250 - 1/0 | 4 - 14 | 600 | 600 | 600 | 200 | 60 | 30 | 100,000 |
| G,H,I,K | 3/0 - 1/0 | 6 - 14 | 150 | 150 | 100 | 30 | 60 | 30 | 100,000 |

Mechanical Ratings:

- Insulator base and cover temperature: -40°C/F to 125°C (257°F) UL RTI
- Flammability rating of insulator base and cover: UL 94 V-0
- * Use outside these ratings needs to be judged in the end-use application.

Materials:

- Connector: High conductivity aluminum, tin plated
- Insulator base: Glass filled polycarbonate (thermoplastic)
- Terminal set screws: Steel, nickel plated and Aluminum, tin plated
- Connector mounting screws: Steel, zinc plated
- Hinged Cover: Glass filled polycarbonate (thermoplastic)

Agency Approvals:

- UL Recognized, UL 1059 Terminal Block Standard, File No. XCFR2.E62806
- CSA Certified, CSA C22.2 No. 158, File No. LR19766 (Wire Classes B & C only)
- CE compliant to IEC 60947-7-1
- RoHS Compliant

Wire Approvals:

Line Side Wire Approvals:

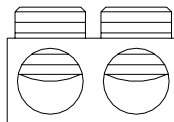

| Wire Size | Torque | | Copper Wire Stranding Classes - Number of Conductors | | | | | | |
|-----------|--------|---------|--|---------|---------|---------|---------|---------|---------|
| | N-m | In. lbs | Solid | Class B | Class C | Class G | Class H | Class I | Class K |
| 250 kcmil | 31.1 | 275 | | 37 | 61 | | | | |
| 4/0 | 31.1 | 275 | | 19 | 37 | 1 | 1 | | |
| 3/0 | 31.1 | 275 | | 19 | 37 | 1 | 1 | 1 | 1 |
| 2/0 | 31.1 | 275 | | 19 | 37 | 1 | 1 | 1 | 1 |

Aluminum stranded wire range: 250kcmil – 1/0

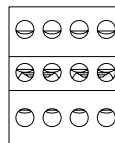

Load Side Wire Approvals:

| Wire Size | Torque | | Copper Wire Stranding Classes - Number of Conductors | | | | | | |
|-----------|--------|---------|--|---------|---------|---------|---------|---------|---------|
| | N-m | In. lbs | Solid | Class B | Class C | Class G | Class H | Class I | Class K |
| 4 AWG | 4.0 | 35 | | 1 | 1 | | | | |
| 6 | 4.0 | 35 | | 1 | 1 | 1 | 1 | 1 | 1 |
| 8 | 4.0 | 35 | | 1 | 1 | 1 | 1 | 1 | 1 |
| 10 | 4.0 | 35 | 1 | 1 - 2 | 1 - 2 | | | 1 - 2 | 1 - 2 |
| 12 | 4.0 | 35 | 1 | 1 - 4 | 1 - 4 | | | 1 - 2 | 1 - 2 |
| 14 | 4.0 | 35 | 1 | 1 - 4 | 1 - 4 | | | 1 - 2 | 1 - 2 |

* Multiple conductor approvals for **LOAD** side only. (copper wire only)

Aluminum stranded wire ranges: #4 – #14 AWG

For information on copper stranded wire classes, please reference:
<http://www.marathonsp.com/CatalogPDFs/Flexible-Stranded-Wire.pdf>

- Wire strip length, line side tap – 1 9/16"
- Wire strip length, load side tap, top row – 1/2", middle row – 11/16", bottom row - 15/16"
- Hex keys required: line side - 5/16", load side - 1/8"

Mounting:

- Panel mountable: #10 fastener, torque to 25-30 in. lbs.

For information on copper stranded wire classes, please reference:
<http://www.marathonsp.com/CatalogPDFs/Flexible-Stranded-Wire.pdf>

Accessories:

- Marker Strips. Printing available. Consult factory.

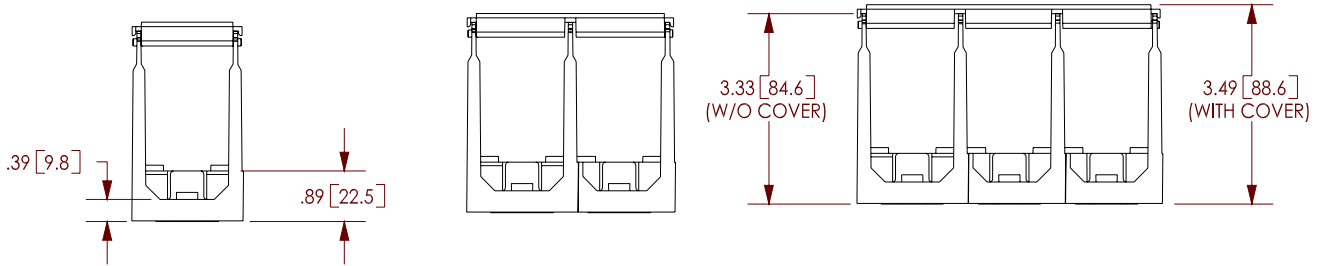
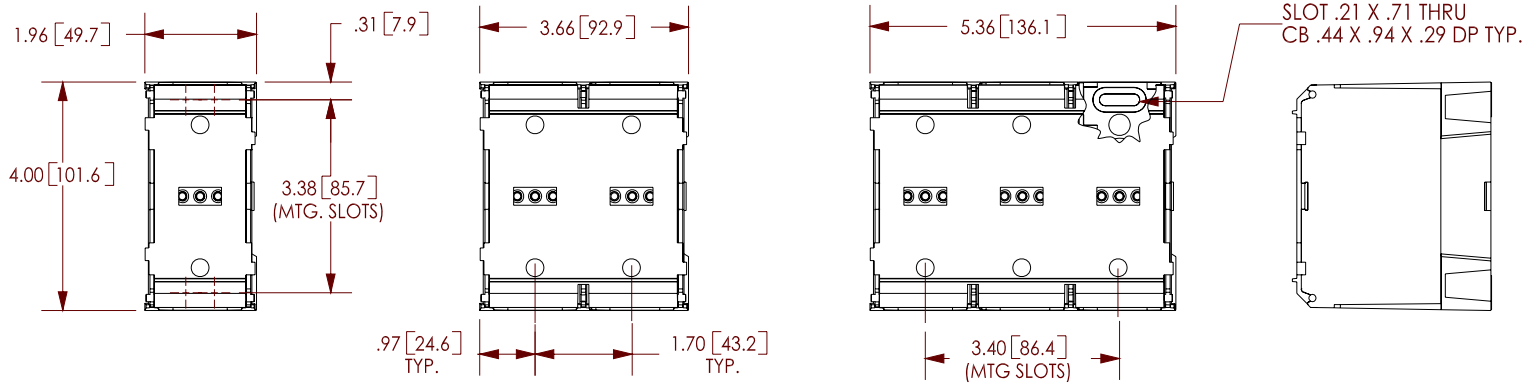

1 Pole

2 Pole

3 Pole

WWW.MARATHONSP.COM
1-419-352-8441