

Heavy Duty Terminal Blocks

1600 Series

600 Volts

Specifications:

- Base, General Purpose Phenolic, 150° C
- Connector, Brass, Nickel Plated
- Screws, Brass, Nickel Plated, 10-32
- Rated 30 Amps with unprepared wire, #10-16 AWG Copper
- Rated 75 Amps with properly terminated wire
- 21/32" Line To Line Spacing
- UL Recognized File No. #E62806
- CSA Certified File No. LR19766
- CE



Catalog #:	# of Poles	Catalog #:	# of Poles
1604 STD	4	1604 ST	4
1606 STD	6	1606 ST	6
1608 STD	8	1608 ST	8
1612 STD	12	1612 ST	12
1604 DJ	4	1604 SC	4
1606 DJ	6	1606 SC	6
1608 DJ	8	1608 SC	8
1612 DJ	12	1612 SC	12
1604 DJSV	4	1604 H	4
1606 DJSV	6	1606 H	6
1608 DJSV	8	1608 H	8
1612 DJSV	12	1612 H	12

1600 STD

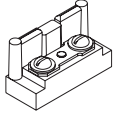

Standard Connector

1600 DJ

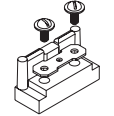

Removable Connector With Brass Insert

1600 DJSV

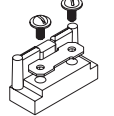

Removable Connector With Brass Insert Removable Cover

1600 ST*

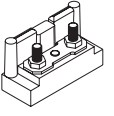

10-32 Stud Removable Connector

1600 SC

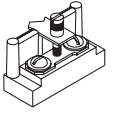

Short Circuiting Bar With Brass Insert 4 Shorting Pins Per Block

1600 H

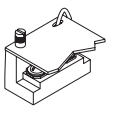

Standard Connector With Hinge Cover

* STRC: 10-32 Stud with Riveted Connector
MCJ-Jumper Available

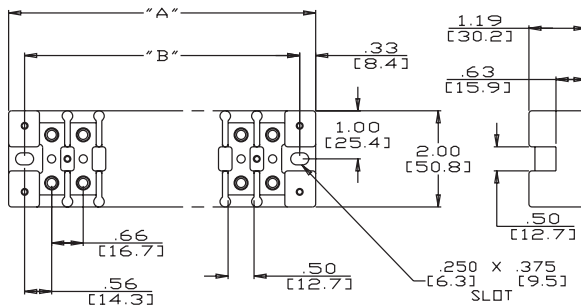

Catalog #:	# of Poles	A	B
1604	4	3.75	3.09
1606	6	5.06	4.41
1608	8	6.38	5.72
1612	12	9.00	8.34

MM = Dim X 25.4