

GSD

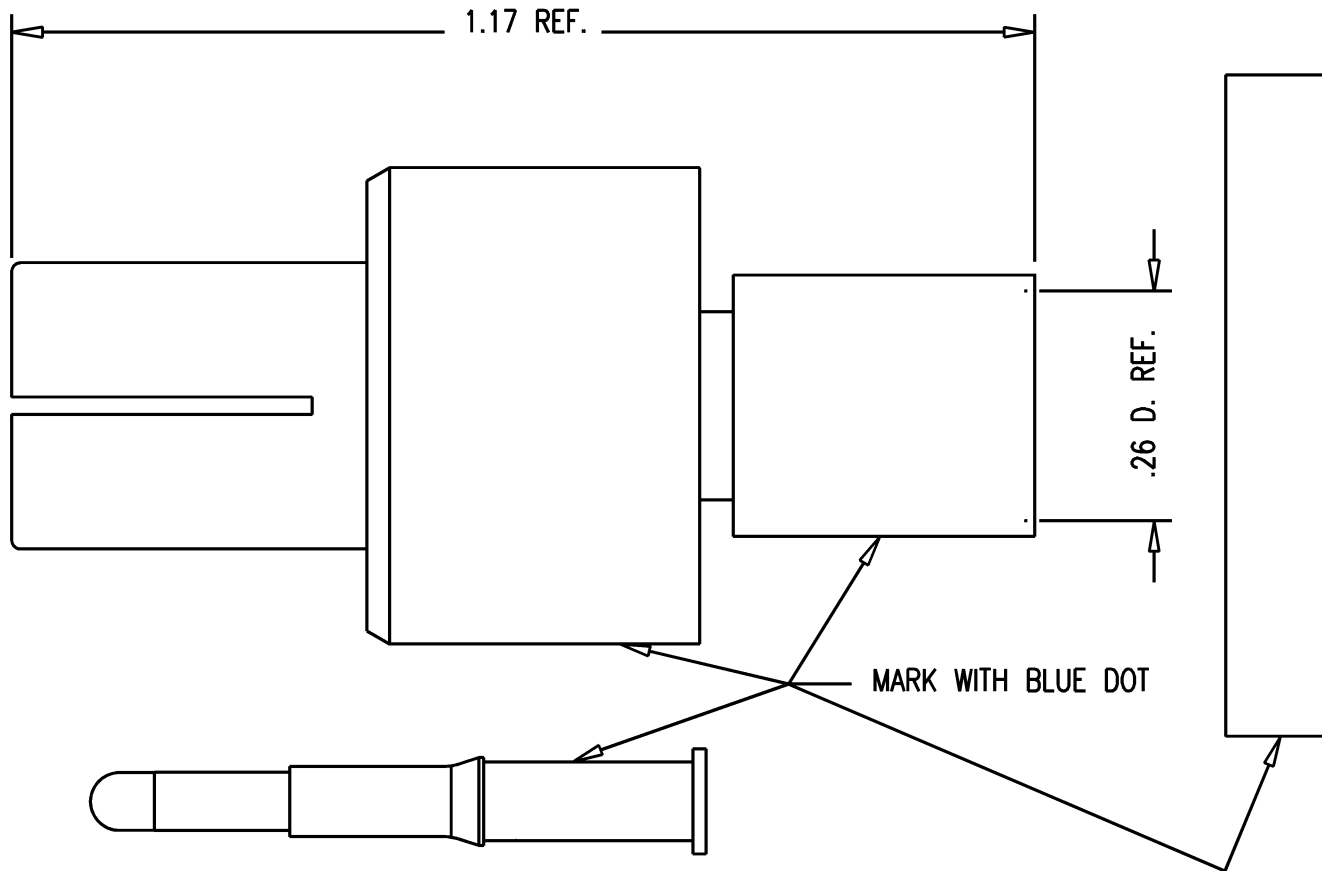

NOTES:

1. FOR CRIMPLING USE DIE KTH-2002.
2. MATERIALS:
 INSULATOR: TEFLON, ASTM-D-4894
 K-GRIP SLEEVE: COMMERCIAL BRONZE, ASTM-B-135
 OUTER CONTACT: PHOS. BRONZE, QQ-B-750.
 GASKET: SILICONE RUBBER, ZZ-R-765
 ALL OTHER METAL PARTS: BRASS, ASTM-B16

3. FINISHES:

CENTER CONTACTS: GOLD PLATE PER MIL-C-45204
 ALL OTHER METAL PARTS: SILVER PLATE PER QQ-S-365

GSD

7708-2

REVISIONS	
ISSUE	CHANGES
0	ER 35416 KH 04/06/95
1	CN 37915 C GEH 10/06/99
2	CN 38321 E HVN 06/04/01

SCALE 4:1

APPROX SURFACE AREA

USED ON

REF:

RETRO-FIT ASSY

DRAWN KH	DATE 04/06/95
DESIGN DW	DATE 04/07/95
APPR.	DATE

KINGS

ELECTRONICS CO., INC.
 ROCK HILL, SOUTH CAROLINA 29730

7708-2

MAY 2007 THIS DRAWING BECAME THE PROPERTY OF PROPERTY OF WINCHESTER ELECTRONICS CORPORATION. ALL RIGHTS RESERVED.