

SD

2025-79-9

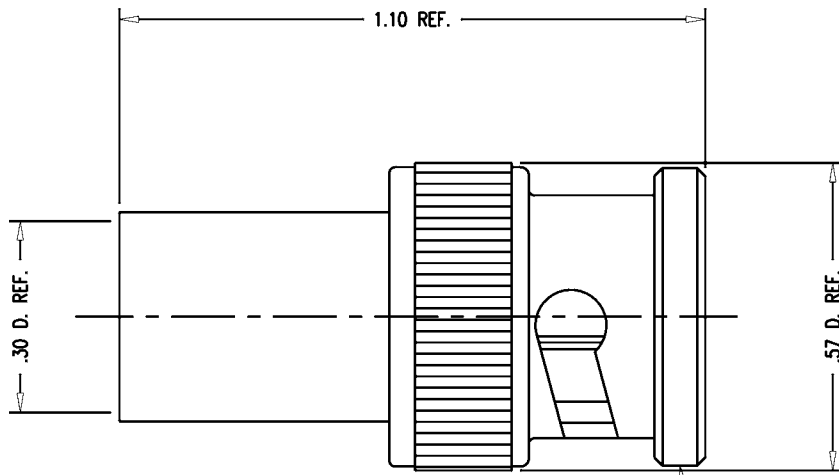

STAMP: KINGS 2025-79-9

NOTES:

1. FOR USE WITH BELDEN 1694A & GEPCO VSD2001 CABLE.
2. FOR CABLING INSTRUCTIONS SEE CP-424.
3. FOR CABLE TRIMMING USE KTJ-43 & KTD-30.
4. FOR CRIMPING USE DIE KTH-2010.
5. INTERFACE PER MIL-STD-348, FIG. 301-1 (AS APPLICABLE).
6. MATERIALS:
  - INSULATOR-TEFLON, ASTM-D-4894
  - GASKET-SILICONE RUBBER, ZZ-R-765
  - K-GRIP SLEEVE-COMMERCIAL BRONZE, ALLOY 220
  - OUTER CONTACT } BER. COP., ASTM-B-196
  - SPRING WASHER }
  - ALL OTHER METAL PARTS-BRASS, ASTM-B16
7. FINISHES:
  - CENTER CONTACT: HARD GOLD PLATE PER MIL-G-45204
  - SPRING WASHER-SILVER PLATE PER QQ-S-365
  - ALL OTHER METAL PARTS-KINGS TARNISH RESISTANT NICKEL FINISH (TR-5)
8. ELECTRICAL CHARACTERISTICS:
  - NOMINAL IMPEDANCE-75 OHMS
  - WORKING VOLTAGE-500 VRMS
  - FREQUENCY RANGE-DC TO 2 GHZ

REVISIONS

ISSUE	CHANGES
0	ER 35355 KH 02/23/94
1	CN 35706 A MJB 07/20/94
2	CN 35730 E KVH 08/19/94
3	CN 36121 B ME 02/28/95
4	CN 36972 E MJB 05/16/96
5	CN 37010 C JJS 06/18/96
6	CN 37136 E KH 09/19/96
7	CN 37553 C MRM 02/25/98

2025799C

SCALE 4:1

APPROX SURFACE AREA

USED ON

REF:

PLUG, 75 BNC

DRAWN	KH	DATE	02/23/94
-------	----	------	----------

DESIGN	CT	DATE	02/24/94
--------	----	------	----------

APPR.	DATE
-------	------

**KINGS**  
ELECTRONICS CO., INC.  
TUCKAHOE, NEW YORK 10707

2025-79-9

SD