

DASH NO.	M CODE	MADE FROM
----------	--------	-----------

GSD

2025-59-9

REVISIONS

ISSUE	CHANGES
0	ER 32856 JCA 02/15/91
1	CN 36876 D MJB 03/22/96
2	CN 37188 E PG 11/05/96

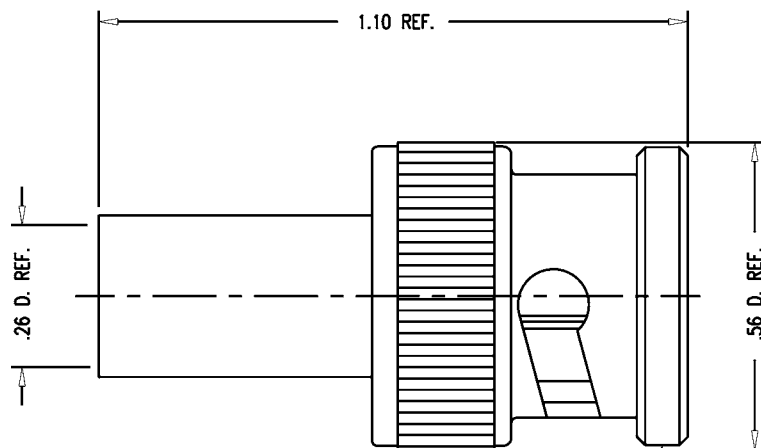

STAMP: KINGS 2025-59-9

NOTES:

- FOR USE WITH RG-59, 210/U & BELDEN 8241 CABLE.
- FOR CABLING INSTRUCTIONS SEE CP-401.
- FOR CRIMPING USE DIE KTH-2002.
- INTERFACE PER KINGS ES-17, FIG. 6.
- CENTER CONTACT TO BE SUPPLIED UNASSEMBLED.
- MATERIALS:
INSULATOR: TEFLON, ASTM-D-1457
GASKET: SIL. RUB., ZZ-R-765
OUTER CONTACT: BER. COP., ASTM-B-196
ALL OTHER PARTS: BRASS, QQ-B-626
- FINISHES:
SPRING WASHER: SILVER PLT. PER QQ-S-365
CENTER CONTACT: HARD GOLD PLT. PER MIL-G-45204
ALL OTHER METAL PARTS: KINGS TARNISH RESISTANT FINISH (TR-5)
- ELECTRICAL CHARACTERISTICS:
NOMINAL IMPEDANCE: 75 OHMS
VOLTAGE RATING: 500 VRMS
FREQUENCY RANGE: DC TO 2 GHz

JCA1372

SCALE 4:1

APPROX SURFACE AREA

USED ON

REF:

PLUG, 75 BNC

DRAWN JCA DATE 02/15/91

DESIGN GA DATE 02/20/91

APPR. DATE

KINGS
ELECTRONICS CO., INC.
TUCKAHOE, NEW YORK 10707

GSD

2025-59-9