



# GUARDIAN Electric Manufacturing

ISO 9001 / AS9100 Certified Company

Woodstock, IL 60098 Ph. (815)334-3600 Fax (815)337-0377

Or visit us at our website [www.guardian-electric.com](http://www.guardian-electric.com)

## Model 42 DC Frame Solenoid

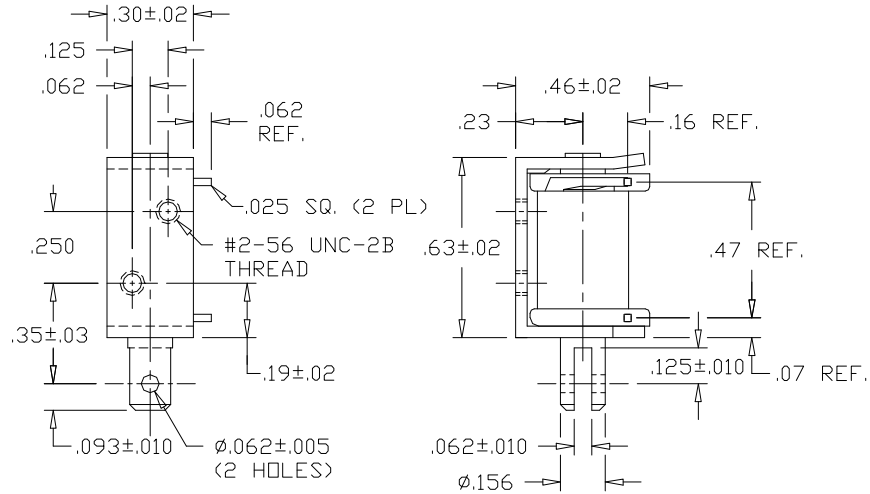

Solenoid shown energized and fully seated.

Total Weight: .25 oz.

Plunger Weight: .02 oz.

Model No.	Part No.	Duty Cycle	Voltage	Resistance (Ω)	Power (W)	Current (mA)
42-I-12D	A420-066613-00	Intermittent	12VDC	83.7	1.8	143
42-C-12D	A420-066612-00	Continuous	12VDC	106	1.4	113
42-I-24D	A420-066615-00	Intermittent	24VDC	297	2	81
42-C-24D	A420-066614-00	Continuous	24VDC	412	1.5	58

When ordering, please refer to Part No., as listed above.

Consult factory for custom configurations.

Stroke (in.)	Pull Force (oz.)								Holding Force (oz.)
	0.050	0.125	0.250	0.375	0.500	0.625	0.750	1.000	
Continuous Duty	0.4	n/a	n/a	n/a	n/a	n/a	n/a	n/a	4
Intermittent Duty	0.6	n/a	n/a	n/a	n/a	n/a	n/a	n/a	3.5

### UL Recognition

Recognized under the  Component Recognition Program of **Underwriters Laboratories, Inc.**

### Continuous Duty

100% 'On' Time

### Intermittent Duty

25% 'On' Time, (100 Seconds 'On' Max. Followed By 300 Seconds 'Off' Min.)

### RoHS

These parts comply with **RoHS** Directive 2002/95/EC