

PART NUMBER SEE SHEET 2

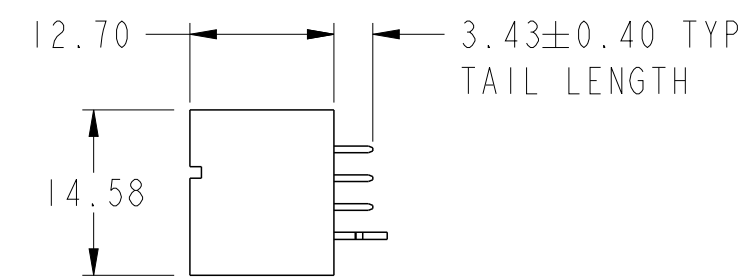
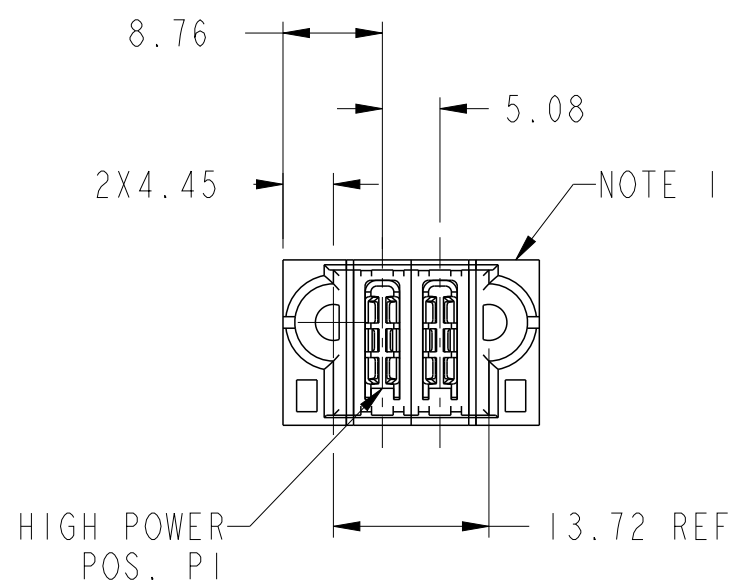
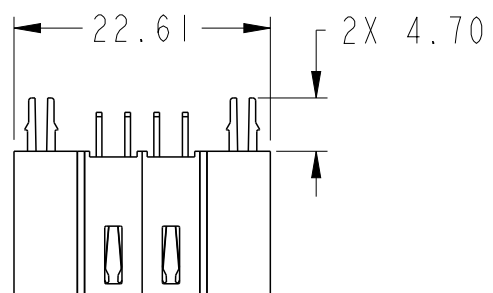
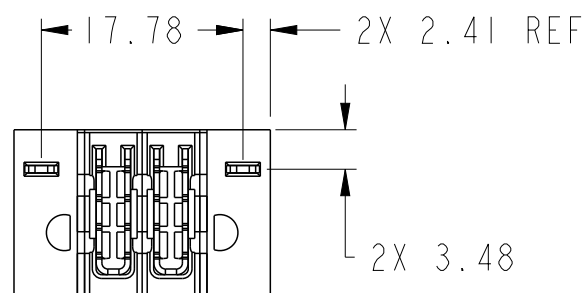

spec ref		dr	Rainbow Zhan	2016/12/08	projection	MM	size	A3	scale	3:2		
tolerance std		eng	Sunny2 Liu	2016/12/23			ecn no		-			
ISO 406 ISO 1101		chr	Fancy Zhang	2016/12/23			rel level		Released			
TOLERANCES UNLESS OTHERWISE SPECIFIED		appr	Pei-Ming Zheng	2016/12/23	product family		PwrBlade+					
surface	linear	0.X		±0.5	Amphenol FCI		2HDP VERTICAL PLUG STB		dwg no 10106136-2000002		rev A	
		0.XX		±0.25								
ISO 1302		angular	0°		cat. no.		Product - Customer Drw		sheet 1 of 3			
			±2°									

Amphenol FCI

© 2016 AFCI

PRODUCT NO.

10106136-2000002LF

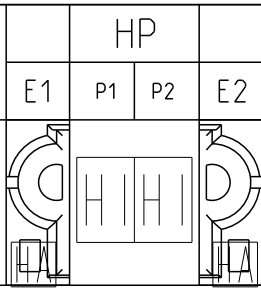

CODE	DESCRIPTION
HI	STD HIGH POWER CONTACT
HA	METAL HOLD DOWN

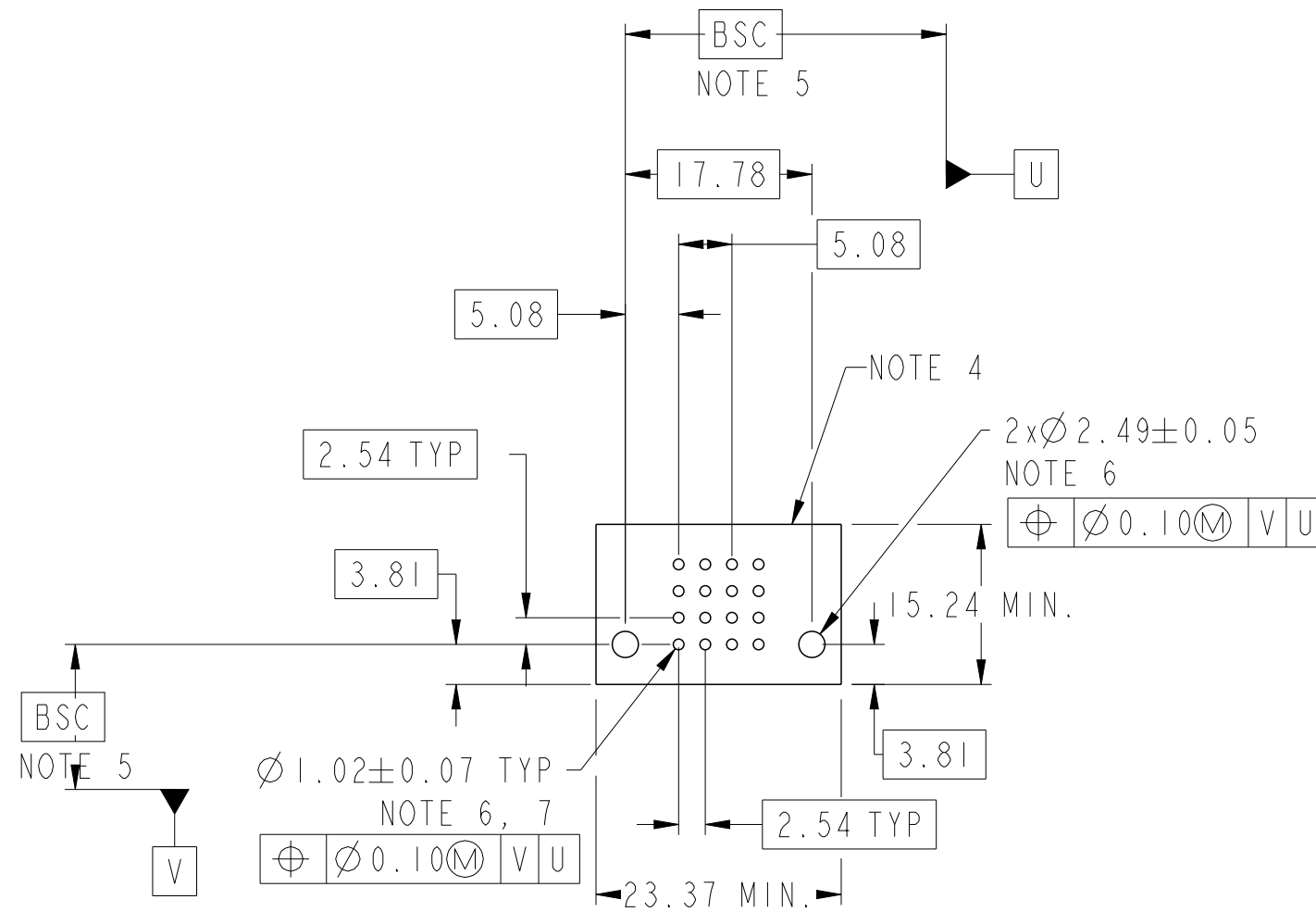

Amphenol
FCi

© 2016 AFCI

spec ref	dr	2016/12/08	projection	MM	size	A3	scale	3:2
tolerance std	eng	2016/12/23			ecn no	-	rel level	Released
ISO 406 ISO 1101	chr	2016/12/23						
surface	linear	0.X	±0.5		dwg no	10106136-2000002	rev	A
		0.XX	±0.25					
ISO 1302	angular	0°	±2°	cat. no.	Product - Customer Drw		sheet 2 of 3	

A

B

C

D

A

B

C

D

NOTES:

- 1) PRODUCT MARK:
PART NUMBER AND DATE CODE TO BE MARKED ON THIS SURFACE .
THE MARK CAN BE OMITTED IF THERE IS NOT ENOUGH SPACE ON THIS SURFACE.
- 2) MATERIALS:
-HOUSING : HIGH TEMP THERMOPLASTIC WITH GLASS FIBER, UL94V-0, BLACK.
-POWER CONTACT : HIGH CONDUCTIVITY COPPER ALLOY.
-SIGNAL CONTACT : COPPER ALLOY.
- 3) PLATING SPECIFICATION : 10116351
- 4) DENOTES CONNECTOR KEEP OUT ZONE.
- 5) DATUM AND BASIC DIMENIONS ARE ESTABLISHED BY CUSTOMER.
- 6) ALL HOLE DIAMETERS ARE FINISHED HOLE SIZES.
- 7) 1.15+/-0.025MM DRILLED HOLE PLATED WITH 0.00762MM MIN SN
OVER 0.0254-0.0762MM CU PLATING TO ACHIEVE A 1.02+/-0.07MM HOLE.
- 8) THE HOUSING WILL WITHSTAND EXPOSURE TO 265 °C PEAK TEMPERATURE
FOR 10 SECONDS IN A WAVE SOLDER APPLICATION.
- 9) THIS PRODUCT MEETS EUROPEAN UNION DIRECTIVES AND OTHER COUNTRY
REGULATIONS AS DESCRIBED IN GS-47-0004.
- 10) PRODUCT SPECIFICATION : GS-12-658.
APPLICATION SPECIFICATION : GS-20-141.
PRODUCT PACKAGE SPECIFICATION: GS-14-1502.

Amphenol
FCi

© 2016 AFCI

spec ref		dr	Rainbow Zhan	2016/12/08	projection	MM	size	A3	scale	3:2
tolerance std		eng	Sunny2 Liu	2016/12/23		← →	ecn no		-	
ISO 406 ISO 1101		chr	Fancy Zhang	2016/12/23			rel level		Released	
TOLERANCES UNLESS OTHERWISE SPECIFIED		appr	Pei-Ming Zheng	2016/12/23	product family		PwrBlade+			
surface	linear	0.X	±0.5	Amphenol FCi	2HDP	dwg no	10106136-2000002		rev A	
		0.XX	±0.25							
0.XXX	±0.10									
ISO 1302	angular	0°	±2°	cat. no.	Product - Customer Drw		sheet 3 of 3			