

REMARK:

1. CHARACTERISTICS:  
 RATED VOLTAGE: 250V  
 RATED CURRENT: 5AMP  
 CONTACT RESISTANCE: 25moHms MAX. INITIAL; 4moHms MAX. AFTER.  
 INSULATION RESISTANCE: 5000Mohms MIN. at 500V DC  
 DIELECTRIC STRENGTH: 1000VRMS  
 OPERATING TEMPERATURE RANGE: -55°C ~ 105°C  
 INSERTION/EXTRACTION FORCE PER CONTACT: 5N Max. / 0.3N Min.  
 MATING/UNMATING CYCLES: 500MATING MIN.

2. MATERIAL:

INSULATORS: GLASS-FILLED THERMOPLASTIC U94H-0, COLOR IN BLACK.  
 CONTACTS: COPPER ALLOY, SELECTIVE GOLD ON CONTACT AREA,  
 100µ" Min WHITE TIN TOP OVER SOLDER AREA,  
 300µ" Min NICKEL UNDER PLATE.  
 SHELL: STEEL, 100µ" Min NICKEL TOP OVER,  
 500µ" Min COPPER UNDER PLATE.  
 CLINCH NUT: COPPER ALLOY, 100µ" Min WHITE TIN PLATED.

3. PART NUMBER DESCRIPTION: **10090098-S XX X X LF**

SERIES NO. \_\_\_\_\_  
 TYPE \_\_\_\_\_  
 S: SOCKET (FEMALE)  
 NUMBER OF CONTACTS \_\_\_\_\_  
 09: 9-PIN  
 15: 15-PIN  
 25: 25-PIN  
 37: 37-PIN  
 LF: ROHS COMPLIANT  
 X: UNC #4-40 CLINCHNUTS  
 L: M3 CLINCHNUTS  
 CONTACT FINISH  
 4: GOLD FLASH  
 6: 30µ" PLATING OPTION  
 AVAILABLE ON REQUEST

POS.	A	B	C	D	G
09	30.81	24.99	16.33	19.28	2.74
15	39.24	33.32	24.66	27.75	2.74
25	53.04	47.04	38.38	41.30	2.77
37	69.32	63.50	54.84	57.40	2.77

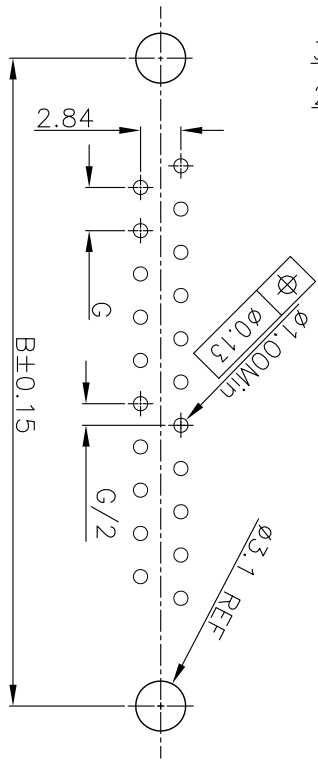

P.C.B LAYOUT  
 t: 1.6±0.1MM

mat'l. code		dr		ddate		tolerances unless otherwise specified	
ltr	ecen no	J.H	J.H	3/13/09	4/2/09	.XX ± 0.38	.XXX ± 0.10
A	T09-1033	J.H	J.H	3/13/09	4/2/09	.XX ± 0.25	.XXX ± 0.10
B	T09-1044	J.H	J.H	4/2/09		.XXX ± 0.10	.XXX ± 0.10

CUSTOMER COPY		title	
sheet	revision	product family	D-SUB
1	B	D-SUB	D-SUB
2	B	D-SUB	D-SUB

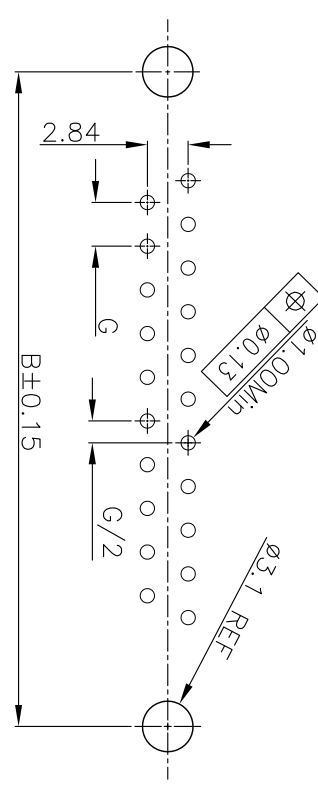
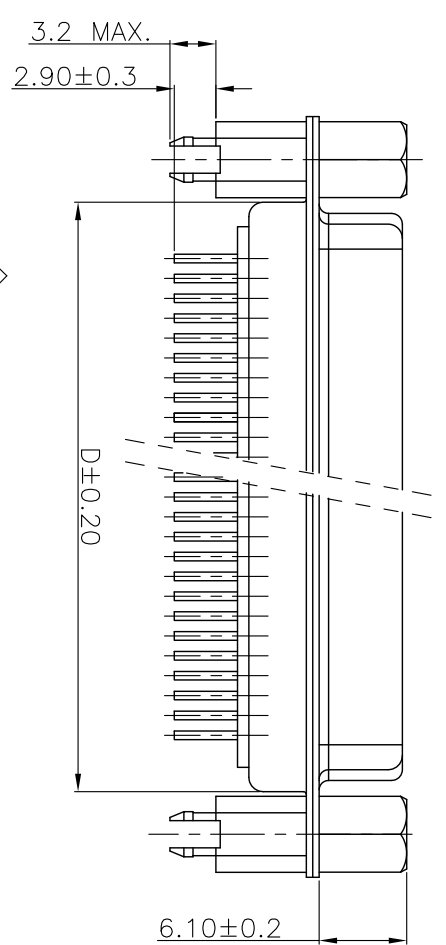
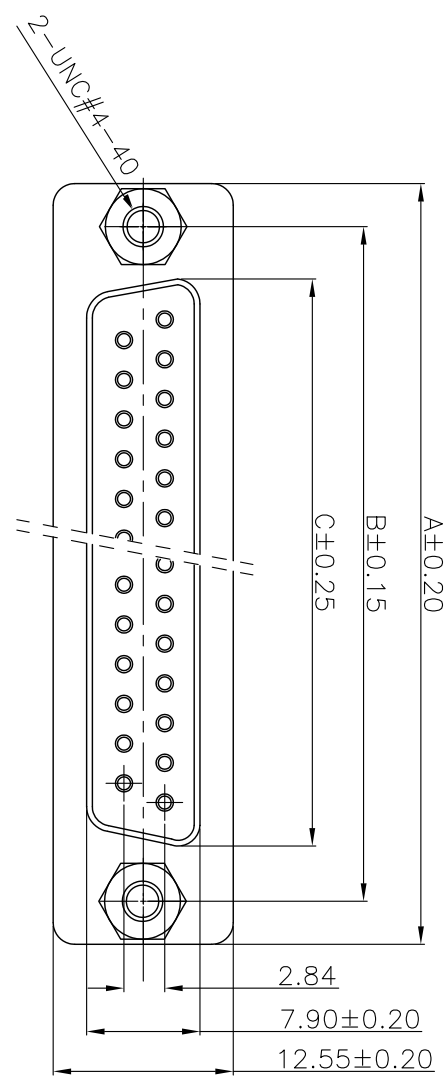

P.C.B LAYOUT  
t: 1.6±0.1MM

REMARK:  
1. CHARACTERISTICS:  
RATED VOLTAGE: 250V  
RATED CURRENT: 5AMP  
CONTACT RESISTANCE: 25mohms MAX. INITIAL; 40mohms MAX. AFTER  
INSULATION RESISTANCE: 5000kohms MIN. at 500V DC  
DIELECTRIC STRENGTH: 1000V/MS  
OPERATING TEMPERATURE RANGE: -55°C~105°C  
INSERTION/EXTRACTION FORCE PER CONTACT: 5N Max./0.3N Min.  
MATING/UNMATING CYCLES: 50MATTINGS MIN.

2. MATERIAL:  
INSULATIONS: GLASS-FILLED THERMOPLASTIC U194V-0, COLOR IN BLACK.  
CONTACTS: COPPER ALLOY, SELECTIVE GOLD ON CONTACT AREA,  
100µ" Min MATTE TIN TOP OVER SOLDER AREA,  
30µ" Min NICKEL UNDER PLATE.  
SHELL: STEEL, 100µ" Min NICKEL TOP OVER,  
50µ" Min COPPER UNDER PLATE.  
CLANCH NUT: COPPER ALLOY, 100µ" Min MATTE TIN PLATED.  
SCREW LOCK: COPPER ALLOY, 100µ" Min BRIGHT NICKEL PLATED.

3. PART NUMBER DESCRIPTION: **10090098-S XX X X LF**  
SERIES NO. \_\_\_\_\_  
TYPE \_\_\_\_\_  
S: SOCKET (FEMALE) \_\_\_\_\_  
NUMBER OF CONTACTS \_\_\_\_\_  
CONTACT FINISH \_\_\_\_\_  
LF: ROHS COMPLIANT  
PLANGE MOUNTING OPTION  
V: UNC #4-40 SERMLOCKS  
09: 9-PIN  
15: 15-PIN  
25: 25-PIN  
37: 37-PIN  
4: FLASH GOLD  
6: 30µ" PLATING OPTION AVAILABLE ON REQUEST

POS.	PART NO.	A	B	C	D	G
09	10090098-S09*VLF	30.81	24.99	16.33	19.28	2.74
15	10090098-S15*VLF	39.24	33.32	24.66	27.75	2.74
25	10090098-S25*VLF	53.04	47.04	38.38	41.30	2.77
37	10090098-S37*VLF	69.32	63.50	54.84	57.40	2.77

mat'l. code	tolerances unless otherwise specified	CUSTOMER COPY	FCI	www.fciconnect.com
ltr	.X ± 0.38	projection		
ecn no	.XX ± 0.25	MM		
dr	.XXX ± 0.10	sizeI dwg no	D-SUB	
ddate	0° ±2°	product family	D-SUB	
lineor		code	TMN	
angles		scale	1:1	
dr	JASON HSU 3/12/09	sheet	2 of 2	
enfr	GARY HSEIH 3/12/09	revision		
chr	JOSEPH HSIA 3/12/09	sheet		
appd		index		