

2: Assembly Material



2.1 Front Panel Screws M2.5

E | 2_3

2.2 Miscellaneous Screws

E | 2_5

2.3 Earthing Screws

E | 2_7

2.4 Self-Tapping Screws

E | 2_8

2.5 PT Screws

E | 2_8

2.6 Sheet Metal Screws

E | 2_8

2.7 Threaded Bolts

E | 2_8

2.8 Set Screws

E | 2_8

2: Assembly Material

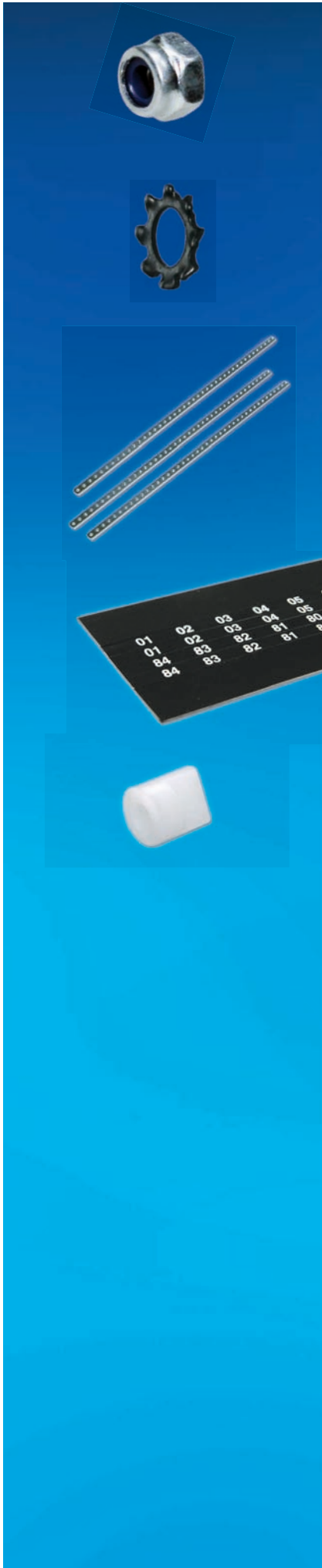

2.9 Nuts and Lock Nuts

E | 2_9

2.10 Washers

E | 2_10

2.11 Tapped Strips

E | 2_11

2.12 Label Strips

E | 2_12

2.13 Insulation

E | 2_13

E

2: Assembly Material



2.1 Front Panel Screws M2.5

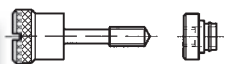

2.1.1 Milled Edge Screw Slotted, Head Ø 7, Press-Fit Bush

Description	Material	Part-No.
M2.5 x 11.3	Steel, nickel-plated	10 pcs. 63-443



2.1.2 Milled Edge Screw Slotted, Head Ø 7, Threaded Bush

Description	Material	Part-No.
M2.5 x 11.3; M2.5/M5 x 0.5	Steel/brass, nickel-plated	10 pcs. 63-130



2.1.3 Milled Edge Screw Slotted, Head Ø 7, Retainer

Description	Material	Part-No.
M2.5 x 11.3	Steel, nickel-plated / plastic	10 pcs. 63-157

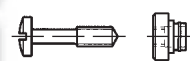

2.1.4 Round Head Screw, Head Ø 5 (Torx Ø 6), Press-Fit Bush

Description	Material	Part-No.
Slotted, M2.5 x 11.3	Steel, nickel-plated	10 pcs. 63-444
Torx, M2.5 x 11.3, size T8	Steel, nickel-plated	63K480



2.1.5 Round Head Screw Slotted, Head Ø 5, Threaded Bush

Description	Material	Part-No.
M2.5 x 11.3; M2.5/M5 x 0.5	Steel/brass, nickel-plated	10 pcs. 63-129



2.1.6 Round Head Screw, Head Ø 5 (Torx Ø 6), Retainer

Description	Material	Part-No.
Slotted M2.5 x 11.3	Steel, nickel-plated / plastic	10 pcs. 63-159
Torx, M2.5 x 11.3, size T8	Steel, nickel-plated / plastic	63K159



2.1.7 Milled Edge Screw Slotted, Head Ø 7

Description	Material	Part-No.	Part-No.
M2.5 x 11.3	Steel, nickel-plated	1 pc. 61-267	100 pcs. 1904-16
M2.5 x 11.3	Steel, nickel-plated, black	61-267-01	61-267-01-2

2: Assembly Material

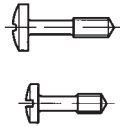

2.1.8 Round Head Screw Slotted, Head Ø 5

Description	Material	Part-No.	
		1 pc.	100 pcs.
M2.5 x 9	Steel, nickel-plated	61-252	61-252-2
M2.5 x 11.3	Steel, nickel-plated	61-256	1904-37

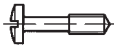

2.1.9 Round Head Screw, Head Ø 6

Description	Material	Part-No.	
		1 pc.	100 pcs.
Philips M2.5 x 12.7	Steel, nickel-plated	61-287	1904-41
Philips M2.5 x 12.7	Steel, nickel-plated, black	61-295-01	63-474
Torx M2.5 x 11.3, size T8	Steel, nickel-plated	5443-08	1904K41
Freedrive M2.5 x 11.3	Steel, nickel-plated	61-295	61-295-2
Freedrive M2.5 x 11.3	Steel, nickel-plated, black	61-294	61-295-01-2



2.1.10 Press-Fit Bush, Drilling Ø 3.7^{+0.11}

Description	Material	Part-No.	
		1 pc.	100 pcs.
M2.5 Mat. ≥ 2.5 mm	Steel, nickel-plated	61-201	63-301
M2.5 Mat. ≥ 2.5 mm	Steel, nickel-plated, black	61-207	63-471
M2.5 Mat. ≥ 1 mm	Steel, nickel-plated	61-225	61-225-2
M2.5 Mat. ≥ 1 mm	Steel, nickel-plated, black	61-223	61-223-2

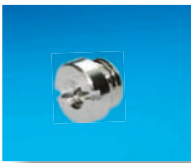

2.1.11 Threaded Bush

Description	Material	Part-No.	
		1 pc.	100 pcs.
M2.5/M5 x 0.5	Brass, nickel-plated	61-200	63-131

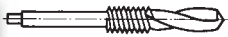

2.1.12 Combination Drill Piece for Remachining

Description	Material	Part-No.	
		1 pc.	
M5 x 0.5	Steel	61-545	



2.1.13 Screw Retainer

Description	Material	Part-No.	
		1 pc.	100 pcs.
M2.5 + M3	Plastic	61-008	63-119

2: Assembly Material



2.2 Miscellaneous Screws

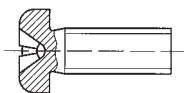

2.2.1 Philips Cylindrical Screw, ~DIN 84A

Description	Material	Part-No.	
		1 pc.	100 pcs.
M2.5 x 4	Steel, zinc-plated	5325-04	-
M2.5 x 4, Torx T8	Stainless steel	5470-07	-
M2.5 x 5, Torx T8	Stainless steel	5470-07	-
M2.5 x 6	Steel, zinc-plated	5325-06	1910-04
M2.5 x 6, Torx T8	Stainless steel	5470-04	-
M2.5 x 8	Steel, zinc-plated	5325-08	1910-05
M2.5 x 8, Torx T8	Stainless steel	5470-10	-
M2.5 x 10	Steel, zinc-plated	5325-10	1910-06
M2.5 x 10, Torx T8	Stainless steel	5470-09	-
M2.5 x 12	Steel, zinc-plated	5325-12	1910-07
M3 x 4, Torx T10	Steel, zinc-plated	5470-01	-
M3 x 6, Torx T10	Steel, zinc-plated	5470-02	-
M3 x 8	Steel, zinc-plated	5338-08	1910-16
M3 x 8, Torx T10	Steel, zinc-plated	5470-03	-
M3 x 12	Steel, zinc-plated	5330-12	1910-15
M3 x 12, Torx T10	Steel, zinc-plated	5470-05	-
M4 x 8	Steel, zinc-plated	5348-08	1910-20
M4 x 8 , Torx T10	Steel, zinc-plated	5470-06	-
M4 x 12	Steel, zinc-plated	5348-12	-

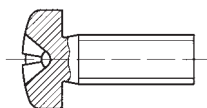

2.2.2 Philips Round Head Screw, DIN 7985A

Description	Material	Part-No.	
		1 pc.	100 pcs.
M2 x 12	Stainless steel	5304-12	63-491
M2 x 8	Stainless steel	5304-12	63-495
M3 x 4	Steel, zinc-plated	5331-04	1912-04
M3 x 6	Steel, zinc-plated	5330-06	1912-06
M3 x 8	Steel, zinc-plated	5330-08	1910-13
M3 x 10	Steel, zinc-plated	5330-10	1910-14
M4 x 6	Steel, zinc-plated	5340-06	1910-18
M4 x 8	Steel, zinc-plated	5340-08	-
M6 x 8	Steel, zinc-plated	5360-08	1910-30

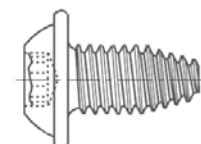

2.2.3 SHEETtracs® Screw

Description	Material	Part-No.	
		1 pc.	100 pcs.
3 x 6, Torx T10	Steel, zinc-plated	5477-01	-

2: Assembly Material

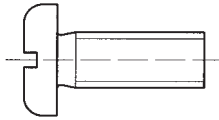

2.2.4 Slotted Pan Head Screw, DIN 85A

Description	Material	Part-No.	
		1 pc.	100 pcs.
M2.5 x 3	Steel, zinc-plated	5571-03	1901-03
M2.5 x 4	Steel, zinc-plated	5571-04	1901-04
M2.5 x 5	Steel, zinc-plated	5571-05	1901-05
M2.5 x 6	Steel, zinc-plated	5571-06	1901-06
M2.5 x 8	Steel, zinc-plated	5571-08	1901-08
M2.5 x 16	Steel, zinc-plated	5571-16	1901-16
M2.5 x 18	Steel, zinc-plated	5571-18	1901-09
M3 x 5	Steel, zinc-plated	5531-05	1901-11
M3 x 6	Steel, zinc-plated	5531-06	1901-12
M3 x 8	Steel, zinc-plated	5531-08	1901-13
M6 x 8	Steel, nickel-plated	5561-08	1901-51
M6 x 12	Steel, nickel-plated	5561-12	1901-52

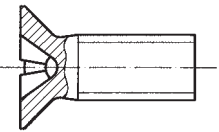

2.2.5 Philips Countersunk Screw, DIN 965A

Description	Material	Part-No.	
		1 pc.	100 pcs.
M2.5 x 4	Steel, zinc-plated	5322-04	-
M2.5 x 4, Torx T8	Stainless steel	5470-25	-
M2.5 x 6	Steel, zinc-plated	5322-06	-
M2.5 x 6, Torx T8	Stainless steel	5470-20	-
M2.5 x 8	Steel, zinc-plated	5322-08	1906-08
M2.5 x 8, Torx T8	Stainless steel	5470-21	-
M3 x 6	Steel, zinc-plated	5332-06	1906-12
M3 x 6, Torx T10	Steel, zinc-plated	5470-22	-
M3 x 8	Steel, zinc-plated	5332-08	1906-13
M3 x 8, Torx T10	Steel, zinc-plated	5470-28	-
M3 x 10	Steel, zinc-plated	5332-10	1906-14
M3 x 10, Torx T10	Steel, zinc-plated	5470-23	-
M4 x 6, Torx T20	Steel, zinc-plated	5470-27	-
M4 x 10	Steel, zinc-plated	5342-08	-
M4 x 10, Torx T20	Steel, zinc-plated	5470-26	5470-26-2
M4 x 10	Steel, zinc-plated	5342-10	1906-24

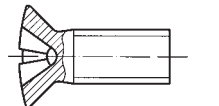

2.2.6 Philips Countersunk Round Head, Screw, DIN 966A

Description	Material	Part-No.	
		1 pc.	100 pcs.
M3 x 6	Steel, nickel-plated	5333-06	1905-12
M3 x 8	Steel, nickel-plated	5333-08	1905-13
M3 x 10	Steel, nickel-plated	5333-10	1905-14

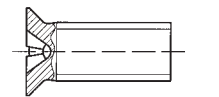

2.2.7 Philips Countersunk Screw with Small Head Ø 6

Description	Material	Part-No.	
		1 pc.	100 pcs.
M4 x 5	Steel, zinc-plated	5441-50	5441-50-2
M4 x 5	Steel, zinc-plated, black	5441-53	-
M4 x 5, Torx T10	Steel, zinc-plated	5441-58	5441-58-2
M4 x 5, Torx	Steel, zinc-plated, black	5441-59	5441-59-2
M4 x 10	Steel, zinc-plated	5441-51	63-431
M4 x 10	Steel, zinc-plated, black	5441-52	-
M4 x 10, Torx T10	Steel, zinc-plated	5441-54	5441-54-2
M4 x 10, Torx T10	Steel, zinc-plated, black	5441-57	5441-57-2

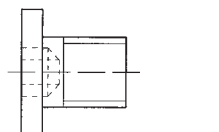

2.2.9 Cylindrical Allen Screw with Extremely Low Head

Description	Material	Part-No.	
		1 pc.	100 pcs.
M5 x 6	Steel, zinc-plated	5441-22	63-355
M6 x 10	Steel, zinc-plated	5441-24	-

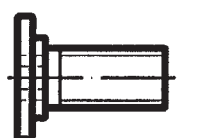

2.2.10 Special Low-Head Allen Screw with Collar

- Ø8.2 x 1.3 for 19" perforation in cabinets

Description	Material	Part-No.	
		1 pc.	100 pcs.
M6 x 15	Steel, zinc-plated	5441-15	63-357

2: Assembly Material

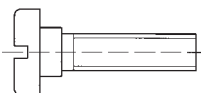

2.2.11 Slotted Cylindrical Screw with Collar

- M3: collar Ø 4

Description	Material	Part-No.	
		1 pc.	100 pcs.
M3 x 11	Steel, zinc-plated	61-259	1904-14

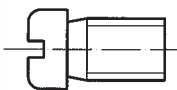

2.2.12 Slotted Cylindrical Screw with Small Head Ø 3.2 / Ø 3.8 (M3)

Description	Material	Part-No.	
		1 pc.	100 pcs.
M2.5 x 4	Steel, zinc-plated	5526-04	1909-10
M3 x 6	Steel, zinc-plated	5536-06	-

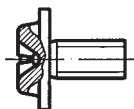
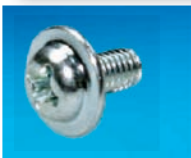

2.2.13 Philips Round Head Screw with Integrated Washer

Description	Material	Part-No.	
		1 pc.	100 pcs.
M2.5 x 10, Torx 8	Steel, zinc-plated	5473-04	-
M3 x 4, Torx T10	Steel, zinc-plated	5473-02	-
M3 x 6	Steel, zinc-plated	5335-06	1912-16
M3 x 6, Torx T10	Steel, zinc-plated	5473-01	-
M4 x 12, Torx 10	Steel, zinc-plated	5473-03	-

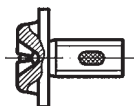

2.2.14 Philips Round Head Screw with Integrated Washer, Tuflock-Coated

Description	Material	Part-No.	
		1 pc.	100 pcs.
M2.5 x 10	Steel, zinc-plated	5336-10	5336-10-2

2.3 Earthing Screws

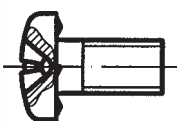

2.3.1 Special Philips Round Head Earthing Screw

Description	Material	Part-No.	
		1 pc.	100 pcs.
M3 x 6	Steel, zinc-plated	61-283	63-372
M3 x 6	Steel, zinc-plated, black	61-293	63-473

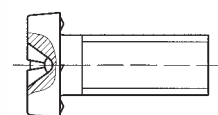

2.3.2 Special Philips Cylindrical Earthing Screw

Description	Material	Part-No.	
		1 pc.	100 pcs.
M3 x 6	Steel, zinc-plated	61-279	63-354
M3 x 6, Torx T10	Steel, zinc-plated	5443-04	-
M4 x 6, Torx T20	Steel, zinc-plated	5443-06	-
M4 x 10	Steel, zinc-plated	61-260	1904-12
M4 x 10, Torx T20	Steel, zinc-plated	5443-01	5443-01-2
M4 x 16, Torx T20	Steel, zinc-plated	5443-07	-

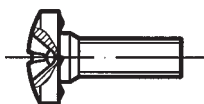

2.3.3 Special Philips Round Head Earthing Screw

- With collar Ø 3.2 x 0.9 for front panels

Description	Material	Part-No.	
		1 pc.	100 pcs.
M2.5 x 8	Steel, nickel-plated	61-286	63-442
M2.5 x 8, Torx T8	Steel, nickel-plated	61-298	-

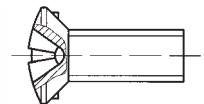

2.4.4 Philips Countersunk Round Head Earthing Screw

Description	Material	Part-No.	
		1 pc.	100 pcs.
M3 x 8	Steel, zinc-plated	61-270	63-374
M3 x 8	Steel, zinc-plated, black	61-292	63-472
M4 x 12	Steel, zinc-plated	63-271	61-375

2: Assembly Material

2.4 Self-Tapping Screws

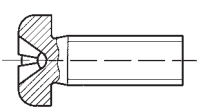

2.4.1 Self-Tapping Philips Round Head Screw

Description	Material	Part-No.	
		1 pc.	100 pcs.
M3 x 5	Steel, zinc-plated	5338-05	1910-10
M4 x 6, Torx T20	Steel, zinc-plated	5471-01	-
M4 x 8, Torx T20	Steel, zinc-plated	5471-02	-

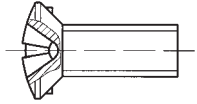

2.4.2 Self-Tapping Philips Countersunk Earthing Screw

Description	Material	Part-No.	
		1 pc.	100 pcs.
M3 x 8.8	Steel, zinc-plated	61-272	63-376

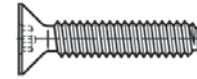

2.4.3 Self-Tapping Countersunk Screw

Description	Material	Part-No.	
		1 pc.	100 pcs.
M4 x 12, Torx T20	Steel, zinc-plated	5472-01	-

2.5 PT Screws



2.5.1 Philips PT Round Head Screw

Description	Material	Part-No.	
		1 pc.	100 pcs.
Ø 2.2 x 8	Steel, zinc-plated	5535-13	63-494
Ø 2.2 x 12	Steel, zinc-plated	5535-12	63-490
Ø 2.5 x 8	Steel, zinc-plated	5588-08	1902-54
Ø 3 x 5	Steel, zinc-plated	61-276	1902-70

2.6 Sheet Metal Screws

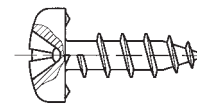

2.6.1 Special Philips Round Head Sheet Metal Earthing Screw

Description	Material	Part-No.	
		1 pc.	100 pcs.
Ø 2.9 x 6.5, Torx T10	Steel, zinc-plated	5443-09	-
Ø 2.9 x 9.5	Steel, zinc-plated	5441-33	63-377
Ø 4.8 x 9.5, Torx T25	Steel, zinc-plated	5575-40	-

2.7 Threaded Bolts

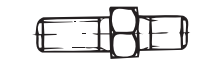

2.7.1 Threaded Earthing Bolt

Description	Material	Part-No.	
		1 pc.	100 pcs.
M4 x 9/6	Steel, zinc-plated	61-096	63-192



2.7.2 Press-in Threaded Stud for Earth Connector

Description	Material	Part-No.	
		1 pc.	100 pcs.
M3 x 8	Steel, zinc-plated	5815-32	-
M4 x 8	Steel, zinc-plated	5815-41	63-194
M4 x 10	Steel, zinc-plated	5815-42	-
M4 x 12	Steel, zinc-plated	5815-43	-

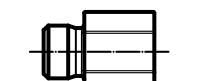

2.7.3 ESD Snap-faster Hook-up

Description	Material	Part-No.	
		1 pc.	100 pcs.
M3 / 4.5 mm, L= 9.5 mm	Brass	61-001	-

2.8 Set Screws



2.8.1 Set Screws for Fixing of Tapped Strips

Description	Material	Part-No.	
		1 pc.	100 pcs.
M2.5 x 8	Steel, zinc-plated	5412-08	1902-15
M3 x 6	Steel, zinc-plated	5413-06	1902-21
M3 x 8	Steel, zinc-plated	5413-08	1902-20
M4 x 6	Steel, zinc-plated	5414-06	-
M5 x 6	Steel, zinc-plated	5415-06	-

2: Assembly Material

2.9 Nuts and Lock Nuts



2.9.1 Hexagonal Nut

Description	Material	Part-No.	
		1 pc.	100 pcs.
M2 x 0.8d	Stainless steel	5620-12	63-492
M2.5 x 0.8d	Steel, zinc-plated	5620-31	1907-03
M3 x 0.5d	Steel, zinc-plated	5620-40	1907-14
M3 x 0.8d	Steel, zinc-plated	5620-41	1907-10
M4 x 0.5d	Steel, zinc-plated	5620-50	-
M4 x 0.8d	Steel, zinc-plated	5620-51	1907-20
M5 x 0.8d	Steel, zinc-plated	5620-61	1907-30
M6 x 0.8d	Steel, zinc-plated	5620-71	1907-40



2.9.2 Hexagonal Lock Nut

Description	Material	Part-No.	
		1 pc.	100 pcs.
M2.5	Steel, zinc-plated	5627-00	1907-04
M5	Steel, zinc-plated	5627-02	-



2.9.3 Inset Nut

Description	Material	Part-No.	
		1 pc.	100 pcs.
M6	Steel, zinc-plated	1925-65	63-092



2.9.4 Retainer For Inset Nut

Description	Material	Part-No.	
		1 pc.	100 pcs.
M6	POM	61-030	63-091



2.9.5 Square Nut

Description	Material	Part-No.	
		1 pc.	100 pcs.
M2.5 SW5.5	Steel, zinc-plated	61-249	1907-83
M3 SW5.5	Steel, zinc-plated	5621-40	1907-87
M3 SW7	Steel, zinc-plated	5621-41	1907-88
M4 SW7	Steel, zinc-plated	5621-50	1907-90



2.9.6 Square Earthing Nut

Description	Material	Part-No.	
		1 pc.	100 pcs.
M4 SW7	Steel, tempered	61-095	63-197

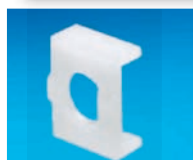

2.9.7 Holder For Square Nut

Description	Material	Part-No.	
		1 pc.	100 pcs.
SW7	POM	61-073	63-251



2.9.6 Nut Positioning Ring for Nut in Profile Slot

Description	Material	Part-No.	
		1 pc.	100 pcs.
M3 (8.2 / 6.2)	PE	61-015	63-006
M4 (8.2 / 6.2)	PE	61-016	63-007

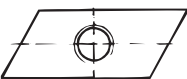
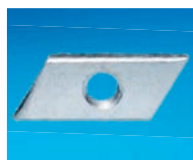

2.9.6 Oblique Nut

Description	Material	Part-No.	
		1 pc.	100 pcs.
M6	Steel, zinc-plated	61-839	1907-51

2: Assembly Material

2.10 Washers

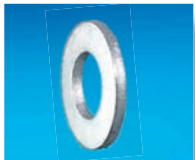

2.10.1 Washer

Description	Material	Part-No.	
		1 pc.	100 pcs.
Ø 2.8 / 7.0 (M2.5)	Steel, zinc-plated	5630-01	1907-01
Ø 3.2 / 7.0 (M3)	Steel, zinc-plated	5630-02	1907-11
Ø 4.3 / 9.0 (M4)	Steel, zinc-plated	5630-03	1907-21
Ø 4.3 / 12.0 (M4)	Steel, zinc-plated	5630-06	1907-21



2.10.2 Lock Washer

Description	Material	Part-No.	
		1 pc.	100 pcs.
Ø 3.2 (M3)	Spring steel, black	5706-04	1907-12
Ø 4.3 (M4)	Spring steel, black	5706-06	1907-22



2.10.3 Plastic Washer

Description	Material	Part-No.	
		1 pc.	100 pcs.
M6	POM, black	61-007	63-090

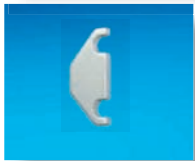

2.10.5 Washers for Unibox 14

Description	Material	Part-No.	
		1 pc.	
Washer for Unibox 14	Aluminium, raw	61-427	

2: Assembly Material



2.11 Tapped Strips



2.11.1 Tapped Strips M2.5

- 2 x 6 mm M2.5
- Steel, galvanised, passivated

Description	Material	Part-No.	
		1 pc.	100 pcs.
M2.5 2 HP	Steel, zinc-plated	61-489	63-000
M2.5 4 HP	Steel, zinc-plated	61-483	63-198
M2.5 8 HP	Steel, zinc-plated	61-475	63-184
M2.5 10 HP	Steel, zinc-plated	61-436	63-002
M2.5 15 HP	Steel, zinc-plated	61-476	63-185
M2.5 18 HP	Steel, zinc-plated	61-477	63-186
M2.5 21 HP	Steel, zinc-plated	61-459	63-182
M2.5 27 HP	Steel, zinc-plated	61-486	63-187
M2.5 28 HP	Steel, zinc-plated	61-458	63-183
M2.5 32 HP	Steel, zinc-plated	61-463	63-190
M2.5 36 HP	Steel, zinc-plated	61-536	63-516
M2.5 40 HP	Steel, zinc-plated	61-465	63-086
M2.5 42 HP	Steel, zinc-plated	61-464	63-057
M2.5 46 HP	Steel, zinc-plated	61-461	63-519
M2.5 59 HP	Steel, zinc-plated	61-487	63-188
M2.5 60 HP	Steel, zinc-plated	61-466	63-087
M2.5 63 HP	Steel, zinc-plated	61-469	63-062
M2.5 81 HP	Steel, zinc-plated	61-467	63-088
M2.5 84 HP	Steel, zinc-plated	61-468	63-089
M2.5 2200 mm	Steel, zinc-plated	61-532	-

Description	Material	Part-No.
M2.5 43 HP	Steel, zinc-plated	61-588
M2.5 64 HP	Steel, zinc-plated	61-587
M2.5 85 HP	Steel, zinc-plated	61-568

2: Assembly Material



2.11.2 Tapped Strips M2.5 1.8 x 5 mm

- 1.8 x 5 mm, M2.5
- Steel, galvanised, passivated

Description	Material	Part-No.	
		1 pc.	10 pcs.
M2.5 10 HP	Steel, zinc-plated	61-470	63-080
M2.5 18 HP	Steel, zinc-plated	61-478	63-178
M2.5 27 HP	Steel, zinc-plated	61-479	63-179
M2.5 37 HP	Steel, zinc-plated	61-538	63-816
M2.5 42 HP	Steel, zinc-plated	61-471	63-081
M2.5 46 HP	Steel, zinc-plated	61-460	63-191
M2.5 63 HP	Steel, zinc-plated	61-472	63-082
M2.5 81 HP	Steel, zinc-plated	61-473	63-083
M2.5 84 HP	Steel, zinc-plated	61-474	63-084
M2.5 2200 mm	Steel, zinc-plated	61-534	

Description	Material	Part-No.
M2.5 43 HP	Steel, zinc-plated	61-584
M2.5 64 HP	Steel, zinc-plated	61-585
M2.5 85 HP	Steel, zinc-plated	61-586



2.11.3 Tapped Strips M3

- 2 x 6 mm M3
- Steel, galvanised, passivated

Description	Material	Part-No.	
		1 pc.	10 pcs.
M3 10 HP	Steel, zinc-plated	61-435	63-004
M3 21 HP	Steel, zinc-plated	61-457	63-180
M3 28 HP	Steel, zinc-plated	61-456	63-181
M3 40 HP	Steel, zinc-plated	61-452	63-067
M3 42 HP	Steel, zinc-plated	61-454	63-064
M3 60 HP	Steel, zinc-plated	61-451	63-066
M3 63 HP	Steel, zinc-plated	61-455	63-069
M3 81 HP	Steel, zinc-plated	61-450	63-065
M3 84 HP	Steel, zinc-plated	61-453	63-068
M3 L = 427.78 mm	Steel, zinc-plated	61-242-443	-
M3 L = 443.02 mm	Steel, zinc-plated	61-242-428	-

2.12 Label Strips

- Numbering of HP-steps
- Mounting onto front extrusions
- Black plastic, PVC
- Numbering white
- Self-adhesive
- **Scope of delivery:**
 - 1 label strip, consisting of 4 single tapes

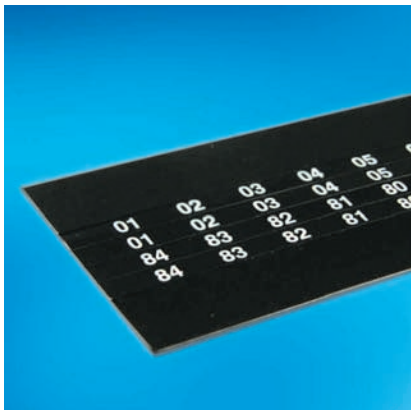

2.12.1 Label Strips

Numbering	Length		Scope of Delivery	Part-No.
	mm	inch		
01-42/42-01	218.1	8.58	2 pcs. each (up and down)	63-142
01-63/63-01	324.8	12.78	2 pcs. each (up and down)	63-143
01-81/81-01	416.4	16.39	2 pcs. each (up and down)	63-043
01-84/84-01	431.6	16.99	2 pcs. each (up and down)	63-046
01-84	431.6	16.99	4 pcs.	63-146

2: Assembly Material

2.13 Insulation



2.13.1 Backplane Insulating Spacer

Description	Material	Part-No.	
		1 pc.	100 pcs.
Ø 7 (M2.5)	POM	61-088	63-166

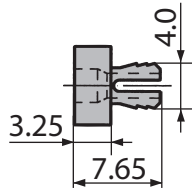

2.13.2 Insulating Strips

Description	Material	Part-No.
		1 pc.
28 HP	ABS	66-901-25
42 HP	ABS	66-901-20
63 HP	ABS	66-901-21
81 HP	ABS	66-901-22
84 HP	ABS	66-901-23

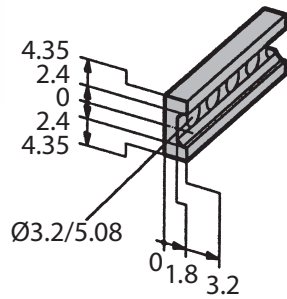

E