

## Skirted Control Knobs

### Series #1910

- ▶ Control knobs and levers in thermoplastic, with or without flange and index/graduations.
- ▶ Knobs can be decorated or customized to your specific need.
- ▶ Perfect knobs for synthesizers and other electronic applications.
- ▶ A variety of shapes and diameters with plain, tapped bosses or with studs are available with standard threads to fit the application.
- ▶ A wide range of soft touch control knobs available in thermoplastic overmold.
- ▶ Colors available upon request.
- ▶ Please note: Not all variations available are listed below. Please [contact customer service](#) to inquire about all available options.



CHECK INVENTORY

REQUEST A QUOTE

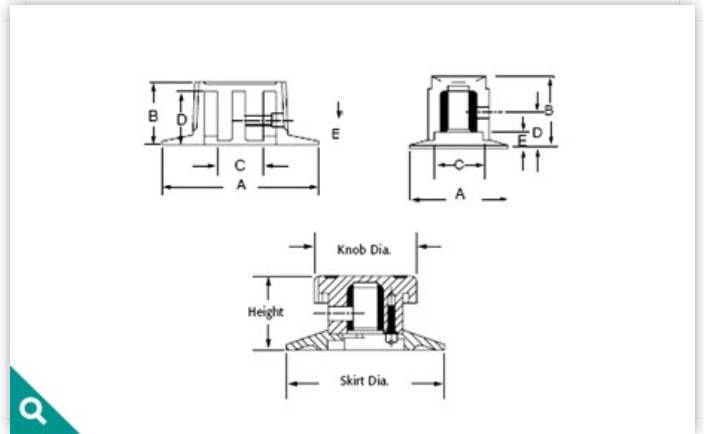

Item #	Diameter A	Height B	Indicator Line	Inlay	Material Type	Mounting Diameter	Mounting Type	Set Screw Thread	Color	Product Drawing
1910	0.75	0.50	No	No	Thermoset	0.25	Plain Molded Hole		Black	<a href="#">Download</a>
1910-C	0.75	0.50	No	No	Thermoset	0.25	Bushing		Black	<a href="#">Download</a>
1910-G	0.75	0.50	Yes	No	Thermoset	0.19	Plain Molded Hole		Black	<a href="#">Download</a>
1910-S	0.75	0.50	Yes	No	Thermoset	0.19	Bushing		Black	<a href="#">Download</a>
1910-W	0.75	0.50	No	No	Thermoset	0.125	Bushing		Black	<a href="#">Download</a>
1910AW	0.75	0.50	Yes	No	Thermoset	0.25 Keyway	Plain Molded Hole		Black	<a href="#">Download</a>
1910BC	0.75	0.50	Yes	No	Thermoset	0.25	Plain Molded Hole		Black	<a href="#">Download</a>
1910CJ	0.75	0.50	Numbers 1-9	No	Thermoset	0.125	Plain Molded Hole		Black	<a href="#">Download</a>
1910CQ	0.75	0.50	No	Yes	Thermoset	0.25	Plain Molded Hole		Black	<a href="#">Download</a>
1910CS	0.75	0.50	Yes	No	Thermoset	0.25	Plain Molded Hole		Black	<a href="#">Download</a>
1910CV	0.75	0.50	Yes	Yes	Thermoset	0.25	Plain Molded Hole		Black	<a href="#">Download</a>
1910CZ	0.75	0.50	Yes	No	Thermoset	0.25 Flatted to 0.16	Spring		Black	<a href="#">Download</a>
1910DA	0.75	0.50	Yes	No	Thermoset	0.25	Knurl Molded Hole		Black	<a href="#">Download</a>
1910DB	0.75	0.50	Yes	No	Thermoset	0.25	Bushing		Black	<a href="#">Download</a>
1910DE	0.75	0.50	Yes	No	Thermoset	0.125	Plain Molded Hole		Black	<a href="#">Download</a>
1910DG	0.75	0.50	Yes	Yes	Thermoset	0.125	Plain Molded Hole		Black	<a href="#">Download</a>
1910DL	0.75	0.50	Yes	No	Thermoset	0.25	Plain Molded Hole		Black	<a href="#">Download</a>
1910DQ	0.75	0.50	Yes	No	Thermoset	0.125	Plain Molded Hole		Black	<a href="#">Download</a>

1910DY	0.75	0.50	Yes	No	Thermoset	0.125	Plain Molded Hole	Black	<a href="#">Download</a>
1910EE	0.75	0.50	Yes	No	Thermoset	0.25	Bushing	Black	<a href="#">Download</a>
1910EG	0.75	0.50	Yes	No	Thermoset	0.125	Plain Molded Hole	Black	<a href="#">Download</a>
1910EL	0.75	0.50	Yes	No	Thermoset	0.125	Bushing	Black	<a href="#">Download</a>
1910EP	0.75	0.50	Yes	No	Thermoset	0.25	Plain Molded Hole	Black	<a href="#">Download</a>
1910ER	0.75	0.50	No	Yes	Thermoset	0.25	Plain Molded Hole	Black	<a href="#">Download</a>
1910ES	0.75	0.50	Yes	No	Thermoset	0.25	Bushing	Black	<a href="#">Download</a>

PRODUCTS

- [Knobs](#)
- [Handles](#)
- [Electronic Enclosures](#)
- [Hex Hybrid Standoffs](#)
- [Two-Shot / Soft Touch](#)
- [Frac Balls](#)
- [Cable Glands](#)
- [Rubber Grommets](#)
- [Custom Molding](#)

RESOURCES

- [Engineering Specifications](#)
- [Distributor Listing](#)
- [Sales Representative Listing](#)

COMPANY

- [About Us](#)
- [Capabilities](#)
- [Certifications](#)
- [Contact Us](#)
- [Blog](#)
- [Careers](#)

QUESTIONS ?





1 + 1 =  \*

**SEND**