



SURE GRIP

## PHENOLIC

**Material-** Phenolic  
**Insert-** Brass

**BB-** Brass Bushing  
**PH-** Plain Hole

**Projecting Stud-** Steel, zinc plated  
† *Insert-* Steel, zinc plated  
†† *Projecting Stud-* Stainless steel

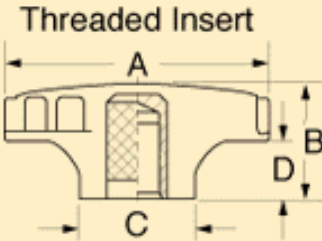

### Threaded Insert

Part No.	Insert	
	Thread	Depth
<a href="#">3000-V</a>	5/16-18	1/2
1 "B" = 5/8, "D" = 1/4		
2 "B" = 1, "D" = 5/8		

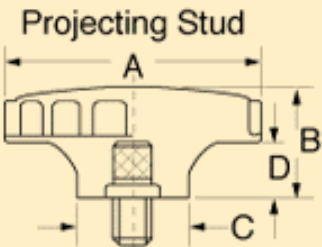

### Projecting Stud

Part No.	Stud		Max Length
	Thread	Length	
<a href="#">3000CB</a>	5/16-18	3/4	3-1/2
<a href="#">3000DV</a>	3/8-16	3/4	3-1/2
<a href="#">3000FG<sup>5</sup></a>	3/8-16	1	3-1/2
<a href="#">3000JK</a>	5/16-18	1-1/2	3-1/2
3" B" = 3/4, "D" = 3/8, 5" B" = 1, "D" = 5/8			
4" B" = 5/8, "D" = 1/4, 6" B" = 1-1/4, "D" = 19/32			

**Plain Hole or Brass Bushing w/Set Screw**

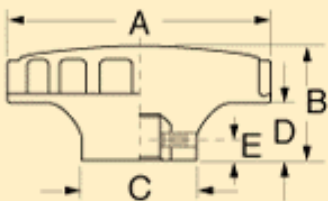

### Hole or Bushing w/ Set Screw

Part No.	Hole		SS	"E"
	Dia.	Type		
<a href="#">3000AM<sup>2</sup></a>	1/4	BB	8-32	3/16

◀◀ [back](#)