

SPACERS

THREADED , ROUND

5XX-9XXX-02 BRASS PER ASTM B16

6XXA-9XXX-XX ALUMINUM PER ASTM B211

BASIC PART NO.

FINISH

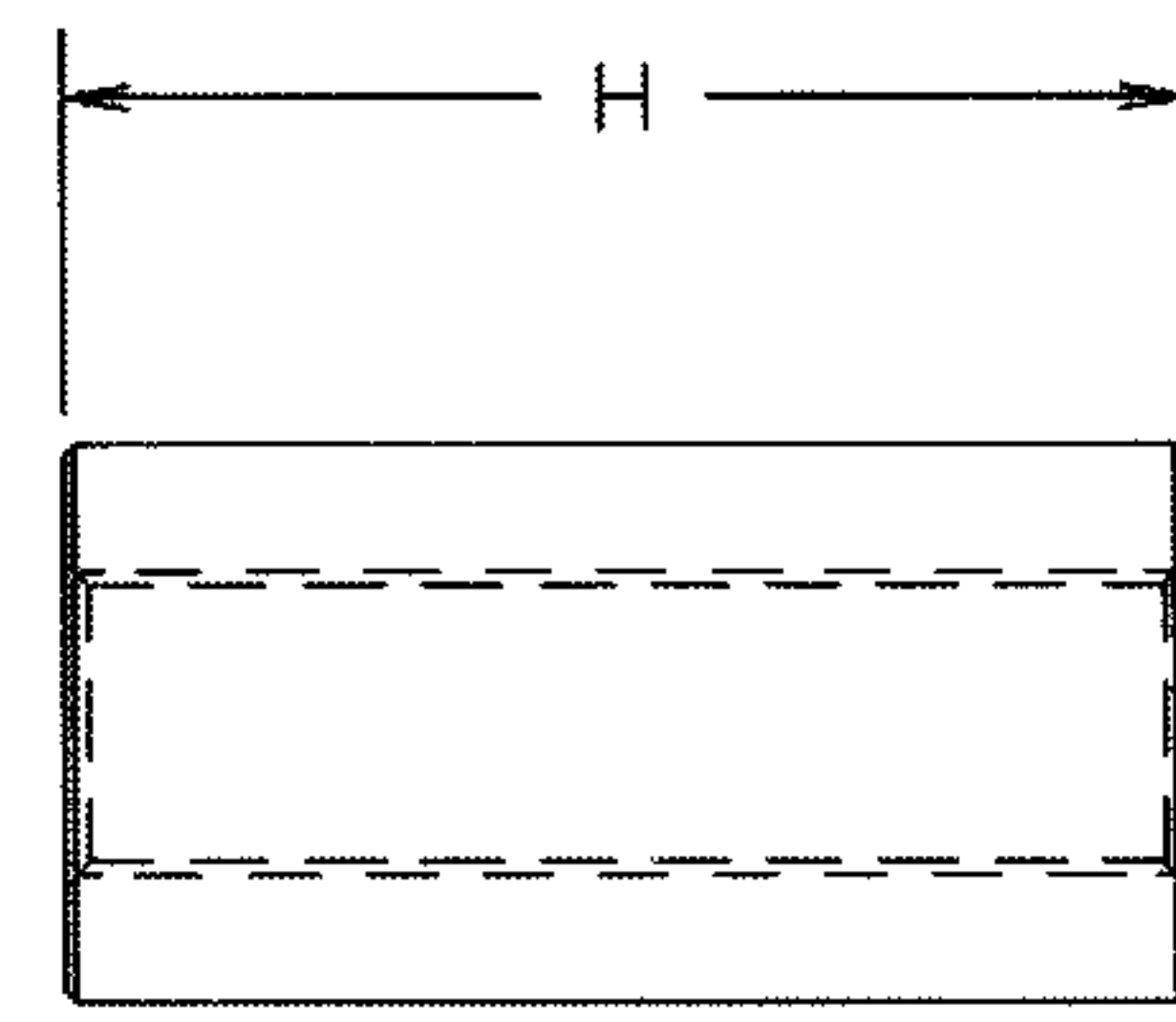
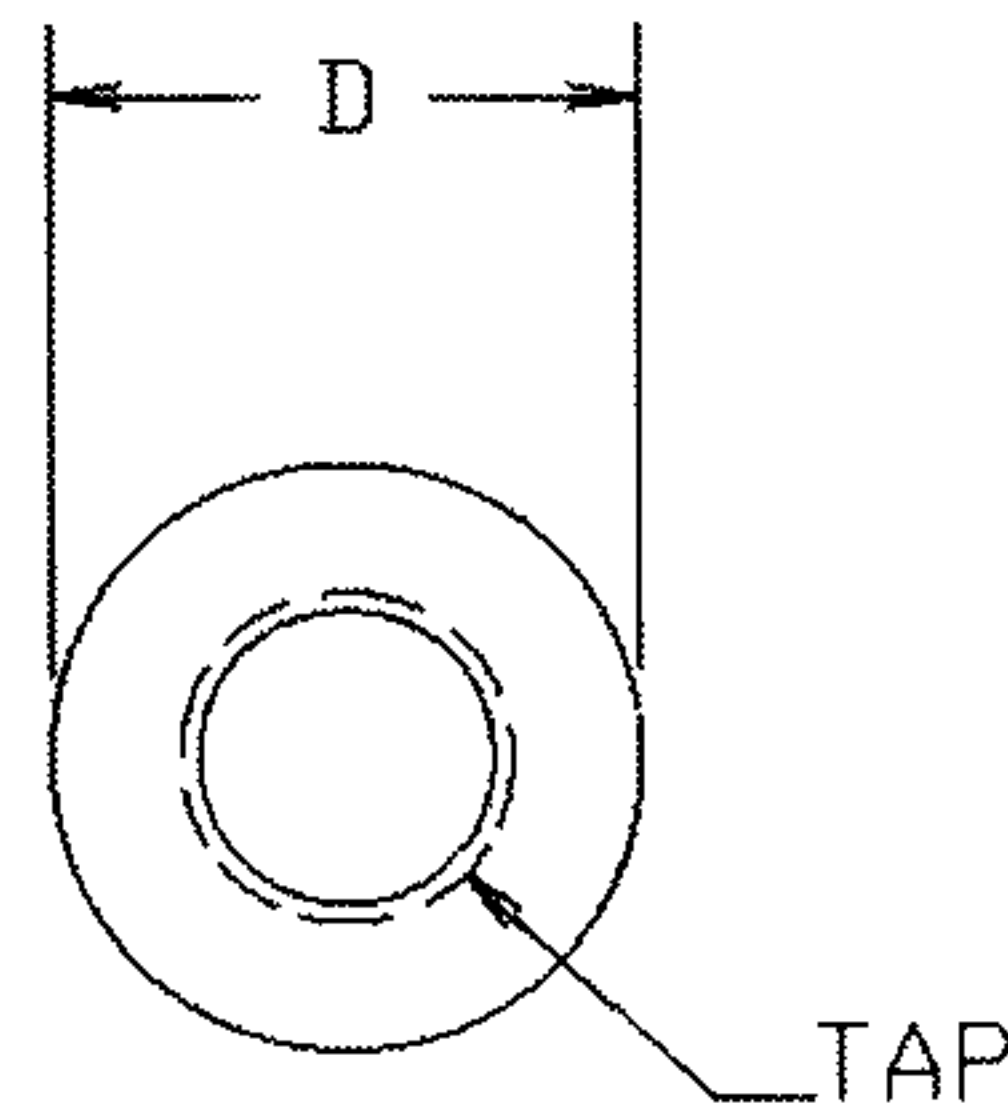

H	D	TAP	BRASS	ALUMINUM	H	D	TAP	BRASS	ALUMINUM
.188	.156	2-56	538-9203	638A-9203	.125	.250	6-32	543-9602	643A-9602
.250	.156	2-56	538-9204	638A-9204	.188	.250	6-32	543-9603	643A-9603
.312	.156	2-56	538-9205	638A-9205	.250	.250	6-32	543-9604	643A-9604
.375	.156	2-56	538-9206	638A-9206	.312	.250	6-32	543-9605	643A-9605
					.375	.250	6-32	543-9606	643A-9606
.125	.188	2-56	542-9202	642A-9202	.437	.250	6-32	543-9607	643A-9607
.188	.188	2-56	542-9203	642A-9203	.500	.250	6-32	543-9608	643A-9608
.250	.188	2-56	542-9204	642A-9204	.562	.250	6-32	543-9609	643A-9609
.312	.188	2-56	542-9205	642A-9205	.625	.250	6-32	543-9610	643A-9610
.375	.188	2-56	542-9206	642A-9206	.687	.250	6-32	543-9611	643A-9611
.437	.188	2-56	542-9207	642A-9207	.750	.250	6-32	543-9612	643A-9612
.500	.188	2-56	542-9208	642A-9208	.812	.250	6-32	543-9613	643A-9613
.562	.188	2-56	542-9209	642A-9209	.875	.250	6-32	543-9614	643A-9614
.625	.188	2-56	542-9210	642A-9210	.937	.250	6-32	543-9615	643A-9615
.687	.188	2-56	542-9211	642A-9211	1.000	.250	6-32	543-9616	643A-9616
.750	.188	2-56	542-9212	642A-9212	1.250	.250	6-32	543-9620	643A-9620
.812	.188	2-56	542-9213	642A-9213	1.500	.250	6-32	543-9624	643A-9624
.875	.188	2-56	542-9214	642A-9214	1.750	.250	6-32	543-9628	643A-9628
.937	.188	2-56	542-9215	642A-9215	2.000	.250	6-32	543-9632	643A-9632
1.000	.188	2-56	542-9216	642A-9216	2.250	.250	6-32	543-9636	643A-9636
					2.500	.250	6-32	543-9640	643A-9640
.125	.188	4-40	542-9402	642A-9402	.125	.250	8-32	543-9802	643A-9802
.188	.188	4-40	542-9403	642A-9403	.188	.250	8-32	543-9803	643A-9803
.250	.188	4-40	542-9404	642A-9404	.250	.250	8-32	543-9804	643A-9804
.312	.188	4-40	542-9405	642A-9405	.312	.250	8-32	543-9805	643A-9805
.375	.188	4-40	542-9406	642A-9406	.375	.250	8-32	543-9806	643A-9806
.437	.188	4-40	542-9407	642A-9407	.437	.250	8-32	543-9807	643A-9807
.500	.188	4-40	542-9408	642A-9408	.500	.250	8-32	543-9808	643A-9808
.562	.188	4-40	542-9409	642A-9409	.562	.250	8-32	543-9809	643A-9809
.625	.188	4-40	542-9410	642A-9410	.625	.250	8-32	543-9810	643A-9810
.687	.188	4-40	542-9411	642A-9411	.687	.250	8-32	543-9811	643A-9811
.750	.188	4-40	542-9412	642A-9412	.750	.250	8-32	543-9812	643A-9812
.812	.188	4-40	542-9413	642A-9413	.812	.250	8-32	543-9813	643A-9813
.875	.188	4-40	542-9414	642A-9414	.875	.250	8-32	543-9814	643A-9814
.937	.188	4-40	542-9415	642A-9415	.937	.250	8-32	543-9815	643A-9815
1.000	.188	4-40	542-9416	642A-9416	1.000	.250	8-32	543-9816	643A-9816
					1.500	.250	8-32	543-9824	643A-9824
.125	.250	4-40	543-9402	643A-9402	2.000	.250	8-32	543-9832	643A-9832
.188	.250	4-40	543-9403	643A-9403					
.250	.250	4-40	543-9404	643A-9404	.250	.375	8-32	544-9804	644A-9804
.312	.250	4-40	543-9405	643A-9405	.375	.375	8-32	544-9806	644A-9806
.375	.250	4-40	543-9406	643A-9406	.500	.375	8-32	544-9808	644A-9808
.437	.250	4-40	543-9407	643A-9407	.625	.375	8-32	544-9810	644A-9810
.500	.250	4-40	543-9408	643A-9408	.750	.375	8-32	544-9812	644A-9812
.562	.250	4-40	543-9409	643A-9409	1.000	.375	8-32	544-9816	644A-9816
.625	.250	4-40	543-9410	643A-9410					
.687	.250	4-40	543-9411	643A-9411					
.750	.250	4-40	543-9412	643A-9412					
.812	.250	4-40	543-9413	643A-9413					
.875	.250	4-40	543-9414	643A-9414					
.937	.250	4-40	543-9415	643A-9415					
1.000	.250	4-40	543-9416	643A-9416					
1.500	.250	4-40	543-9424	643A-9424					
2.000	.250	4-40	543-9432	643A-9432					

- FOR BRASS PARTS, ADD -02 SUFFIX TO PART NUMBER
- FOR STANDARD NICKEL FINISH
- FOR ALUMINUM PARTS, ADD -17 SUFFIX TO PART NUMBER
- FOR STANDARD NON-CHROMATE CLEAR PROTECTIVE COATING OR -16 FOR YELLOW IRRIDITE FINISH.

FOR ADDITIONAL SIZES AND MATERIALS, CONTACT FACTORY

