

CAM SWITCHES

▶ ON/OFF “MAIN SWITCHES”



Technical Info (p. 224)

PANEL MOUNTING - TWO FIXING SCREWS

IP65 standard - IP40 available upon request

Contact Configuration - 1103GN

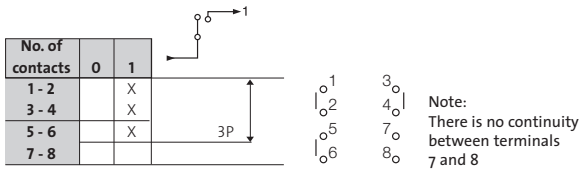

NS3EV493-IP65



TS3EV493-IP65

Contact Configuration - 1104GN

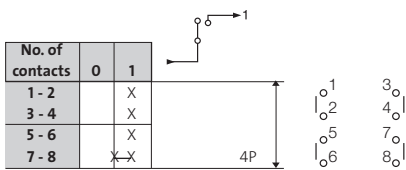

ZS3EV733-IP65



IS3EV733-IP65

Mounting and Dimensions see pg 226 to 229

Switch Series	General use rating - amps	Number of poles	Number of contacts	Positions	Designation	Part Number
PR12	12	3	3		PR12 1103 GN E J483PND51	NS3EV493-IP65
PR12	12	4	4		PR12 1104 GN E J483PND51	NS4EV493-IP65
PR17	16	3	3		PR17 1103 GN E J483PND51	SS3EV493-IP65
PR17	16	4	4		PR17 1104 GN E J483PND51	SS4EV493-IP65
PR21	20	3	3		PR21 1103 GN E J483PND51	TS3EV493-IP65
PR21	20	4	4		PR21 1104 GN E J483PND51	TS4EV493-IP65
PR26	25	3	3		PR26 1103 GN E J723MND51	ZS3EV733-IP65
PR26	25	4	4		PR26 1104 GN E J723MND51	ZS4EV733-IP65
PR40	50	3	3		PR40 1103 GN E J723MND61	HS3EV733-IP65
PR40	50	4	4		PR40 1104 GN E J723MND61	HS4EV733-IP65
PR63	63	3	3		PR40 1103 GN E J723MND61	IS3EV733-IP65
PR63	63	4	4		PR40 1104 GN E J723MND61	IS4EV733-IP65

CAM SWITCHES

► Technical Specifications

UL/CSA Characteristics	PR 12	PR 17	PR 21	PR 26	PR 40	PR 63	PR 125	PR 160
► UL/CSA								
1 PHASE 110/120 VAC	0.5 HP	1 HP	1.5 HP	2 HP	3 HP	5 HP	N/A	N/A
3 PHASE 110/120 VAC 220/240 VAC 440/480 VAC 550/600 VAC	1 HP	2 HP	3 HP	3 HP	7.5 HP	10 HP	N/A	N/A
	3 HP	5 HP	5 HP	7.5 HP	15 HP	20 HP	N/A	N/A
	5 HP	7.5 HP	10 HP	15 HP	30 HP	40 HP	N/A	N/A
	3 HP	10 HP	15 HP	20 HP	30 HP	40 HP	N/A	N/A
GENERAL USE (600 V) (MOTOR CONTROLLER)	12 A	16A	20 A	25 A	50 A	63 A	N/A	N/A
UL 508 RECOGNIZED	YES	YES	YES	YES	YES	YES	No	No
CSA CERTIFIED	YES	YES	YES	YES	YES	YES	No	No
IEC Characteristics	PR 12	PR 17	PR 21	PR 26	PR 40	PR 63	PR 125	PR 160
► For thermal current AC-20 lth I_c(A) (IEC 60 947-3)	20	25	32	40	63	80	200	250
► Rated operating current for AC-21 A I_e(A) (IEC 60 947-3) Switching of resistive loads including moderate overloads	16	20	25	32	50	80	160	200
► Rated operating current for AC-15 A I_e(A) at 230V AC (IEC 60 947-3) Control of electromagnetic loads	6	8	10	12	-	-	-	-
► Performance in AC 23 (kW) (IEC 60 947-3) Switching of motors or other highly inductive loads								
- 3 x 230 V	4	5.5	7.5	11	15	18.5	-	-
- 3 x 400 V	7.5	11	11	11	22	25	-	-
- 3 x 500 V	5.5	11	11	11	25	25	-	-
- 3 x 690 V	4	10	10	11	18.5	22	-	-
► Performance in AC 3 (IEC 60 947-3) Control of squirrel-cage motors starting and switching off motors while running - In kW								
- 3 x 230 V	3	4	4	5.5	11	15	-	-
- 3 x 400 V	4	7.5	7.5	11	18.5	22	-	-
- 3 x 500 V	5.5	7.5	7.5	11	18.5	22	-	-
- 3 x 690 V	3	7.5	7.5	11	18.5	22	-	-

CAM SWITCHES

► Technical Specifications

IEC Characteristics	PR 12	PR 17	PR 21	PR 26	PR 40	PR 63	PR 125	PR 160
► Performance in AC 3 - cont.								
- In HP (for reference)								
- 3 x 230 V	4	5.5	5.5	7.5	15	20	-	-
- 3 x 400 V	5.5	10	10	15	25	30	-	-
- 3 x 500 V	7.5	10	10	15	25	30	-	-
- 3 x 690 V	4	10	10	15	25	30	-	-
► Rated insulation voltage U_i (V)								
- Max. rated voltage $U_e(v)$ IEC	690	690	690	690	690	690	690	690
- CSA (Canada)	600	600	600	600	600	600	600	600
- UL (USA)	600	600	600	600	600	600	600	600
► Rated short time withstand current I_{cw} (A) for 1 sec								
	250	400	420	800	1000	1000	2000	2400
► Maximum wire size (mm²)								
- rigid	4	6/4 ⁽¹⁾	6/4 ⁽¹⁾	6	16	16	ø 8 screw for eyelet	
- flexible	2.5	4	4	6	16	16	ø 8 screw for eyelet	
► Maximum wire size (AWG)								
- rigid	10	8/10 ⁽¹⁾	8/10 ⁽¹⁾	8	6	6		
- flexible	14	12	12	8	6	6		
(1): These values correspond to terminals with jumpers								
► Mechanical durability 1,250,000 operations, maximum rate 150 operations per hour								
► Operating temperature limits - 20°C to + 70°C - 4°F to + 158°F (beyond these limits consult us)								
► Rated operating current in DC-1 low inductive loads (< 1 ms)								
Rated operating current I_e (A) 24 V DC	PR 12	PR 17	PR 21	PR 26	PR 40	PR 63	PR 125	PR 160
	16	20	25	32	50	80	-	-

I_e (A): rated current for breaking 1 contact. For higher voltages you must use a reduction coefficient K in the following graph

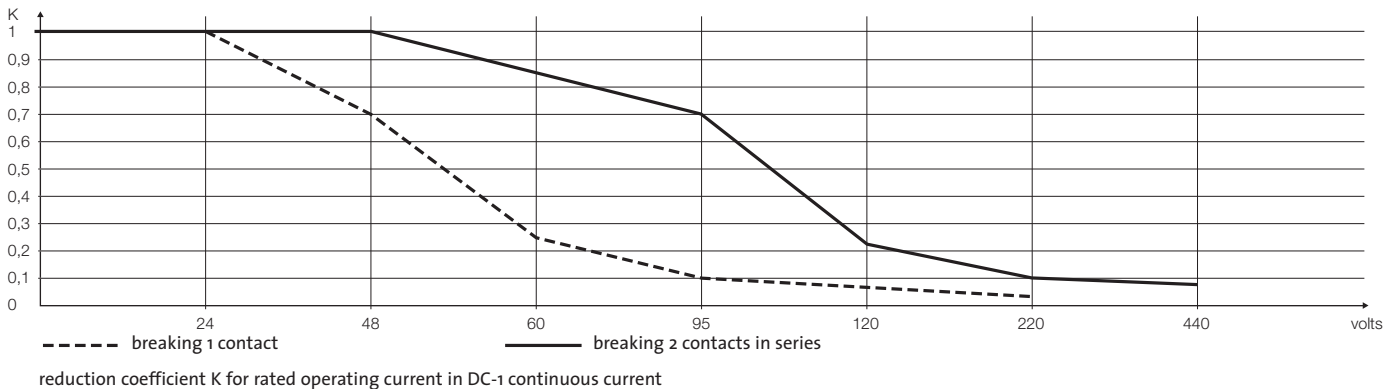

CAM SWITCHES

► Mounting

2 SCREWS - 30 OR 50 MM INTERVAL

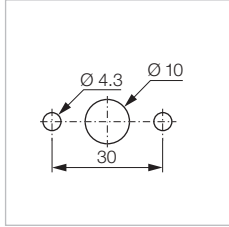

PR 12
PR 17
PR 21
PR 26

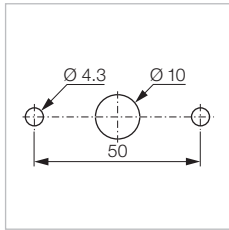
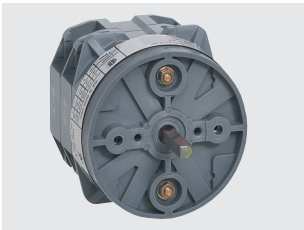

PR 40
PR 63

SINGLE HOLE MOUNTING Ø 22

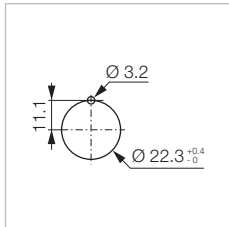

For PR12 only

- 48 legend plate with handle
- HANDLE
- LEVER
- KEY

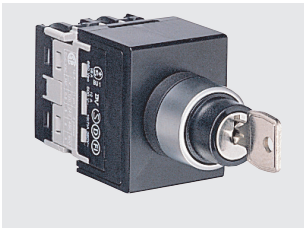

CAM SWITCHES

► Dimensions

2 SCREW FRONT MOUNTING (E)

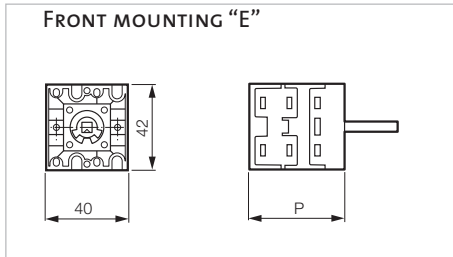

PR 12	No. of contacts	P*
	1-2	36
	3-4	46
	5-6	56
	7-8	66
	9-10	76
	11-12	86

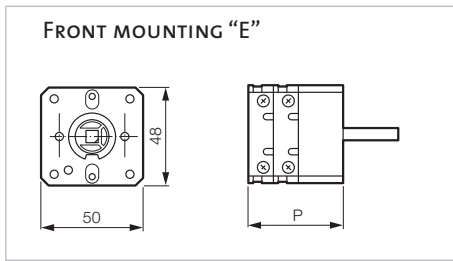

PR 17/21	No. of contacts	P*
	1-2	33
	3-4	45
	5-6	57
	7-8	69
	9-10	81
	11-12	93

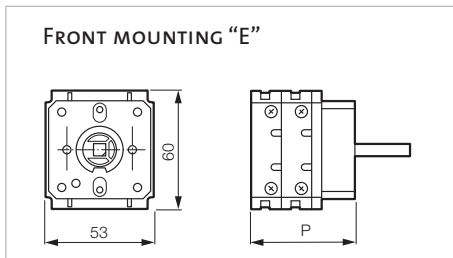

PR 26	No. of contacts	P*
	1-2	36
	3-4	51
	5-6	66
	7-8	81
	9-10	96
	11-12	111

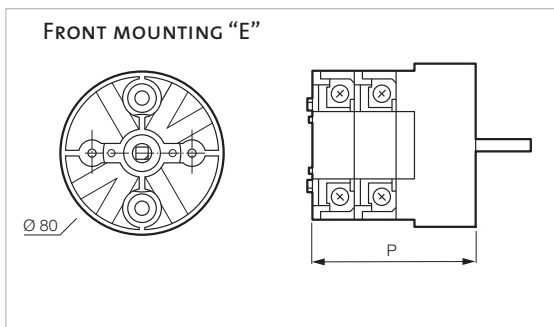

PR 40/63	No. of contacts	P*
	1-2	60
	3-4	80
	5-6	100
	7-8	120
	9-10	140
	11-12	160

CAM SWITCHES

► Dimensions

SINGLE HOLE MOUNTING Ø 22

FRONT MOUNTING "E N48MD50"

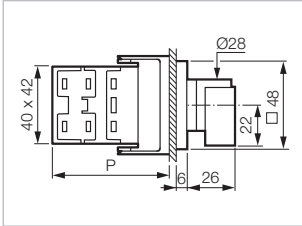

FRONT MOUNTING "E C21RA03"

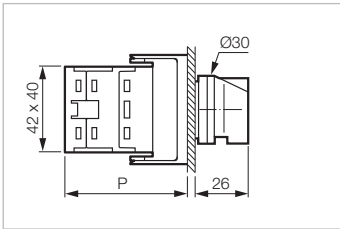

FRONT MOUNTING "E C21RC00"

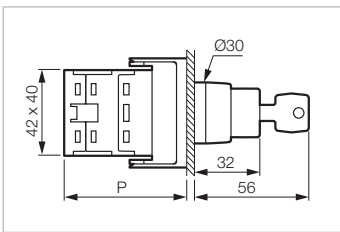

**WITH HANDLE AND
LEGEND PLATE**

No. of contacts	P*
1-2	51
3-4	61
5-6	71
7-8	81
9-10	91
11-12	101

**WITH HANDLE
OR LEVER**

No. of contacts	P*
1-2	51
3-4	61
5-6	71
7-8	81
9-10	91
11-12	101

WITH KEY

No. of contacts	P*
1-2	51
3-4	61
5-6	71
7-8	81
9-10	91
11-12	101

CAM SWITCHES

► Dimensions

ENCLOSURES

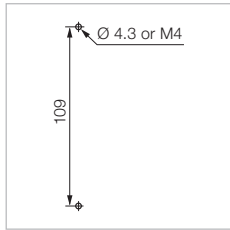
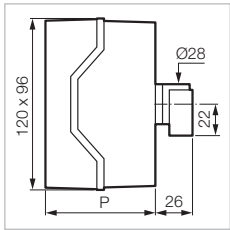

PR 12	No. of contacts	P*
	1-6	77
	7-10	101

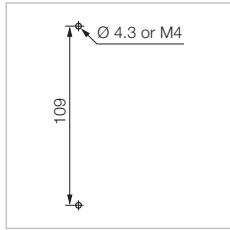
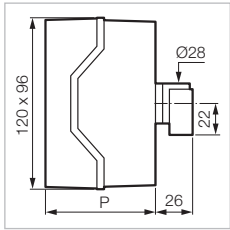

PR 17/21	No. of contacts	P*
	1-6	77
	7-10	101

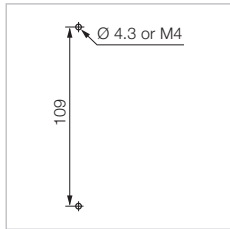
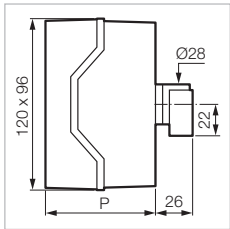

PR 26	No. of contacts	P*
	1-4	77
	5-8	101

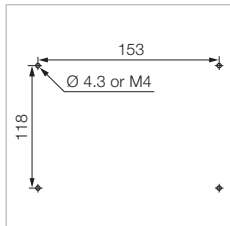
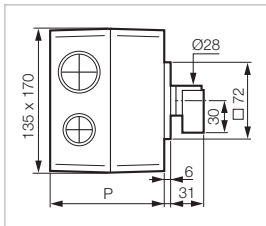

PR 40/63	No. of contacts	P*
	1-4	107
	5-8	145