

## 25A / 32A

### ▶ DOOR INTERLOCK MOUNTING - NO METAL SHAFT EXTENSION



PADLOCKABLE PRESENTATION	Yellow/Red Handle Part Number	Grey Handle Part Number
--------------------------	----------------------------------	----------------------------



0165009NS

<b>25 A</b>		
3P	<b>0165009NS</b>	<b>0168009NS</b>
3P + NC/NO	<b>0165019NS</b>	<b>0168019NS</b>
4P neutral on left	<b>0165029NS</b>	<b>0168029NS</b>
4P + NC/NO	<b>0165039NS</b>	<b>0168039NS</b>



0168109NS

<b>32 A</b>		
3P	<b>0165109NS</b>	<b>0168109NS</b>
3P + NC/NO	<b>0165119NS</b>	<b>0168119NS</b>
4P neutral on left	<b>0165129NS</b>	<b>0168129NS</b>
4P + NC/NO	<b>0165139NS</b>	<b>0168139NS</b>

**STANDARD VERSIONS IP40 RATED.  
TO ORDER WITH IP65 GASKETS ADD -1 TO PART NUMBERS ABOVE.  
IE. 0165009NS-1**

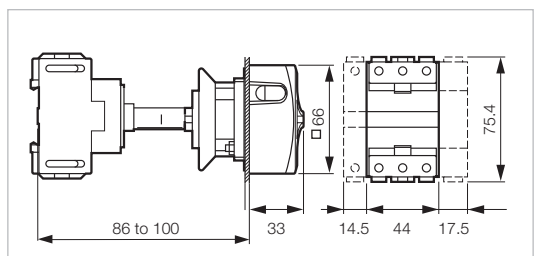

COMPONENTS AND ACCESSORIES	Part Number
----------------------------	-------------



0172179

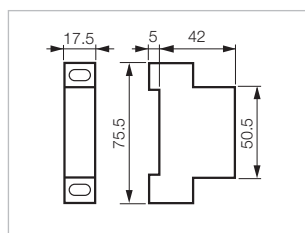

<b>3-pole switch body without handle</b>	
25 A	<b>0172000</b>
32 A	<b>0172100</b>

<b>Additional pole</b>	
25 A	<b>0172075</b>
32 A	<b>0172175</b>

<b>Neutral pole</b>	
25 A	<b>0172065</b>
32 A	<b>0172165</b>

<b>Junction block</b> Ground or Neutral	<b>0172185</b>
--	----------------

<b>Auxiliary contact</b> NC/NO	<b>0172179</b>
-----------------------------------	----------------

<b>IP65 Seal Kit</b>	<b>0174259</b>
----------------------	----------------

<b>Replacement Handle</b>	
<input type="checkbox"/> 66 - Yellow/Red	<b>0172601</b>
<input type="checkbox"/> 66 - Grey	<b>0174601</b>



0174259