

8 7 6 5 4 3 2 1

THE INFORMATION CONTAINED IN THIS DRAWING IS THE SOLE PROPERTY OF ANDERSON POWER PRODUCTS. ANY REPRODUCTION IN PART OR WHOLE WITHOUT THE WRITTEN PERMISSION OF ANDERSON POWER PRODUCTS IS PROHIBITED.

Copyright 2012

ANDERSON POWER PRODUCTS RESERVES THE RIGHT TO ALTER PRODUCT TYPES, THEIR TECHNICAL DATA, DIMENSION, STYLE AND ACCESSORIES WITHOUT PRIOR NOTIFICATION.

COMPONENTS INCLUDED		
ITEM	QTY	DESCRIPTION
1	1	STRAIGHT PLUG SHELL (FEMALE) WITH O-RING

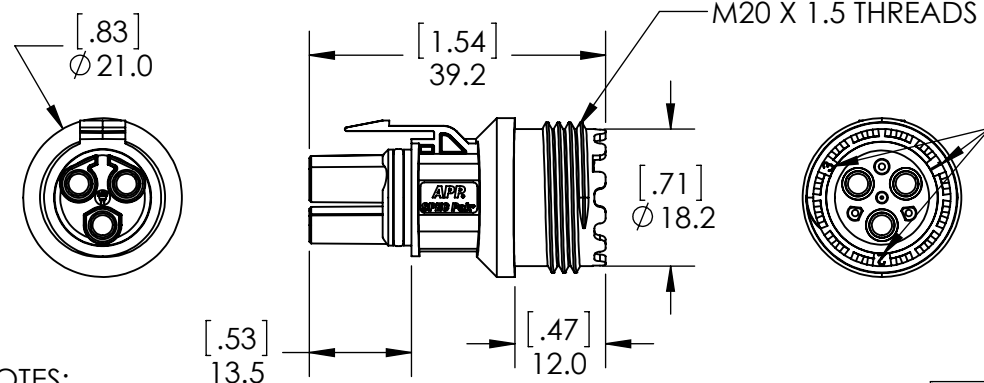
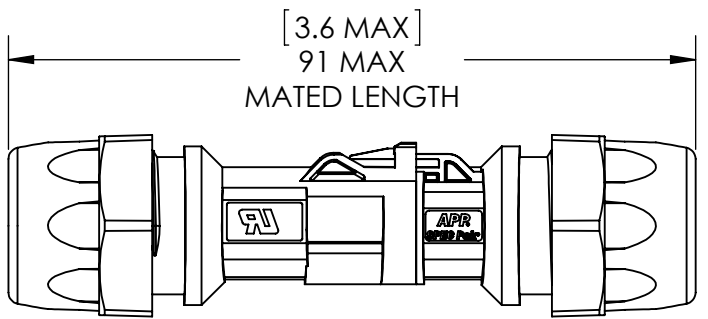
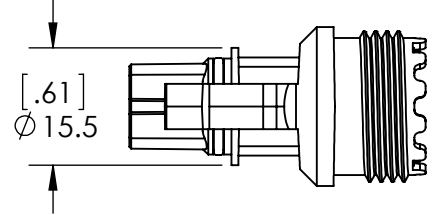
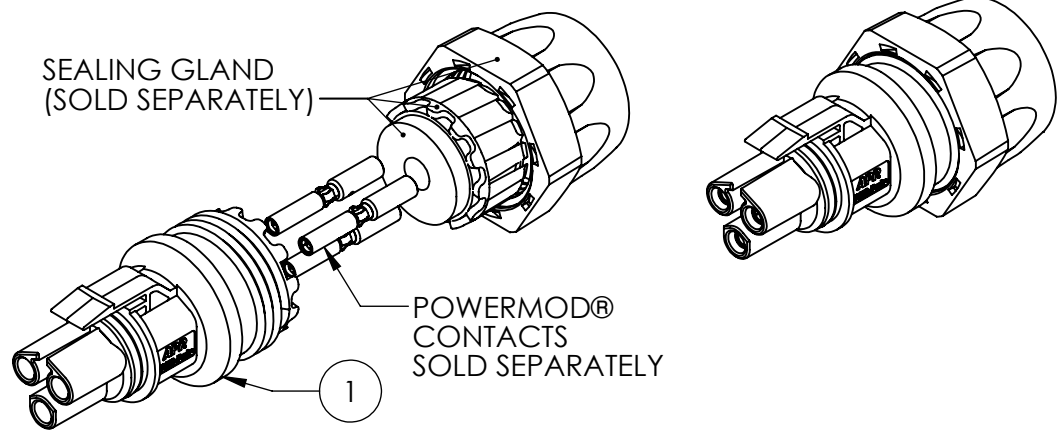

PART NO. SK6-019M03

- NOTES:
- MATERIAL:
 - A. PLUG HOUSING - PC, BLACK
 - B. O-RING - NBR, BLACK
 - FOR USE WITH POWERMOD® SOCKET CONTACTS (SOLD SEPARATELY)
 - REFER TO ASSEMBLY INSTRUCTIONS 1S6590

DIMENSIONS ARE IN:	MM [INCH]	APPROVALS	
UNLESS OTHERWISE STATED		DRAWN	NTS 11/28/2012
TOLERANCES:		CHECKED	CMS 3/8/2013
DECIMALS (INCH)	DECIMALS (MM)	ANGLES	
.XX ± .02	.X ± .5	± 2°	
SURFACE FINISH:		MFG APPRV	CHB 3/8/2013
MACHINED	3.2µ [128µin]	QC APPRV	UFN 3/8/2013
MOLDED	1.6µ [64µin]	ENG APPRV	BD 3/8/2013
MATERIAL: SEE NOTES		SIZE	A
FINISH:		DWG NO.	115221S1
		REV.	2

ANDERSON POWER PRODUCTS

TITLE

3-POSITION MINI PL SPEC PAK® STRAIGHT PLUG SHELL (FEMALE)

SCALE: NONE

CADFILE: 03867

SHEET: 1 OF 1

REV.	DESCRIPTION	APPRV	DATE
2	ECRN 15480	NTS	10/3/2013
1	ECRN 15459	NTS	8/2013
REVISIONS			

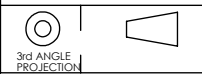

-CAD GENERATED DRAWING-
DO NOT MANUALLY UPDATE
DO NOT SCALE

8 7 6 5 4 3 2 1