

# D-ST

## Screw Termination D'Sub series

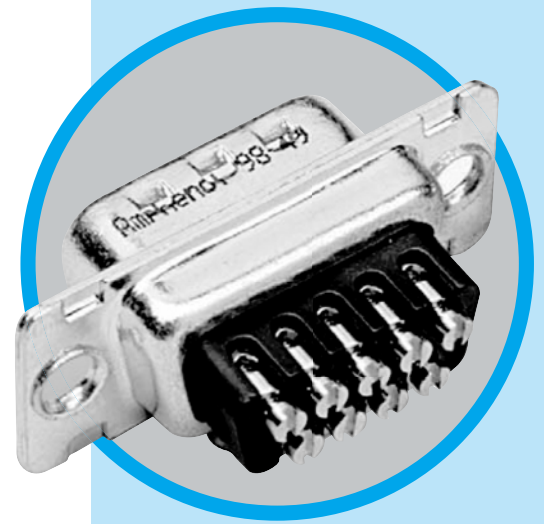

### CHARACTERISTICS

- Connectors according to: MIL C24308 - NFC 93425-HE5

Materials and platings	
Shells	Steel, Tin plated
Insulator	Glass filled thermoplastic, UL 94V-0
Contacts	Machined brass for plug, full gold Machined bronze for socket, full gold

Electrical Data	
Current rating	7.5 A max
Voltage rating	300 V RMS at 50 Hz
Withstanding voltage	1000 V RMS at 50 Hz
Insulation resistance	> 5000 MΩ at 500 V DC
Contact resistance	< 5 mΩ

Climatic Data	
Operating temperature	- 55°C to + 85°C, peak at 125°C
Damp heat	21 days (40°C - 95% HR)
Salt spray	48 hours

Mechanical Data	
Cable type	Solid or stranded
Cable gage	0.75 mm max ( AWG 18 ) - For larger wire, please consult factory
Screw torque	0.05 mN max
Mating cycles	100 (class II) or 500 (class I)

### DESCRIPTION

Amphenol's Screw Termination D'sub series is specially designed for field application.

This new series of connectors permits easy wiring without any specific tools; only a standard screwdriver is required.

Due to their overall dimensions these connectors are compatible with all standard hoods and accessories.

*Simplify  
Your cable  
assemblies!*

### APPLICATIONS

- Industrial controllers
- Residential & public building controls; heating, air conditioning, lighting, safety shutters, fire prevention, alarm systems
- Infrastructure controls; motorway signage, stop-lights
- Field service, cable repairs



**Amphenol**

**DST/E**

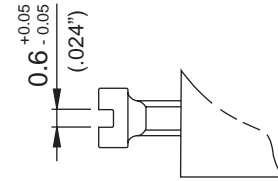
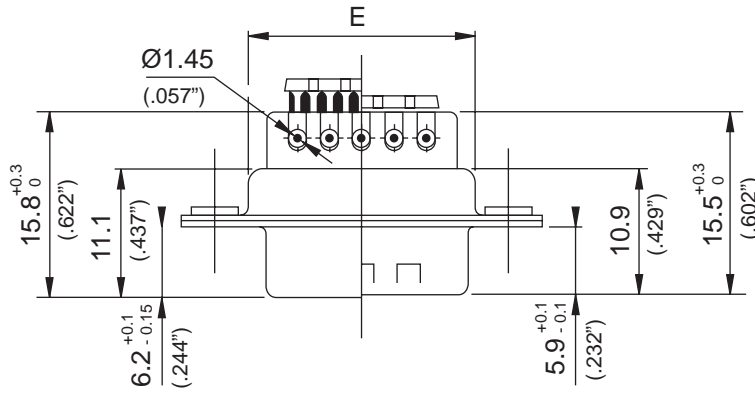
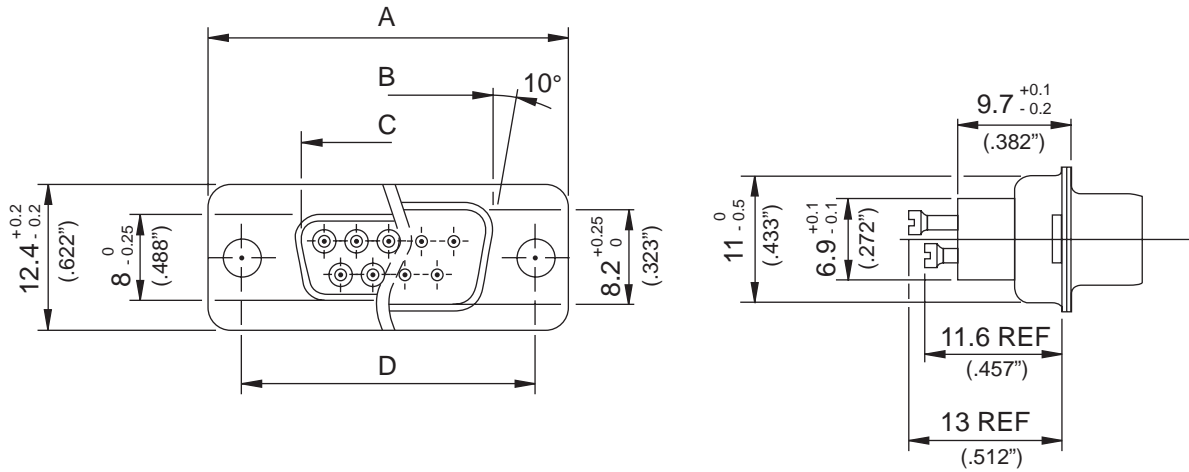

Cable stripping

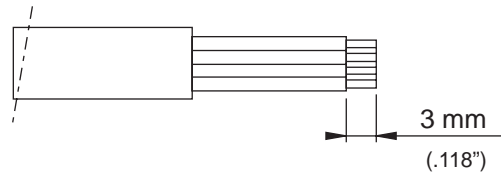

SIZE	A 0.25 (.010") -0.25 (.010")	B 0 -0.2 (.008")	C 0.2 (.008") 0	D 0.1 (.004") -0.1 (.004")	E 0.1 (.004") -0.4 (.016")
9	30.7 (1.209")	16.4 (.646")	16.8 (.661")	25 (.984")	19.4 (.370")
15	39 (1.535")	24.8 (.976")	25.1 (.988")	33.3 (1.311")	27.7 (1.091")
25	52.9 (2.083")	38.5 (1.516")	38.8 (1.528")	47 (1.850")	41.4 (1.630")
37	69.2 (2.724")	54.9 (2.161")	55.3 (2.177")	63.5 (2.500")	57.9 (2.280")

## How to order

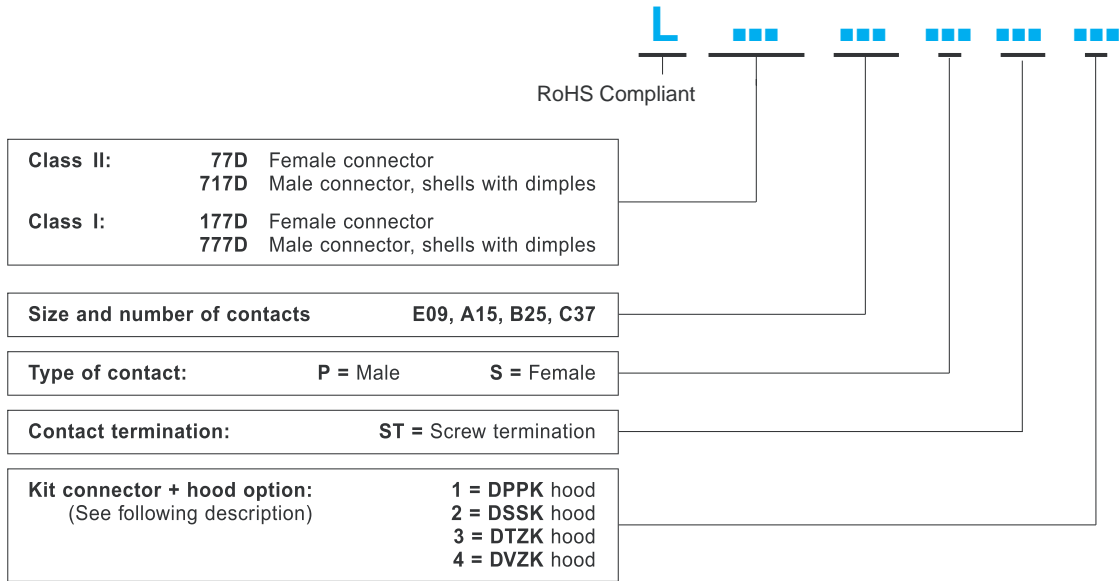

## Plastic hoods



DPPK Straight cable entry

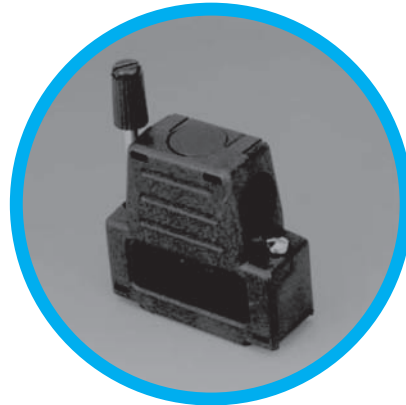

DSSK Angled cable entry

## Metallic hoods



DTZK Straight cable entry

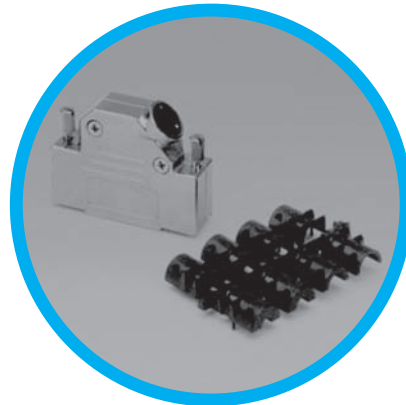

DVZK Angled cable entry

