

## Connectors for Copper Conductors



### One-Hole Metric Lugs

Color-Keyed® metric lugs are manufactured from electrolytic copper tube. The dimensions of the tube are designed to obtain the most efficient electrical conductivity and mechanical strength, resisting vibration and pullout.

Color-Keyed® metric lugs are annealed to guarantee optimum ductility, which is a necessity for compression connectors having to withstand severe deformation arising when compressed or bending of the tongue that may happen during installation.

Connectors have to perform adequately with vibration loads, and annealing is necessary to avoid material failure between the barrel and the tongue.

The presence of an inspection hole facilitates full insertion of the conductor, and the barrel length is designed to allow easy and accurate positioning of the dies during the crimping operation.

Lugs are electrolytically tin-plated to eliminate oxidation of the copper material. Color-Keyed® metric lugs complement our connector family and meet a growing need for customer's connector requirements. Details of the appropriate crimping tools and dies are included. Our Thomas & Betts Sales Representative group is always available to provide any technical advice required. Please contact them if sizes are needed additional to those shown in this catalogue.

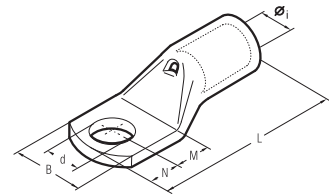

C o m p r e s s i o n

CAT. NO.	Cond. Size SQMM		Ø Stud MM	Dimensions (mm)						Std. Pkg.	6 Ton TBM62BSCR (Crimps)	14 Ton BPLT14BSCRI (Crimps)	26 Ton TBM26MCC (Crimps)	60 Ton TBM60MCC (Crimps)
	Low Stranded	Flexible		Ø1	B	M	N	L	D					
MCC6M4		4 ÷ 6	4	3.6	8.0	5.0	4.0	21.5	4.3	100	MCD6-6 (1)	-	-	
MCC6M5			5	3.6	9.0	6.5	6.0	25.0	5.3	100				
MCC6M6			6	3.6	11.0	7.0	6.0	25.5	6.4	100				
MCC10M4		10	4	4.6	10.0	5.0	4.0	22.5	4.3	100	MCD10-6 (1)	MCD10-14 (1)	N/A	N/A
MCC10M5*			5	4.6	10.0	6.5	6.0	26.0	5.3	100				
MCC10M6*			6	4.6	11.0	7.0	6.0	26.5	6.4	100				
MCC10M8*			8	4.6	15.0	9.0	8.0	30.5	8.4	100				
MCC10M10*			10	4.6	18.0	11.0	10.0	34.5	10.5	100				
MCC16M4*		16	4	5.8	11.5	5.0	4.0	25.5	4.3	100	MCD16-6 (1)	MCD16-14 (1)	N/A	N/A
MCC16M5*			5	5.8	11.5	6.5	6.0	29.0	5.3	100				
MCC16M6*			6	5.8	11.5	7.0	6.0	29.5	6.4	100				
MCC16M8*			8	5.8	15.0	9.0	8.0	33.5	8.4	100				
MCC16M10*			10	5.8	18.0	11.0	10.0	37.5	10.5	100				
MCC25M5*		25	5	7.0	14.0	6.5	6.0	31.5	5.3	100	MCD25-6 (1)	MCD25-14 (1)	N/A	N/A
MCC25M6*			6	7.0	14.0	7.0	6.0	32.0	6.4	100				
MCC25M10*			10	7.0	18.0	11.0	10.0	40.0	10.5	100				
MCC35M5*		35	5	8.9	17.0	6.5	6.0	34.0	5.3	100	MCD35-6 (1)	MCD35-14 (1)	N/A	N/A
MCC35M6*			6	8.9	17.0	7.0	6.0	34.5	6.4	100				
MCC35M8*			8	8.9	17.0	9.0	8.0	38.5	8.4	100				
MCC35M10*			10	8.9	19.0	11.0	10.0	42.5	10.5	100				
MCC35M12*			12	8.9	21.0	14.0	12.0	47.5	13.2	100				
MCC50M8*		50	8	10.0	19.0	19.0	8.0	42.5	8.4	50	MCD50-6 (1)	MCD50-14 (1)	N/A	N/A
MCC50M10*			10	10.0	20.0	11.0	10.0	46.5	10.5	50				
MCC50M12*			12	10.0	21.0	14.0	12.0	51.5	13.2	50				
MCC70M6*		70	6	11.3	21.0	8.0	7.0	44.0	6.4	50	MCD70-6 (1)	MCD70-14 (1)	N/A	N/A
MCC70M8*			8	11.3	21.0	9.0	8.0	46.0	8.4	50				
MCC70M10*			10	11.3	21.0	11.0	10.0	50.0	10.5	50				
MCC70M12*			12	11.3	22.0	14.0	12.0	55.0	13.2	50				
MCC70M16*			16	11.3	26.0	18.0	16.0	63.0	17.0	50				
MCC95M8*		95	8	13.5	25.0	9.0	8.0	52.5	8.4	50	MCD95-6 (1)	MCD95-14 (1)	N/A	N/A
MCC95M10*			10	13.5	25.0	11.0	10.0	56.5	10.5	50				
MCC95M12*			12	13.5	25.0	14.0	12.0	61.5	13.2	50				

\* UL Listed

# Connectors for Copper Conductors

## One-Hole Metric Lugs (continued)

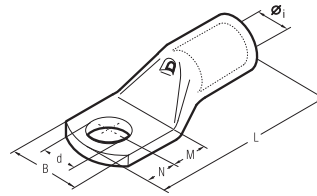

C o m p r e s s i o n



CAT. NO.	Cond. Size SQMM		Ø Stud MM	Dimensions (mm)						Std. Pkg.	6 Ton TBM62BSCR (Crimps)	14 Ton BPLT14BSCRI (Crimps)	26 Ton TBM26MCC (Crimps)	60 Ton TBM60MCC (Crimps)	
	Low Stranded	Flexible		Ø1	B	M	N	L	D						
MCC120M6	120	95 120	8	-	-	-	-	-	6.4	25	MCD120-6 (1)	MCD120-14 (1)	N/A	N/A	
MCC120M8*			8	15.2	28.5	9.0	8.0	54.0	8.4	25					
MCC120M10*			10	15.2	28.5	11.0	10.0	58.0	10.5	25					
MCC120M12*			12	15.2	28.5	14.0	12.0	63.0	13.2	25					
MCC120M16*			16	15.2	28.5	18.0	16.0	71.0	17.0	25					
MCC150M12*	150	120 150	12	16.7	31.5	16.0	14.0	75.0	13.2	25	MCD150-6 (3)	MCD150-14 (1)	N/A	N/A	
MCC150M16*			16	16.7	31.5	19.0	17.0	81.0	17.0	25					
MCC185M10*	185	150 185	10	19.2	35.5	13.0	11.0	76.0	10.5	25	MCD185-6 (3)	MCD185-14 (1)	N/A	N/A	
MCC185M12*			12	19.2	35.5	16.0	14.0	82.0	13.2	25					
MCC185M16*			16	19.2	35.5	19.0	17.0	88.0	17.0	15					
MCC240M10*	240	185 240	10	21.1	39.0	13.0	11.0	82.0	10.5	15	MCD240-6 (3)	MCD240-14 (2)	N/A	N/A	
MCC240M12*			12	21.1	39.0	16.0	14.0	88.0	13.2	15					
MCC240M16*			16	21.1	39.0	19.0	17.0	94.0	17.0	15					
MCC300M10*	300	240	10	23.7	44.0	13.0	11.0	96.0	10.5	10	N/A	MCD300-14 (3)	N/A	N/A	
MCC300M12*			12	23.7	44.0	16.0	14.0	99.0	13.2	10					
MCC300M16*			16	23.7	44.0	19.0	19.0	10.0	17.0	10					
MCC400M10	400	300	12	27.0	51.0	22.0	19.0	113.0	13.2	5	N/A	MCD400-14 (3)	MCD400-26 (2)	MCD400-60 (2)	
MCC400M12			12	27.0	51.0	22.0	19.0	113.0	13.2	5					
MCC400M16			16	27.0	51.0	22.0	19.0	113.0	17.0	5					
MCC500M10	500	400	16						13.2	5	N/A	N/A	MCD500-26 (2)	MCD500-60 (2)	
MCC500M12			16							17.0					5
MCC500M16			16	30.3	56.5	22.0	19.0	117.0	17.0	5					
MCC630M16	630	500	16	33.4	61.6	22.0	19.0	128.0	17.0	6	N/A	N/A	MCD630-26 (2)	MCD630-60 (2)	
MCC630M20			20	33.4	61.6	24.0	23.0	134.0	21.0	6					
MCC800M16	800	630	16	38.0	72.0	24.0	19.0	141.0	17.0	3	N/A	N/A	N/A	MCD800-60 (2)	
MCC800M20			20	38.0	72.0	24.0	23.0	145.0	21.0	3					
MCC1000M16	1000	800	16	44.0	80.0	24.0	19.0	158.0	17.0	2	N/A	N/A	N/A	MCD1000-60 (2)	
MCC1000M20			20	44.0	80.0	24.0	23.0	162.0	21.0	2					

\*UL Listed