

Data Sheet

RT145xxHBLC

Page 1/6

P/N

312031xx

xx=number of poles

2017/01/24

Illustration

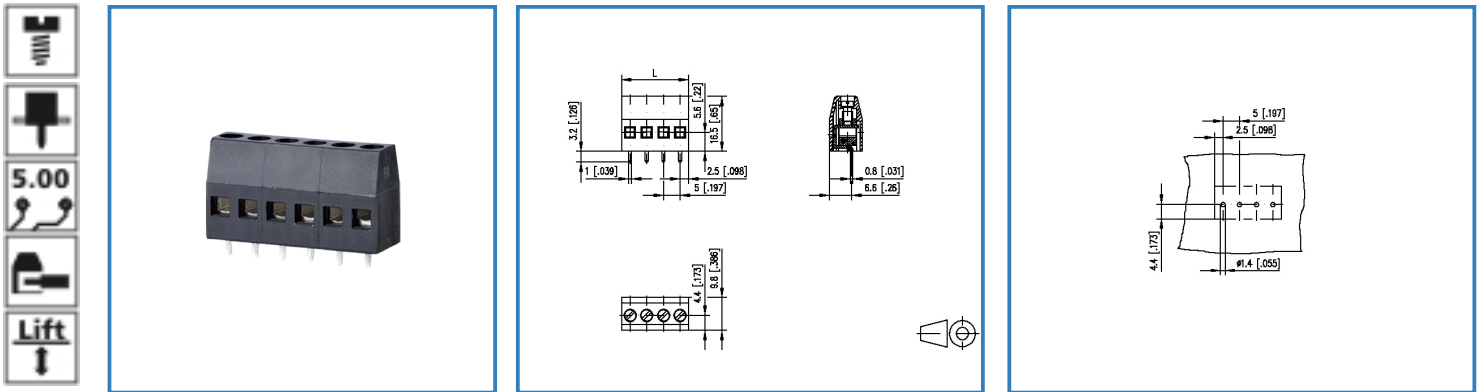

see enlarged drawing at the end of the document

Product specification

- screw type terminal block, solderable
- centerline 5.00 mm, direction of connection 90°
- lift system, fittable without loss of poles
- color black

Data Sheet

RT145xxHBLC

Page 2/6

P/N

312031xx

xx=number of poles

2017/01/24

Technical Data

General Data

Tightening torque SEV	0.5 Nm		
Tightening torque UL	6 lb-in		
Solder pin length	3.2 mm		
min. number of poles	2		
max. number of poles	24		
Insulating material class	CTI 600		
clearance/creepage dist.	4 mm		
protection category	IP 20		
Overvoltage category	III	III	II
Pollution degree	3	2	2
Rated voltage	320 V	800 V	800 V
Rated test voltage	4 kV	4.0 kV	4 kV

Connection data

Rated wiring solid wire	0.08 - 2.5 mm ² / AWG 28 - 12		
Rated wiring stranded wire	0.08 - 2.5 mm ² / AWG 28 - 12		

Approvals

extended wiring UL	2 AWG 16-18, or 1 AWG 16 stranded with 1 AWG 18 solid, or 1 AWG 16 stranded with 1 AWG 18 stranded		
--------------------	----------------------------------------------------------------------------------------------------	--	--

 V / A / AWG	300 / 15 / 28 - 12		
------------------------------------------------------------------------------------------------	--------------------	--	--

 2.5 mm ²	250 V / 24 A / T60		
--------------------------------------------------------------------------------------------------------	--------------------	--	--

Material

insulating material	PA66		
flammability class	V0		
contact material	CuZn		
Glow-Wire Flammability GWFI	960		
Glow-Wire Flammability GWIT	775		
contact surface	Ni + Sn		
terminal body material	CuZn		
terminal body surface	Ni		
screw surface	Zn Cr(VI)-frei/free		
screw thread	M3		

Climatic properties

upper limit temperature	105 °C		
-------------------------	--------	--	--

Data Sheet

RT145xxHBLC

Page 3/6

P/N

312031xx

xx=number of poles

2017/01/24

lower limit temperature -40 °C

General

solderability	Acc. to JEDEC JESD22-B102E 245°C/5s
Tolerance	ISO 2768 -mH



Data Sheet

RT145xxHBLC

Page 4/6

P/N

312031xx

xx=number of poles

2017/01/24

Accessories to

P/N

Product name

31203102 (on request)

RT14502HBLC



METZ CONNECT GmbH

Im Tal 2 | 78176 Blumberg | Germany | www.metz-connect.com

Phone +49 7702 533-0 | Fax +49 7702 533-433

Montageanleitung / Mounting instruction siehe / see www.metz-connect.com

Members of METZ CONNECT



Data Sheet

RT145xxHBLC

Page 5/6

P/N

312031xx

xx=number of poles

2017/01/24

Illustration

Drawing

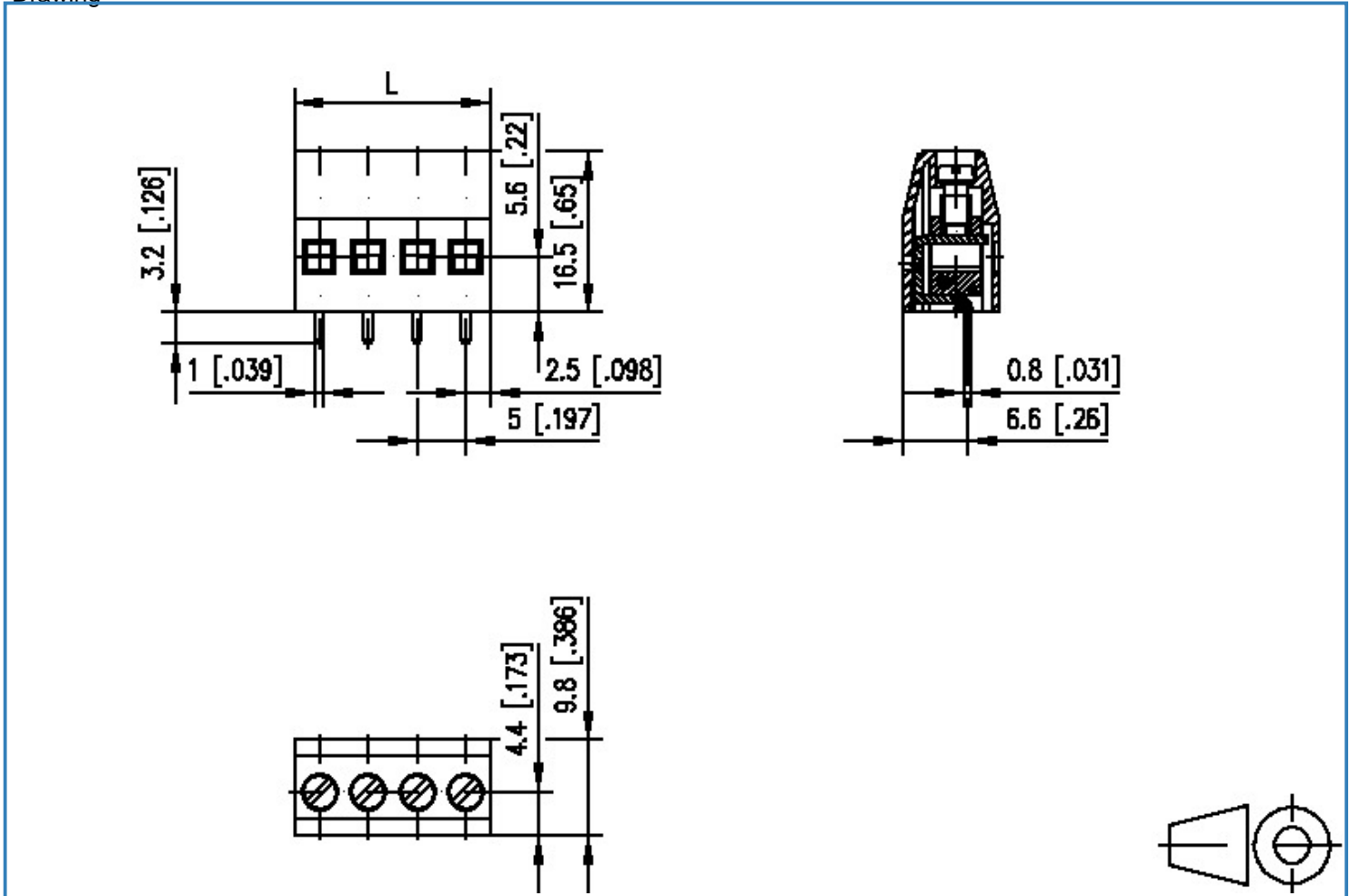

$$L = (\text{pole size} - 1) \times \text{centerline} + 5 [0.197]$$



Data Sheet

RT145xxHBLC

Page 6/6

P/N

312031xx

xx=number of poles

2017/01/24

PCB Layout

