

REV	DESCRIPTION, EGN, EAR NO.	DATE	APP'D
C	PROPOSAL DRAWING	05/11/18	L.CHAN
D	PROPOSAL DRAWING	JAN30/21	L.CHAN

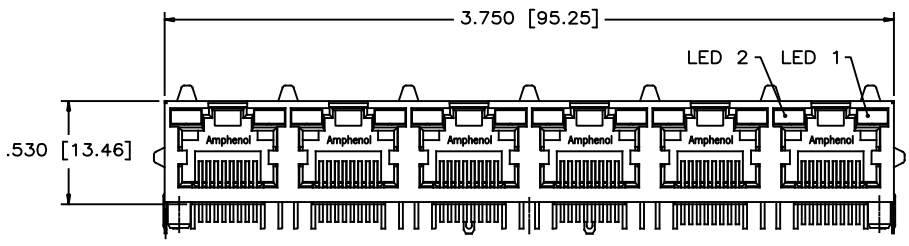

FRONT VIEW

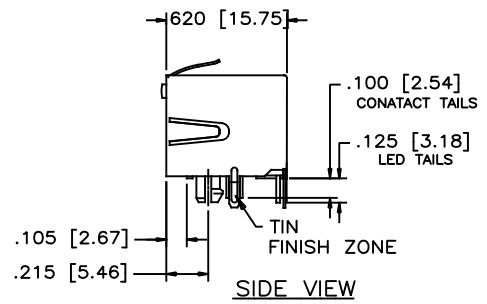

SIDE VIEW

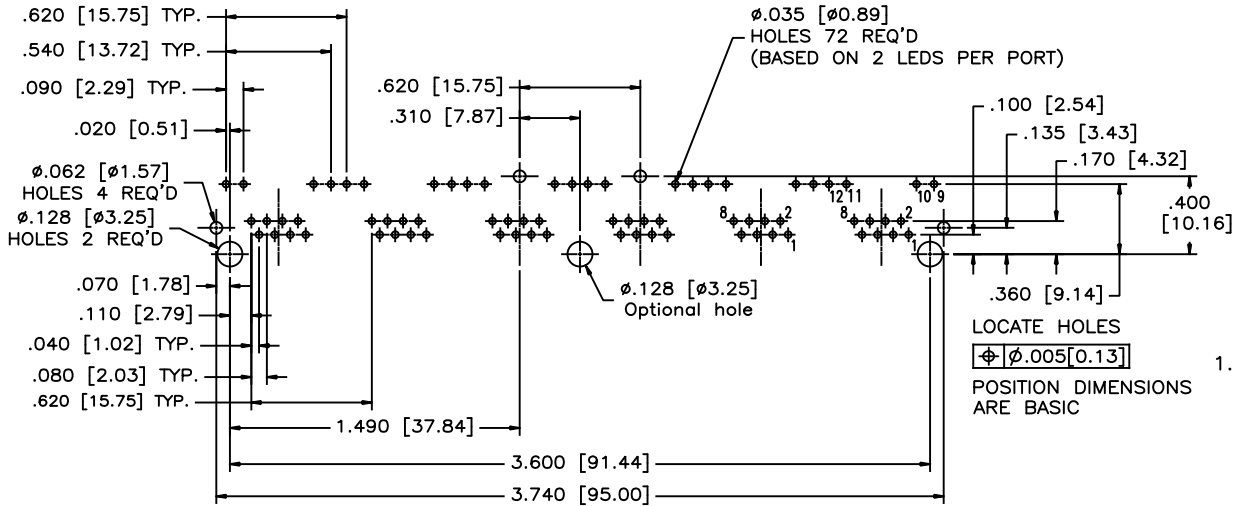

RECOMMENDED P.C.B. LAYOUT
(COMPONENT SIDE OF BOARD)

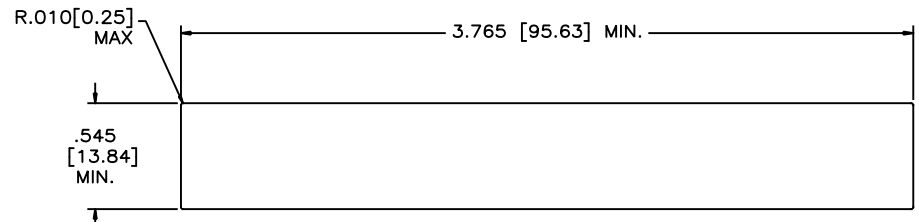

RECOMMENDED PANEL CUTOUT

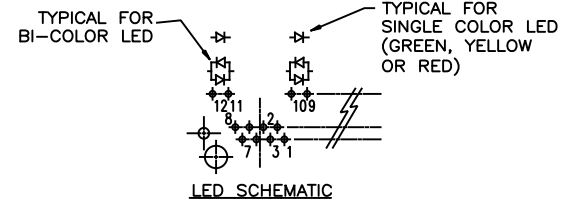

LED SCHEMATIC

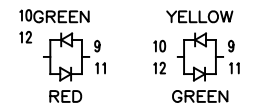

BI-COLOUR LED DETAIL
(RED/YELLOW AND GREEN/ORANGE LED'S ARE ALSO AVAILABLE)

- MATERIALS:**
 PLASTIC HOUSING: HIGH TEMPERATURE THERMOPLASTIC
 FLAMMABILITY RATING UL 94V-0, COLOUR: BLACK
 CONTACTS: PHOSPHOR BRONZE
 PLATING: GOLD ON MATING SURFACES (SEE PART NO. FOR THICKNESS).
 50 μ" [1.27 MICRONS]
 MIN. NICKEL UNDERPLATE
 100 μ" [2.54 MICRONS]
 MIN. MATTE TIN ON CONTACT TAILS.
 SHIELD: COPPER ALLOY WITH TIN FINISH ON PCB TAIL
- MECHANICAL:**
 MATING FORCE: 5.0 LBS MAX.
 MATING CYCLES: 200
- ELECTRICAL:**
 CONTACT RESISTANCE: 20 MILLIOHMS MAXIMUM
 INSULATION RESISTANCE: 500 MEGOHMS MINIMUM
 CURRENT RATING: 1.5 AMPS
 VOLTAGE RATING: 125 VOLTS AC
- ENVIRONMENTAL:**
 STORAGE TEMPERATURE: -20°C to 85°C
 STORAGE LIFE: 1 YEAR
 PACKAGING METHOD: TRAY PACKAGING
- UL FILE NUMBER:** E135615

PART NUMBER: RJHSE-X38X-06

- GOLD PLATING
- E = RJ45 FLAT CONTACT 6 μ INCH
 - G = RJ45 FLAT CONTACT 15 μ INCH
 - J = RJ45 FLAT CONTACT 30 μ INCH
 - S = RJ45 FLAT CONTACT 50 μ INCH
- REFER TO LED OPTIONS DRAWING FOR ORDERING CODES

THIS DOCUMENT CONTAINS PROPRIETARY INFORMATION AND SUCH INFORMATION MAY NOT BE DISCLOSED TO OTHERS FOR ANY PURPOSE OR USED FOR MANUFACTURING PURPOSES WITHOUT WRITTEN PERMISSION FROM AMPHENOL CANADA CORP.

UNLESS SPECIFIED OTHERWISE	DRAWN PAULW	05/11/18
PRIMARY UNITS INCHES	CHECKED L.CHAN	05/11/18
SECONDARY MILLIMETERS	M.E. APP'D	
REFERENCE IN PARENTHESES	Q.A. APP'D	
GENERAL TOLERANCES	DWG APP'D	
1 DECIMAL PLACE ±0.025	ENG. REL. NO.	
2 DECIMAL PLACES ±0.02	REF.	
3 DECIMAL PLACES ±0.015	THIRD ANGLE PROJECTION	DO NOT SCALE DRAWING
ANGULAR DEGREES ±1°		

Amphenol Canada Corp.
Commercial Products

6 PORT HIGH SPEED MODULAR JACK,
8 POSITIONS, 8 CONTACTS, WITH GOLD PLATING OPTION,
WITH LEDS OPTION, WITH SHIELD - RoHS COMPLIANT

DWG NO. P-RJHSE-X38X-06

CODE ID NO. 03554 DWG SIZE C SCALE NA SHEET 1 OF 2

REV	DESCRIPTION, EGN, EAR NO.	DATE	APP'D
C	PROPOSAL DRAWING	05/11/18	L.CHAN
D	PROPOSAL DRAWING	JAN30/21	L.CHAN

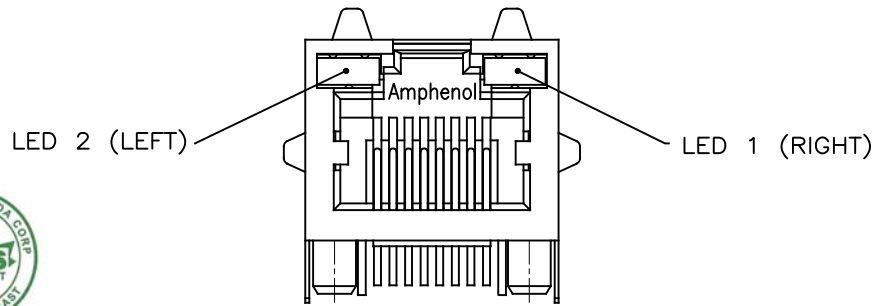

TYPICAL FOR SINGLE & MULTI-PORT

LED SPECIFICATIONS:

FORWARD VOLTAGE: 2.1 VOLTS TYP.
 FORWARD VOLTAGE: 2.9 VOLTS FOR WHITE
 FORWARD VOLTAGE: 3.1 VOLTS FOR BLUE
 REVERSE VOLTAGE: 5.0 VOLTS MIN.
 LUMINOUS INTENSITY:
 18.6 mcd MIN. (AT If=20mA) TYP.
 480 mcd MIN. (AT If=5mA) FOR WHITE
 110 mcd MIN. (AT If=20mA) FOR BLUE

OPERATING TEMPERATURE: -55° TO 85° C
 LEAD SOLDERING TEMPERATURE: 260° C
 (5 SEC, 1/16" FROM CASE)
 PLATING ON TAILS: TIN OR TIN/COPPER
 ALLOY OVER SILVER

EXAMPLE:

PART NUMBER RJHSE-X38X-06

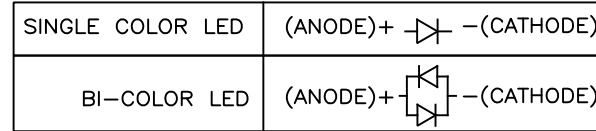

LED COLOR CODE

CODE	LED 2 (LEFT)	LED 1 (RIGHT)	CODE	LED 2 (LEFT)	LED 1 (RIGHT)	CODE	LED 2 (LEFT)	LED 1 (RIGHT)
0	BLOCKED	BLOCKED	9	GREEN	BLOCKED	J	BiC RD/GR	YELLOW
1	YELLOW	GREEN	A	BiC GR/YE	BiC GR/YE	K	YELLOW	BiC GR/OR
2	BLOCKED	GREEN	B	BiC RD/GR	BiC RD/GR	L	BiC GR/YE	RED
3	YELLOW	BLOCKED	C	BiC RD/GR	BiC GR/YE	M	RED	YELLOW
4	GREEN	YELLOW	D	GREEN	BiC GR/YE	N	BiC GR/RD	BiC GR/YE
5	GREEN	GREEN	E	YELLOW	BiC GR/YE	P	GREEN	BiC RD/GR
6	YELLOW	YELLOW	F	BiC GR/YE	YELLOW	R	BiC GR/OR	GREEN
7	RED	GREEN	G	BiC GR/OR	BiC GR/OR	T	RED	RED
8	GREEN	RED	H	BiC GR/YE	GREEN	V	BiC RD/GR	GREEN
						W	ADDITIONAL	OPTIONS

PRIMARY COLOR FOR BI-COLOR
 LEDS IN STANDARD ANODE/
 CATHODE CONFIGURATION IS:
 RED-GREEN= RED
 RED-YELLOW= RED
 GREEN-YELLOW= GREEN
 GREEN-ORANGE= GREEN

LEGEND

BiC=BI-COLOR LED
 LOWC=LOW CURRENT LED
 YE=YELLOW
 GR=GREEN
 RD=RED
 OR=ORANGE

EXAMPLE OF ADDITIONAL LED OPTIONS:

PART NUMBER RJHSE-X38W-06Y

↑ ADDITIONAL LED COLOR CODE
 ↑ DENOTES ADDITIONAL LED OPTIONS TO BE USED

CODE	LED 2 (LEFT)	LED 1 (RIGHT)	CODE	LED 2 (LEFT)	LED 1 (RIGHT)	CODE	LED 2 (LEFT)	LED 1 (RIGHT)
0	DO NOT USE		F	GREEN	BiC GR/OR	Y	YELLOW	BiC YE/GR
1	RED	BLOCKED	G	GREEN	ORANGE			
2	BiC GR/OR	YELLOW	H	BiC OR/GR	BiC OR/GR	B	LOWC YE	LOWC GR
3	YELLOW	RED	J	BiC YE/GR	BiC YE/GR	C	LOWC GR	LOWC YE
4	BLOCKED	RED	K	BLOCKED	WHITE	D	LOWC GR	LOWC GR
5	BLOCKED	YELLOW	L	GREEN	BiC YE/GR			
6	RED	BiC RD/GR	N	BLUE	RED			
7	BLOCKED	BiC RD/GR	P	BLOCKED	BiC GR/YE			
8	BiC RD/GR	BLOCKED	R	BiC GR/RD	BiC GR/RD			
9	BiC GR/YE	BLOCKED	T	BLOCKED	BiC YE/GR			
A	BiC OR/GR	GREEN	U	ORANGE	BiC GR/YE			
E	BiC GR/YE	BiC GR/RD	V	BLOCKED	BiC GR/RD			

NOTE:

THE TWO DIGITS PRECEDING THE
 ADDITIONAL LED CODE MUST BE
 USED IN THE PART NUMBER, WHEN
 ORDERING ANY OF THE ADDITIONAL
 LED OPTIONS.

UNLESS SPECIFIED OTHERWISE	DRAWN PAULW	05/11/18
PRIMARY UNITS INCHES	CHECKED L.CHAN	05/11/18
SECONDARY MILLIMETERS	M.E. APP'D	
REFERENCE IN PARENTHESES	Q.A. APP'D	
GENERAL TOLERANCES	DWG APP'D	
1 DECIMAL PLACE ±0.025	ENG. REL. NO.	
2 DECIMAL PLACES ±0.02	REF.	
3 DECIMAL PLACES ±0.015	THIRD ANGLE PROJECTION	
ANGULAR DEGREES ±1°	DO NOT SCALE DRAWING	

Amphenol Canada Corp. Commercial Products			
6 PORT HIGH SPEED MODULAR JACK, 8 POSITIONS, 8 CONTACTS, WITH GOLD PLATING OPTION, WITH LEDS OPTION, WITH SHIELD - RoHS COMPLIANT			
DWG NO.	P-RJHSE-X38X-06		REV D
CODE ID NO. 03554	DWG SIZE C	SCALE NA	SHEET 2 OF 2